

PART NUMBER
727165

SPECIFICATION DATA	
PARAMETER	VALUE
OUTPUT VOLTAGE	10V P-P MIN
COIL RESISTANCE	60-80 OHMS
INDUCTANCE	9-16 mH @ 1KHz
DIELECTRIC STRENGTH	1288V AC RMS AT 60HZ FOR 1 SEC NOT TO EXCEED 100V PER SECOND
LEAKAGE RESISTANCE	100 MEGOHMS MINIMUM
TEMPERATURE LIMITS	-100°F TO +200°F
IMPEDANCE	300-500 OHMS @ 6Kc

- NOTES:
- OUTPUT VOLTAGE TESTED AT 5456 RPMs WITH AN 8 PITCH GEAR AT .005 AIR GAP AND A 300 OHM LOAD.
 - CUSTOMER: COOPER ENERGY
 - SEE PRODUCTION DRAWING FOR APPLICABLE REVISION LETTER *.
 - POLARITY: UPON APPROACH OF FERROUS MATERIAL WHITE LEAD WILL BE POSITIVE WITH RESPECT TO BLACK LEAD. GREEN LEAD IS GROUNDED TO SHELL.
 - THE MAGNETIC SENSOR MUST BE INSTALLED SUCH THAT THE FLYING LEADS ARE PROTECTED AGAINST MECHANICAL DAMAGE AND THE FLYING LEADS MUST BE TERMINATED AND PROTECTED IN A MANNER SUITABLE FOR THE ZONE OF INSTALLATION. (EG. HAZARDOUS AREA PROTECTION.)
 - THE GREEN FLYING LEAD IS DIRECTLY CONNECTED TO THE METAL ENCLOSURE OF THE MAGNETIC SENSOR. THE REMAINING TWO FLYING LEADS MUST BE INSTALLED SUCH THAT THE CIRCUIT IS CAPABLE OF WITHSTANDING A 500V TEST TO THE METAL ENCLOSURE FOR ONE MINUTE WITH OUT BREAKDOWN.

REVISION HISTORY					
REV	DOCUMENT	DESCRIPTION	CHG'D BY	DATE	APPROVED
P	0100330	MARKING SHOULD BE CHANGED FROM "Ex nA II T6 Gc" to "Ex nA IIC T6 Gc"	BM	2013-05-02	H. GERARDO
R	00012113	REVISED PER ECN	BA	2022-02-16	B. GANGARAJU

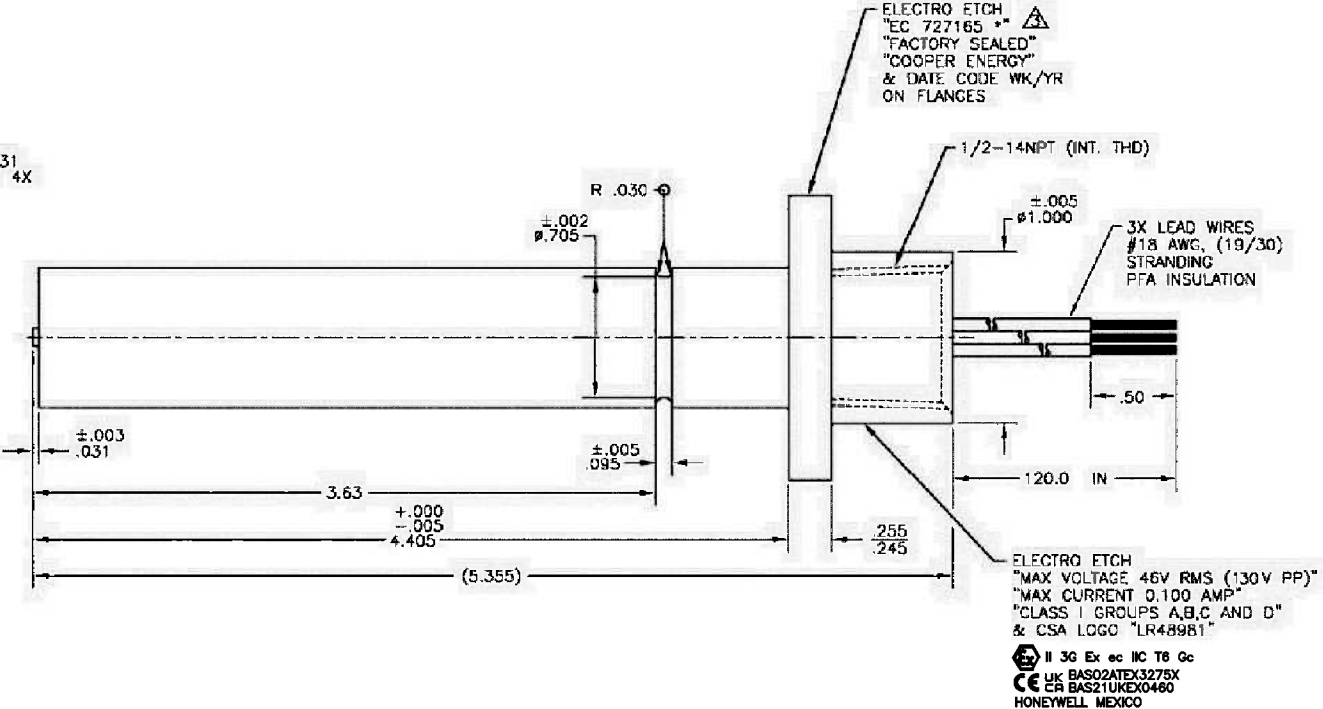
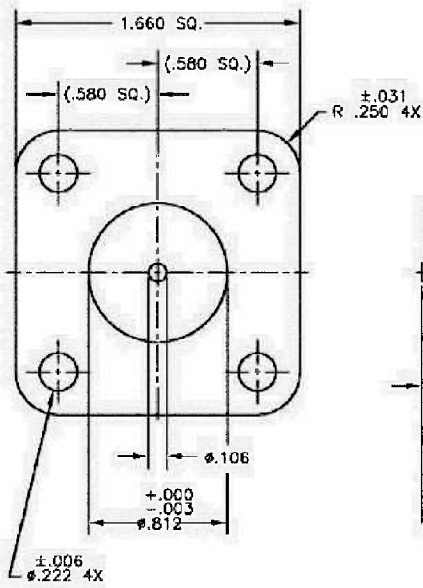

"DO NOT CHANGE WITHOUT CSA APPROVAL"

UNLESS OTHERWISE SPECIFIED DIMENSIONS ARE IN INCHES		THIRD ANGLE PROJECTION				<h3>Honeywell</h3>	
DECIMAL TOL	FRACTIONS	2 PLACE	3 PLACE				
MATERIAL: 300 SERIES SSTL		SIZE: C	CAGE CODE: 81692	DWG NO: 727165	TYPE: I	REV: R	HONEYWELL CONFIDENTIAL THIS DOCUMENT CONTAINS PROPRIETARY INFORMATION AND SUCH INFORMATION MAY NOT BE DISCLOSED TO OTHERS FOR ANY PURPOSE, NOR USED FOR MANUFACTURING PURPOSES WITHOUT WRITTEN PERMISSION FROM HONEYWELL.
FINISH: -		SCALE: NONE	REF: -	SHEET: 1 OF 1	RELEASE DATE: 8/30/88	DRW: GK	
APPLICABLE DOCUMENTS: ASME Y14.100-2009 ASME Y14.5-2009		RDE: NBEAL	QA: ENT	CHK: S. RAGHU	DATE: 5/3/88	DATE: 11/17/88	
COMPUTER GENERATED DRAWING: RASTER		DATE: 2013-05-02					