

DO NOT  
SCALE FROM  
THIS PRINT

**HDTF-3-XX-X-RA-XX-XXX**

PAIRS PER COLUMN: -3  
 No. OF COLUMNS: -04, -06, -08

PLATING: -S: 30µ" SELECTIVE GOLD IN CONTACT AREA, MATTE TIN ON TAIL

IMPEDANCE: -100: 100 Ω  
**A** \*\* -085: 85 Ω

WAFERS: -LC: STANDARD, -HS: HIGH SPEED

ORIENTATION: -RA: RIGHT ANGLE

(\*\* = NOT ENGINEERING APPROVED)

**A**

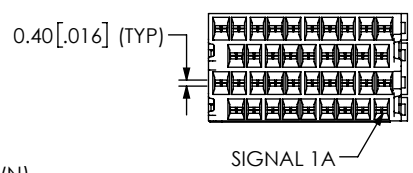
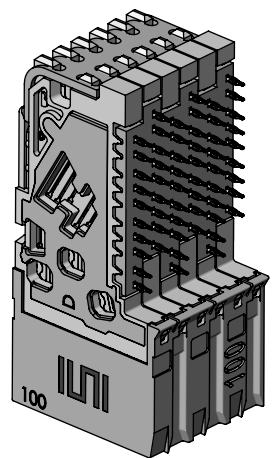
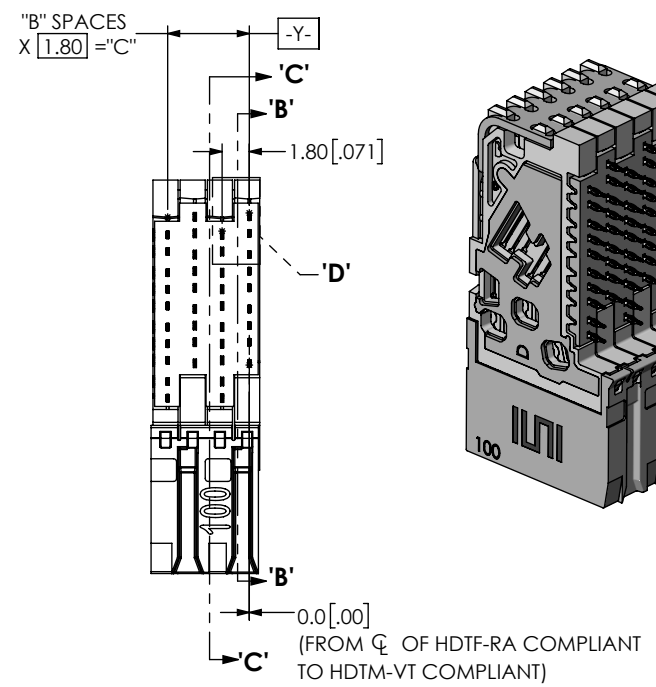
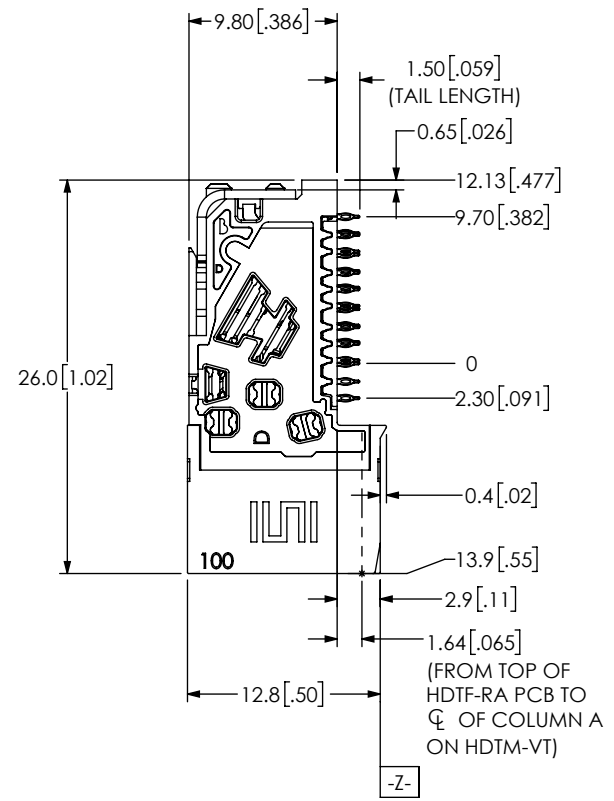
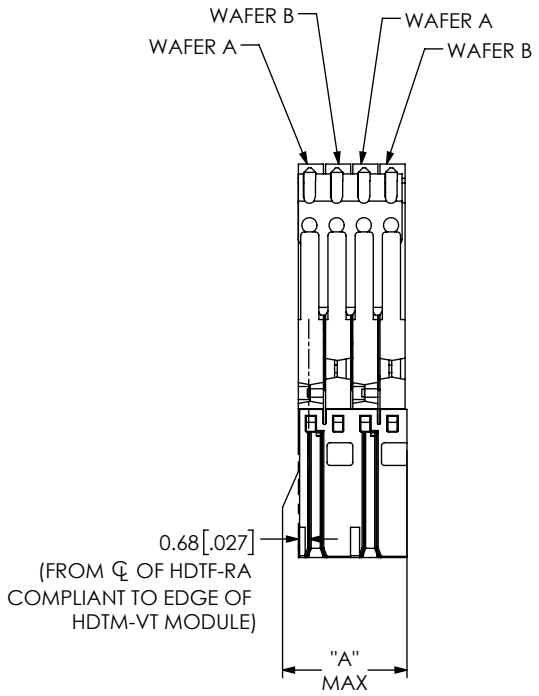

**FIG 1**  
(HDTF-3-04-X-RA-XX-XXX SHOWN)

- NOTES:
1. TRAYS TO BE STANDARD PACKAGING.
  2. CONTACT SAMTEC FOR CONNECTOR PRESS FIT INSTRUCTIONS AND REQUIRED FIXTURES.

**TABLE 1**

No. OF COLUMNS	"A"	"B"	"C"
-04	7.2 [0.28]	3	5.40 [0.213]
-06	10.8 [0.42]	5	9.00 [0.354]
-08	14.4 [0.57]	7	12.60 [0.496]

**PROPRIETARY NOTE**

THIS DOCUMENT CONTAINS CONFIDENTIAL AND PROPRIETARY INFORMATION AND ALL DESIGN, MANUFACTURING, REPRODUCTION, USE, PATENT RIGHTS AND SALES RIGHTS ARE EXPRESSLY RESERVED BY SAMTEC, INC. THIS DOCUMENT SHALL NOT BE DISCLOSED, IN WHOLE OR PART, TO ANY UNAUTHORIZED PERSON OR ENTITY NOR REPRODUCED, TRANSFERRED OR INCORPORATED IN ANY OTHER PROJECT IN ANY MANNER WITHOUT THE EXPRESS WRITTEN CONSENT OF SAMTEC, INC.

**samtec**

520 PARK EAST BLVD, NEW ALBANY, IN 47150  
 PHONE: 812-944-6733 FAX: 812-948-5047  
 e-Mail: info@SAMTEC.com code 55322

DO NOT SCALE DRAWING  
 MATERIAL: INSULATOR: LCP CONTACT: CU ALLOY  
 SHEET SCALE: 2:1

DESCRIPTION: XCode® 3 PAIR HD RA ASSEMBLY  
 DWG. NO. HDTF-3-XX-X-RA-XX-XXX

A WAFER SYMBOL

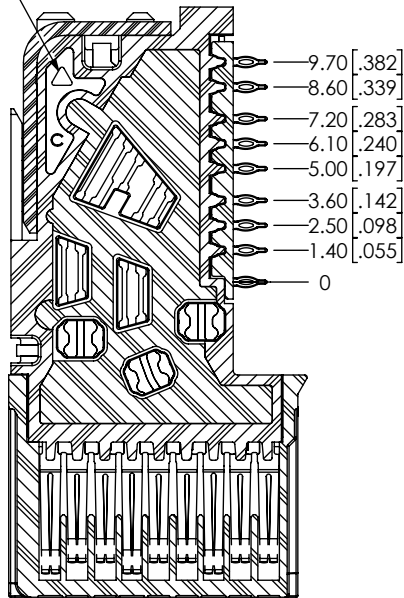

SECTION 'B'-'B'  
SCALE 3 : 1  
(WAFER A)  
(HS OR LC OPTIONS)

B WAFER SYMBOL

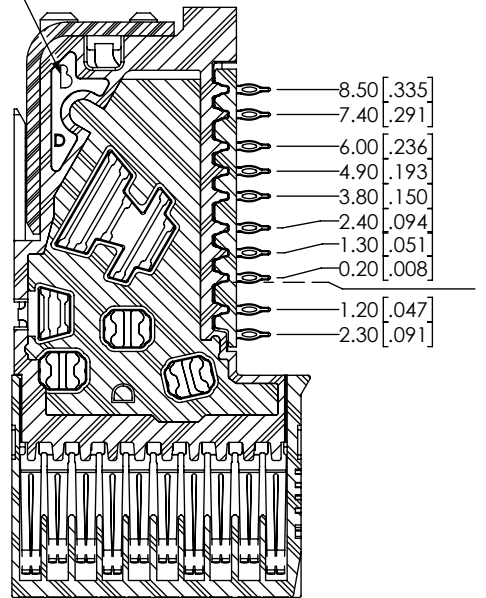

SECTION 'C'-'C'  
SCALE 3 : 1  
(WAFER B)  
(HS OR LC OPTIONS)

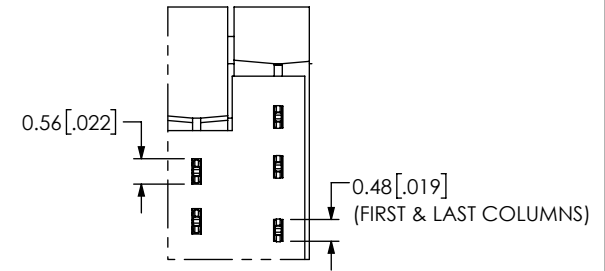

DETAIL 'D'  
SCALE 6 : 1

<p>DO NOT SCALE DRAWING</p> <p>SHEET SCALE: 2:1</p>	<p>PROPRIETARY NOTE</p> <p>THIS DOCUMENT CONTAINS CONFIDENTIAL AND PROPRIETARY INFORMATION AND ALL DESIGN, MANUFACTURING, REPRODUCTION, USE, PATENT RIGHTS AND SALES RIGHTS ARE EXPRESSLY RESERVED BY SAMTEC, INC. THIS DOCUMENT SHALL NOT BE DISCLOSED, IN WHOLE OR PART, TO ANY UNAUTHORIZED PERSON OR ENTITY NOR REPRODUCED, TRANSFERRED OR INCORPORATED IN ANY OTHER PROJECT IN ANY MANNER WITHOUT THE EXPRESS WRITTEN CONSENT OF SAMTEC, INC.</p>	<p>520 PARK EAST BLVD, NEW ALBANY, IN 47150 PHONE: 812-944-6733 FAX: 812-948-5047 e-Mail info@SAMTEC.com code 55322</p>
	<p>DESCRIPTION:</p> <p>XCede® 3 PAIR HD RA ASSEMBLY</p>	<p>DWG. NO.</p> <p>HDTF-3-XX-X-RA-XX-XXX</p>
	<p>BY: KNOWLDEN 11/10/2016</p>	<p>SHEET 2 OF 2</p>