

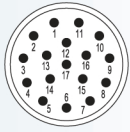

Inserts / Pinouts

Inserts 17-pole



Insert pin mating view (Part P)

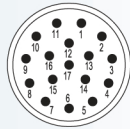

Insert socket mating view (Part E)

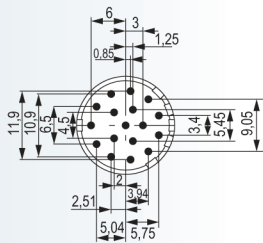

Type	Part Number	Part Number
Pinout counter-clockwise	Pins	Sockets
Insert with solder contacts	7.002.917.103	7.002.917.104
Insert without contacts.....	7.004.917.101	7.004.917.102
Insert with dip solder contacts		
Length 3,5 mm.....	7.002.917.107	
Insert with dip solder contacts		
Length 10 mm.....	7.002.917.127	7.002.917.108
Insert with dip solder contacts		
Length 17 mm.....	7.002.917.137	7.002.917.118

The correct dimension of a connector with dip solder contacts depends on the particular type of housing.

Coding possibilities N, S, H, X and Y (see page 81)



Inserts 19-pole

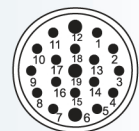

Insert pin mating view (Part E)

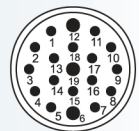

Insert socket mating view (Part P)

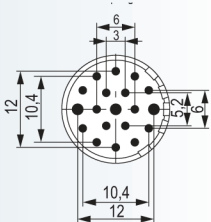

Type	Part Number	Part Number
Pinout clockwise	Pins	Sockets
Insert with solder contacts	7.001.919.103	7.001.919.104
Insert with solder contacts +PE (Pos.12)	7.001.919.113	7.001.919.114
Insert with solder contacts + PE (Pos.12) 1,5 mm elongated ...	7.001.919.123	
Insert without contacts.....	7.003.919.101	7.003.919.102
Insert without contacts +PE (Pos.12).....	7.003.919.111	7.003.919.112
Insert with dip solder contacts		
Length 3,5 mm.....	7.001.919.107	
Insert with dip solder contacts		
Length 10 mm.....	7.001.919.127	7.001.919.108
Insert with dip solder contacts		
Length 17 mm.....	7.001.919.137	7.001.919.118

The correct dimension of a connector with dip solder contacts depends on the particular type of housing.

Coding possibilities N, S, H, X and Y (see page 81)

