

YOU ARE HERE: [Home](#) > [Product Selection](#) > [Circular Connectors](#) > [Contacts & Configurations](#) > [M23 Signal Inserts](#) > [Contact Config.](#) > [7.001.919.103](#)

# Insert 19-pole Contacts & Configurations M23 Signal Inserts

[SHARE THIS PRODUCT](#) [PRINT](#)

- M23 Inserts
- Technical Data
- Downloads
- Approvals

## M23 Signal Connector Insert Configurations

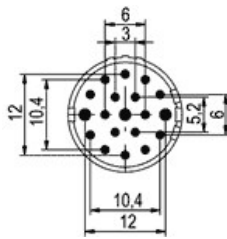

Insert Dimensions

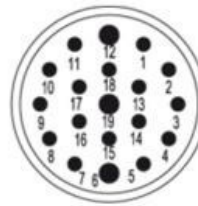

Insert Pin Mating View

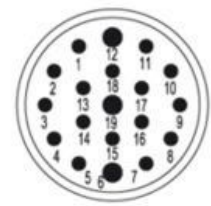

Insert Socket Mating View

Pinout Clockwise	Pins	Sockets
Insert - w/ Dip Solder Contacts 10mm (Fits Panel Connector Only)	<input type="text" value="1"/> <a href="#">ADD TO QUOTE</a> 7.001.919.127	
Insert - w/ Dip Solder Contacts 10mm (Panel Connector only)		<input type="text" value="1"/> <a href="#">ADD TO QUOTE</a> 7.001.919.108
Insert - w/ Dip Solder Contacts 17mm (Fits Panel Connector Only)	<input type="text" value="1"/> <a href="#">ADD TO QUOTE</a> 7.001.919.137	<input type="text" value="1"/> <a href="#">ADD TO QUOTE</a> 7.001.919.118
Insert - w/ Dip Solder Contacts 3.5mm (Fits Panel Connector Only)	<input type="text" value="1"/> <a href="#">ADD TO QUOTE</a> 7.001.919.107	
Insert - with Solder Contacts	<input type="text" value="1"/> <a href="#">ADD TO QUOTE</a> 7.001.919.103	<input type="text" value="1"/> <a href="#">ADD TO QUOTE</a> 7.001.919.104

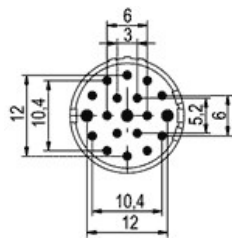

Insert Dimensions

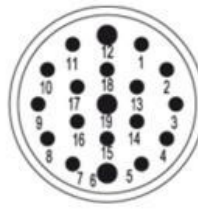

Insert Pin Mating View

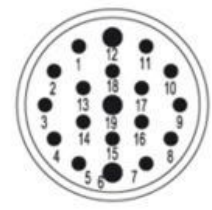

Insert Socket Mating View

Pinout Clockwise	Pins	Sockets
Insert - with Solder Contacts +PE (Pos.12)	<input type="text" value="1"/> <a href="#">ADD TO QUOTE</a> 7.001.919.113	<input type="text" value="1"/> <a href="#">ADD TO QUOTE</a> 7.001.919.114
Insert - with Solder Contacts +PE (Pos.12) 1.5mm elongated	<input type="text" value="1"/> <a href="#">ADD TO QUOTE</a> 7.001.919.123	
Insert - without Contacts	<input type="text" value="1"/> <a href="#">ADD TO QUOTE</a> 7.003.919.101	<input type="text" value="1"/> <a href="#">ADD TO QUOTE</a> 7.003.919.102
Insert - without Contacts +PE (Pos.12)	<input type="text" value="1"/> <a href="#">ADD TO QUOTE</a> 7.003.919.111	<input type="text" value="1"/> <a href="#">ADD TO QUOTE</a> 7.003.919.112



Your One Stop Solution For Cable & Wire Accessories!

VISIT OUR SISTER COMPANY HI-TECH CONTROLS, INC.

- > [Strain Relief Fittings](#)
- > [Industrial Enclosures](#)
- > [Technical](#)
- > [Site Map](#)
- > [Hazloc Cable Glands](#)
- > [Conduit System](#)
- > [Resources](#)
- > [Copyright](#)
- > [Circular Connectors](#)
- > [Thread Adapters, Enlargers & Reducers](#)
- > [About Us](#)
- > [Privacy Policy](#)
- > [Accessories](#)
- > [Contact](#)
- > [Blog](#)

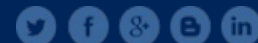

7374 S. Eagle Street 800-456-9012 Toll Free  
 Centennial, CO 80112- 303-699-1135 Phone  
 A 303-680-5344 Fax

