



SCHROFF

Project - 0 item(s)

MY PROJECT LIST

- PRODUCTS
- APPLICATIONS
- INDUSTRIES
- NEW PRODUCTS
- CONFIGURATORS
- Products ▾
- Search

Home > Type H-LL heavy duty, long lip

Type H-LL heavy duty, long lip

SCHROFF



Catalog Number: 34560-301

[Back To Product](#)

- For plug-in units with IEEE handle
- Long lip (H-LL)
- Installation at top and bottom
- < 28 HP not printed
- Al extrusion, anodised finish, conductive contact surface, with HP markings
- For CPCI and VME64x systems
- For plug-in units with IEEE handle
- Long lip (H-LL)
- For CPCI and VME64x systems
- Installation at top and bottom

Product family:

- EuropacPRO
- RatiopacPRO

Note:

Delivery is in standard pack multiples. Pricing is per individual item

Type:

Individual Components

Individual Component Type:

Horizontal Rails & Accessories

Standard pack quantity (SPQ):

Please take into consideration that deliveries may be carried out in the stated SPQs (SPQ, e.g. 5 pieces, 10 pieces, 50 pieces, etc.). Differing order quantities (e.g. 2 pieces) may be changed to the next possible delivery quantity = Standard Pack Quantity.

Note:

Without M4 thread to front, without printing and without notch for 19" bracket



Other Views

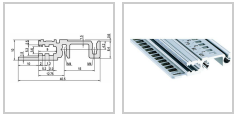

Select product specifications before modifying or adding to project list or requesting a quote.

Length-mm-defining

[Clear Selection](#)

Quantity

Add Item to Project List +

Documents

- Shock and vibration test according to IEC 48/IEC 61587
- Shock and vibration test according to Deutsche Bundesbahn standards
- Seismic test

Links

- Native CAD files

Technical Data

Length mm	1000.0
Qty	1 piece (SPQ 10)
Delivery is exclusively made in Standard Pack Quantity (SPQ)	10
Material	Aluminium extrusion
Description	Horizontal rail

Delivery Comprises:

Item	Quantity	Description
1	1	Horizontal rail, aluminium extrusion, anodised, conductive contact surfaces

Accessories

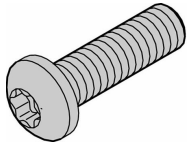

Countersunk screw, torx (M4x10), steel zinc plated, PU 100 pieces

24560-155

[Add Item to Project List +](#)

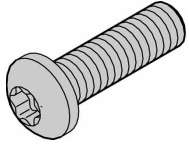

Countersunk screw, torx (M4x14), steel zinc plated, PU 100 pieces

24560-130

[Add Item to Project List +](#)

EXPLORE

[About Us](#)
[Services & Capabilities](#)
[News & Events](#)
[Newsletter Subscriptions](#)
[Strategic Partnerships](#)
[Investor Relations](#)

CONTACT

[Customer Service](#)
[Find a Sales Office or Distributor](#)
[Global Locations](#)
[Product Compliance & Certifications](#)
[Partner Login](#)

DOWNLOAD

[Download Center](#)
[Reference Projects](#)
[Videos](#)
[Product Configurators](#)
[Warranties and Terms of Sale & Procurement](#)

© 2018 nVent. All rights reserved | [Privacy Policy](#) | [Terms of Use](#) | [Cookie Policy](#) | [Imprint](#) | [Site Map](#)

Connect With Us

