

Data sheet

RT045xxUBLC Typ 205

Page 1/5

P/N
312051xx

xx=number of poles

2019/10/28

Version: X

Illustrations



Dimensional drawing

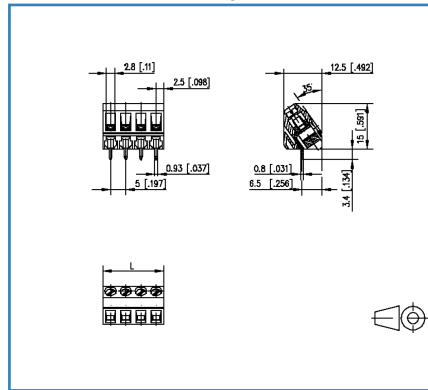

Drill pattern

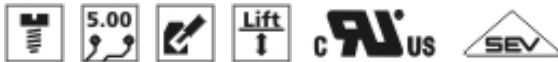
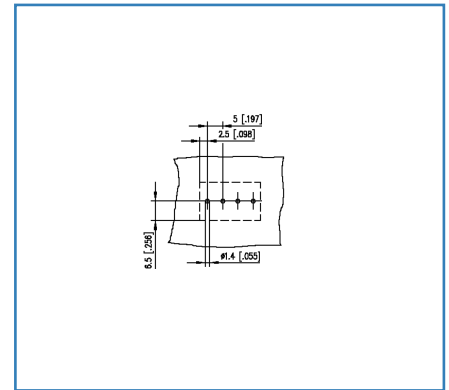



See enlarged drawings at the end of document

Product specification

- screw type terminal block, solderable
- centerline 5.00 mm, direction of connection 55°
- lift system, fittable without loss of poles
- color black

Technical Data

General Data			
Tightening torque SEV	0.5 Nm		
Tightening torque UL	6 lb-in		
Solder pin length	3.4 mm		
min. number of poles	2		
max. number of poles	24		
Insulating material class	CTI 600		
clearance/creepage dist.	3.2 mm		
protection category	IP20		
Min. insul. strip length	7 mm		
Overvoltage category	III	III	II
Pollution degree	3	2	2
Rated voltage	160 V	400 V	400 V
Rated test voltage	2.5 kV	2.5 kV	2.5 kV
Connection Data			
rat.wiring solid AWGmax	0.34 mm ² - 2.5 mm ² / AWG 28 - AWG 12		
rat.wiring strand.AWGmax	0.34 mm ² - 2.5 mm ² / AWG 28 - AWG 12		
Approvals			
extended wiring UL	2 AWG 16-18, or 1 AWG 16 stranded with 1 AWG 18 solid, or 1 AWG 16 stranded with 1 AWG 18 stranded		
 V / A / AWG	300 / 15 / 28 - 12		
approval UL - File No.	E121004		
 2.5 mm ²	250 V / 24 A / 24A / T60		
Material			
insulating material	PA66		
flammability class	V0		
contact material	CuZn		
contact surface	Ni + Sn		
terminal body material	CuZn		
terminal body surface	Ni		
screw surface	Zn Cr(VI)-frei/free		
screw thread	M3		
Glow-Wire Flammability GWFI	960 °C acc. to IEC 60695-2-12		
Glow-Wire Flammability GWIT	775 °C acc. to IEC 60695-2-13		

Data sheet
RT045xxUBLCL Typ 205

Page 3/5

P/N
312051xx

xx=number of poles

2019/10/28

Version: X

Technical Data

REACH - substance (SVHC) Lead / 7439-92-1

Climatic Data

upper limit temperature 105 °C

lower limit temperature -40 °C

General

Tolerance ISO 2768 -mH

Solderability Acc. to JEDEC JESD22-B102E 245°C/5s



Illustrations

Dimensional drawing

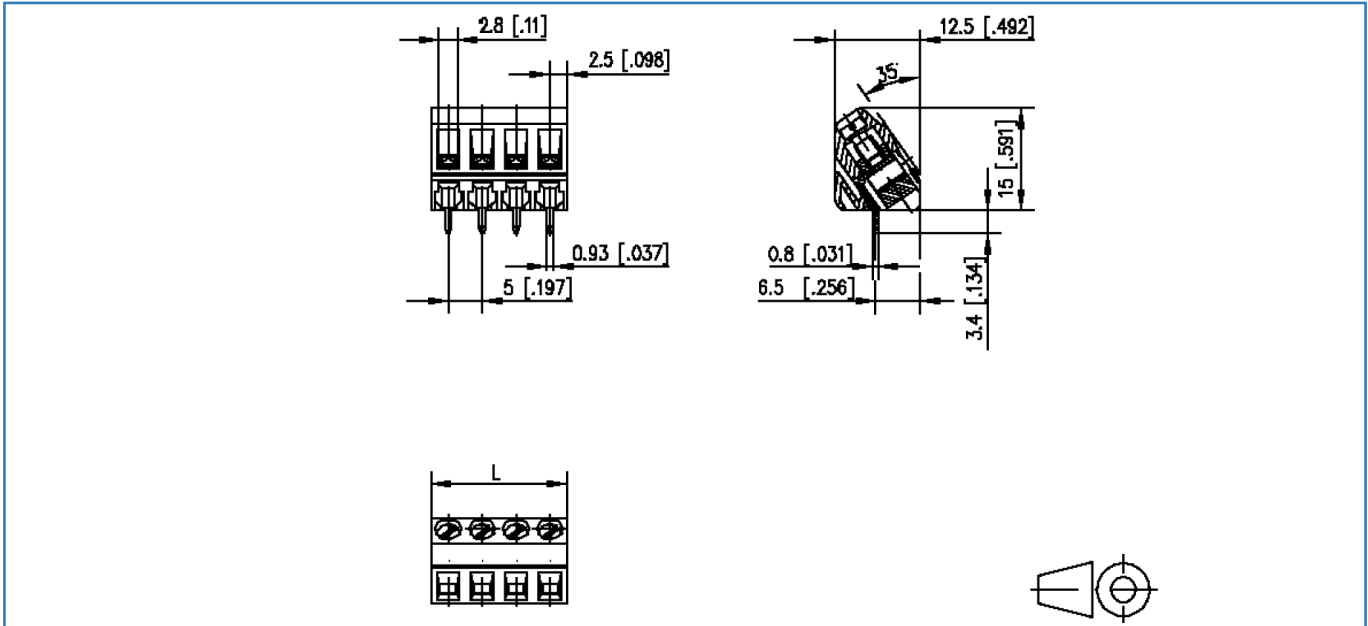

$L = (\text{pole size} - 1) \times \text{centerline} + 5 \text{ mm } [0.197]$

© 2019 METZ CONNECT - Technische Änderungen vorbehalten! Subject to modifications! Sous réserve de modifications techniques!

Illustrations

Drill pattern

