

Data sheet

RP025xxHBLC Typ 207

Page 1/5

P/N
312071xx

xx=number of poles

11/07/2018

Version: Q

Illustrations

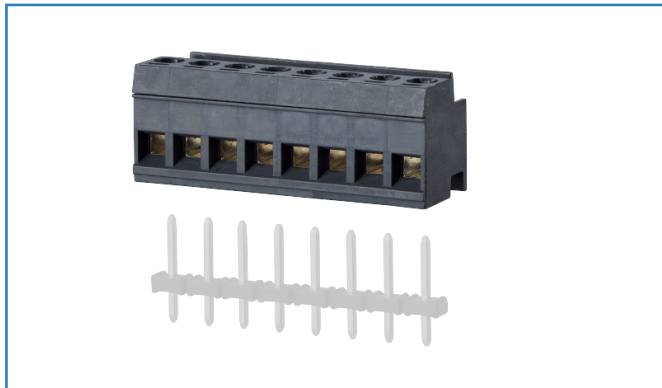

Dimensional drawing

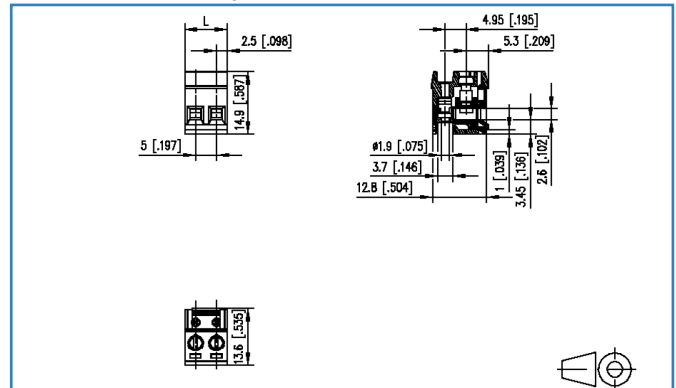

See enlarged drawings at the end of document

Product specification

- screw type terminal block, pluggable
- centerline 5.00 mm, direction of connection 90°
- lift system, fittable without loss of poles
- color black
- Wire entry perpendicular to plug direction

Technical Data



General Data

Tightening torque SEV	0.5 Nm		
Tightening torque UL	4.5 lb-in		
min. number of poles	2		
max. number of poles	24		
Insulating material class	CTI 600		
clearance/creepage dist.	3.2 mm		
Min. insul. strip length	6 mm		
Overvoltage category	III	III	II
Pollution degree	3	2	2
Rated voltage	200 V	500 V	500 V
Rated test voltage	2.5 kV	2.5 kV	2.5 kV

Connection Data

rat.wiring solid AWGmax	0.08 mm ² - 2.5 mm ² / AWG 28 - AWG 12		
rat.wiring strand.AWGmax	0.08 mm ² - 2.5 mm ² / AWG 28 - AWG 12		

Approvals

 V / A / 28	300 / 15 / 28 - 12
 2.5 mm ²	250 V / 2.5 kV / 10 A

Material

Glow-Wire Flammability GWFI	960 °C acc. to IEC 60695-2-12
Glow-Wire Flammability GWIT	775 °C acc. to IEC 60695-2-13
REACH - substance (SVHC)	Lead / 7439-92-1

Climatic Data

upper limit temperature	105 °C
lower limit temperature	-40 °C



Data sheet RP025xxHBLC Typ 207

Page 3/5

P/N
312071xx

xx=number of poles

11/07/2018

Version: Q

Accessories

P/N	Designation
720159-01-2	720159
720159-02-2	720159
750313	750313
750314	750314



Data sheet RP025xxHBLC Typ 207

Page 4/5

P/N
312071xx

xx=number of poles

11/07/2018

Version: Q

Counterpart

P/N	Designation
310481	PR055xxVBHC Typ 048



Illustrations

Dimensional drawing

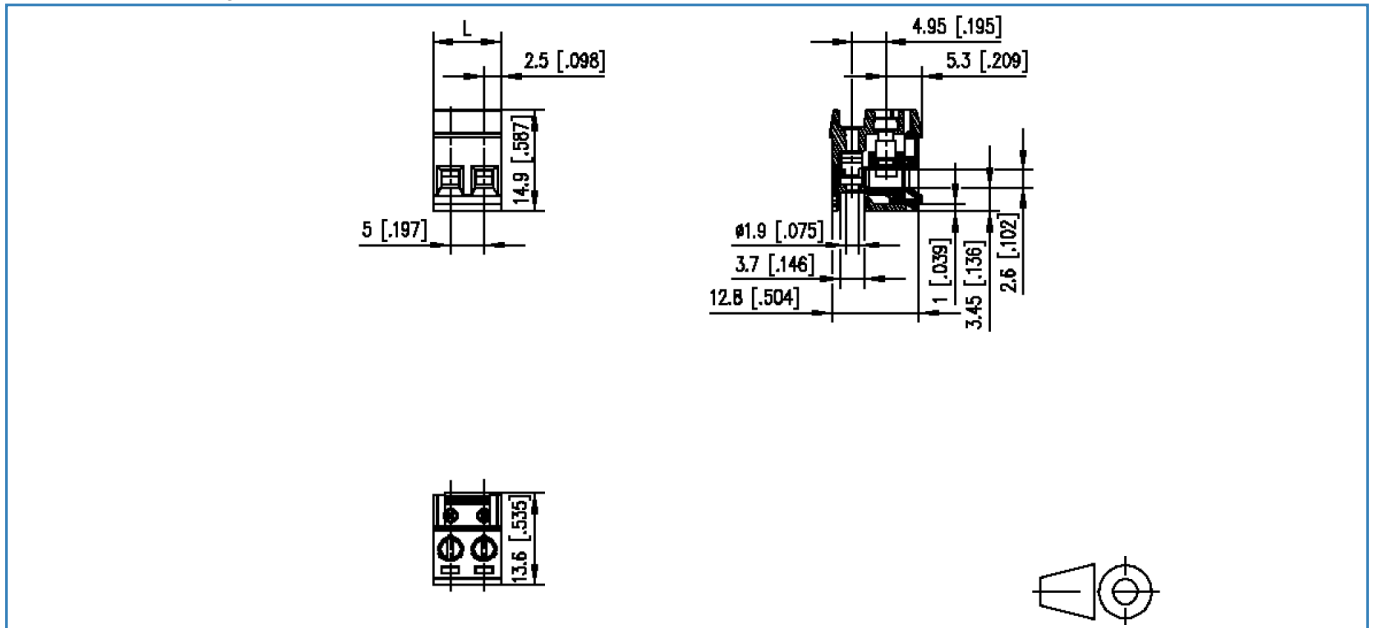

$$L = (\text{pole size} - 1) \times \text{centerline} + 5 [0.197]$$