

Data Sheet

RP016xxVBLF

Illustration

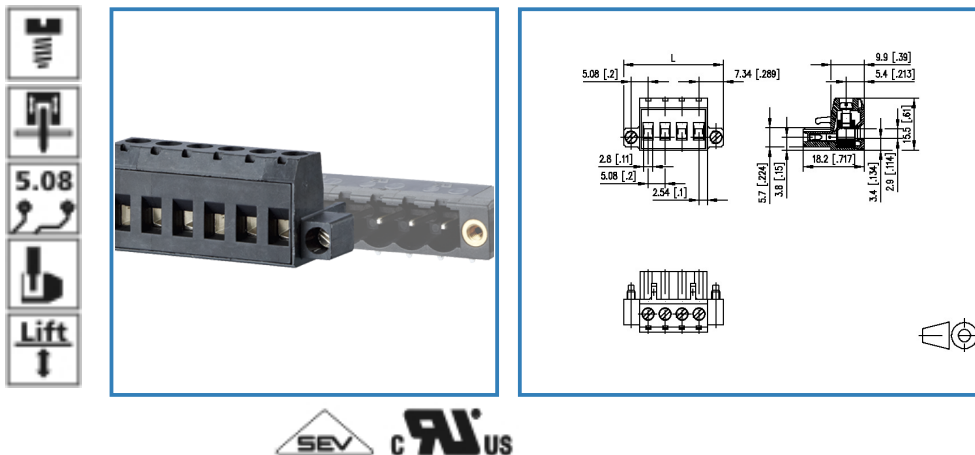

see enlarged drawing at the end of the document

Product specification

- screw type terminal block, pluggable
- centerline 5.08 mm, direction of connection vertical 0°
- lift system
- color black, mounting flange
- wire entry codeable side perpendicular to plug direction
- Connection data

cRUUS V / A / AWG 300 / 16 / 28 - 12

SEV 13.5 A / 320 V / 4 kV / 3 / IEC 61984 / 0.08 - 2.5 mm²



Data Sheet

RP016xxVBLF

Page 2/4

P/N

312511xx

xx=number of poles



2013/12/05

Technical Data

General Data

Tightening torque SEV	0.5 Nm		
Tightening torque UL	4.5 lb-in		
min. number of poles	2		
max. number of poles	24		
Insulating material class	CTI 600		
clearance/creepage dist.	3.6 mm		
protection category	IP 20		
Overvoltage category	III	III	II
Pollution degree	3	2	2
Rated voltage	250 V	630 V	630 V
Rated test voltage	4.0 kV	4.0 kV	4 kV

Connection data

 V / A / AWG	300 / 16 / 28 - 12
	13.5 A / 320 V / 4 kV / 3 / IEC 61984 / 0.08 - 2.5 mm ²

Material

insulating material	PA66
flammability class	V0
terminal body material	CuZn
terminal body surface	Ni
screw surface	Zn Cr(VI)-frei/free
screw thread	M3

Climatic properties

upper limit temperature	105 °C
lower limit temperature	-40 °C

General

Tolerance	ISO 2768 -mH
-----------	--------------



Data Sheet

RP016xxVBLF

Page 3/4

P/N

312511xx

xx=number of poles

2013/12/05

Matching Part

P/N	Product name
312351	PT116xxVBBF Typ 235
312361	PT116xxHBBF Typ 236
313981 (on request)	PR066xxHBBF

Accessories

P/N	Product name
700025-01-9	700025

Data Sheet

RP016xxVBLF

Page 4/4

P/N

312511xx

xx=number of poles

2013/12/05

Illustration

Drawing

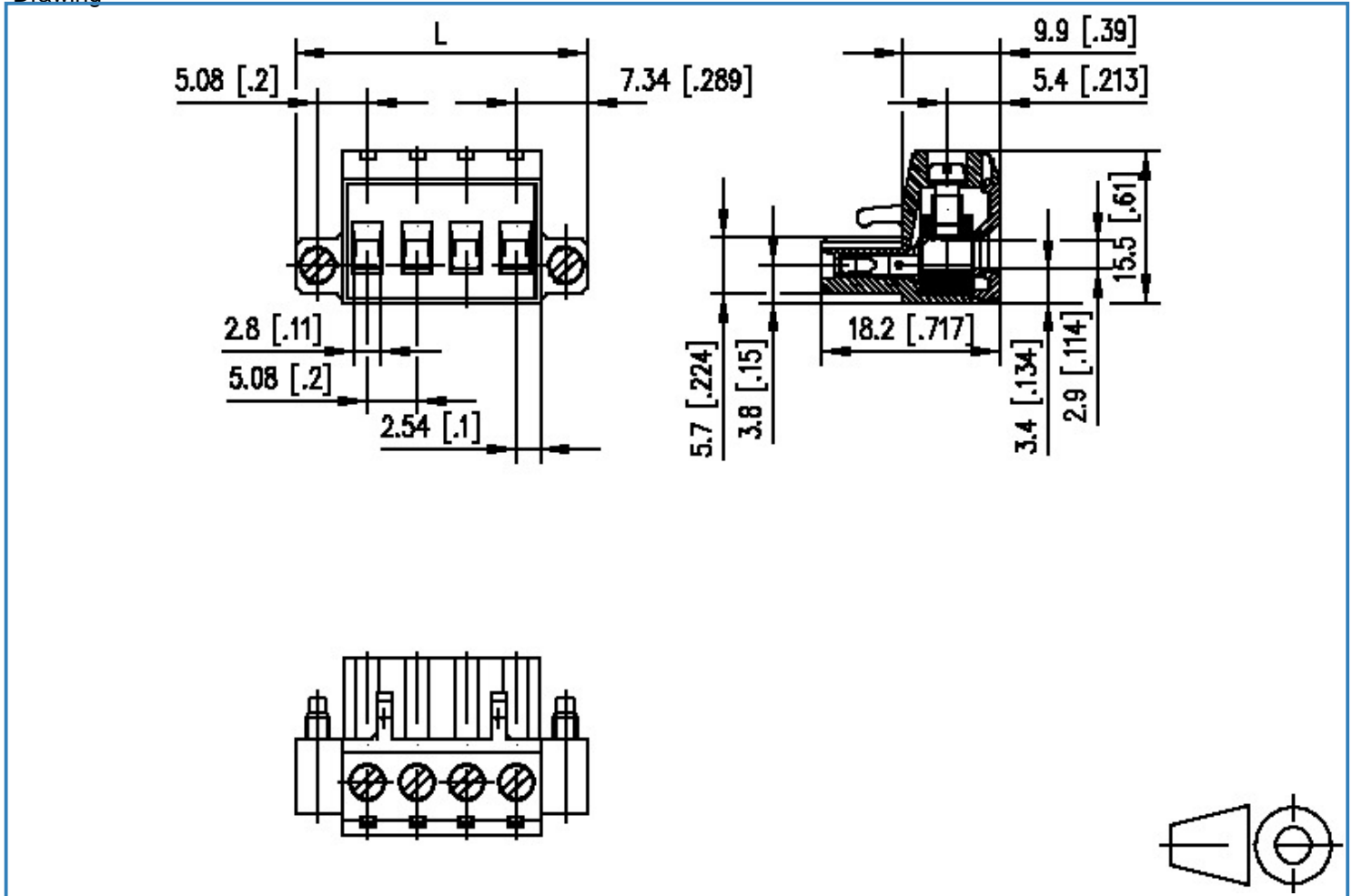

$L = (\text{pole size} - 1) \times \text{centerline} + 14.68 [0.578]$

