

Data Sheet



RT016xxHBWC

Technical Data

General Data

Tightening torque SEV	0.4 Nm		
Tightening torque UL	3.5 lb-in		
Solder pin length	3.8 mm		
min. number of poles	2		
max. number of poles	22		
Insulating material class	CTI 600		
clearance/creepage dist.	2.7 mm		
protection category	IP 10		
Overvoltage category	III	III	II
Pollution degree	3	2	2
Rated voltage	200 V	500 V	500 V
Rated test voltage	2.5 kV	2.5 kV	2.5 kV

Connection data

 V / A / AWG	300 / 15 / 28 - 14
 1.5 mm ²	130 V / 13 A / T60

Material

insulating material	PA66
flammability class	V0
terminal body material	CuZn
terminal body surface	Ni + Sn
screw surface	Zn Cr(VI)-frei/free
wire protector material	CuSn
wire protector surface	Sn
screw thread	M3

Climatic properties

upper limit temperature	105 °C
lower limit temperature	-40 °C

General

solderability	Acc. to JEDEC JESD22-B102E 245°C/5s
Tolerance	ISO 2768 -mH



Data Sheet

RT016xxHBWC

Page 3/4

P/N

311011xx

xx=number of poles

2014/06/17

Illustration

Drawing

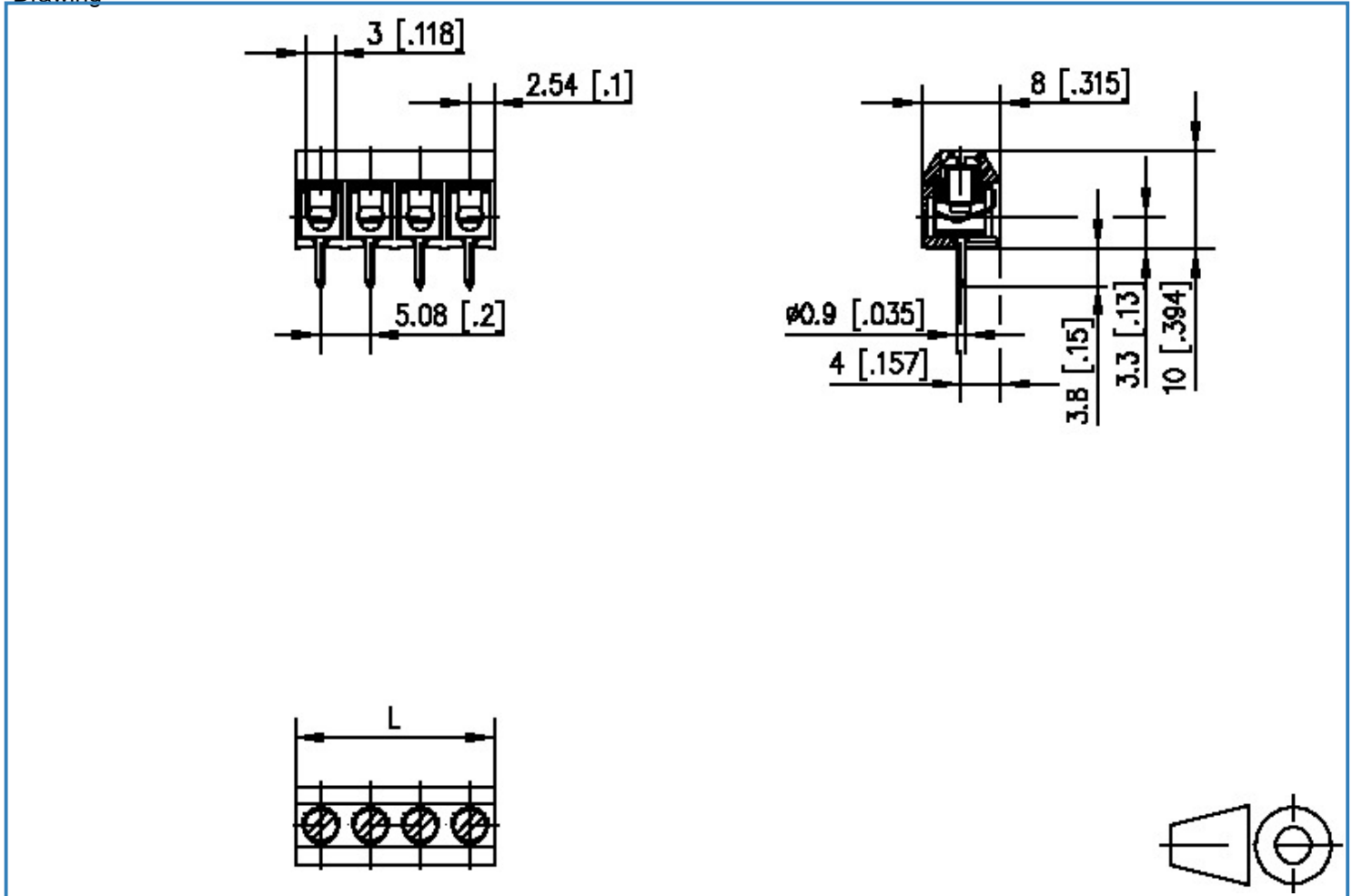

$$L = (\text{pole size} - 1) \times \text{centerline} + 5.08 [0.2]$$



Data Sheet

RT016xxHBWC

Page 4/4

P/N

311011xx

xx=number of poles

2014/06/17

PCB Layout

