

## Data sheet

### Modul 19 inch module frame 1.5RU 48 port Â stainless steel unequipped

Page 1/5

P/N

130924-00-E

EAN 4250184106203

2015-29-06

## Illustrations



Dimensional drawing

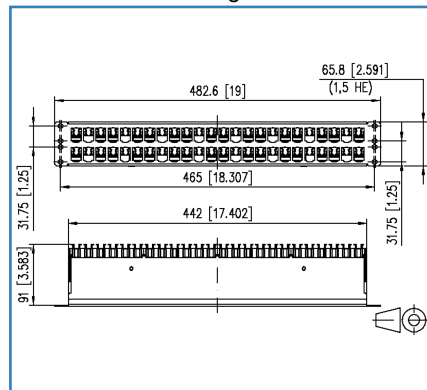

Cut-out

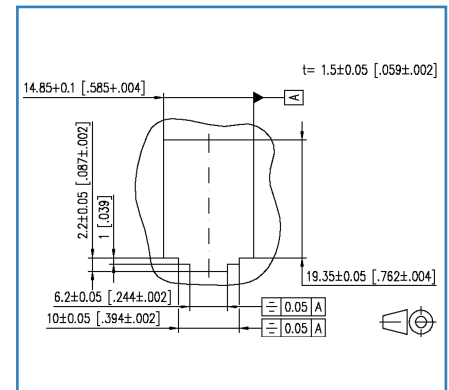

See enlarged drawings at the end of document

## Product specification

- 19 inch 1.5RU stainless steel module frame for 48 modules
- optional strain relief on patch panel using cable ties
- grounding bolt M6 x 10 with nut and lock washer
- incl. 30 cm grounding cable
- all fully shielded modules are connected by means of the stainless steel module frame
- mounting version: Modul

**Modul 19 inch module frame 1.5RU 48 port  
Â stainless steel unequipped**

P/N  
130924-00-E

EAN 4250184106203

2015-29-06

**Technical Data**

**General Data**

|                       |                           |
|-----------------------|---------------------------|
| Fields of application | Office                    |
| Design                | patch panel               |
| Color                 | stainless steel           |
| Dimensions            |                           |
| Dimension (L x W x H) | 91.00 x 482.60 x 65.80 mm |
| Dimension (L x W x H) | 3.58 x 19.00 x 2.59 in.   |
| Inches                | 19 inches                 |
| Height unit           | 1.5 HE                    |
| Modularity            | yes                       |
| Labeling option       | printed numbers           |

**Connections/interfaces**

|                                      |   |
|--------------------------------------|---|
| Number of ports interface 1          | 48  |
| Number of equipped ports interface 1 | 0   |
| Number of ports interface 2          | 48  |
| Number of ports interface 2 equipped | 0   |
| Grounding wire length                | 0.30 m  |
| Grounding wire length                | 0.98 ft                                       |
| Ground connection                    | grounding bolt M6x10 with nut and lock washer |

**Mechanical characteristics**

|         |       |
|---------|-------|
| Cut-out | Modul |
|---------|-------|

**Materials and material properties**

|                           |                 |
|---------------------------|-----------------|
| Material - Module support | stainless steel |
| Material - Cable guide    | ABS             |

**Environmental conditions**

|                            |              |
|----------------------------|--------------|
| Temperature (min. - max.)  |              |
| Temperature - Storage °C   | -40 - 70 °C  |
| Temperature - Storage °F   | -40 - 158 °F |
| Temperature - Operating °C | -40 - 70 °C  |
| Temperature - Operating °F | -40 - 158 °F |



Data sheet

Page 3/5

**Modul 19 inch module frame 1.5RU 48 port  
Â stainless steel unequipped**

P/N  
130924-00-E

EAN 4250184106203

2015-29-06

**Technical Data**

**Certifications**

Gost Certification yes

**Approvals**

RoHS compliant

**Classifications**

ETIM 5.0 EC001128

**Packing details**

|                                 |                            |
|---------------------------------|----------------------------|
| Type of packaging               | 1 pc(s) / box              |
| Packaging unit - Weight (gram)  | 1435.00 g                  |
| Packaging unit - Weight (pound) | 3.16 lb                    |
| Packaging dimension (W x H x D) | 540.00 x 165.00 x 65.00 mm |
| Packaging dimension (W x H x D) | 21.26 x 6.50 x 2.56 in.    |

© 2015 METZ CONNECT - Technische Änderungen vorbehalten! Subject to modifications! Sous réserve de modifications techniques!



Data sheet

Page 4/5

**Modul 19 inch module frame 1.5RU 48 port  
Â stainless steel unequipped**

P/N  
130924-00-E

EAN 4250184106203

2015-29-06

**Accessories**

| P/N    | Designation                |
|--------|----------------------------|
| 130792 | Mounting kit, cage nuts M6 |

Data sheet

**Modul 19 inch module frame 1.5RU 48 port  
Â stainless steel unequipped**

P/N  
130924-00-E

EAN 4250184106203

2015-29-06

Illustrations

Dimensional drawing

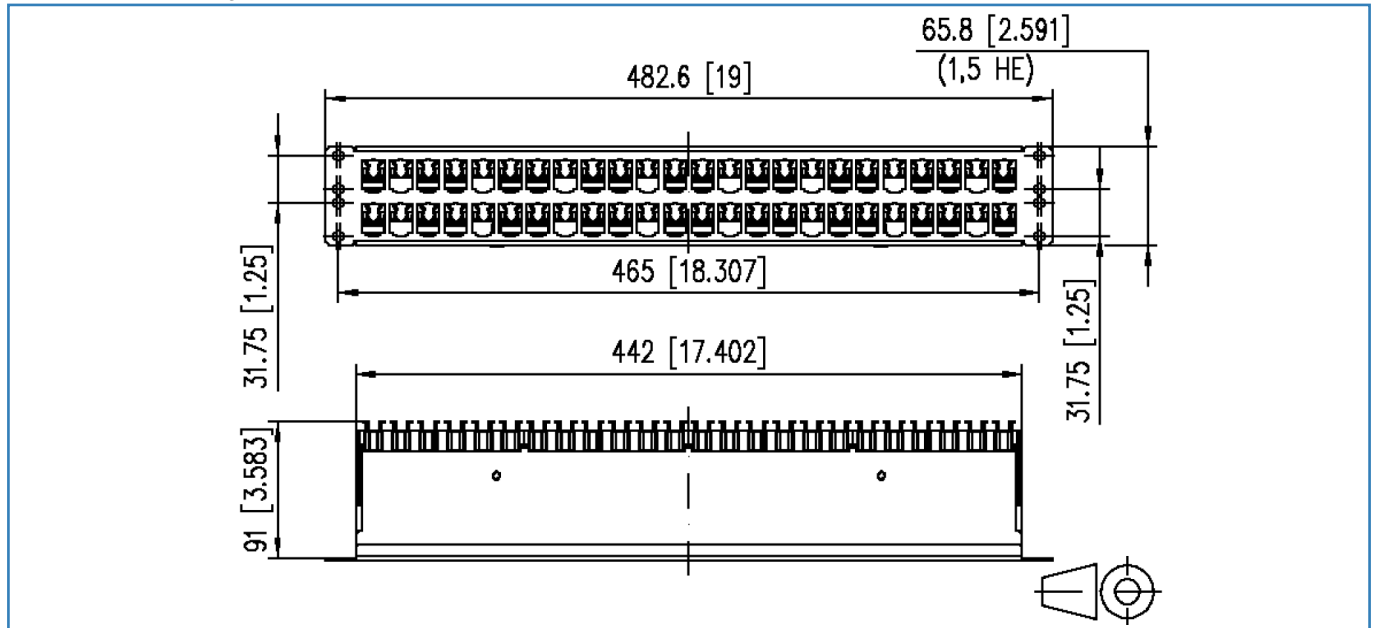

Cut-out

