

Data sheet

Modul surface mount housing 6 port pure white

Page 1/5

P/N

130861-0602-E

EAN 4250184115069

2015-29-06

Illustrations



Dimensional drawing

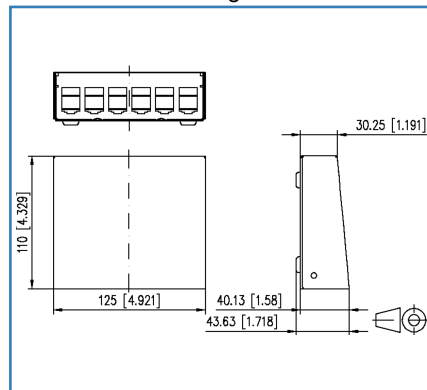

Cut-out

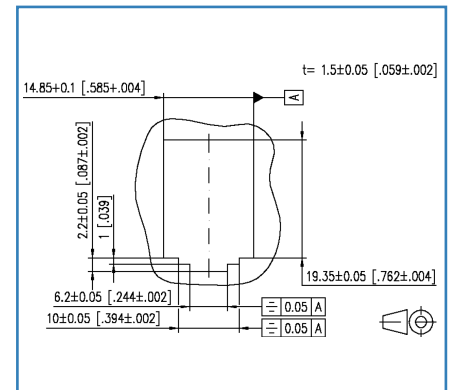

See enlarged drawings at the end of document

Product specification

- surface-mounted, unequipped module housing for individual modules in modul design
- solid steel sheet housing
- upper part of the housing powder-coated in RAL 9010
- upper part of the housing can be put on and removed easily because no screws are used for fastening
- equipotential bonding possible by means of contact pin
- additional strain relief on lower part of housing using cable ties
- suitable for direct wall mounting, as desktop device and for DIN-rail mounting using the DIN rail adapter mini FS
- bottom of the 3-port and 4-port housing can be removed. Additional fastening by means of 60 mm fastening clearance.
- optionally available and fits in all housings: mini splice tray
- optionally available 2 x 12 housing: Strain relief for patch cords 130861-24ZE-E
- variants: 3, 4, 6, 8, 12, 16 and 2 x 12 ports



Modul surface mount housing 6 port pure white

P/N

130861-0602-E

EAN 4250184115069

2015-29-06

Technical Data

General Data

| | |
|-----------------------|----------------------------|
| Fields of application | Office |
| Design | patch panel |
| Color | pure white |
| Dimensions | |
| Dimension (L x W x H) | 110.00 x 125.00 x 43.63 mm |
| Dimension (L x W x H) | 4.33 x 4.92 x 1.72 in. |
| Modularity | yes |
| Labeling option | on housing |

Connections/interfaces

| | |
|--------------------------------------|---|
| Number of ports interface 1 | 6 |
| Number of equipped ports interface 1 | 0 |
| Number of ports interface 2 | 6 |
| Number of ports interface 2 equipped | 0 |

Mechanical characteristics

| | |
|---------------|-----------|
| Cut-out | Modul |
| Strain relief | cable tie |

Materials and material properties

| | |
|------------------------|----------------------|
| Material - Housing | aluminium-zinc sheet |
| Material - Front cover | aluminium-zinc sheet |
| Material - Cover | steel |

Environmental conditions

| | |
|----------------------------|--------------|
| Temperature (min. - max.) | |
| Temperature - Storage °C | -40 - 70 °C |
| Temperature - Storage °F | -40 - 158 °F |
| Temperature - Operating °C | -40 - 70 °C |
| Temperature - Operating °F | -40 - 158 °F |



Modul surface mount housing 6 port pure white

P/N

130861-0602-E

EAN 4250184115069

2015-29-06

Technical Data

Certifications

Gost Certification yes

Approvals

RoHS compliant

Classifications

ETIM 5.0 EC001128

Packing details

| | |
|---------------------------------|----------------------------|
| Type of packaging | 1 pc(s) / box |
| Packaging unit - Weight (gram) | 316.00 g |
| Packaging unit - Weight (pound) | 0.70 lb |
| Packaging dimension (W x H x D) | 135.00 x 133.00 x 52.00 mm |
| Packaging dimension (W x H x D) | 5.31 x 5.24 x 2.05 in. |



Data sheet

Page 4/5

Modul surface mount housing 6 port pure white

P/N

130861-0602-E

EAN 4250184115069

2015-29-06

Accessories

| P/N | Designation |
|--------------|---|
| 130861-MSK-E | FO extension set for module surface mount housing |



Illustrations

Dimensional drawing

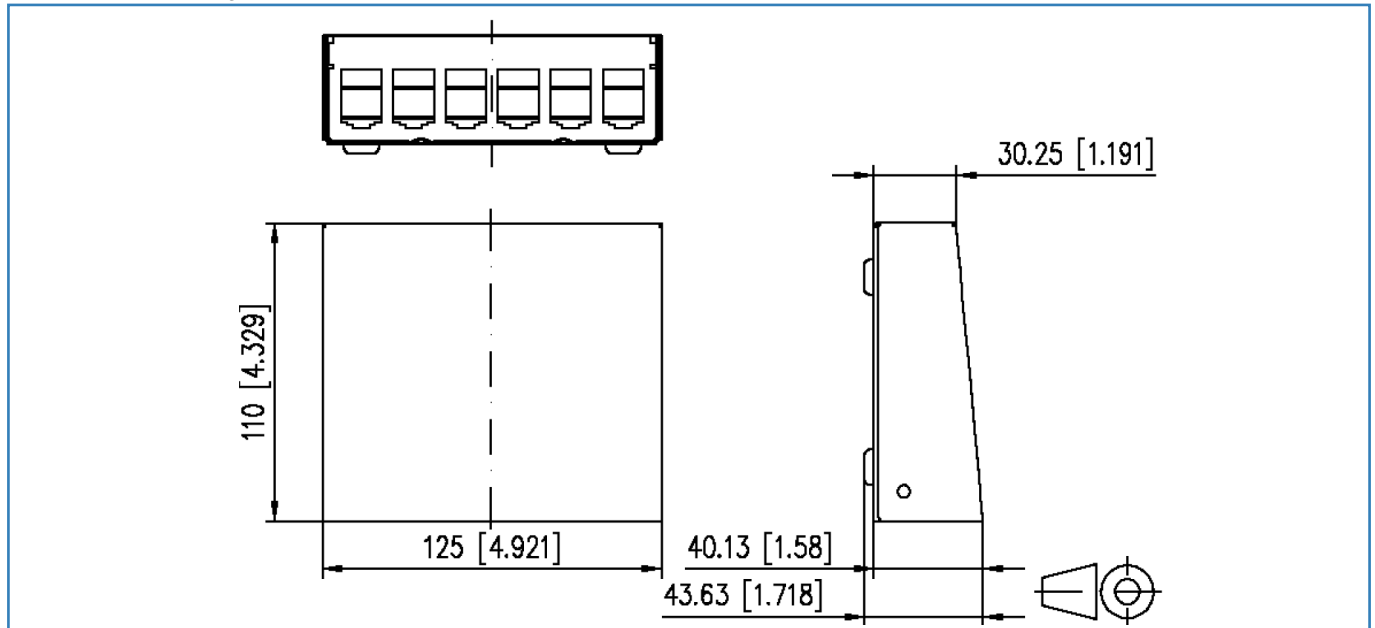

Cut-out

