

THREAD
#6-32 UNC

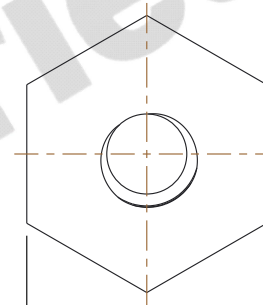

0.313 ± 0.006
[7.94 ± 0.15]
HEX.

NOTES:

1. Material: Aluminum alloy-6061-T6 (AMS4117) (UNS A96061),
2024-T4 (AMS-QQ-A-225/6 (UNS A92024),
or 2011)-T4 (ASTM B211) (UNS A92011)
2. Finish: Chemical conversion coat (MIL-DTL-5541), Class 3
3. All Drawing Dimensions are in Inches [mm]
4. Unless otherwise specified, Edge Breaks, Radii or Countersinks 0.005-0.015
5. All features in accordance with NAS1831

COMPONENT FEMALE FEMALE STANDOFF



MW Industries

95 Silvermine Rd., Seymour CT 06483
Tel: 203-888-2133, Fax: 203-888-9860

This Drawing is the Property of MW Industries. It contains confidential, proprietary information that is MW Industries property. Do not disclose to or duplicate for others except as authorized by MW Industries.

TOLERANCES
ALL DIMENSIONS ARE INCHES
(UNLESS OTHERWISE SPECIFIED)
METALLIC
LENGTHS < 6 INCHES ± 0.005
LENGTH > 6 INCHES ± 0.010
DIAMETERS: ± 0.005
NON-METALLIC
LENGTH: ± 0.010 DIAMETERS: ± 0.010
INTERNAL THREADS:
MINIMUM THREAD DEPTH

NAS1831AC5C08

5/16 Female Female Standoff

SCALE	REV
4.00	04
SHEET	
1 of 1	