

THIS COPY IS PROVIDED ON A RESTRICTED BASIS AND IS NOT TO BE USED IN ANY WAY DETRIMENTAL TO THE INTERESTS OF PANDUIT CORP.

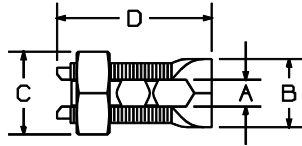

NOTES:

- HIGH STRENGTH COPPER ALLOY HIGHLY RESISTANT TO CORROSION AND SEASON CRACKING.
- ELECTRO-TIN PLATED BOLT, NUT SPACER AND PRESSURE BAR.
- WHEN CONNECTING ALUMINUM OR ACSR WIRE, USE OF PANDUIT OXIDE JOINT COMPOUND CMP-100 IS RECOMMENDED.
- UL LISTED & CSA CERTIFIED (FOR APPLICABLE PARTS) WITH COPPER AND ALUMINUM CABLE
- MADE IN THE U.S.A.

CATALOG NUMBER	COPPER AND ALUMINUM			MAX. CONDUCTOR		ACSR		GUY Str.	WIRE DIAMETER RANGE	APPROXIMATE DIMENSIONS (IN INCHES)				RECOMMENDED TORQUE (IN.-LB.)
	RANGE OF EQUAL MAIN AND TAP		MIN. TAP WITH ONE MAX. MAIN	COPPERWELD		RANGE OF MAIN OR TAP								
	MIN.	MAX.		STR.	TYPE A	MIN.	MAX.			IN	IN	A	B	
SBCT8-C	14 Str.	8 Str.	14 Str.	--	--	--	8	5/32	.073-.146	.16	.49	.62	1.10	165
SBCT6-C	10 Str.	6 Str.	10 Sol.	3 No.12	8A	--	6	7/32	.116-.184	.21	.56	.68	1.28	165
SBCT3-C	8 Sol.	3 Str.	8 Sol.	3 No.9	5A	6	4	1/4	.128-.258	.32	.69	.80	1.55	275
SBCT2-C	8 Sol.	2 Str.	8 Sol.	3 No.7	3A	6	2	5/16	.128-.316	.33	.69	.80	1.54	275

CATALOG NUMBER	COPPER CONDUCTOR			ALUMINUM RANGE NOT U.L. LISTED OR CSA CERTIFIED		COPPERWELD	WIRE DIAMETER RANGE	APPROXIMATE DIMENSIONS (IN INCHES)				RECOMMENDED TORQUE (IN.-LB.)
	RANGE OF EQUAL MAIN AND TAP		MIN. TAP WITH ONE MAX. MAIN	ALUMINUM	ACSR							
	MIN.	MAX.				MAX Str.	IN	A	B	C	D	
SBCT10-C	16 Str.	10 Str.	16 Str.	16 Str.-10 Str.	--	--	.057-.116	.15	.38	.49	.87	80
SBCT10-L	6 Sol.	1/0 Str.	10 Sol.	6 Sol.-1/0 Str.	6-1	3 No. 6	.162-.375	.38	.75	.86	1.63	385
SBCT20-0	6 Str.	2/0 Str.	10 Sol.	6 Str.-2/0 Str.	6-1/0	3 No. 5	.184-.419	.42	.82	.99	1.82	385
SBCT30-0	4 Str.	3/0 Str.	6 Sol.	4 Str.-3/0 Str.	6-2/0	7 No. 7	.198-.470	.47	.88	1.12	2.01	500
SBCT250-0	4 Str.	250 MCM	4 Str.	4 Str.-250 MCM	4-4/0	7 No. 5	.232-.575	.58	1.00	1.27	1.37	650
SBCT350-1	3/0 Str.	350 MCM	1 Sol.	3/0 Str.-350 MCM	2/0-350	19 No. 7	.447-.682	.76	1.50	1.63	2.57	650
SBCT500-1	3/0 Str.	500 MCM	1/0 Str.	3/0 Str.-500 MCM	2/0-477 1B/1	19 No. 6	.447-.815	.83	1.65	1.81	3.00	825
SBCT750-1	250 MCM	750 MCM	2/0 Str.	250 - 750 MCM	4/0-666.6	19 No. 5	.563-.999	1.03	1.93	2.11	3.78	1000
SBCT1000-1	350 MCM	1000 MCM	4/0 Str.	350 - 1000 MCM	300-900	--	.682-1.162	1.23	2.29	2.53	4.02	1100

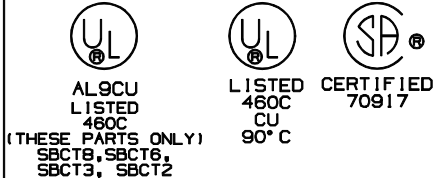

CIG FILENAME/LAYERS										C41212_00						
PANDUIT										CORP TINLEY PARK, ILLINOIS						
										COPPER DUAL RATED SPLIT BOLT CONNECTOR CUSTOMER DRAWING						
UNLESS OTHERWISE SPECIFIED, DIMENSIONAL TOLERANCES ARE 1										UNLESS OTHERWISE SPECIFIED, ALL DIMENSIONS ARE GIVEN IN INCHES, THIRD ANGLE PROJECTION						
DRAWN BY T.S.M.A.										SCALE NONE						
DATE 3/25/97										DRAWING NO. C41212						
REV 00 3/97 TM										DWG SIZE B						
RELEASED										SEE NOTES						
REV	DATE	BY	CHK	DESCRIPTION						ECN	R	CUST	SUP	GMSH	DWG	SIZE