

HEAVYCON

Standard Housings, HV Series

1. Short Description

HEAVYCON plug connectors are just as common in measurement and control engineering as in mechanical and plant engineering. They are responsible for both power supply and control. Another sector in which they are often to be found is in lighting and stage engineering.

HEAVYCON plug connectors also act as the interface for PCs or diagnostics equipment to transfer operating data or monitoring signals during system operation.

The HEAVYCON housings are divided into:

- **Permanently installed housings**
- Box mounting base with one or two cable entries
- Panel mounting base with an aperture in the floor for control cabinet mounting
- **Free housings**
- Sleeve housings
- Coupling housings

The user can choose between a variety of different housing heights. On the one hand, in order to be able to provide a sufficiently large connection space for large conductor cross sections, and on the other hand, the large connection space with its bigger surface area dissipates the heat loss generated.

Double width HEAVYCON housings (Design B 32 and B 48) for universal applications allow two contact inserts to be accommodated in one housing.

If several plug connectors are mounted close together, it may be difficult to operate the locking latch due to the constricted space. For this reason, there are housings with single or double locking latches. This guarantees convenient handling and perfect operation even in inaccessible spots.



Type description

HEAVYCON	HC - HV	10 - T	FL - 45 / M	1	PG16	G
Type HV						
No. of positions	10					
T	= Sleeve housing					
A	= Panel mounting base					
S	= Box mounting base					
K	= Coupling housing					
FL	= For single locking latches,					
FQ	= For double locking latches,					
ML	= with single locking latches,					
MQ	= with double locking latches,					
D	= with cover					
Housing height h in mm						
M	= with gland					
O	= without gland					
Number of glands						
PG	= PG cable gland,					
M	= Metric gland					
G	= straight,					
S	= lateral					
V	= front					

HV 3 Series, Sleeve Housing, with PG Cable Gland



Description	Height h [mm]	Cable gland	Cable exit	Type	Order No.	Pcs./Pkt.
Sleeve housing, for single locking latch	45	PG 16	straight	HC-HV 3-TFL-45/M1PG16G	17 73 51 4	10
Sleeve housing, for double locking latch	52	PG 16	lateral	HC-HV 3-TFL-52/M1PG16S	17 73 50 1	10
Sleeve housing, for double locking latch	52	PG 16	lateral	HC-HV 3-TFQ-52/M1PG16S	17 73 52 7	10
Sleeve housing, with double locking latch	48	PG 16	lateral	HC-HV 3-TMQ-48/M1PG16S	17 73 54 3	10

Technical data

Degree of protection

IP 65

Materials

aluminum die cast, powder-coated, gray
high-grade steel, handle: PA-GF

Housing

Double locking latch

Ambient temperature

[°C]

- 40 to +125

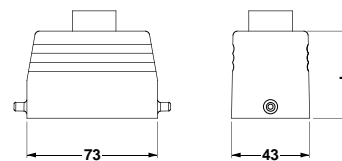

HC-HV 3 TFL...

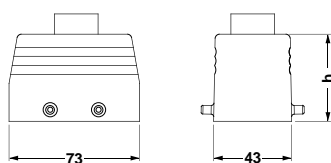

HC-HV 3 TFQ...

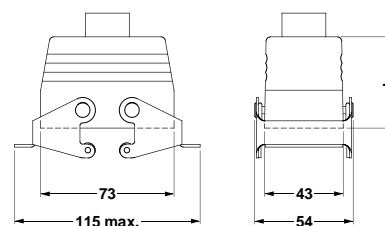

HC-HV 3 TMQ...

HV 3 Series, Sleeve Housing, for Metric Glands



Description	Height h [mm]	Cable gland	Cable exit	Type	Order No.	Pcs./Pkt.
Sleeve housing, for single locking latch	52	M 25	lateral	HC-HV 3-TFL-52/O1M25S	16 04 93 0	10
Sleeve housing, for double locking latch	45	M 25	straight	HC-HV 3-TFQ-45/O1M25G	16 04 93 1	10

Technical data

Degree of protection

IP 65

Materials

Housing

aluminum die cast, powder-coated, gray

Ambient temperature

[°C]

- 40 to +125

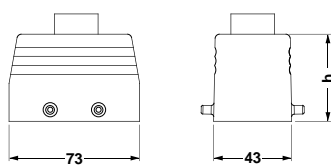

HC-HV 3 TFQ...

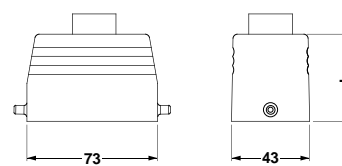

HC-HV 3 TFL...

HV 3 Series, Panel Mounting Base



Description	Height h [mm]	Cable gland	Protective cover	Type	Order No.	Pcs./Pkt.
Panel mounting base, with single locking latch	27	–	no	HC-HV 3-AML	17 73 56 9	10
	27	–	yes	HC-HV 3-AMLD	17 73 57 2	
Panel mounting base, with double locking latch	27	–	no	HC-HV 3-AMQ	17 73 58 5	10
Panel mounting base, for double locking latch	27	–	yes	HC-HV 3-AFQD	17 73 59 8	10

Technical data

Degree of protection

IP 65

Materials

aluminum die cast, powder-coated, gray

Housing

NBR

Sealing

Single locking latch

zinc-plated steel and passivated

Double locking latch

high-grade steel, handle: PA-GF

Ambient temperature

[°C]

– 40 to +125

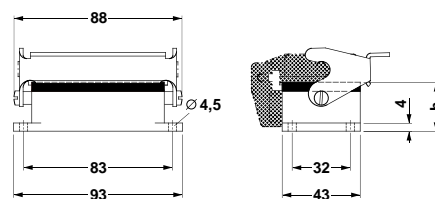

HC-HV 3 AML...

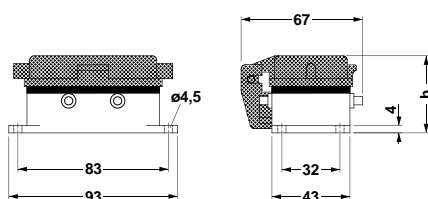

HC-HV 3 AFQ...

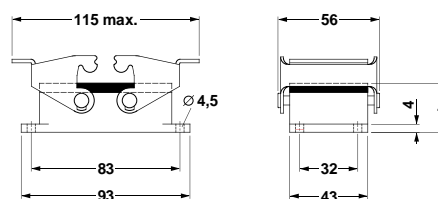

HC-HV 3 AMQ...

HV 3 Series, Box Mounting Base, with PG Cable Gland



Description	Height h [mm]	Cable gland	Protective cover	Type	Order No.	Pcs./Pkt.
Box mounting base, with single locking latch	52	PG 16	no	HC-HV 3-SML-52/M1PG16	17 73 60 8	10
	52	2 x PG 16	yes	HC-HV 3-SMLD-52/M2PG16	17 73 63 7	
Box mounting base, with double locking latch	52	PG 16	no	HC-HV 3-SMQ-52/M1PG16	17 73 64 0	10
Box mounting base, for double locking latch	52	PG 16	yes	HC-HV 3-SFQD-52/M1PG16	17 73 66 6	10

Technical data

Degree of protection

IP 65

Materials

aluminum die cast, powder-coated, gray

Housing

NBR

Sealing

zinc-plated steel and passivated

Single locking latch

high-grade steel, handle: PA-GF

Double locking latch

Ambient temperature

[°C]

- 40 to +125

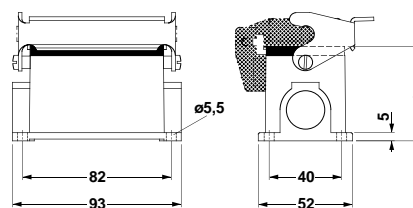

HC-HV 3 SML(D)...

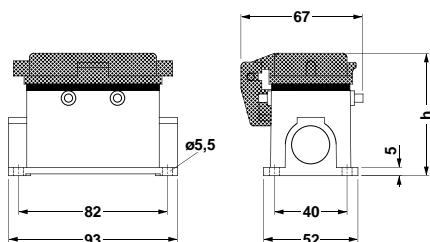

HC-HV 3 SFQD...

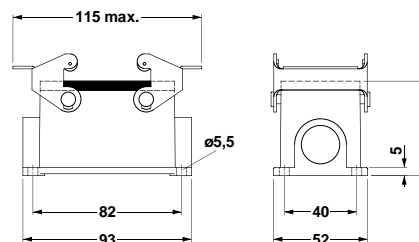

HC-HV 3 SMQ...

HV 3 Series, Box Mounting Base, for Metric Glands



Description	Height h [mm]	Cable gland	Protective cover	Type	Order No.	Pcs./Pkt.
Box mounting base, with single locking latch	52	M 25	no	HC-HV 3-SML-52/O1M25	16 04 92 7	10
Box mounting base, with double locking latch	52	M 25	yes	HC-HV 3-SMLD-52/O1M25	16 04 92 8	10
Box mounting base, with double locking latch	52	M 25	no	HC-HV 3-SMQ-52/O1M25	16 04 92 9	10
Box mounting base, for double locking latch	52	M 25	yes	HC-HV 3-SFQD-52/O1M25	16 04 92 6	10

Technical data

Degree of protection

IP 65

Materials

aluminum die cast, powder-coated, gray

Housing

NBR

Sealing

Single locking latch

zinc-plated steel and passivated

Double locking latch

high-grade steel, handle: PA-GF

Ambient temperature

[°C]

- 40 to +125

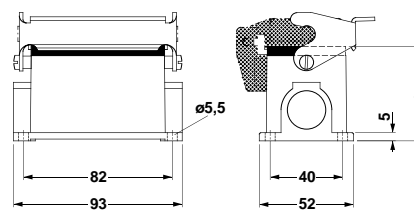

HC-HV 3 SML(D)...

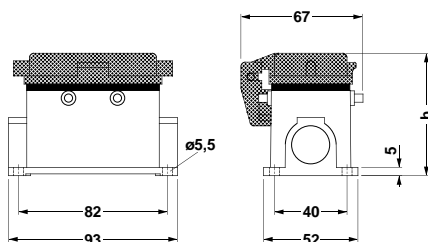

HC-HV 3 SFQD...

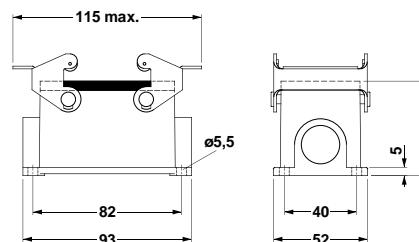

HC-HV 3 SMQ...

HV 3 Series, Coupling Housing, with PG Cable Gland



Description	Height h [mm]	Cable gland	Protective cover	Type	Order No.	Pcs./Pkt.
Coupling housing, with single locking latch	52	PG 16	no	HC-HV 3-KML-52/M1PG16	17 73 69 5	10
Coupling housing, with double locking latch	52	PG 16	no	HC-HV 3-KMQ-52/M1PG16	17 73 68 2	10

Technical data

Degree of protection

IP 65

Materials

Housing

aluminum die cast, powder-coated, gray

Sealing

NBR

Single locking latch

zinc-plated steel and passivated

Double locking latch

high-grade steel, handle: PA-GF

Ambient temperature

[°C]

- 40 to +125

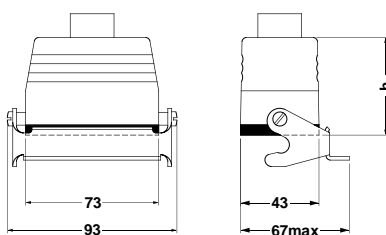

HC-HV 3 KML...

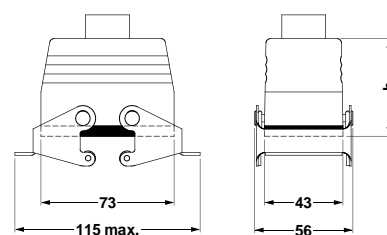

HC-HV 3 KMQ...

HV 3 Series, Coupling Housing, for Metric Glands



Description	Height h [mm]	Cable gland	Protective cover	Type	Order No.	Pcs./Pkt.
Coupling housing, with single locking latch	52	M 25	no	HC-HV 3-KML-52/O1M25	16 04 92 2	10
Coupling housing, with double locking latch	52	M 25	no	HC-HV 3-KMQ-52/O1M25	16 04 92 4	10

Technical data

Degree of protection

IP 65

Materials

Housing

aluminum die cast, powder-coated, gray

Sealing

NBR

Single locking latch

zinc-plated steel and passivated

Double locking latch

high-grade steel, handle: PA-GF

Ambient temperature

[°C]

- 40 to +125

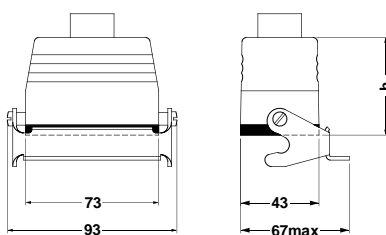

HC-HV 3 KML...

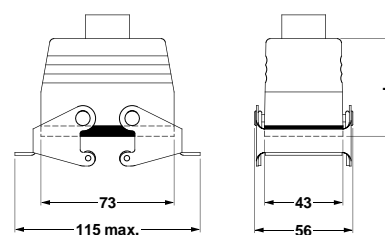

HC-HV 3 KMQ...

HV 6 Series, Sleeve Housing, with PG Cable Gland



Description	Height h [mm]	Cable gland	Cable exit	Type	Order No.	Pcs./Pkt.
Sleeve housing, for single locking latch	60	PG 21	lateral	HC-HV 6-TFL-60/M1PG21S	17 73 70 5	10
Sleeve housing, for double locking latch	45 65	PG 21 PG 21	straight lateral	HC-HV 6-TFQ-45/M1PG21G HC-HV 6-TFQ-65/M1PG21S	17 73 73 4 17 73 72 1	10
Sleeve housing, with double locking latch	65	PG 21	lateral	HC-HV 6-TMQ-65/M1PG21S	17 73 74 7	10

Technical data

Degree of protection

IP 65

Materials

aluminum die cast, powder-coated, gray
high-grade steel, handle: PA-GF

Housing

Double locking latch

Ambient temperature

[°C]

- 40 to +125

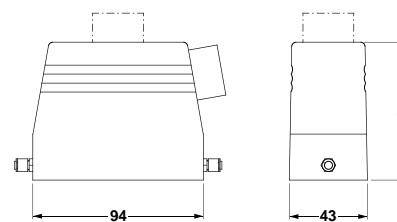

HC-HV 6 TFL...

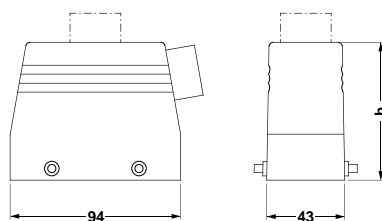

HC-HV 6 TFQ...

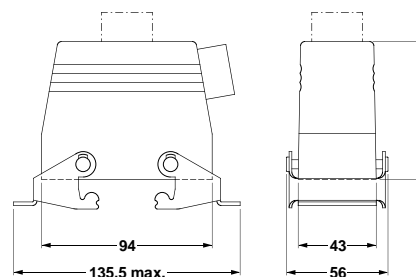

HC-HV 6 TMQ...

HV 6 Series, Sleeve Housing, for Metric Glands



Description	Height h [mm]	Cable gland	Cable exit	Type	Order No.	Pcs./Pkt.
Sleeve housing, for single locking latch	60	M 25	lateral	HC-HV 6-TFL-60/O1M25S	16 04 93 4	10
Sleeve housing, for double locking latch	45	M 25	straight	HC-HV 6-TFQ-45/O1M25G	16 04 93 5	10
	60	M 25	lateral	HC-HV 6-TFQ-60/O1M25S	16 04 93 6	
Technical data						
Degree of protection				IP 65		
Materials				aluminum die cast, powder-coated, gray		
Housing						
Ambient temperature	[°C]			- 40 to +125		

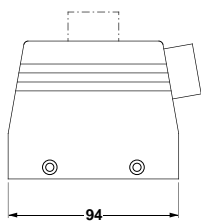

HC-HV 6 TFQ...

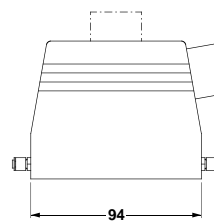
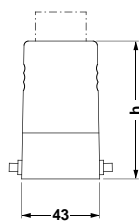

HC-HV 6 TFL...

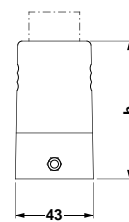

HV 6 Series, Panel Mounting Base



Description	Height h [mm]	Cable gland	Protective cover	Type	Order No.	Pcs./Pkt.
Panel mounting base, with single locking latch	27	–	no	HC-HV 6-AML	17 73 76 3	10
	27	–	yes	HC-HV 6-AMLD	17 73 77 6	
Panel mounting base, with double locking latch	27	–	no	HC-HV 6-AMQ	17 73 78 9	10
Panel mounting base, for double locking latch	27	–	yes	HC-HV 6-AFQD	17 73 79 2	10

Technical data

Degree of protection

IP 65

Materials

aluminum die cast, powder-coated, gray

Housing

NBR

Sealing

zinc-plated steel and passivated

Single locking latch

high-grade steel, handle: PA-GF

Double locking latch

Ambient temperature

[°C]

– 40 to +125

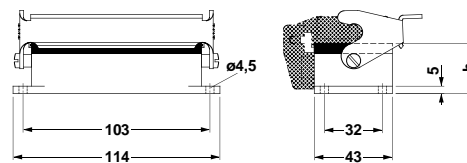

HC-HV 6 AML(D)...

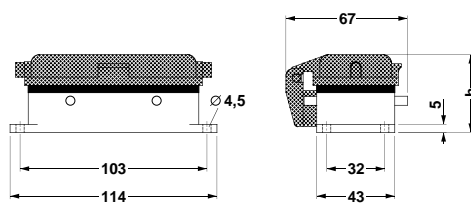

HC-HV 6 AFQD...

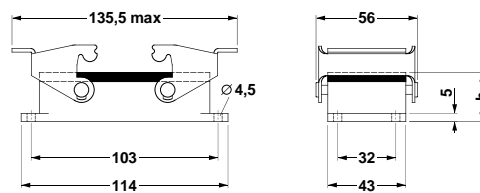

HC-HV 6 AMQ...

HV 6 Series, Box Mounting Base, with PG Cable Gland



Description	Height h [mm]	Cable gland	Protective cover	Type	Order No.	Pcs./Pkt.
Box mounting base, with single locking latch	67	PG 21	no	HC-HV 6-SML-67/M1PG21	17 73 80 2	10
	67	PG 21	yes	HC-HV 6-SMLD-67/M1PG21	17 73 82 8	
Box mounting base, with double locking latch	67	PG 21	no	HC-HV 6-SMQ-67/M1PG21	17 73 84 4	10

Technical data

Degree of protection

IP 65

Materials

Housing

aluminum die cast, powder-coated, gray

Sealing

NBR

Single locking latch

zinc-plated steel and passivated

Double locking latch

high-grade steel, handle: PA-GF

Ambient temperature

[°C]

- 40 to +125

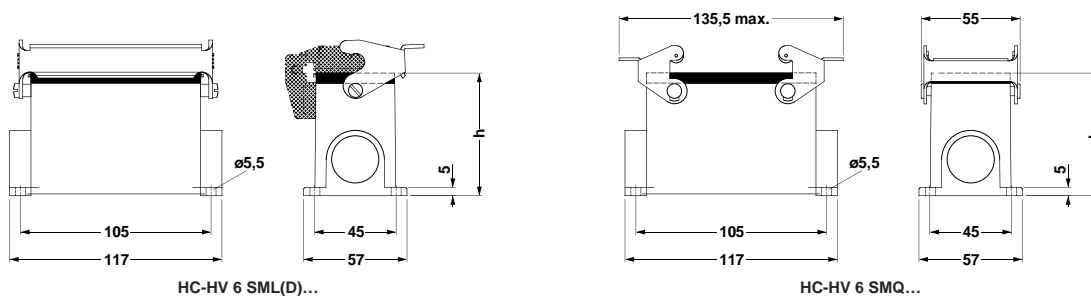

HC-HV 6 SML(D)...

HC-HV 6 SMQ...

HV 6 Series, Box Mounting Base, for Metric Glands



Description	Height h [mm]	Cable gland	Protective cover	Type	Order No.	Pcs./Pkt.
Box mounting base, with single locking latch	67	M 25	yes	HC-HV 6-SMLD-67/O1M25	16 04 93 2	10
Box mounting base, with double locking latch	67	M 25	no	HC-HV 6-SMQ-67/O1M25	16 04 93 3	10

Technical data

Degree of protection

IP 65

Materials

Housing

aluminum die cast, powder-coated, gray

Sealing

NBR

Single locking latch

zinc-plated steel and passivated

Double locking latch

high-grade steel, handle: PA-GF

Ambient temperature

[°C]

- 40 to +125

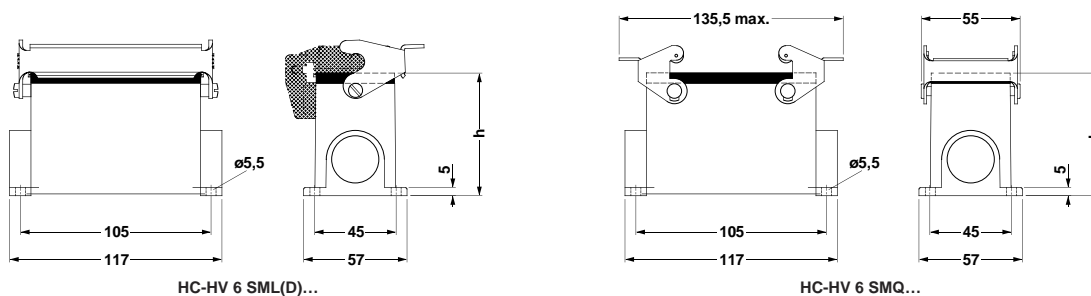

HC-HV 6 SML(D)...

HC-HV 6 SMQ...

HV 6 Series, Coupling Housing, with PG Cable Gland



Description	Height h [mm]	Cable gland	Protective cover	Type	Order No.	Pcs./Pkt.
Coupling housing, with single locking latch	69	PG 21	no	HC-HV 6-KML-69/M1PG21	17 73 89 9	10
Coupling housing, with double locking latch	69	PG 21	no	HC-HV 6-KMQ-69/M1PG21	17 73 88 6	10

Technical data

Degree of protection

IP 65

Materials

Housing

aluminum die cast, powder-coated, gray

Sealing

NBR

Single locking latch

zinc-plated steel and passivated

Double locking latch

high-grade steel, handle: PA-GF

Ambient temperature

[°C]

- 40 to +125

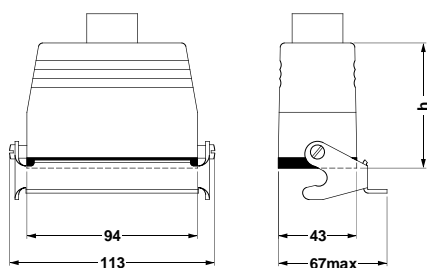

HC-HV 6 KML...

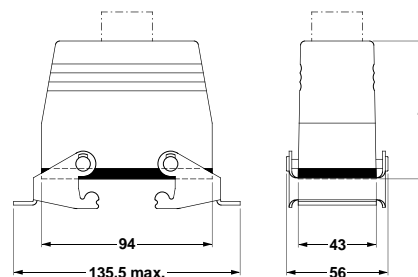

HC-HV 6 KMQ...

HV 10/16 Series, Sleeve Housing, with PG Cable Gland



Description	Height h [mm]	Cable gland	Cable exit	Type	Order No.	Pcs./Pkt.
Sleeve housing, for single locking latch	76	PG 21	straight	HC-HV 10/16-TFL-76/M1PG21G	17 73 91 2	10
	76	PG 21	lateral	HC-HV 10/16-TFL-76/M1PG21S	17 73 90 9	
Sleeve housing, for double locking latch	76	PG 21	lateral	HC-HV 10/16-TFQ-76/M1PG21S	17 73 92 5	10
Sleeve housing, with double locking latch	76	PG 21	lateral	HC-HV 10/16-TMQ-76/M1PG21S	17 73 98 3	10

Technical data

Degree of protection

IP 65

Materials

aluminum die cast, powder-coated, gray

Housing

high-grade steel, handle: PA-GF

Double locking latch

Ambient temperature

[°C]

- 40 to +125

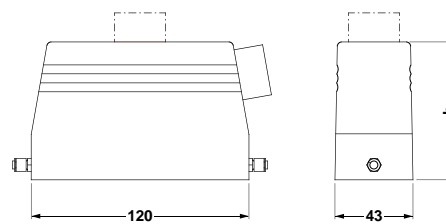

HC-HV 10/16 TFL...

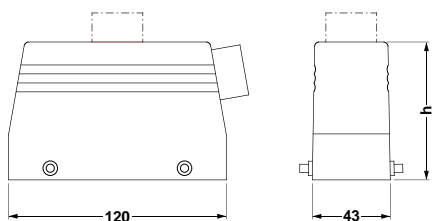

HC-HV 10/16 TFQ...

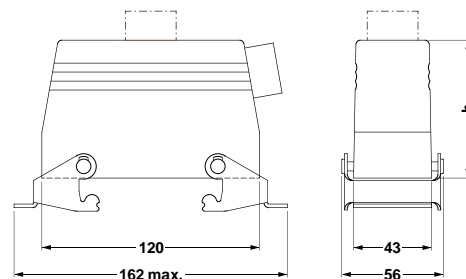

HC-HV 10/16 TMQ...

HV 10/16 Series, Sleeve Housing, for Metric Glands



Description	Height h [mm]	Cable gland	Cable exit	Type	Order No.	Pcs./Pkt.
Sleeve housing, for single locking latch	76	M 25	lateral	HC-HV 10/16-TFL-76/O1M25S	16 04 94 0	10
Sleeve housing, for double locking latch	76	M 25	straight	HC-HV 10/16-TFQ-76/O1M25G	16 04 94 1	10
Sleeve housing, with double locking latch	76	M 25	straight	HC-HV 10/16-TMQ-76/O1M25G	16 04 94 2	10
		M 25	lateral	HC-HV 10/16-TMQ-76/O1M25S	16 04 94 3	

Technical data

Degree of protection

IP 65

Materials

aluminum die cast, powder-coated, gray
high-grade steel, handle: PA-GF

Housing

Double locking latch

Ambient temperature

[°C]

- 40 to +125

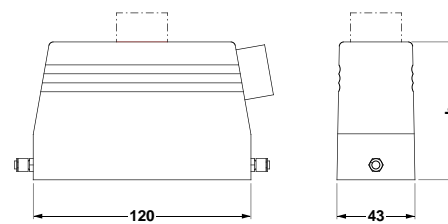

HC-HV 10/16 TFL...

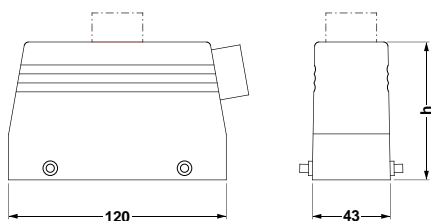

HC-HV 10/16 TFQ...

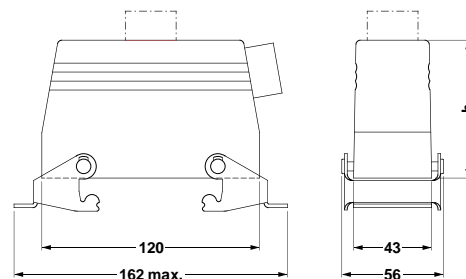

HC-HV 10/16 TMQ...

HV 10/16 Series, Panel Mounting Base



Description	Height h [mm]	Cable gland	Protective cover	Type	Order No.	Pcs./Pkt.
Panel mounting base, with single locking latch	27	–	no	HC-HV 10/16-AML	17 74 02 1	10
	27	–	yes	HC-HV 10/16-AML D	17 74 03 4	
Panel mounting base, with double locking latch	27	–	no	HC-HV 10/16-AMQ	17 74 04 7	10
Panel mounting base, for double locking latch	27	–	yes	HC-HV 10/16-AFQD	17 74 05 0	10

Technical data

Degree of protection

IP 65

Materials

aluminum die cast, powder-coated, gray

Housing

NBR

Sealing

zinc-plated steel and passivated

Single locking latch

high-grade steel, handle: PA-GF

Double locking latch

Ambient temperature

[°C]

– 40 to +125

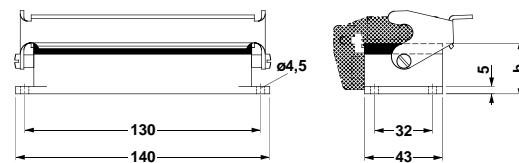

HC-HV 10/16 AML(D)...

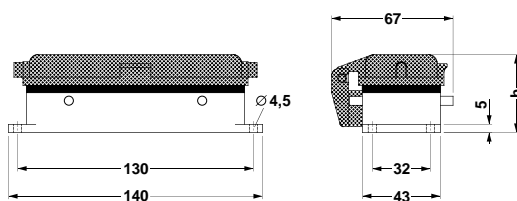

HC-HV 10/16 AFQD...

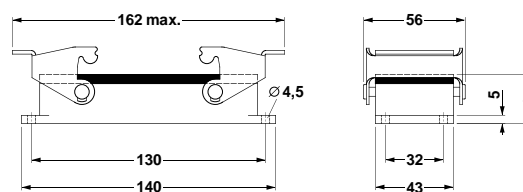

HC-HV 10/16 AMQ...

HV 10/16 Series, Box Mounting Base, with PG Cable Gland



Description	Height h [mm]	Cable gland	Protective cover	Type	Order No.	Pcs./Pkt.
Box mounting base, with single locking latch	67	PG 21	no	HC-HV 10/16-SML-67/M1PG21	17 74 06 3	10
	67	PG 21	yes	HC-HV 10/16-SMLD-67/M1PG21	17 74 08 9	
	67	2 x PG 21	yes	HC-HV 10/16-SMLD-67/M2PG21	17 74 09 2	
Box mounting base, with double locking latch	67	PG 21	no	HC-HV 10/16-SMQ-67/M1PG21	17 74 10 2	10

Technical data

Degree of protection

IP 65

Materials

Housing

aluminum die cast, powder-coated, gray

Sealing

NBR

Single locking latch

zinc-plated steel and passivated

Double locking latch

high-grade steel, handle: PA-GF

Ambient temperature

[°C]

- 40 to +125

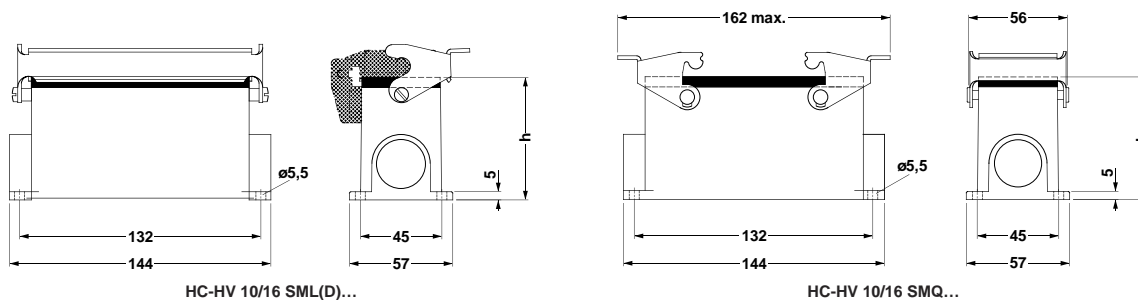

HV 10/16 Series, Box Mounting Base, for Metric Glands



Description	Height h [mm]	Cable gland	Protective cover	Type	Order No.	Pcs./Pkt.
Box mounting base, with single locking latch	67	M 25	yes	HC-HV 10/16-SMLD-67/O1M25	16 04 93 7	10
	67	M 25	yes	HC-HV 10/16-SMLD-67/O2M25	16 04 93 8	10
Box mounting base, with double locking latch	67	M 25	no	HC-HV 10/16-SMQ-67/O1M25	16 04 93 9	10

Technical data

Degree of protection

IP 65

Materials

Housing

aluminum die cast, powder-coated, gray

Sealing

NBR

Single locking latch

zinc-plated steel and passivated

Double locking latch

high-grade steel, handle: PA-GF

Ambient temperature

[°C]

- 40 to +125

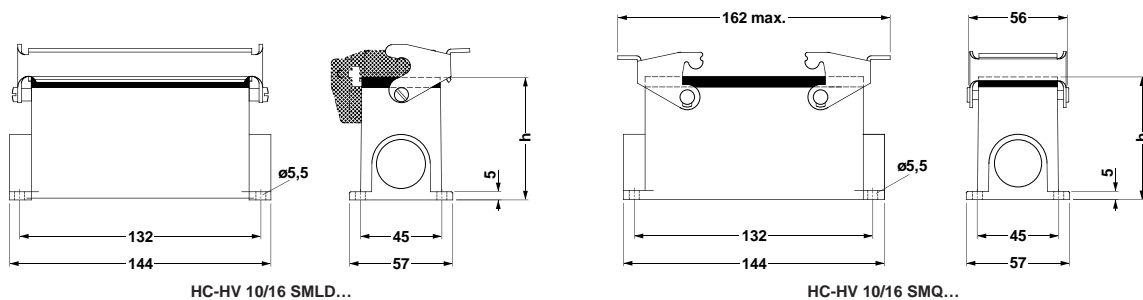

HV 10/16 Series, Coupling Housing, with PG Cable Gland



Description	Height h [mm]	Cable gland	Protective cover	Type	Order No.	Pcs./Pkt.
Coupling housing, with single locking latch	79	PG 21	no	HC-HV 10/16-KML-79/M1PG21	17 74 15 7	10

Technical data

Degree of protection

IP 65

Materials

Housing

aluminum die cast, powder-coated, gray

Sealing

NBR

Single locking latch

zinc-plated steel and passivated

Ambient temperature

[°C]

- 40 to +125

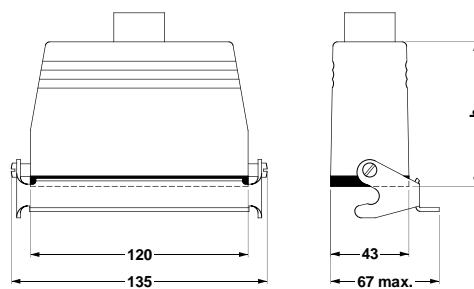

HC-HV 10/16 KML...