

## Cable duct - CD-HF 25X40 - 3240341

Please be informed that the data shown in this PDF Document is generated from our Online Catalog. Please find the complete data in the user's documentation. Our General Terms of Use for Downloads are valid (<http://phoenixcontact.com/download>)



Cable duct, light gray, halogen-free, consisting of upper part and mounting base, width: 25 mm, height: 40 mm, length: 2000 mm

The illustration shows the version in gray

### Why buy this product

- Predetermined breaking point enables tool-free, burr-free removal of bars
- The wide, diagonal heads of the cable duct bars make it easy to fit the cover and hold it securely in place
- Fast and seamless creation of T and cross connections by means of an additional predetermined breaking point in the cable duct base
- Installed conductors are securely held in place by means of wire retaining clips that can be snapped onto bars on the side
- Cover is securely held in place for both horizontal and vertical mounting

### Key Commercial Data

Packing unit	24 STK
GTIN	 4 046356 507264

### Technical data

#### Dimensions

Length (b)	2000 mm
Width (a)	25 mm
Height	40 mm

#### Ambient conditions

Ambient temperature (operation)	-25 °C ... 90 °C
---------------------------------	------------------

#### General

Color	light gray
Components	Halogen-free
Flammability rating according to UL 94	V0
Material	PC/ABS

#### Standards and Regulations

Halogen-free	yes
Connection in acc. with standard	CSA

# Cable duct - CD-HF 25X40 - 3240341

## Technical data

### Standards and Regulations

Flammability rating according to UL 94	V0
--	----

## Classifications

### eCl@ss

eCl@ss 4.0	27140602
eCl@ss 4.1	27140602
eCl@ss 5.0	27140602
eCl@ss 5.1	27140602
eCl@ss 6.0	27400703
eCl@ss 7.0	27400703
eCl@ss 8.0	27400703

### ETIM

ETIM 2.0	EC000012
ETIM 3.0	EC000012
ETIM 4.0	EC000012
ETIM 5.0	EC000012

### UNSPSC

UNSPSC 6.01	30101815
UNSPSC 7.0901	30101815
UNSPSC 11	30101815
UNSPSC 12.01	30101815
UNSPSC 13.2	30101815

## Approvals

### Approvals

---

#### Approvals

CSA / UL Recognized / VDE Zeichengenehmigung

---

#### Ex Approvals

---

#### Approvals submitted

---

#### Approval details

## Cable duct - CD-HF 25X40 - 3240341

### Approvals



UL Recognized 

VDE Zeichengenehmigung 

### Drawings

Dimensional drawing

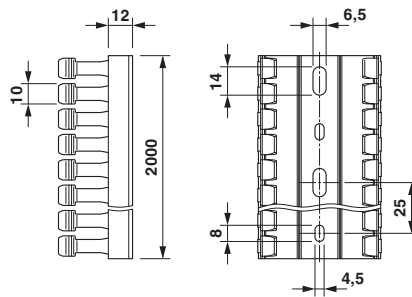

Base perforation according to DIN EN 50085

Phoenix Contact 2016 © - all rights reserved  
<http://www.phoenixcontact.com>

PHOENIX CONTACT GmbH & Co. KG  
Flachsmarktstr. 8  
32825 Blomberg  
Germany  
Tel. +49 5235 300  
Fax +49 5235 3 41200  
<http://www.phoenixcontact.com>