

## Cable sleeve - CES-SRG-BK-4X3 - 0801665

Please be informed that the data shown in this PDF Document is generated from our Online Catalog. Please find the complete data in the user's documentation. Our General Terms of Use for Downloads are valid (<http://phoenixcontact.com/download>)



Small, slotted cable sleeves suitable for four cables with a diameter of 2 ... 3 mm, material: NBR

### Product Description

Slotted sleeves for accommodating four cables with a diameter of 2 ... 3 mm, can be used in CEL sealing frames. When fitted, the sleeves also ensure strain relief according to DIN EN 50262.

### Key Commercial Data

Packing unit	10 STK
GTIN	 4 046356 674461

### Technical data

#### Dimensions

External cable diameter	4x 2 mm ... 3 mm
Length	29.5 mm
Width	19.5 mm
Height	17 mm

#### Ambient conditions

Degree of protection	IP54 (for sealing frames with screw locking. IP44 sealing frames with locking latch.)
Ambient temperature (operation)	-40 °C ... 125 °C (static)

#### General

Product description	Slotted sleeves for accommodating four cables with a diameter of 2 ... 3 mm, can be used in CEL sealing frames. When fitted, the sleeves also ensure strain relief according to DIN EN 50262.
No. of conductors	4
Material	NBR
Color	black

# Cable sleeve - CES-SRG-BK-4X3 - 0801665

## Classifications

### eCl@ss

eCl@ss 4.0	27081002
eCl@ss 4.1	27081002
eCl@ss 5.0	27081002
eCl@ss 5.1	27081002
eCl@ss 6.0	27081002
eCl@ss 7.0	27081002
eCl@ss 8.0	27069216

### ETIM

ETIM 3.0	EC000879
ETIM 4.0	EC000451
ETIM 5.0	EC000451

### UNSPSC

UNSPSC 6.01	30212109
UNSPSC 7.0901	39121708
UNSPSC 11	39121708
UNSPSC 12.01	39121708
UNSPSC 13.2	39121708

## Approvals

### Approvals

---

Approvals

GL

---

Ex Approvals

---

Approvals submitted

---

Approval details

GL
----

## Drawings

## Cable sleeve - CES-SRG-BK-4X3 - 0801665

Dimensional drawing

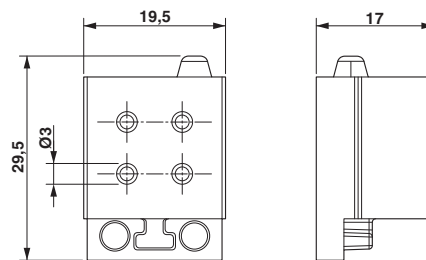

Dimensional drawing

---

Phoenix Contact 2016 © - all rights reserved  
<http://www.phoenixcontact.com>

PHOENIX CONTACT GmbH & Co. KG  
Flachsmarktstr. 8  
32825 Blomberg  
Germany  
Tel. +49 5235 300  
Fax +49 5235 3 41200  
<http://www.phoenixcontact.com>