

Printed-circuit board connector - IPC 16/ 6-ST-10,16 - 1969412

Please be informed that the data shown in this PDF Document is generated from our Online Catalog. Please find the complete data in the user's documentation. Our General Terms of Use for Downloads are valid (<http://phoenixcontact.com/download>)



Plug component, nominal current: 76 A, rated voltage (III/2): 1000 V, number of positions: 6, pitch: 10.16 mm, connection method: Screw connection with tension sleeve, color: green, contact surface: Silver

The figure shows a 5-pos. version of the product

Why buy this product

- ✓ Well-known connection principle allows worldwide use
- ✓ Low temperature rise, thanks to maximum contact force
- ✓ Allows connection of two conductors
- ✓ Inverted connector with pin contacts for touch-proof device outputs or free-hanging cable/cable connections

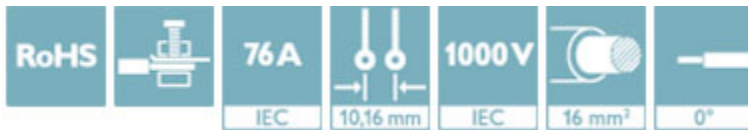

Key Commercial Data

Packing unit	1 STK
Minimum order quantity	50 STK
GTIN	 4 017918 943660
GTIN	4017918943660
Weight per Piece (excluding packing)	56.560 g
Custom tariff number	85366990
Country of origin	Poland

Technical data

Dimensions

Length [l]	44.1 mm
Width [w]	64 mm
Height [h]	27.8 mm
Pitch	10.16 mm

Printed-circuit board connector - IPC 16/ 6-ST-10,16 - 1969412

Technical data

Dimensions

Dimension a	50.8 mm
-------------	---------

General

Range of articles	IPC 16/...-ST
Type of contact	Male connector
Number of positions	6
Connection method	Screw connection with tension sleeve
Insulating material group	I
Rated surge voltage (III/3)	8 kV
Rated surge voltage (III/2)	8 kV
Rated surge voltage (II/2)	6 kV
Rated voltage (III/3)	1000 V
Rated voltage (III/2)	1000 V
Rated voltage (II/2)	1000 V
Connection in acc. with standard	EN-VDE
Nominal current I_N	76 A
Nominal cross section	16 mm ²
Maximum load current	76 A
Insulating material	PA
Flammability rating according to UL 94	V0
Internal cylindrical gage	A6
Stripping length	12 mm
Screw thread	M4
Tightening torque, min	1.7 Nm
Tightening torque max	1.8 Nm

Connection data

Conductor cross section solid min.	0.75 mm ²
Conductor cross section solid max.	16 mm ²
Conductor cross section flexible min.	0.75 mm ²
Conductor cross section flexible max.	16 mm ²
Conductor cross section flexible, with ferrule without plastic sleeve min.	0.5 mm ²
Conductor cross section flexible, with ferrule without plastic sleeve max.	16 mm ² Only in connection with CRIMPFOX 16 S
Conductor cross section flexible, with ferrule with plastic sleeve min.	0.5 mm ²
Conductor cross section flexible, with ferrule with plastic sleeve max.	10 mm ² Only in connection with CRIMPFOX 16 S
Conductor cross section AWG min.	18
Conductor cross section AWG max.	6
2 conductors with same cross section, solid min.	0.75 mm ²

Printed-circuit board connector - IPC 16/ 6-ST-10,16 - 1969412

Technical data

Connection data

2 conductors with same cross section, solid max.	6 mm ²
2 conductors with same cross section, stranded min.	0.75 mm ²
2 conductors with same cross section, stranded max.	6 mm ²
2 conductors with same cross section, stranded, ferrules without plastic sleeve, min.	0.5 mm ²
2 conductors with same cross section, stranded, ferrules without plastic sleeve, max.	4 mm ²
2 conductors with same cross section, stranded, TWIN ferrules with plastic sleeve, min.	0.5 mm ²
2 conductors with same cross section, stranded, TWIN ferrules with plastic sleeve, max.	6 mm ²
Minimum AWG according to UL/CUL	20
Maximum AWG according to UL/CUL	6

Standards and Regulations

Connection in acc. with standard	EN-VDE
	CUL
Flammability rating according to UL 94	V0

Environmental Product Compliance

China RoHS	Environmentally Friendly Use Period = 50
	For details about hazardous substances go to tab "Downloads", Category "Manufacturer's declaration"

Drawings

Diagram

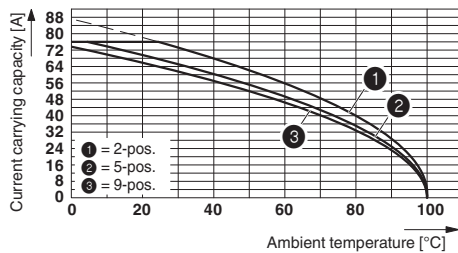

Derating curve for: IPC 16/...-ST-10,16 with DFK-IPC 16/...-G-10,16

Diagram

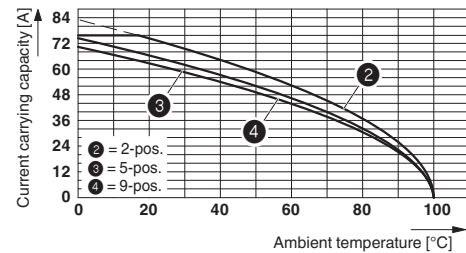

Derating curve for: IPC 16/...-ST-10,16 with IPC 16/...-G-10,16

Printed-circuit board connector - IPC 16/ 6-ST-10,16 - 1969412

Diagram

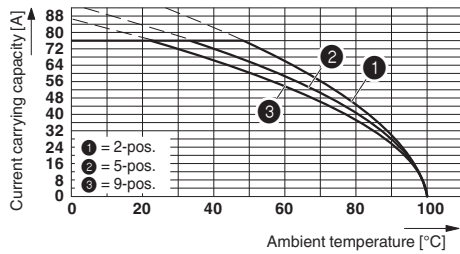

Dimensional drawing

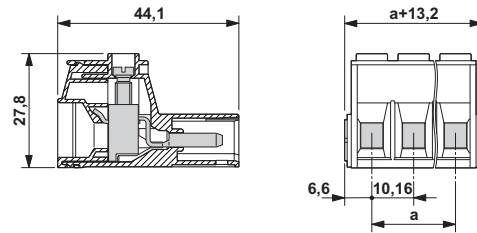

Derating curve for: PC 16/...-ST-10,16 with IPC 16/...-ST-10,16

The figure shows the 3-pos. version

Classifications

eCl@ss

eCl@ss 4.0	272607xx
eCl@ss 4.1	27260701
eCl@ss 5.0	27260701
eCl@ss 5.1	27260701
eCl@ss 6.0	27260704
eCl@ss 7.0	27440402
eCl@ss 8.0	27440309
eCl@ss 9.0	27440309

ETIM

ETIM 3.0	EC001121
ETIM 4.0	EC002638
ETIM 5.0	EC002638
ETIM 6.0	EC002638

UNSPSC

UNSPSC 6.01	30211810
UNSPSC 7.0901	39121409
UNSPSC 11	39121409
UNSPSC 12.01	39121409
UNSPSC 13.2	39121409

Approvals

Approvals

Printed-circuit board connector - IPC 16/ 6-ST-10,16 - 1969412

Approvals

Approvals

SEV / IECEE CB Scheme / EAC / cULus Recognized

Ex Approvals

Approval details

SEV		https://www.electrosuisse.ch/en/meta/shop/product-certificates.html	IK-3431
mm ² /AWG/kcmil	16		
Nominal current I _N	76 A		
Nominal voltage U _N	1000 V		

IECEE CB Scheme		http://www.iecee.org/	CH-8077
Nominal current I _N	76 A		
Nominal voltage U _N	1000 V		

EAC			B.01742
-----	---	--	---------

cULus Recognized		http://database.ul.com/cgi-bin/XYV/template/LISEXT/1FRAME/index.htm	E60425-20040202
	B	C	
mm ² /AWG/kcmil	20-6	20-6	
Nominal current I _N	55 A	55 A	
Nominal voltage U _N	600 V	600 V	

Accessories

Accessories

Coding element

Printed-circuit board connector - IPC 16/ 6-ST-10,16 - 1969412

Accessories

Coding profile - CP-PC RD - 1701967



Coding profile, for plugging into the coding ribs of the plug at a later date, insulating material, color: Red

Crimping tool

Crimping pliers - CRIMPFOX 6 - 1212034



Crimping pliers, for ferrules without insulating collar according to DIN 46228 Part 1 and ferrules with insulating collar according to DIN 46228 Part 4, 0.25 mm² ... 6.0 mm², lateral entry, trapezoidal crimp

Crimping pliers - CRIMPFOX 16 S - 1207983



Crimping pliers for ferrules up to 16 mm²

Screwdriver tools

Screwdriver - SZS 1,0X4,0 VDE - 1205066



Screwdriver, slot-headed, VDE insulated, size: 1.0 x 4.0 x 100 mm, 2-component grip, with non-slip grip

Terminal marking

Printed-circuit board connector - IPC 16/ 6-ST-10,16 - 1969412

Accessories

Marker strip - SK 5,0 WH:REEL - 0805221



Marker strip, Roll, white, unlabeled, can be labeled with: THERMOMARK ROLL, THERMOMARK ROLL X1, THERMOMARK ROLLMASTER 300/600, THERMOMARK X1.2, THERMOMARK S1.1, mounting type: adhesive, for terminal block width: 5 mm, lettering field size: continuous x 5 mm

Additional products

Printed-circuit board connector - PCU 6/ 6-STD-10,16 - 1922679



Plug component, nominal current: 41 A, rated voltage (III/2): 1000 V, number of positions: 6, pitch: 10.16 mm, connection method: Screw connection with tension sleeve, color: green, contact surface: Silver, mounting: Direct mounting

Printed-circuit board connector - PC 16/ 6-ST-10,16 - 1967414



Plug component, nominal current: 76 A, rated voltage (III/2): 1000 V, number of positions: 6, pitch: 10.16 mm, connection method: Screw connection with tension sleeve, color: green, contact surface: Silver

Printed-circuit board connector - TPC 16/ 6-ST-10,16 - 1715219



Plug component, nominal current: 76 A, rated voltage (III/2): 1000 V, number of positions: 6, pitch: 10.16 mm, connection method: Screw connection with tension sleeve, color: green, contact surface: Silver

Printed-circuit board connector - SPC 16/ 6-ST-10,16 - 1711307



Plug component, nominal current: 76 A, rated voltage (III/2): 1000 V, number of positions: 6, pitch: 10.16 mm, connection method: Push-in spring connection, color: green, contact surface: Silver

Printed-circuit board connector - IPC 16/ 6-ST-10,16 - 1969412

Accessories

Base strip - IPC 16/ 6-G-10,16 - 1969577



Header, nominal current: 76 A, rated voltage (III/2): 1000 V, number of positions: 6, pitch: 10.16 mm, color: green, contact surface: Silver, mounting: Wave soldering

Base strip - IPC 16/ 6-GU-10,16 - 1969894



Header, nominal current: 76 A, rated voltage (III/2): 1000 V, number of positions: 6, pitch: 10.16 mm, color: green, contact surface: Silver, mounting: Wave soldering, Plug direction parallel to the PCB: connector part rotated by 180° with respect to the plug axis.

Base strip - IPCV 16/ 6-G-10,16 - 1969739



Header, nominal current: 76 A, rated voltage (III/2): 1000 V, number of positions: 6, pitch: 10.16 mm, color: green, contact surface: Silver, mounting: Wave soldering

Base strip - DFK-IPC 16/ 6-G-10,16 - 1702455



Header, nominal current: 76 A, rated voltage (III/2): 1000 V, number of positions: 6, pitch: 10.16 mm, color: green, contact surface: Silver, mounting: Wave soldering

Base strip - DFK-IPC 16/ 6-GU-10,16 - 1702536



Header, nominal current: 76 A, rated voltage (III/2): 1000 V, number of positions: 6, pitch: 10.16 mm, color: green, contact surface: Silver, mounting: Wave soldering

Printed-circuit board connector - IPC 16/ 6-ST-10,16 - 1969412

Accessories

Housing - DFK-IPCV 16/ 6-G-10,16 - 1703098



Header, nominal current: 76 A, rated voltage (III/2): 1000 V, number of positions: 6, pitch: 10.16 mm, color: green, contact surface: Silver, mounting: Wave soldering

Plug - DFK-IPC 16/ 6-ST-10,16 - 1703739



Plug component, nominal current: 76 A, rated voltage (III/2): 1000 V, number of positions: 6, pitch: 10.16 mm, connection method: Screw connection with tension sleeve, color: green, contact surface: Silver