

Contact insert - VC-AML 6 - 1853531

Please be informed that the data shown in this PDF Document is generated from our Online Catalog. Please find the complete data in the user's documentation. Our General Terms of Use for Downloads are valid (<http://phoenixcontact.com/download>)



Contact insert module, for panel mounting frames, with 90° PCB connection, 6-pos., 250 V / 10 A

Product Features

- Compact design
- Proven COMBICON technology
- Direct PCB connection
- Can be keyed to prevent incorrect connection



Key Commercial Data

Packing unit	1 pc
GTIN	 4 017918 132897
Weight per Piece (excluding packing)	5.45 g
Custom tariff number	85369010
Country of origin	Poland

Technical data

General

Note	Connectors may only be connected/disconnected when under no load.
Connection method	Solder connection
	Solder connection
Degree of pollution	3
Overvoltage category	III
Number of positions	6
Insertion/withdrawal cycles	≥ 100
Pin dimensions	1 x 1 mm

Contact insert - VC-AML 6 - 1853531

Technical data

General

Connection in acc. with standard	IEC / EN
----------------------------------	----------

Ambient conditions

Ambient temperature (operation)	-40 °C ... 100 °C
---------------------------------	-------------------

Material data

Flammability rating according to UL 94	V0
Contact material	CuZn
Contact surface material	Tin-plated
Contact carrier material	PA

Electrical characteristics

Rated voltage (III/3)	250 V
Rated surge voltage	4 kV
	4 kV
Rated current	10 A

Standards and Regulations

Connection in acc. with standard	IEC / EN
	CUL
Flammability rating according to UL 94	V0

Classifications

eCl@ss

eCl@ss 4.0	27140816
eCl@ss 4.1	27140816
eCl@ss 5.0	27143424
eCl@ss 5.1	27143424
eCl@ss 6.0	27143424
eCl@ss 7.0	27440209
eCl@ss 8.0	27440205
eCl@ss 9.0	27440205

ETIM

ETIM 2.0	EC000438
ETIM 3.0	EC000438
ETIM 4.0	EC000438
ETIM 5.0	EC000438

Contact insert - VC-AML 6 - 1853531

Classifications

UNSPSC

UNSPSC 6.01	30211923
UNSPSC 7.0901	39121522
UNSPSC 11	39121522
UNSPSC 12.01	39121522
UNSPSC 13.2	39121522

Approvals

Approvals

Approvals

UL Recognized / cUL Recognized / LR / EAC / EAC / EAC / cULus Recognized

Ex Approvals

Approvals submitted

Approval details

UL Recognized	
Nominal current I _N	8 A
Nominal voltage U _N	250 V

cUL Recognized	
Nominal current I _N	8 A
Nominal voltage U _N	250 V

LR

Contact insert - VC-AML 6 - 1853531

Approvals

EAC

EAC

EAC

cULus Recognized 

Drawings

Drilling diagram

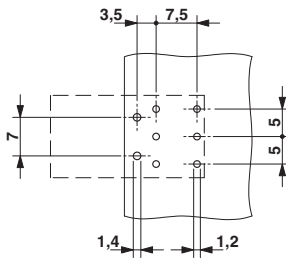

Dimensional drawing

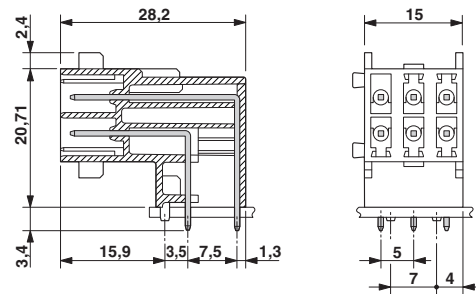

Contact insert - VC-AML 6 - 1853531

Diagram

