

## Base strip - MC 1,5/11-GF-3,81 - 1827952

Please be informed that the data shown in this PDF Document is generated from our Online Catalog. Please find the complete data in the user's documentation. Our General Terms of Use for Downloads are valid (<http://phoenixcontact.com/download>)

Header, Nominal current: 8 A, Rated voltage (III/2): 160 V, Number of positions: 11, Pitch: 3.81 mm, Color: green, Contact surface: Tin, Mounting: Soldering

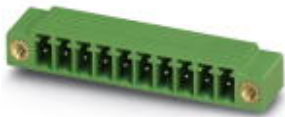

The figure shows a 10-position version of the product

### Product Features

- ✓ Low-profile pin strips with compact pitches
- ✓ Plug-in direction parallel and vertical to the PCB
- ✓ Individual position coding by inserting coding profiles



### Key Commercial Data

|                                      |   |
|--------------------------------------|---|
| Packing unit                         | 1 pc  |
| GTIN                                 | <br>4 017918 050405 |
| Weight per Piece (excluding packing) | 4.06 g  |
| Custom tariff number                 | 85366990  |
| Country of origin                    | Germany   |

### Technical data

#### Dimensions

|                          |              |
|--------------------------|--------------|
| Length                   | 9.2 mm       |
| Pitch                    | 3.81 mm      |
| Dimension a              | 38.1 mm      |
| Width                    | 52.3 mm      |
| Constructional height    | 7.25 mm      |
| Height                   | 10.65 mm     |
| Length of the solder pin | 3.4 mm       |
| Pin dimensions           | 0,8 x 0,8 mm |

# Base strip - MC 1,5/11-GF-3,81 - 1827952

## Technical data

### Dimensions

|               |        |
|---------------|--------|
| Hole diameter | 1.2 mm |
|---------------|--------|

### General

|  |               |
|--|---------------|
| Range of articles                      | MC 1,5/...-GF |
| Insulating material group              | IIIa          |
| Rated surge voltage (III/3)            | 2.5 kV        |
| Rated surge voltage (III/2)            | 2.5 kV        |
| Rated surge voltage (II/2)             | 2.5 kV        |
| Rated voltage (III/3)                  | 160 V         |
| Rated voltage (III/2)                  | 160 V         |
| Rated voltage (II/2)                   | 250 V         |
| Connection in acc. with standard       | EN-VDE        |
| Nominal current $I_N$                  | 8 A           |
| Maximum load current                   | 8 A           |
| Insulating material                    | PBT           |
| Flammability rating according to UL 94 | V0            |
| Color                                  | green         |
| Number of positions                    | 11            |

### Standards and Regulations

|  |        |
|--|--------|
| Connection in acc. with standard       | EN-VDE |
|  | CSA    |
| Flammability rating according to UL 94 | V0     |

### Classifications

#### eCl@ss

|            |          |
|------------|----------|
| eCl@ss 4.0 | 272607xx |
| eCl@ss 4.1 | 27260701 |
| eCl@ss 5.0 | 27260701 |
| eCl@ss 5.1 | 27260701 |
| eCl@ss 6.0 | 27260704 |
| eCl@ss 7.0 | 27440402 |
| eCl@ss 8.0 | 27440402 |

#### ETIM

|          |          |
|----------|----------|
| ETIM 3.0 | EC001121 |
| ETIM 4.0 | EC002637 |

# Base strip - MC 1,5/11-GF-3,81 - 1827952

## Classifications

### ETIM

|          |          |
|----------|----------|
| ETIM 5.0 | EC002637 |
|----------|----------|

### UNSPSC

|               |          |
|---------------|----------|
| UNSPSC 6.01   | 30211810 |
| UNSPSC 7.0901 | 39121409 |
| UNSPSC 11     | 39121409 |
| UNSPSC 12.01  | 39121409 |
| UNSPSC 13.2   | 39121409 |

## Approvals

### Approvals

#### Approvals

CSA / VDE Gutachten mit Fertigungsüberwachung / IECCE CB Scheme / CCA / EAC / cULus Recognized

#### Ex Approvals

#### Approvals submitted

## Approval details

|   |       |       |
|---|-------|-------|
| CSA  |       |       |
|   | B     | D     |
| Nominal current I <sub>N</sub>  | 8 A   | 8 A   |
| Nominal voltage U <sub>N</sub>  | 300 V | 300 V |

|   |       |
|---|-------|
| VDE Gutachten mit Fertigungsüberwachung  |       |
| Nominal current I <sub>N</sub>  | 8 A   |
| Nominal voltage U <sub>N</sub>  | 160 V |

# Base strip - MC 1,5/11-GF-3,81 - 1827952

## Approvals

|                                |       |
|--------------------------------|-------|
| IECEE CB Scheme                |       |
| Nominal current I <sub>N</sub> | 8 A   |
| Nominal voltage U <sub>N</sub> | 160 V |

|                                |       |
|--------------------------------|-------|
| CCA                            |       |
| Nominal current I <sub>N</sub> | 8 A   |
| Nominal voltage U <sub>N</sub> | 160 V |

|     |  |
|-----|--|
| EAC |  |
|-----|--|

|                                |       |       |
|--------------------------------|-------|-------|
| cULus Recognized               |       |       |
|                                | B     | D     |
| Nominal current I <sub>N</sub> | 8 A   | 8 A   |
| Nominal voltage U <sub>N</sub> | 300 V | 300 V |

## Drawings

Drilling diagram

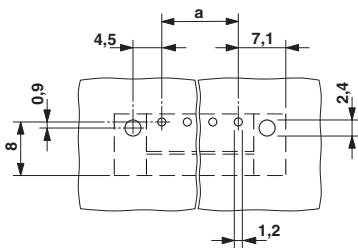

Diagram

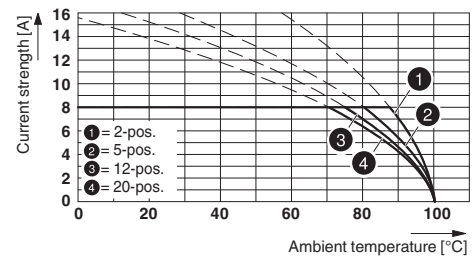

Type: MC 1,5/...-STF-3,81 with MC 1,5/...-GF-3,81

## Base strip - MC 1,5/11-GF-3,81 - 1827952

Dimensional drawing

