

# Housing - HC-B 16-SML-67/O1PG21 - 1673698

Please be informed that the data shown in this PDF Document is generated from our Online Catalog. Please find the complete data in the user's documentation. Our General Terms of Use for Downloads are valid (<http://phoenixcontact.com/download>)



Box mounting base, with single locking latch, height 67 mm, with a support 1x PG21



## Key Commercial Data

|              |               |
|--------------|---------------|
| Packing unit | 10 pc         |
| GTIN         |               |
| GTIN         | 4017918152543 |

## Technical data

### Dimensions

|        |        |
|--------|--------|
| Height | 67 mm  |
| Width  | 57 mm  |
| Length | 117 mm |

### Ambient conditions

|                                      |                   |
|--------------------------------------|-------------------|
| Degree of protection of housing (IP) | IP65              |
| Ambient temperature (operation)      | -40 °C ... 125 °C |

### General

|                              |   |
|------------------------------|---|
| Note                         | For contact inserts HC-B16, BB32, BBB40, D40, DD72, HS6, M, K |
| Size                         | B16   |
| Housing type                 | Box mounting bases  |
| Locking type                 | with single locking latch                                     |
| No. of cable outlets         | 1   |
| Cable outlet                 | left (view of the opened single locking latch)                |
| Screw connection             | none  |
| Type of the screw connection | 1x Pg21   |
| Housing material             | Aluminum die-cast   |
| Housing surface material     | Powder-coated, gray   |

# Housing - HC-B 16-SML-67/O1PG21 - 1673698

## Technical data

### General

|                              |                             |
|------------------------------|-----------------------------|
| Seal material                | NBR                         |
| Material lock                | Stainless steel, handle: PA |
| Material grip body interlock | PA                          |

### Environmental Product Compliance

|            |   |
|------------|---|
| China RoHS | Environmentally friendly use period: unlimited = EFUP-e |
|            | No hazardous substances above threshold values          |

## Drawings

Dimensional drawing

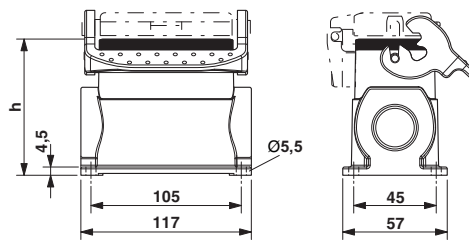

Dimensional drawing; h = 67 mm

## Approvals

Approvals

Approvals

EAC

Ex Approvals

### Approval details

|     |  |                          |
|-----|--|--------------------------|
| EAC |  | RU C-<br>DE.AI30.B.01102 |
|-----|--|--------------------------|

Phoenix Contact 2018 © - all rights reserved  
<http://www.phoenixcontact.com>

PHOENIX CONTACT GmbH & Co. KG  
Flachsmarktstr. 8  
32825 Blomberg  
Germany  
Tel. +49 5235 300  
Fax +49 5235 3 41200  
<http://www.phoenixcontact.com>