

## Cable gland - G-INS-M20-M68N-PNES-LG - 1424471

Please be informed that the data shown in this PDF Document is generated from our Online Catalog. Please find the complete data in the user's documentation. Our General Terms of Use for Downloads are valid (<http://phoenixcontact.com/download>)



Cable gland, Cable gland material: PA, External cable diameter 10 mm ... 14 mm, Shielding: No, Connecting thread: M20, Color: lightgrey RAL 7035

RoHS

### Key Commercial Data

Packing unit	1
GTIN	 4 055626 372617
GTIN	4055626372617
Custom tariff number	39269097

### Technical data

#### Dimensions

Length	43 mm
Wrench size, union nut	27 mm
Wrench size, support	27 mm
Hexagon angular dimension	27.8 mm
Length of the connecting thread	10 mm
Feed-through hole diameter	20.1 mm ... 20.2 mm
External cable diameter	10 mm ... 14 mm
	10 mm ... 14 mm (for UL 514 B)

#### Ambient conditions

Degree of protection	IP68 (5 bar / 0.5 h)
	IP66
Ambient temperature (operation)	-20 °C ... 100 °C (static)

# Cable gland - G-INS-M20-M68N-PNES-LG - 1424471

## Technical data

### General

No. of conductors	1
Cable gland material	PA
Cable seal material	Neoprene
Shielded	No
Thread type on connection side	M20
Thread pitch	1.5 mm
Torque	3.5 Nm (Union nut) 3.5 Nm (Support) 9 Nm (for UL514 B: union nut / support)
Flammability rating according to UL 94	V2 V2 (Housing)
Color	lightgrey RAL 7035
Impact category	2
Execution of the strain relief	A
Assembly instructions	1) Mount screw connection support in the housing using the correct torque 2) Insert cable 3) Tighten union nut using the correct torque
Manufacturer	BIMED
Manufacturer Designation	BM-13

### Standards and Regulations

Flammability rating according to UL 94	V2
--	----

## Drawings

Dimensional drawing

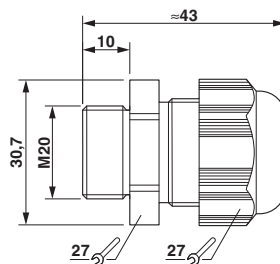

Dimensional drawing

# Cable gland - G-INS-M20-M68N-PNES-LG - 1424471

## Classifications

### eCl@ss

eCl@ss 5.1	27149109
eCl@ss 6.0	27149109
eCl@ss 7.0	27149109
eCl@ss 8.0	27149109
eCl@ss 9.0	27144432

### ETIM

ETIM 5.0	EC000441
----------	----------

## Approvals

### Approvals

#### Approvals

UL Listed / cUL Listed / EAC / cULus Listed

#### Ex Approvals

### Approval details

UL Listed		<a href="http://database.ul.com/cgi-bin/XYV/template/LISEXT/1FRAME/index.htm">http://database.ul.com/cgi-bin/XYV/template/LISEXT/1FRAME/index.htm</a>	E199260
-----------	---	---	---------

cUL Listed		<a href="http://database.ul.com/cgi-bin/XYV/template/LISEXT/1FRAME/index.htm">http://database.ul.com/cgi-bin/XYV/template/LISEXT/1FRAME/index.htm</a>	E199260
------------	---	---	---------

EAC		EAC-Zulassung
-----	---	---------------

cULus Listed	
--------------	---

## Cable gland - G-INS-M20-M68N-PNES-LG - 1424471

### Accessories

#### Accessories

#### Sealing plugs

Closing cap - SEALING PLUG 9X16 RD - 1400259



Closing cap, for closing unused bore holes in multiple seals and cable glands, diameter 9 mm

---

Nut - A-INL-M20-P-LG - 1414570



Nut, Cable gland material: Polyamide, PA 6 GF 30, for threads M20, Color: lightgrey RAL 7035

---

---