

## Housing - HC-STA-D07-HHFS-1TGM20-PL-BK - 1419255

Please be informed that the data shown in this PDF Document is generated from our Online Catalog. Please find the complete data in the user's documentation. Our General Terms of Use for Downloads are valid (<http://phoenixcontact.com/download>)



Sleeve housing D7, for single locking latch, Material: Polyamide, Cable outlets: 1, straight, Height: 57 mm, Cable gland: with, Gland: no, 1x M20, Standard

RoHS

### Key Commercial Data

Packing unit	1 STK
Weight per Piece (excluding packing)	20.000 g
Custom tariff number	85389099
Country of origin	China

### Technical data

#### Dimensions

Height	57 mm
Width	28 mm
Length	26.5 mm
External cable diameter	4 mm ... 10 mm

#### Ambient conditions

Degree of protection of housing (IP)	IP54
	IP65 (with sealing screw)
Ambient temperature (operation)	-40 °C ... 125 °C

#### General

Note	for contact inserts HC-A03, A04, D07, D08, Q02, Q03, Q04, Q05, Q07, Q12
Size	D7
Housing type	Sleeve housing
Color	black

# Housing - HC-STA-D07-HHFS-1TGM20-PL-BK - 1419255

## Technical data

### General

Locking type	for single locking latch
No. of cable outlets	1
Cable exit	straight
Screw connection	with
Type of the screw connection	1x M20
Housing material	Polyamide
Material lock	Polyamide

## Drawings

Dimensional drawing

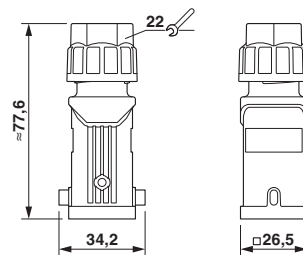

## Classifications

### eCl@ss

eCl@ss 5.1	27260701
eCl@ss 8.0	27440202
eCl@ss 9.0	27440202

### ETIM

ETIM 5.0	EC000437
----------	----------

## Accessories

### Accessories

#### Full screw connection

Cable gland - G-INS-M20-S68N-PNES-GY - 1411125



Cable gland, Cable gland material: Polyamide 6, External cable diameter 6 mm ... 12 mm, Shielding: No, Connecting thread: M20, Color: silver-gray RAL 7001

## Housing - HC-STA-D07-HHFS-1TGM20-PL-BK - 1419255

### Accessories

---

Cable gland - G-INS-M20-S68N-PNES-BK - 1411133



Cable gland, Cable gland material: Polyamide 6, External cable diameter 6 mm ... 12 mm, Shielding: No, Connecting thread: M20, Color: jet black RAL 9005

---