

## Flush-type connector - SACC-E-MINM-5CON-NPT12-547/1,0 - 1417766

Please be informed that the data shown in this PDF Document is generated from our Online Catalog. Please find the complete data in the user's documentation. Our General Terms of Use for Downloads are valid (<http://phoenixcontact.com/download>)



Flush-type connector, 5-position, Plug, straight, 7/8"-16UNF, on free cable end, Front mounting, with 1/2 inch-14 NPT mounting thread, Individual wires, cable length: 1 m



### Key Commercial Data

Packing unit	1 pc
GTIN	 4 055626 403502
GTIN	4055626403502
Weight per Piece (excluding packing)	0.100 g
Custom tariff number	85366990
Country of origin	Mexico

### Technical data

#### Dimensions

Length of cable	1 m
-----------------	-----

#### Ambient conditions

Degree of protection	IP68
----------------------	------

#### General

Rated current at 40°C	8 A
Rated voltage	300 V AC
	300 V DC
Number of positions	5
Insulation resistance	≥ 100 MΩ

# Flush-type connector - SACC-E-MINM-5CON-NPT12-547/1,0 - 1417766

## Technical data

### General

Standards/regulations	7/8-inch connector UL 2238 Suitable for use in Class I, Division 2 Groups A, B, C, D hazardous locations according to ISA standard 12.12.01-2015, section 8.2 and 8.8.3
Status display	No
Degree of pollution	3
Connection method	Individual wires
Insertion/withdrawal cycles	> 500
Torque	10 lb <sub>F</sub> -in.
	1.12 Nm
Mounting type	Front mounting, with 1/2 inch-14 NPT mounting thread

### Material

Flammability rating according to UL 94	V-0
Contact material	Copper alloy
Contact surface material	Au
Contact carrier material	PVC
Material, knurls	Anodized aluminum

### Cable

Cable type	PVC litz wire
Conductor cross section	0.75 mm <sup>2</sup>
AWG signal line	18
Conductor structure signal line	16 x AWG 30
Core diameter including insulation	1.78 mm
Thickness, insulation	Core insulation
Wire colors	Black 1, blue 2, grey 3, brown 4, white 5
Material conductor insulation	PVC
Standards/specifications	7/8-inch connector UL 2238 Suitable for use in Class I, Division 2 Groups A, B, C, D hazardous locations according to ISA standard 12.12.01-2015, section 8.2 and 8.8.3

### Standards and Regulations

Standard designation	7/8-inch connector
Standards/regulations	UL 2238
Flammability rating according to UL 94	V-0

### Environmental Product Compliance

China RoHS	Environmentally Friendly Use Period = 50
	For details about hazardous substances go to tab "Downloads", Category "Manufacturer's declaration"

# Flush-type connector - SACC-E-MINM-5CON-NPT12-547/1,0 - 1417766

## Drawings

Dimensional drawing

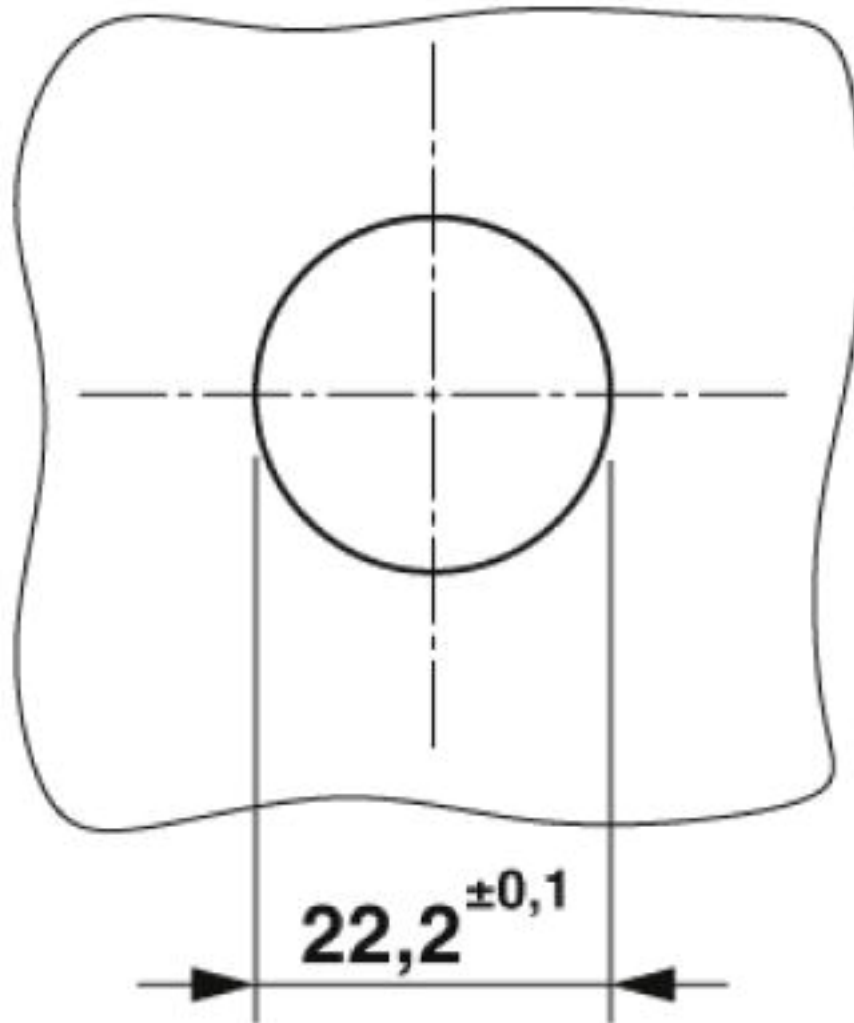

Housing cutout

# Flush-type connector - SACC-E-MINM-5CON-NPT12-547/1,0 - 1417766

Dimensional drawing

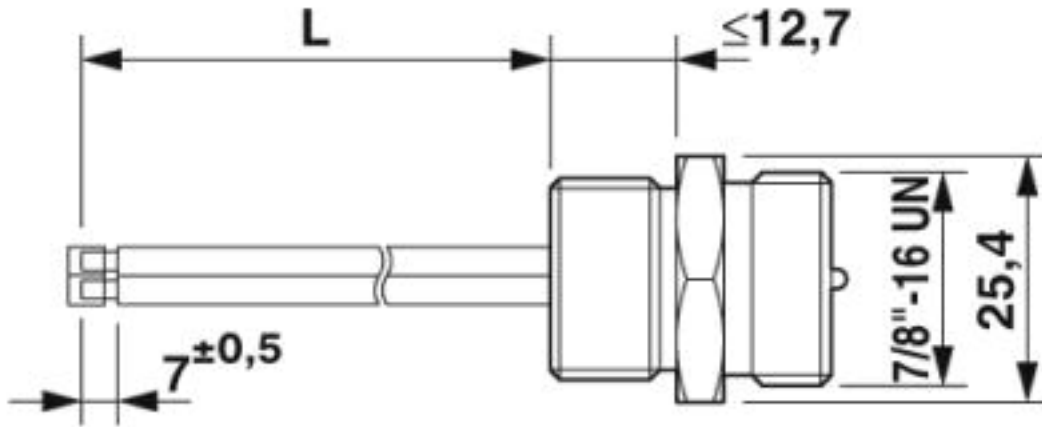

7/8" flush-type plug

Circuit diagram

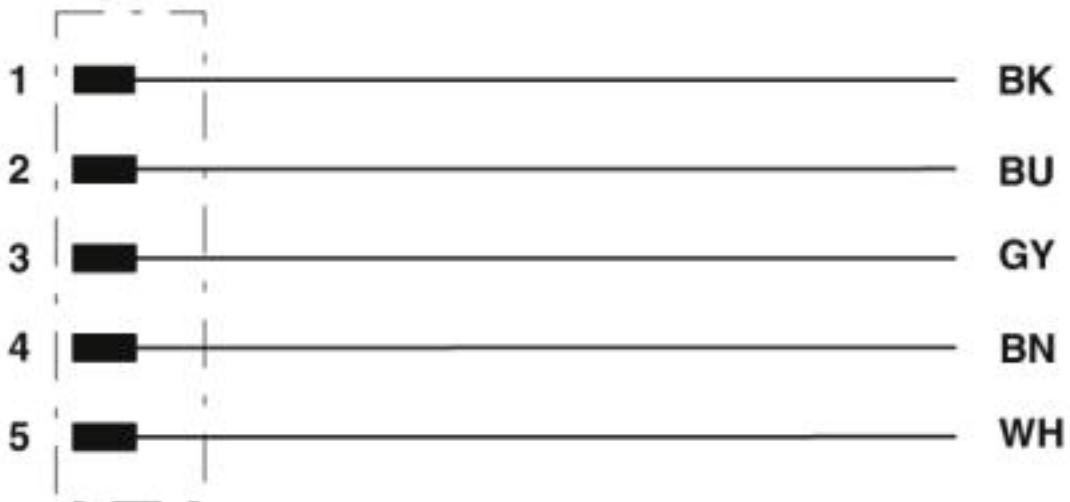

Contact assignment of the 7/8" plug

# Flush-type connector - SACC-E-MINM-5CON-NPT12-547/1,0 - 1417766

Schematic diagram

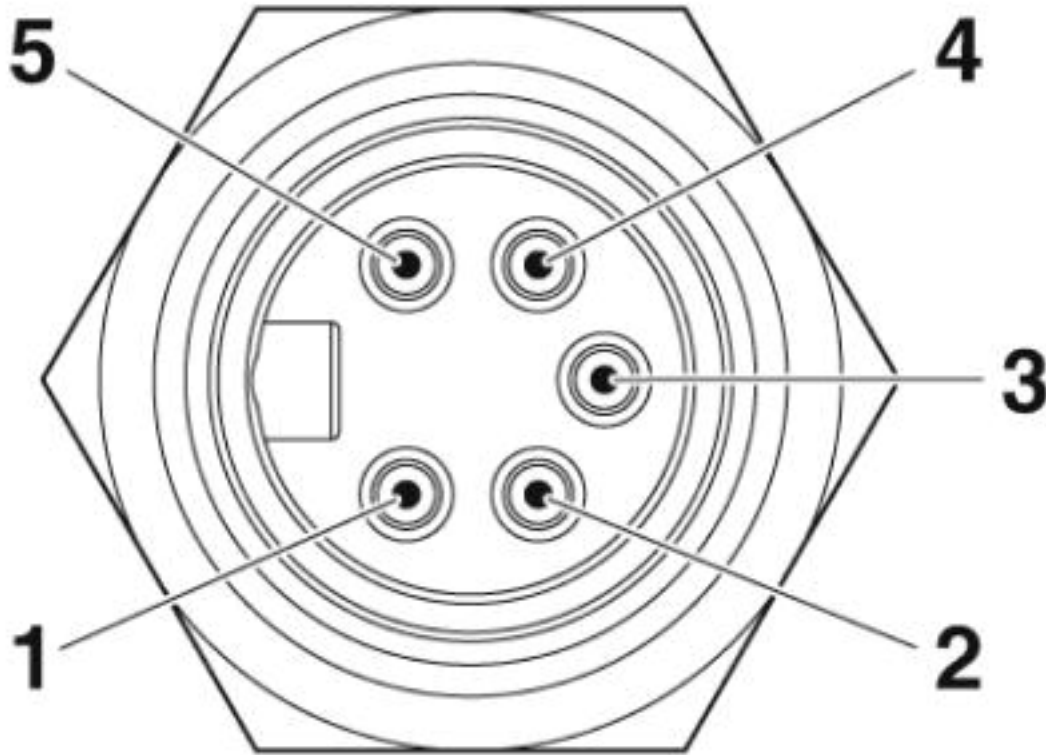

Pin assignment, plug, 7/8"-16UNF, 5-pos., view of male side (reference image)

## Classifications

eCl@ss

eCl@ss 4.0	27140815
eCl@ss 4.1	27140815
eCl@ss 5.0	27143423
eCl@ss 5.1	27143423
eCl@ss 6.0	27143423
eCl@ss 7.0	27449001
eCl@ss 9.0	27440103

ETIM

ETIM 3.0	EC002061
ETIM 4.0	EC002062
ETIM 5.0	EC002635
ETIM 6.0	EC002061

# Flush-type connector - SACC-E-MINM-5CON-NPT12-547/1,0 - 1417766

## Classifications

### UNSPSC

UNSPSC 6.01	31251501
UNSPSC 7.0901	31251501
UNSPSC 11	31251501
UNSPSC 12.01	31251501
UNSPSC 13.2	39121413

## Approvals

### Approvals

#### Approvals

UL Listed / cUL Listed / cULus Listed

#### Ex Approvals

### Approval details

UL Listed		<a href="http://database.ul.com/cgi-bin/XYV/template/LISEXT/1FRAME/index.htm">http://database.ul.com/cgi-bin/XYV/template/LISEXT/1FRAME/index.htm</a>	FILE E 221474
-----------	--	---	---------------

cUL Listed		<a href="http://database.ul.com/cgi-bin/XYV/template/LISEXT/1FRAME/index.htm">http://database.ul.com/cgi-bin/XYV/template/LISEXT/1FRAME/index.htm</a>	FILE E 221474
------------	--	---	---------------

cULus Listed			
--------------	--	--	--

## Accessories

### Accessories

## Flush-type connector - SACC-E-MINM-5CON-NPT12-547/1,0 - 1417766

### Accessories

SACC-1/2 NPT-LOCKNUT - 1020362



Locknut, 1/2 inch-14 NPT thread

---

Seal - SACC-MIN-SEAL - 1020363



Seal for MINI 7/8-inch panel feed through with 1/2 inch-14 NPT thread

---

---