

| | | | |
|--|---|-------------------|-----|
| Product designation | Switch disconnecter with fuse | | |
| Product type designation | GM | | |
| Type of fuse | J | | |
| Number of poles | nr. | 3 | |
| Operating voltage type | AC | | |
| Electrical features | | | |
| Conventional free air thermal current I _{th} IEC/EN | A | 600 | |
| Rated insulation voltage U _i IEC/EN | V | 1000 | |
| Rated impulse withstand voltage U _{imp} | kV | 12 | |
| Operational current I _e | | | |
| | Operating current I _e AC21A 400V | A | 630 |
| | Operating current I _e AC21A 500V | A | 630 |
| | Operating current I _e AC21A 690V | A | 630 |
| | Operating current I _e AC22A 400V | A | 630 |
| | Operating current I _e AC22A 500V | A | 600 |
| | Operating current I _e AC22A 690V | A | 600 |
| | Operating current I _e AC23A 400V | A | 630 |
| | Operating current I _e AC23A 500V | A | 630 |
| | Operating current I _e AC23A 690V | A | 630 |
| Power dissipation per pole max | W | 46 | |
| Power dissipation per pole without fuse | W | 46 | |
| Max fuse power dissipation | | | |
| | in open air | W | 50 |
| | in enclosure | W | 50 |
| Rated operational power AC23A | | | |
| | 400V | kW | 355 |
| | 690V | kW | 630 |
| Rated short time current (1s) I _{cw} (rms) | kA | 20000 | |
| Short-circuit protection with fuse | Class/A | J/600 | |
| Making capacity AC23A 400V | A | 6300 | |
| Breaking capacity AC23A 400V | A | 6400 | |
| Operations | | | |
| Mechanical life | Cycles | 5000 | |
| Electrical life AC21A | Cycles | 1000 (AC23A 400V) | |
| Ambient conditions | | | |
| Operating temperature | | | |
| | min | °C | -25 |
| | max | °C | 55 |
| Storage temperature | | | |
| | min | °C | -40 |
| | max | °C | 70 |
| Max altitude | m | 3000 | |
| Mechanical features | | | |
| Operational position | | | |
| | Operating position normal | Vertical plan | |
| | Operating position allowable | Any | |
| Fixing | | Screw | |
| Terminals | | | |
| | type | Bar | |
| Tightening torque for terminals | | | |

| | | | |
|--|-----|-----------------|---------|
| | max | Nm | 56.5 |
| | max | lbin | 41.6 |
| Tightening torque for fuse links bolts | | Nm | 40 |
| Tightening torque for terminal lug | | Nm | 54 |
| Conductor section | | min (AWG/kcmil) | (2x) 2 |
| Terminal kit lugs | | | GMX504 |
| Frontal IP degree | | | IP20 |
| Pollution degree | | | 3 |
| UL technical data | | | |
| Compliance | | | UL98 |
| General purpose current rating | | A | 600 |
| Operating voltage max | | V | 600 |
| Horsepower/FLA current three phase motor | | 240V | 200/480 |
| | | 480V | 400/477 |
| | | 600V | 500/472 |
| Short circuit rating | | kA rms | 200 |
| Short circuit rating with fuse | | Class/A | J/600 |

Dimensions

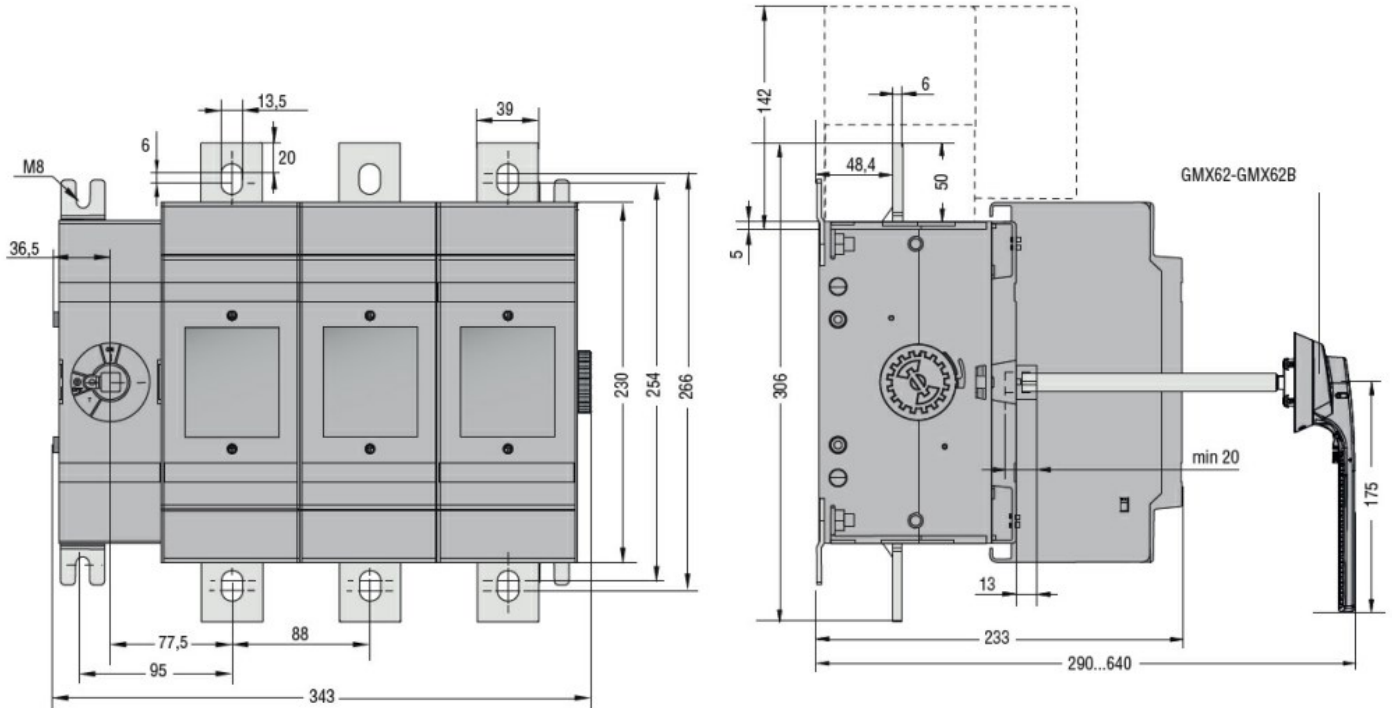

Wiring diagrams

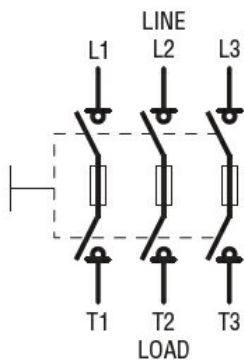

Certifications and compliance

Compliance

IEC/EN 60947-1

IEC/EN 60947-3

Certifications

cULus according to UL98/CSA C22.2 n°4