



## | P993

### Low Range Differential Pressure PCB Mount Sensor

The P993 series of pressure sensors incorporates a silicon capacitive sensing element in a compact package. Using a 5 VDC input, the sensors provide a 0.25 to 4.0 VDC output proportional to pressure. Internal temperature compensation provides an accurate, easy to use device. The innovative design eliminates mounting position effects found on other low pressure differential sensors currently available in the market.



#### Features

- Rugged PCB Mount Package
- Amplified Temperature Compensated
- Linear Output
- No Position Sensitivity
- EMI/RFI & ESD Protected
- Superior Output Signal Stability

#### Applications

- Variable Air Volume Systems (VAV)
- Filter Pressure Monitoring Duct Air
- Flow Modulated Furnace Controls
- Combustion Air Flow Gaseous
- Leak Detection



#### MAIN FEATURES

<b>Pressure Ranges</b>	2, 5, 10, $\pm 1$ , $\pm 2$ , $\pm 5$ Inches of H <sub>2</sub> O
<b>Electrical Connection</b>	3 solderable pins, tin plated
<b>Pressure Connection</b>	1/8" diameter tube fitting with barb
<b>Housing Material</b>	PET 30% glass reinforced, flame retardant
<b>Output Signal</b>	0.25 VDC – 4 VDC



#### TECHNICAL SPECIFICATIONS

##### Pressure Ranges

From 0 to ...	Inch of H <sub>2</sub> O	2	5	10	$\pm 1$	$\pm 2$	$\pm 5$
<b>Proof Pressure</b>	PSI	1	1	1	1	1	1
<b>Burst pressure</b>	PSI	1.5	1.5	1.5	1.5	1.5	1.5



Physical

<b>Operating Life Cycle</b>	min. 10 million full pressure cycles over the full range
<b>Vibration Resistance</b>	1 G from 20 to 1200 Hz
<b>Shock Resistance</b>	10 G's at 6 ms duration
<b>Drop Test</b>	1m onto concrete surface
<b>Weight</b>	≤ 20 grams (without mating connector)
<b>Operating Temperature</b>	-10°C to + 60°C
<b>Storage Temperature</b>	- 40°C to + 95°C
<b>Media</b>	Air

Performance

<b>Total Error Band</b>	±2% of span Max. (±3% for 0 - 1" range) (10°C ≤ T ≤ 40°C)
-------------------------	---

Electrical

<b>Output Signal</b>	0.25 to 4 VDC Ratiometric
<b>Power Consumption</b>	≤ 20 mW
<b>Operating Supply Signal</b>	5 VDC ± 5%
<b>Overvoltage Protection</b>	min. 16 VDC
<b>Short-circuit Proofness</b>	Yes *1
<b>Reverse Polarity Protection</b>	Yes *2
<b>Output Impedance</b>	100 Ω Max

- 2. for min. 3 intervals at 5 minutes each
- 3. for min. 10 seconds on assigned pins



DIMENSIONS

Dimensions in mm [Inch]

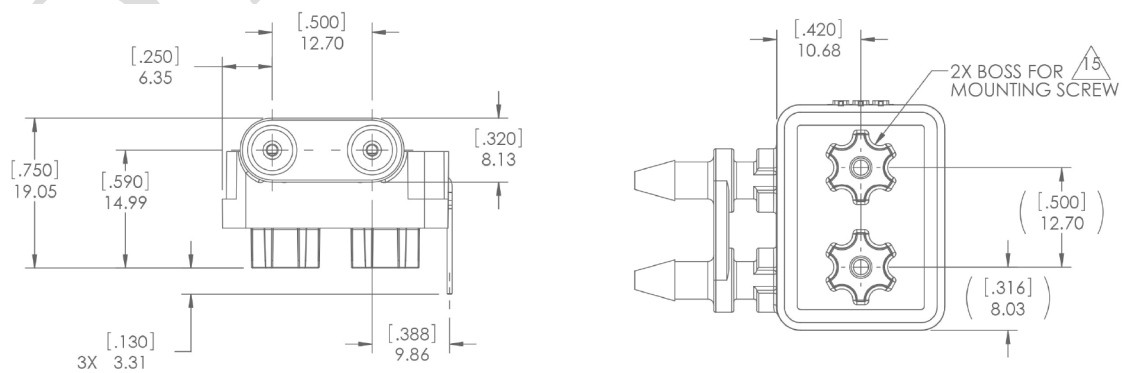



## ORDERING OPTIONS

Example: P993-5B

P993 Pressure Sensor, ±5" H2O.

P993 - XX

### Family

P993

### Pressure Ranges

- 1B: ± 1" H2O
- 2: 0 - 2.0" H2O
- 2B: ± 2" H2O
- 5: 0 - 5.0" H2O
- 5B: ± 5" H2O
- 10: 0 - 10" H2O



## AGENCY APPROVALS & CERTIFICATIONS



2002/95/EC ROHS Directive



## WARNINGS



### RISK OF MATERIAL DAMAGE AND HOT ENCLOSURE

- The product's side panels may be hot, allow the product to cool before touching
- Follow proper mounting instructions including torque values
- Do not allow liquids or foreign objects to enter this product

**Failure to follow these instructions can result in serious injury, or equipment damage.**



### HAZARD OF ELECTRIC SHOCK, EXPLOSION OR ARC FLASH

- Disconnect all power before installing or working with this equipment
- Verify all connections and replace all covers before turning on power

**Failure to follow these instructions will result in death or serious injury.**

Datasheets provided by Sensata Technologies, Inc., its subsidiaries and/or affiliates ("Sensata") are solely intended to assist third parties ("Buyers") who are developing systems that incorporate Sensata products (also referred to herein as "components"). Buyer understands and agrees that Buyer remains responsible for using its independent analysis, valuation, and judgment in designing Buyer's systems and products. Sensata datasheets have been created using standard laboratory conditions and engineering practices. Sensata has not conducted any testing other than that specifically described in the published documentation for a particular datasheet. Sensata may make corrections, enhancements, improvements, and other changes to its datasheets or components without notice.

Buyers are authorized to use Sensata datasheets with the Sensata component(s) identified in each particular datasheet. HOWEVER, NO OTHER LICENSE, EXPRESS OR IMPLIED, BY ESTOPPEL OR OTHERWISE TO ANY OTHER SENSATA INTELLECTUAL PROPERTY RIGHT, AND NO LICENSE TO ANY THIRD PARTY TECHNOLOGY OR INTELLECTUAL PROPERTY RIGHT, IS GRANTED HEREIN. SENSATA DATASHEETS ARE PROVIDED "AS IS". SENSATA MAKES NO WARRANTIES OR REPRESENTATIONS WITH REGARD TO THE DATASHEETS OR USE OF THE DATASHEETS, EXPRESS, IMPLIED, OR STATUTORY, INCLUDING ACCURACY OR COMPLETENESS. SENSATA DISCLAIMS ANY WARRANTY OF TITLE AND ANY IMPLIED WARRANTIES OF MERCHANTABILITY, FITNESS FOR A PARTICULAR PURPOSE, QUIET ENJOYMENT, QUIET POSSESSION, AND NON-INFRINGEMENT OF ANY THIRD PARTY INTELLECTUAL PROPERTY RIGHTS WITH REGARD TO SENSATA DATASHEETS OR USE THEREOF.

All products are sold subject to Sensata's terms and conditions of sale supplied at [www.sensata.com](http://www.sensata.com) SENSATA ASSUMES NO LIABILITY FOR APPLICATIONS ASSISTANCE OR THE DESIGN OF BUYERS' PRODUCTS. BUYER ACKNOWLEDGES AND AGREES THAT IT IS SOLELY RESPONSIBLE FOR COMPLIANCE WITH ALL LEGAL, REGULATORY, AND SAFETY-RELATED REQUIREMENTS CONCERNING ITS PRODUCTS, AND ANY USE OF SENSATA COMPONENTS IN ITS APPLICATIONS, NOTWITHSTANDING ANY APPLICATIONS-RELATED INFORMATION OR SUPPORT THAT MAY BE PROVIDED BY SENSATA.

Mailing Address: Sensata Technologies, Inc., 529 Pleasant Street, Attleboro, MA 02703, USA.

## CONTACT US

### Americas

+1 (800) 350 2727  
[sensors@sensata.com](mailto:sensors@sensata.com)  
[switches@sensata.com](mailto:switches@sensata.com)

### Europe, Middle East & Africa

+359 (2) 809 1826  
[pressure-info.eu@sensata.com](mailto:pressure-info.eu@sensata.com)

### Asia Pacific

[sales.isasia@list.sensata.com](mailto:sales.isasia@list.sensata.com)  
 China +86 (21) 2306 1500  
 Japan +81 (45) 277 7117  
 Korea +82 (31) 601 2004  
 India +91 (80) 67920890  
 Rest of Asia +886 (2) 27602006  
 ext 2808