

Customer Information Sheet

DRAWING No.: P13-XX23

SHEET 2 OF 2

IF IN DOUBT - ASK



NOT TO SCALE

THIRD ANGLE PROJECTION

ALL DIMENSIONS IN mm

ORDER CODE:
P13-XX23
PROBE HEAD _____
VARIANT (SEE BELOW)

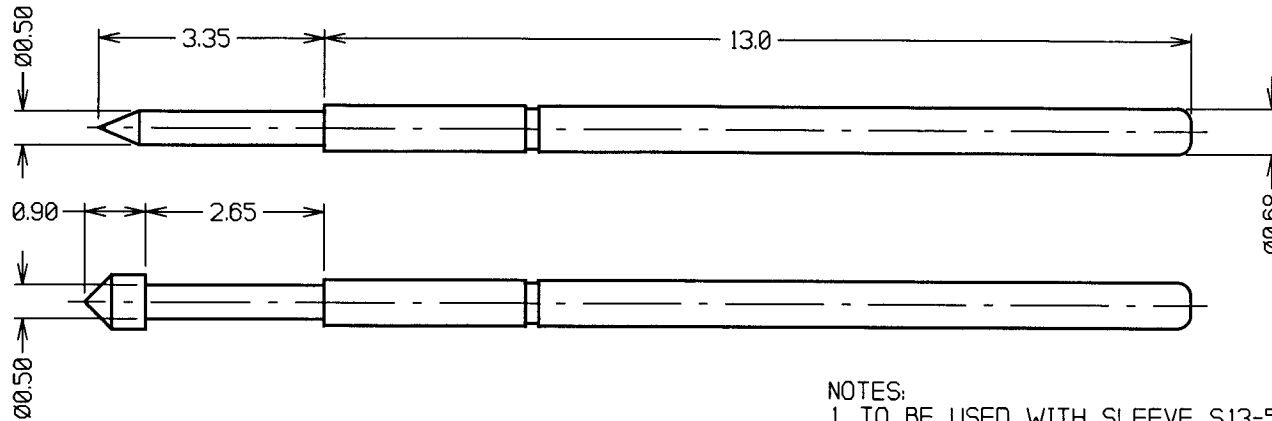

- NOTES:
1. TO BE USED WITH SLEEVE S13-503.
 2. SUITABLE FOR A MINIMUM DISTANCE BETWEEN CENTRES OF 1.27mm.

PROBE HEAD VARIANTS

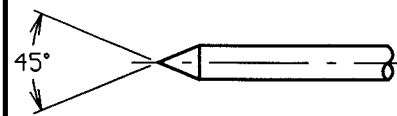

SPEAR HEAD
P13-0123

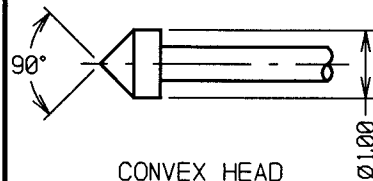

CONVEX HEAD
P13-2123

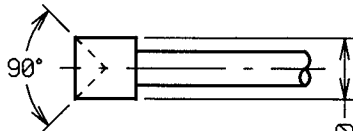

CONCAVE HEAD
P13-1123

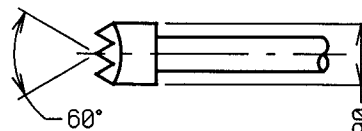

SERRATED HEAD
P13-4023

SPECIFICATIONS:

MATERIAL:

PLUNGER = BERYLLIUM COPPER
BARREL = PHOSPHOR BRONZE
SPRING = MUSIC WIRE

FINISH:

PLUNGER = RHODIUM OVER HARD NICKEL
BARREL = GOLD
SPRING = GOLD

ELECTRICAL:

CURRENT RATING = 3A
CONTACT RESISTANCE = 30 MILLIOHMS

MECHANICAL:

DURABILITY = 1,000,000 CYCLES
FULL TRAVEL = 2.65mm
SPRING FORCES:

AT FULL TRAVEL = 1.18N ±0.24N (120g ±20%)
AT 2/3 TRAVEL = 0.88N ±0.18N (90g ±20%)

2	07.03.01	5730
ISS.	DATE	REV/NOTE
APPROVED: <i>[Signature]</i>		
CHECKED: <i>[Signature]</i>		
DRAWN: W. J. BOURNE		
CUSTOMER REF.:		
ASSEMBLY DRG.:		

HARWIN

THIS DRAWING AND ANY INFORMATION OR DESCRIPTIVE MATTER SET OUT HEREON ARE CONFIDENTIAL AND COPYRIGHT PROPERTY OF THE HARWIN GROUP AND MUST NOT BE DISCLOSED, LOANED, COPIED OR USED FOR MANUFACTURING, TENDERING OR FOR ANY OTHER PURPOSE WITHOUT THEIR WRITTEN PERMISSION.

TOLERANCES

X. - ±1mm
X.X - ±0.25mm
X.XX - ±0.10mm
X.XXX - ±0.01mm
ANGLES = ±1°
UNLESS STATED

MATERIAL:

SEE ABOVE

FINISH:

SEE ABOVE

S/AREA:

mm²

TITLE:

1.27mm MIN. CENTRE
TWO-PIECE SPRING PROBE

DRAWING NUMBER:

P13-XX23

HARWIN INC
U.S.A.
TEL: (812) 285 0055
FAX: (812) 285 0056

HARWIN PLC
U.K.
TEL: 023 9237 0451
FAX: 023 9231 4590

HARWIN PTE
SINGAPORE
TEL: 65 7794909
FAX: 65 7793868

SHT
2
OF
2