

PRODUCT NUMBER
95615-XXXXLF

PLATING
(AS AVAILABLE)

- 0 = 0.20µm GOLD/GXT ON CONTACT AREA
2µm MIN MATTE TIN ON TAIL
- 1 = 0.76µm GOLD/GXT ON CONTACT AREA
2µm MIN MATTE TIN ON TAIL
- 3 = 0.38µm GOLD/GXT ON CONTACT AREA
2µm MIN MATTE TIN ON TAIL
- 5 = 0.38µm GXT FULL PLATED
- 6 = 0.76µm GXT FULL PLATED
- 7 = 0.76µm GOLD/GXT FULL PLATED
- 9 = 0.20µm GOLD/GXT FULL PLATED
- 1.27µm Ni MIN UNDERPLATING

RoHS COMPATIBLE, SEE NOTE 6
PACKAGING, SEE NOTE 5
(MAY BE SUBJECT TO TOOLING FEES)
TOTAL NB OF POSITIONS, 08 TO 34

EXTENDED RANGE

- TOOLING FEASIBILITY CONFIRMED
- SAMPLES ON DEMAND
- AVAILABILITY ON DEMAND

STANDARD PICK-UP CAP

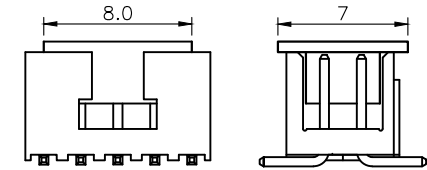
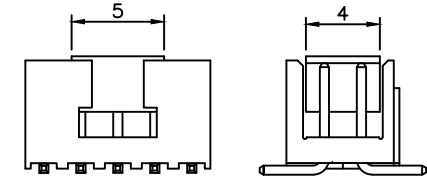

LARGE PICK-UP CAP NOTE 5
NOT AVAILABLE FOR 2X2

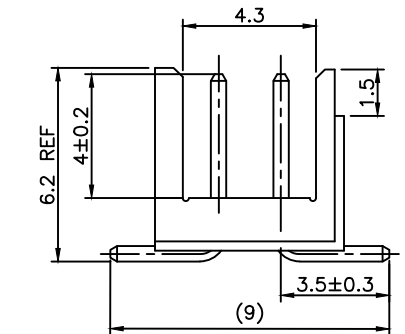
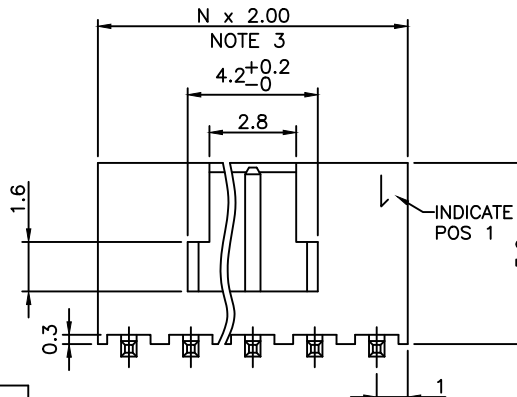
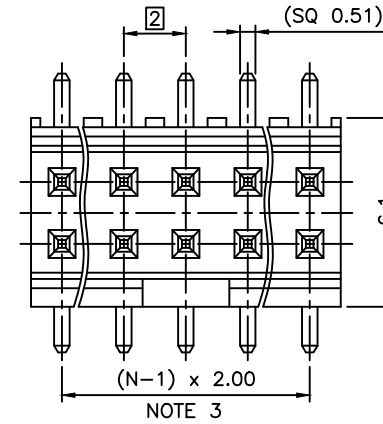

NOTES:

- 1 - MATERIAL HOUSING: HIGH TEMP. THERMOPLASTIC UL 94V-0, COLOR CREAM
- 2 - MATERIAL TERMINAL: COPPER ALLOY
- 3 - TO DETERMINE DIMENSIONS:
N = NUMBER OF POSITIONS PER ROW
- 4 - 7N MIN. PIN RETENTION IN EITHER DIRECTION.
- 5 - PACKAGING:
= POLYBAGS
T = TUBE AVAILABILITY : FROM 2x5 UP TO 2x17
B = TUBE WITH PICK UP CAP AVAILABLE FROM 2x5 UP TO 2x17
K = TAPE AND REEL WITHOUT PICK-UP CAP, AS AVAILABLE
A = TAPE AND REEL WITH LARGE PICK-UP CAP, AS AVAILABLE
TR = TAPE AND REEL WITH PICK-UP CAP, AS AVAILABLE.
- 6 - RoHS COMPATIBLE PRODUCT SPECIFICATIONS
 - a - PLATING:
- "LF" MEANS THE PRODUCT IS LEAD-FREE, 2µm MINIMUM MATTE TIN OVER 1.27µm MINIMUM NICKEL UNDERPLATE.
 - b - MANUFACTURING PROCESS COMPATIBILITY
- THE HOUSING WILL WITHSTAND EXPOSURE TO 260°C PEAK TEMPERATURE FOR 30 SECONDES MAX IN A CONVECTION, INFRA-RED OR VAPOR PHASE OR REFLOW OVEN.
 - c - LABELLING:
- MEETS PACKAGING SPECS AS PER GS-14-920
 - d - THIS PRODUCT MEETS EUROPEAN DIRECTIVES AND OTHER COUNTRY REGULATIONS AS DISCRIBED IN GS-47-0004.
- 7 - THIS PART SERIES IS NOT INITIALLY INTENDED FOR AUTOMOTIVE APPLICATIONS. ADDITIONAL FEES ARE CHARGEABLE FOR ANY ADDITIONAL QUALIFICATION AND TEST REPORTS PERFORMED OUTSIDE THE SCOPE OF THE STANDARD PRODUCT SPECIFICATIONS.
- 8 - UNLESS OTHERWISE APPROVED BY AMPHENOL, ALL PARTS AND COMPONENTS ARE DESIGNED & BUILT ACCORDING TO AMPHENOL'S SPECIFICATIONS WHICH ARE SUBJECT TO CHANGE WITHOUT NOTICE.

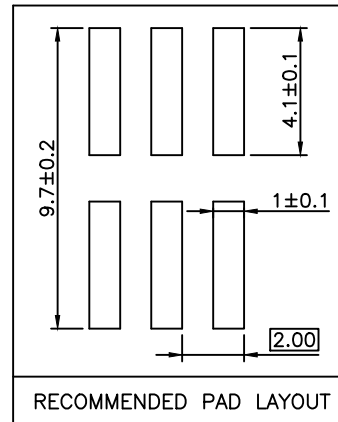

mat'l. code		surface		tolerance		projection		product family	
		ISO 1302		ISO 406 ISO 1101		mm		MINITEK HEADER	
ltr	ecn no	dr	date	tolerances unless otherwise specified		mm		title	
T	F-23051	AMA	16.01.15	angles	linear			SHROUDED HEADER	
U	F-49571	DDE	23.10.25					2.00mm SMT	
V	F-55060	DDE	25.03.20			scale 7:1		dwg no	
				dr	JL.CORDIER	97.07.26			sheet 1 of 1
P	F11-0071	JCO	11.06.17	engr	J.COMPAGNON	97.07.26			size
R	F11-0339	JCO	11.12.06	chr	JL.CORDIER	97.07.26			A3
S	B-19190	LMU	14.10.24	appd	J.COMPAGNON	97.07.26			type
sheet	revision								
index	sheet								

Copyright FCI
 Amphenol FCI
 FCconnect.com