

PRODUCT NUMBER  
77773-YXXLF

RoHS COMPATIBLE, SEE NOTE 7

PLATING

3=0.76µm GOLD/GXT ON CONTACT AREA  
2µm MIN MATTE TIN ON TAIL  
4=2µm MIN MATTE TIN FULL PLATED  
1.27µm Ni MIN UNDERPLATING

| STYLE | SIZE | OMIT PIN POSITION FROM TOP VIEW               |
|-------|------|---|
| 01    | 1x09 | 2   |
| 02    | 1x35 | 4;5;6;7;8;12;13;14;15;16;20;21;22;23;24;28;32 |
| 03    | 1x21 | 2;4;6;8;10;12;14;16;18;20;21                  |
| 04    | 1x21 | 1;2;4;6;8;10;12;14;16;18;20                   |
| 05    | 1x10 | 8   |
| 06    | 1x06 | 1   |
| 07    | 1x08 | 7   |
| 08    | 1x04 | 2   |
| 09    | 1x04 | 3   |
| 12    | 1x21 | 2;4;6;8;10;12;14;16;18;20                     |
| 13    | 1x05 | 2;4   |
| 14    | 1x03 | 2   |
| 15    | 1x25 | 1;3;5;7;9;11;13;15;17;19;21;23;25             |
| 16    | 1x07 | 5   |

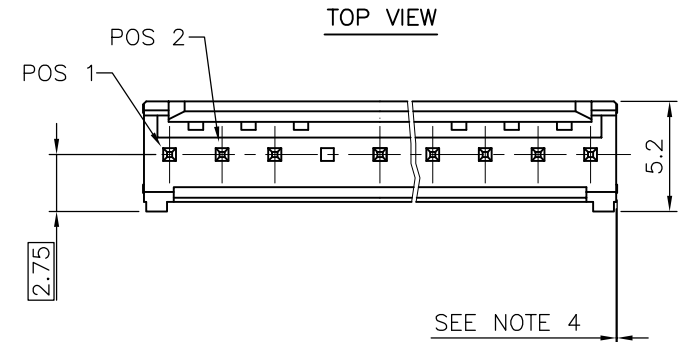

NOTES:

- BODY MATERIAL: POLYESTER 30% GLASSFILLED COLOR BLUE, FLAME RETARDANT PER UL-94 V0.
- CONTACT MATERIAL: PHOSPHOR BRONZE.
- 15N MIN PIN RETENTION IN EITHER DIRECTION
- 0.6 MAX PROTRUSION PERMITTED AT 4 PLACES
- PACKAGING :  
- POLYBAGS FROM 02 TO 18 POSITIONS  
- TUBE FROM 19 TO 36 POSITIONS
- TO DETERMINE DIMENSIONS :  
N = NUMBER OF POSITIONS PER ROW  
EXAMPLE : 8 POS N x 2.54 = 20.32mm
- RoHS COMPATIBLE PRODUCT SPECIFICATIONS

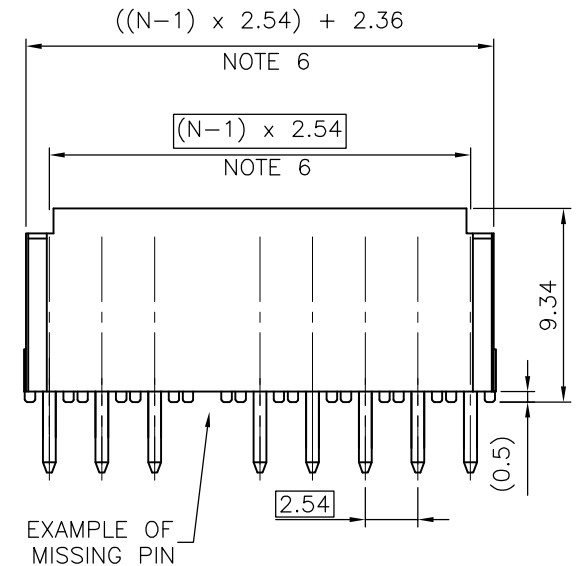
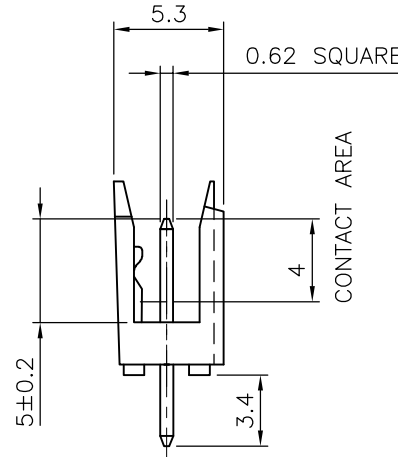

- PLATING:  
- "LF" MEANS THE PRODUCT IS LEAD-FREE, 2µm MINIMUM MATTE TIN OVER 1.27µm MINIMUM NICKEL UNDERPLATE.
- MANUFACTURING PROCESS COMPATIBILITY  
- THE HOUSING WILL WITHSTAND EXPOSURE TO 245°C ±5°C SOLDER BATH TEMPERATURE FOR 5 SECONDS IN A WAVE SOLDER APPLICATION WITH A 1.6mm MIN THICK CIRCUIT BOARD.
- LABELING:  
- MEETS PACKAGING SPECS AS PER GS-14-920
- LEGAL STATEMENT: SEE GS-47-0004

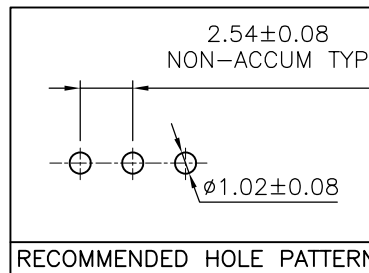

|                        |          |                     |          |                                       |             |                  |  |                             |  |
|------------------------|----------|---------------------|----------|---------------------------------------|-------------|------------------|--|-----------------------------|--|
| mat'l. code<br>SEE P/N |          | surface<br>ISO 1302 |          | tolerance<br>ISO 406 ISO 1101         |             | projection<br>mm |  | product family<br>DUBOX HDR |  |
| ltr                    | ecn no   | dr                  | date     | tolerances unless otherwise specified |             | mm               |  | title                       |  |
| V                      | F08-0147 | YOV                 | 08.04.14 | angles                                | .X ±0.3     | mm               |  | DUBOX,SR,STR                |  |
| W                      | F09-0028 | LMU                 | 09.03.11 | linear                                | .XX ±0.15   | scale 4:1        |  | SELECTIVELY LOADED          |  |
| X                      | B-19285  | AMA                 | 14.11.03 |                                       | .XXX ±0.05  |                  |  | dwg no                      |  |
| Y                      | F-21810  | AMA                 | 15.06.19 | dr                                    | COMPAGNON J | 95.03.06         |  | sheet 1 of 1                |  |
| AA                     | F-22862  | LMU                 | 15.12.22 | engr                                  | PHAMVAN JM  | 95.03.06         |  | size                        |  |
| AB                     | F-36003  | LMU                 | 20.01.29 | chr                                   | JMC         | 95.04.04         |  | 77773                       |  |
|                        |          |                     |          | appd                                  | JMP         | 95.04.04         |  | A3                          |  |
| sheet index            |          | revision sheet      |          |                                       |             |                  |  | type                        |  |
|                        |          |                     |          |                                       |             |                  |  | CUSTOMER Drawing            |  |