

LEAD FREE P/N
70264-XYLFF

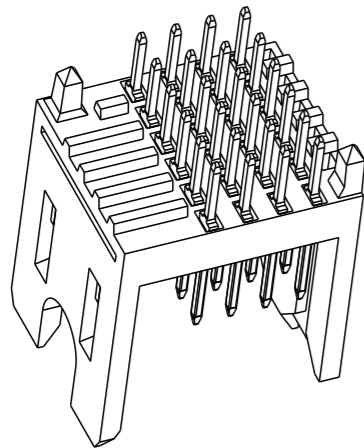
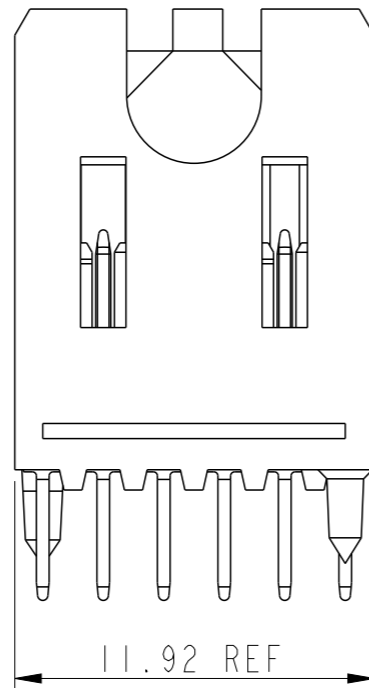
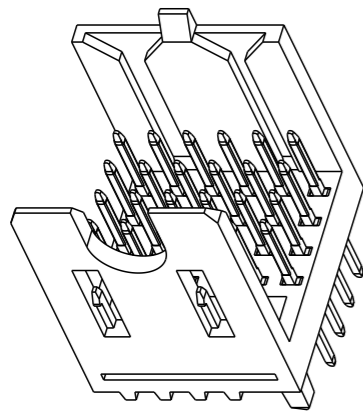
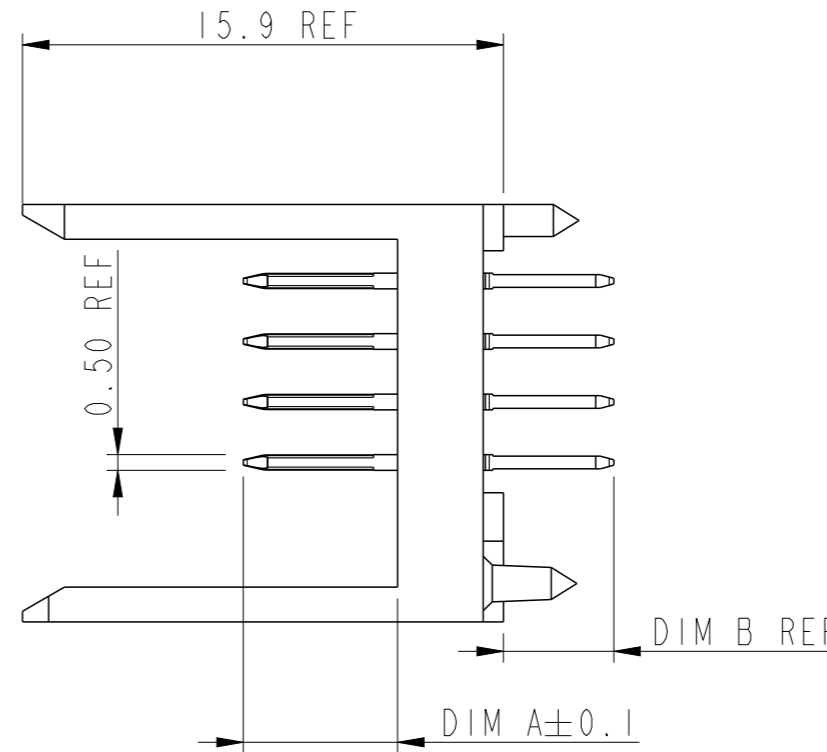
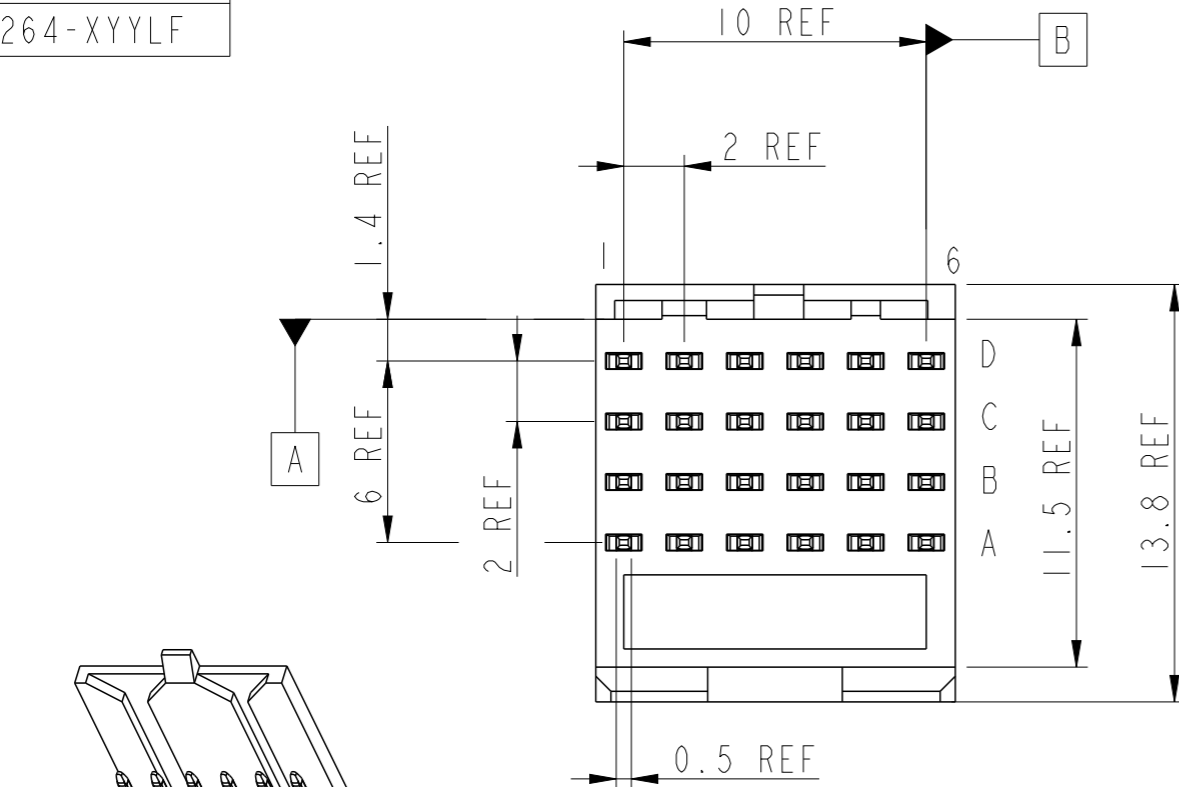

NOTES :

- FOR DIM A AND DIM B, SEE SHEET 2 AND UP.
- MATERIAL: BODY : LCP UL94-V0
CONTACT : COPPER ALLOY. $\triangle M$
- FOR PLATING PERFORMANCE REFER DRAWING # 10159408 $\triangle M$
- ALL PRODUCTS WITH PART NUMBERS SHOWN IN SUBSEQUENT TABLES WILL BE PACKAGED IN TUBES.
- THIS PRODUCT MEETS EUROPEAN UNION DIRECTIVES AND OTHER COUNTRY REGULATIONS AS DESCRIBED IN GS-47-0004. $\triangle M$
- ALL PRODUCTS WILL WITHSTAND EXPOSURE TO 260°C FOR 60 SECONDS IN A CONVENTION INFRARED OR VAPOR PHASE REFLOW OVEN. $\triangle M$
- A $\triangle M$ SYMBOL WILL BE NEXT TO ANY DIMENSION, VIEW, OR NOTE WHICH HAS BEEN MODIFIED WITH THE CURRENT DRAWING REVISION.

GENERAL CHARACTERISTICS AND RoHS INFORMATIONS:
SEE DRAWING C-8626-000S

spec ref	-	dr	Terran Huang	2010/07/09	projection	mm	size	A3	scale	4:1	
tolerance std	ISO 406 ISO 1101	eng	Narayanan, Aru	2020/11/17		← →	ecn no	ELX-I-38997-1			
TOLERANCES UNLESS OTHERWISE SPECIFIED		chr	-	-			product family	mdl.param.value	rel level	Released	
mdl.param.value	linear	0.X	±0.3	Amphenol FCI	METRAL SIGNAL STRAIGHT HEADER		dwg no	70264		rev	M
		0.XX	±0.13		1 MODULE 4 ROW STB NARROW BODY						
		0.XXX	±0.050		cat. no.	mdl.param.value	Product - Customer Drw	sheet 1 of 3			
	angular	0°	±2°								

A

B

C

D

A

B

C

D

Amphenol
FCi

© 2016 AFCI

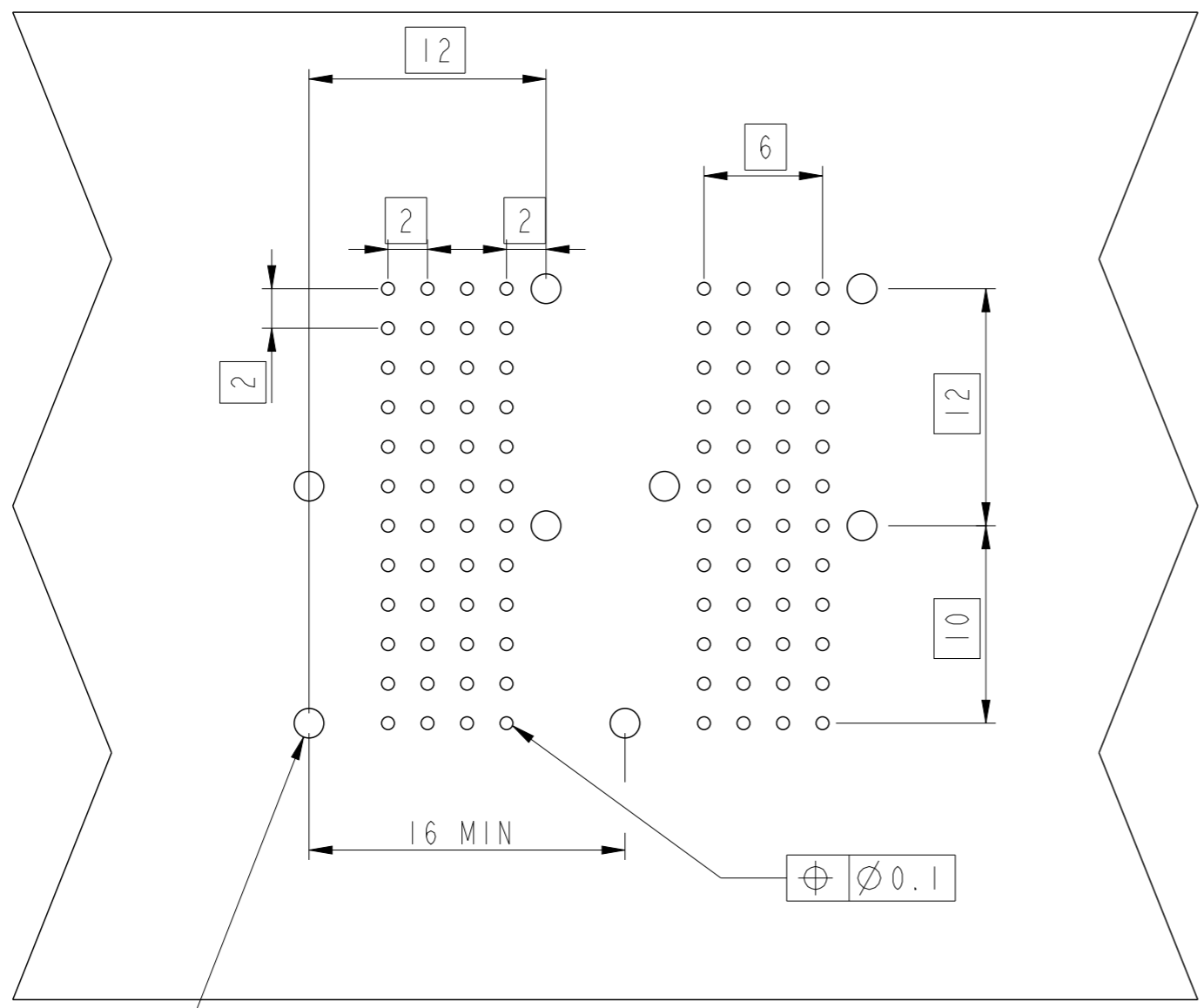

KEY		
CODE	DIMENSIONS	
	DIM A MATE	DIM B TAIL
1	5.00	4.25
2	5.75	4.25
3	6.50	4.25
4	7.25	4.25
5	5.00	3.6
6	5.75	3.6
7	6.50	3.6
8	7.25	3.6

$\phi 1.5^{+0.1}$
 $\oplus \phi 0.1$
 UNPLATED HOLES

REQUIRED PCB LAYOUT
 COMPONENT SIDE
 FOR PTH DETAILS REFER DRAWING 58351

spec ref	-	dr	Terran Huang	2010/07/09	projection	mm	size	A3	scale	3:1	
tolerance std	ISO 406 ISO 1101	eng	Narayanan, Aru	2020/11/17			ecn no	ELX-I-38997-1			
TOLERANCES UNLESS OTHERWISE SPECIFIED		chr	-	-			rel level	Released			
mdl.param.value	linear	appr	Kuriakose, San	2020/11/17	product family	mdl.param.value	cat. no.	mdl.param.value	Product - Customer Drw	sheet 2 of 3	
	0.X				METRAL SIGNAL STRAIGHT HEADER		dwg no	70264		rev	M
	0.XX				I MODULE 4 ROW STB NARROW BODY						
	0.XXX										
	angular	0°	±2°								

