

PRODUCT NUMBER
10135248-4XX-XXLF

PLATING
FULL TIN 2.5µm MIN
UNDERPLATING 1.27µm Ni MIN

NOTES 4 & 5
NB OF CONTACTS
PACKAGING, NOTE 3

PIN STYLE	DIM "E" +0.03 -0.27	DIM "C"
01	9.90	7.62
02	11.58	10.16

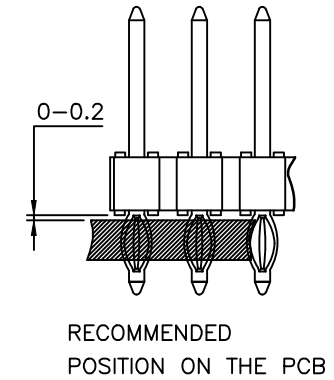
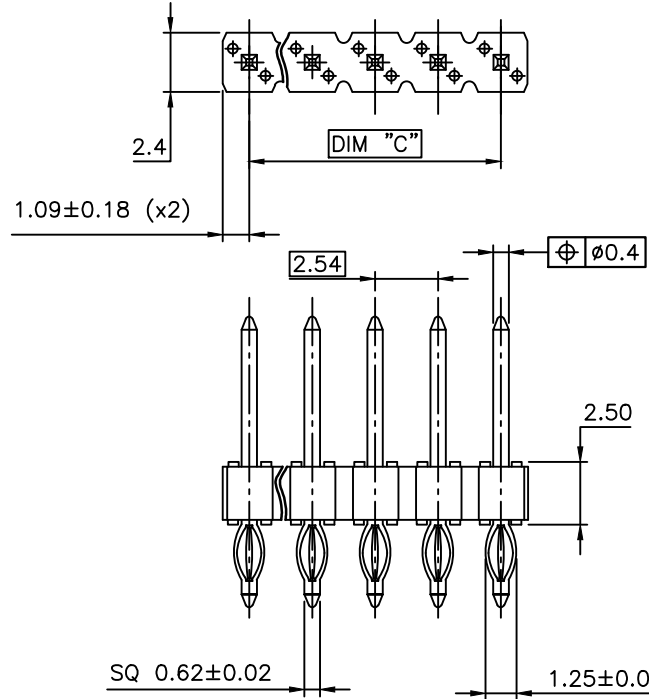

NOTES:

- HOUSING MAT'L : HIGH TEMPERATURE THERMOPLASTIC. UL94V-0 COLOR: BLACK
- PIN MATERIAL : PHOSPHOR BRONZE
a- AUTOMOTIV PIN TIP DESIGN
- PACKAGING
- = POLYBAGS
K = TAPE AND REEL WITHOUT PICK-UP CAP.
- LEAD FREE CONNECTOR
- "LF" MEANS THAT THE PRODUCT IS RoHS COMPLIANT THEN MEETS EUROPEAN UNION DIRECTIVES AND OTHER COUNTRY REGULATION AS DESCRIBED IN GS-47-004

THE HOUSING WILL WITHSTAND EXPOSURE TO 260°C PEAK TEMPERATURE IN ACCORDANCE WITH RECOMMENDED REFLOW CURVE PAGE 2 AND JEDEC J-STD-020.

- 9N MIN RETENTION IN EITHER DIRECTION

mat'l. code		surface ISO 1302 ✓ ISO 406 ISO 1001		tolerance tolerances unless otherwise specified	projection mm	product family BSTIK	
ltr	ecn no	dr	date	angles	Linear	title HEADER PF RET SINGLE ROW	
A	---	LMU	15.06.04	.x ±0.3	mm	dwg no	
B	F-23027	AMA	16.01.13	.xx ±0.15	scale 5:1	sheet 1 of 2 size	
C	F-23284	AMA	16.02.18	.xxx ±0.05		10135248 A3	
		dr	B.VERNIER	15.05.11	FCJ		type
		enr	L.MULIN	15.05.11			CUSTOMER Drawing
		chr	J.COMPAGNON	15.05.11			
		appd					
sheet index	revision sheet	C	B				
		1	2				

