

RoHS COMPLIANT 551-3107F
 Part Numbers with the "F" suffix ending are RoHS Compliant.
 Packaging is marked with "RoHS Compliant" label or equivalent markings. Parts can be wave soldered, dip soldered or hand soldered using typical lead-free soldering process with max 260°C temp. for 5 sec.

REV	REVISIONS	DRN	CKD	APP	DATE
A	NEW RELEASE	TWC	TC	NO	9-25-05
B	ADDED NOTES 1 & 2; ADDED DOMINANT WAVELENGTH; ADDED MAX LUMINOUS INT.; REVERSE CURRENT & VOLTAGE; ADDED DUAL DIMENSIONS; REVISED TOLERANCES.	AJF	KLJ	NO	2-2-10
C	UPDATED INTENSITY, DOMINANT WAVELENGTH, REVERSE CURRENT AND POWER DISSIPATION	LD		NO	9-10-21

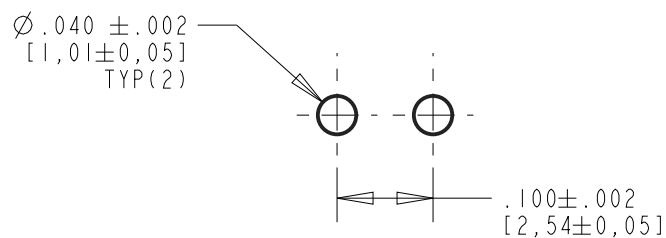
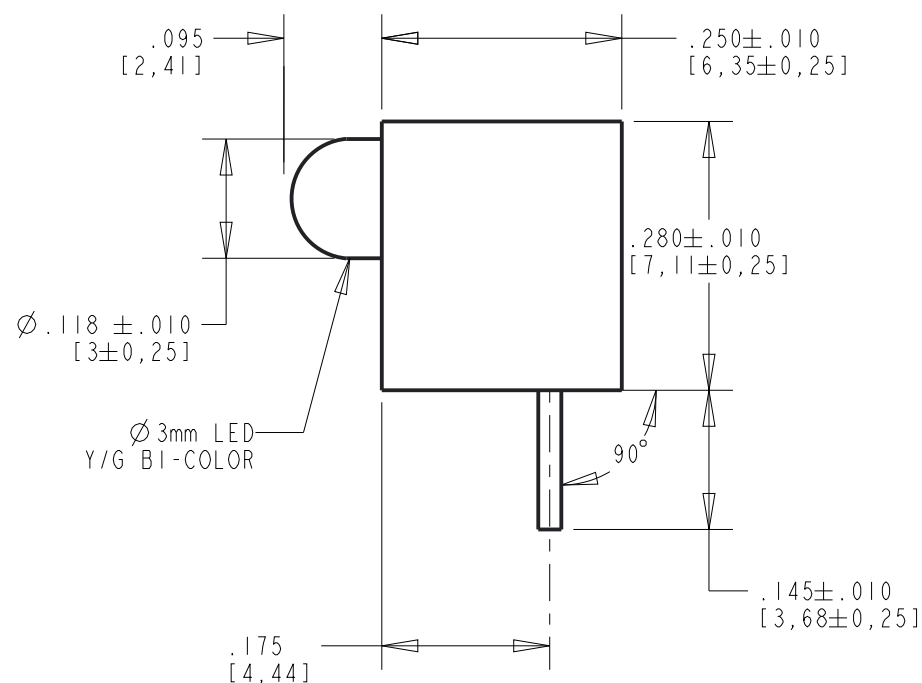
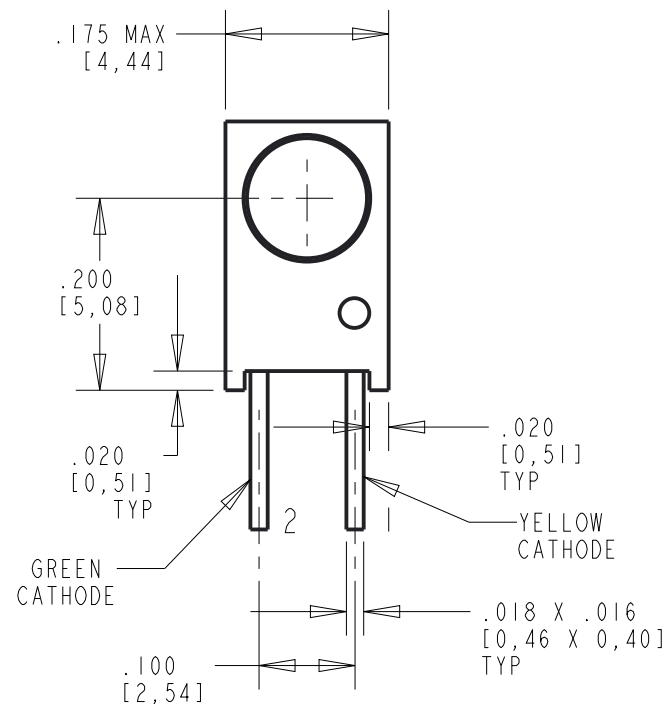

RECOMMENDED HOLE PATTERN GAUGE

LED COLOR = YELLOW/GREEN BI-COLOR						
OPERATING CHARACTERISTICS AT 25°C AMBIENT						
CHARACTERISTICS	COLOR	MIN	TYP	MAX	UNITS	TEST CONDITIONS
LUMINOUS INTENSITY	YELLOW	3.8		11.0	mcd	I _F = 10 mA
	GREEN	6.5		18.0		
FORWARD VOLTAGE	YELLOW	1.8	2.1	2.6	V	I _F = 20 mA
	GREEN	1.8	2.1	2.6		
PEAK WAVELENGTH	YELLOW		585		nm	
	GREEN		565			
DOMINANT WAVELENGTH	YELLOW	583	588	593	nm	
	GREEN	564	569	574		
REVERSE CURRENT	ALL			10	μA	V _R = 5V
VIEWING ANGLE	ALL		80		Degree	

ABSOLUTE MAXIMUM RATING AT 25°C AMBIENT			
	UNITS	YELLOW	GREEN
POWER DISSIPATION	mW	52	72
CONTINUOUS FORWARD CURRENT	mA	20	30
DERATE LINEARLY FROM 50°C	mA/°C	0.25	0.40
PEAK FORWARD CURRENT (1/10 DUTY CYCLE, 0.1 ms PULSE WIDTH)	mA	80	120
LEAD SOLDERING TEMPERATURE, 6 SEC., 1/16" FROM BASE	°C	260	
OPERATING TEMPERATURE	°C	-55 TO 100	
STORAGE TEMPERATURE	°C	-55 TO 100	



ATTENTION:
 OBSERVE PRECAUTIONS FOR
 HANDLING ELECTROSTATIC
 SENSITIVE DEVICES

NOTES:

1. LENS: WHITE DIFFUSED.
2. DIE: GaP GREEN & GaAsP/GaP YELLOW.
3. LEADS FIT INTO HOLES SPACED AS PER PATTERN.
4. LEAD DIMENSIONS SHOWN ARE MEASURED AT HOUSING EXIT.
5. PIN NUMBERS FOR REFERENCE ONLY, DESIGNATION NON-EXISTENT ON PARTS.
6. DIALIGHT PART NUMBER: 551-3107F.
7. THIS ASSEMBLY CONTAINS ELECTROSTATIC DISCHARGE SENSITIVE DEVICES (ESDS). MAINTAIN ALL PRECAUTIONARY MEASURES DURING ASSEMBLY, HANDLING, AND STORAGE IN ACCORDANCE WITH IPC-A-610.

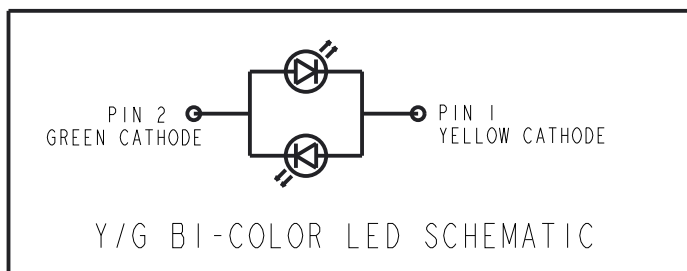

THIS DRAWING AND THE CONTENTS HEREIN ARE CONFIDENTIAL AND THE SOLE PROPERTY OF DIALIGHT CORP. REPRODUCTION OF THIS DRAWING OR CONSTRUCTION OF ANY PARTS WITHIN THIS DRAWING ARE FORBIDDEN WITHOUT THE WRITTEN CONSENT OF DIALIGHT CORP.

SCALE: DRAWING SCALE	DRAWING NUMBER	REV
ALL DIM'S: INCH (mm)	C-17289	C
TOLERANCES: UNLESS OTHERWISE SPECIFIED	TITLE 3mm LED CBI .200" HIGH CENTERLINE, RoHS COMPLIANT	
FRACTIONS: ±1/64 DECIMALS (.XX): ±.02 DECIMALS (.XXX): ±.015	MATERIAL	
ANGLES: ±3° FINISH		
FSCM 83330	SHEET 11 OF 11	FAMILY TABLE:

1501 ROUTE 34 SOUTH
 FARMINGDALE, NJ 07727
 (732) 919-3119
 www.dialight.com