

C-FILTER D-SUB HIGH DENSITY

Solder pin – Angled – .350" / 7.98 mm – Precision machined contacts – Metal bracket

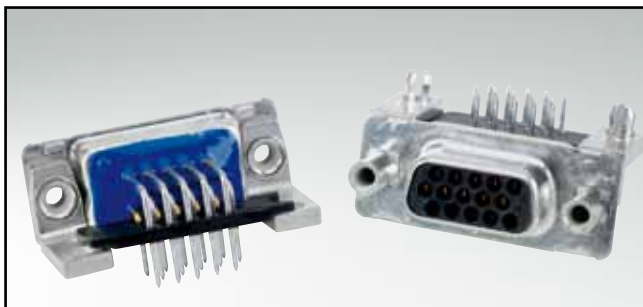

RoHS compliant – CSA listed, File No.: LR 115000-1 – UL listed, File No.: E202784

DESCRIPTION

- Mounting styles:
 - with mounting bracket and 4-40 UNC or M3 threaded insert
 - with mounting bracket, PCB clip and 4-40 UNC or M3 threaded insert
- Quality class 3 (also available in quality class 1)
- Shell: Steel tin plated (brass tin plated on request)

SOCKET CONNECTOR

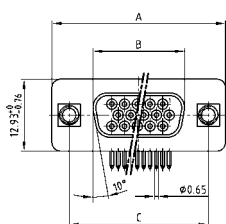

No. of pos.	A -0.76	B -0.25	C
15	31.19	16.46	25.00 ^{+0.12} / _{-0.13}
26	39.52	24.79	33.30 ^{+0.15} / _{-0.10}
44	53.42	38.50	47.04 ^{+0.13} / _{-0.10}
62	69.70	54.96	63.50 ^{+0.13} / _{-0.10}

PCB layout: Kat1iU1A

Mounting style: Threaded insert

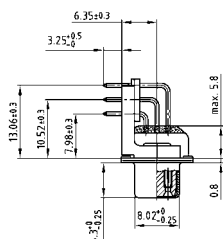
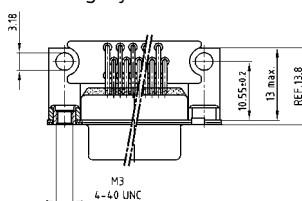

Mounting style: PCB clip, threaded insert

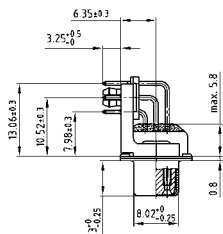
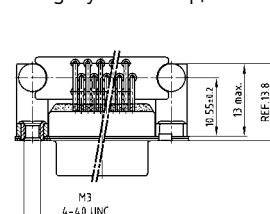

PLUG CONNECTOR

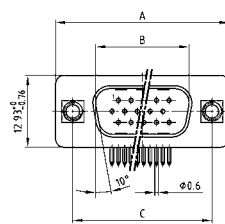

No. of pos.	A -0.76	B -0.25	C	D -0.3
15	31.19	16.79	25.00 ^{+0.12} / _{-0.13}	6.12
26	39.52	25.12	33.30 ^{+0.15} / _{-0.10}	6.12
44	53.42	38.84	47.04 ^{+0.13} / _{-0.10}	5.99
62	69.70	55.30	63.50 ^{+0.13} / _{-0.10}	5.99

PCB layout: Kat1iU2A

Mounting style: Threaded insert

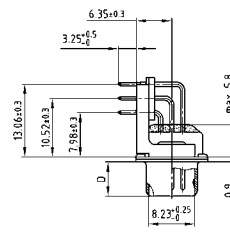
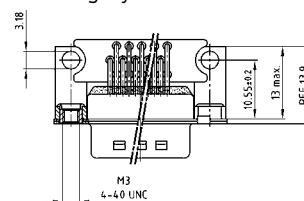

Mounting style: PCB clip, threaded insert

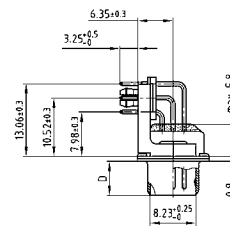
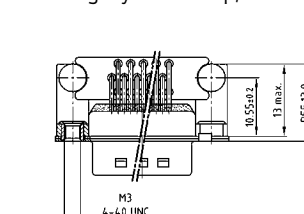

ORDER DATA

Capacitance 180 pF

SOCKET CONNECTOR

No. of pos.	Mounting style	Part Number
15	4-40 UNC Threaded insert	242 A 28020 X
26	4-40 UNC Threaded insert	242 A 28030 X
44	4-40 UNC Threaded insert	242 A 28040 X
62	4-40 UNC Threaded insert	242 A 28050 X
15	M3 Threaded insert	242 A 28060 X
26	M3 Threaded insert	242 A 28070 X
44	M3 Threaded insert	242 A 28080 X
62	M3 Threaded insert	242 A 28090 X
15	PCB clip / 4-40 UNC Threaded insert	242 A 28180 X
26	PCB clip / 4-40 UNC Threaded insert	242 A 28190 X
44	PCB clip / 4-40 UNC Threaded insert	242 A 28200 X
62	PCB clip / 4-40 UNC Threaded insert	242 A 28210 X
15	PCB clip / M3 Threaded insert	242 A 28220 X
26	PCB clip / M3 Threaded insert	242 A 28230 X
44	PCB clip / M3 Threaded insert	242 A 28240 X
62	PCB clip / M3 Threaded insert	242 A 28250 X

PLUG CONNECTOR

No. of pos.	Mounting style	Part Number
15	4-40 UNC Threaded insert	241 A 28120 X
26	4-40 UNC Threaded insert	241 A 28130 X
44	4-40 UNC Threaded insert	241 A 28140 X
62	4-40 UNC Threaded insert	241 A 28150 X
15	M3 Threaded insert	241 A 28160 X
26	M3 Threaded insert	241 A 28170 X
44	M3 Threaded insert	241 A 28180 X
62	M3 Threaded insert	241 A 28190 X
15	PCB clip / 4-40 UNC Threaded insert	241 A 28280 X
26	PCB clip / 4-40 UNC Threaded insert	241 A 28290 X
44	PCB clip / 4-40 UNC Threaded insert	241 A 28300 X
62	PCB clip / 4-40 UNC Threaded insert	241 A 28310 X
15	PCB clip / M3 Threaded insert	241 A 28320 X
26	PCB clip / M3 Threaded insert	241 A 28330 X
44	PCB clip / M3 Threaded insert	241 A 28340 X
62	PCB clip / M3 Threaded insert	241 A 28350 X

PCB clip .122" / 3.1 ± .004" / 0.10 mm hole diameter and .063" / 1.6 mm circuit board thickness

C-FILTER D-SUB HIGH DENSITY

Solder pin – Angled – .350" / 7.98 mm – Precision machined contacts – Metal bracket

ORDER DATA

Capacitance 370 pF

SOCKET CONNECTOR			PLUG CONNECTOR		
No. of pos.	Mounting style	Part Number	No. of pos.	Mounting style	Part Number
15	4-40 UNC Threaded insert	242 A 19810 X	15	4-40 UNC Threaded insert	241 A 18220 X
26	4-40 UNC Threaded insert	242 A 19820 X	26	4-40 UNC Threaded insert	241 A 18230 X
44	4-40 UNC Threaded insert	242 A 19830 X	44	4-40 UNC Threaded insert	241 A 18240 X
62	4-40 UNC Threaded insert	242 A 19840 X	62	4-40 UNC Threaded insert	241 A 18250 X
15	M3 Threaded insert	242 A 19890 X	15	M3 Threaded insert	241 A 18300 X
26	M3 Threaded insert	242 A 19900 X	26	M3 Threaded insert	241 A 18310 X
44	M3 Threaded insert	242 A 19910 X	44	M3 Threaded insert	241 A 18320 X
62	M3 Threaded insert	242 A 19920 X	62	M3 Threaded insert	241 A 18330 X
15	PCB clip / 4-40 UNC Threaded insert	242 A 19490 X	15	PCB clip / 4-40 UNC Threaded insert	241 A 17900 X
26	PCB clip / 4-40 UNC Threaded insert	242 A 19500 X	26	PCB clip / 4-40 UNC Threaded insert	241 A 17910 X
44	PCB clip / 4-40 UNC Threaded insert	242 A 19510 X	44	PCB clip / 4-40 UNC Threaded insert	241 A 17920 X
62	PCB clip / 4-40 UNC Threaded insert	242 A 19520 X	62	PCB clip / 4-40 UNC Threaded insert	241 A 17930 X
15	PCB clip / M3 Threaded insert	242 A 19570 X	15	PCB clip / M3 Threaded insert	241 A 17980 X
26	PCB clip / M3 Threaded insert	242 A 19580 X	26	PCB clip / M3 Threaded insert	241 A 17990 X
44	PCB clip / M3 Threaded insert	242 A 19590 X	44	PCB clip / M3 Threaded insert	241 A 18000 X
62	PCB clip / M3 Threaded insert	242 A 19600 X	62	PCB clip / M3 Threaded insert	241 A 18010 X

Capacitance 830 pF

SOCKET CONNECTOR			PLUG CONNECTOR		
No. of pos.	Mounting style	Part Number	No. of pos.	Mounting style	Part Number
15	4-40 UNC Threaded insert	242 A 19850 X	15	4-40 UNC Threaded insert	241 A 18260 X
26	4-40 UNC Threaded insert	242 A 19860 X	26	4-40 UNC Threaded insert	241 A 18270 X
44	4-40 UNC Threaded insert	242 A 19870 X	44	4-40 UNC Threaded insert	241 A 18280 X
62	4-40 UNC Threaded insert	242 A 19880 X	62	4-40 UNC Threaded insert	241 A 18290 X
15	M3 Threaded insert	242 A 19930 X	15	M3 Threaded insert	241 A 18340 X
26	M3 Threaded insert	242 A 19940 X	26	M3 Threaded insert	241 A 18350 X
44	M3 Threaded insert	242 A 19950 X	44	M3 Threaded insert	241 A 18360 X
62	M3 Threaded insert	242 A 19960 X	62	M3 Threaded insert	241 A 18370 X
15	PCB clip / 4-40 UNC Threaded insert	242 A 19530 X	15	PCB clip / 4-40 UNC Threaded insert	241 A 17940 X
26	PCB clip / 4-40 UNC Threaded insert	242 A 19540 X	26	PCB clip / 4-40 UNC Threaded insert	241 A 17950 X
44	PCB clip / 4-40 UNC Threaded insert	242 A 19550 X	44	PCB clip / 4-40 UNC Threaded insert	241 A 17960 X
62	PCB clip / 4-40 UNC Threaded insert	242 A 19560 X	62	PCB clip / 4-40 UNC Threaded insert	241 A 17970 X
15	PCB clip / M3 Threaded insert	242 A 19610 X	15	PCB clip / M3 Threaded insert	241 A 18020 X
26	PCB clip / M3 Threaded insert	242 A 19620 X	26	PCB clip / M3 Threaded insert	241 A 18030 X
44	PCB clip / M3 Threaded insert	242 A 19630 X	44	PCB clip / M3 Threaded insert	241 A 18040 X
62	PCB clip / M3 Threaded insert	242 A 19640 X	62	PCB clip / M3 Threaded insert	241 A 18050 X

PCB clip .122" / 3.1 ± .004" / 0.10 mm hole diameter and .063" / 1.6 mm circuit board thickness