

<b>DRAWING NUMBER:</b>	<b>15R-104-X-XX</b>
<b>PRODUCT GROUP:</b>	TERMINALS
<b>SUB-GROUP:</b>	MILITARY NON-INSULATED TERMINALS
<b>DESCRIPTION:</b>	NON-INSULATED TURRET TERMINAL

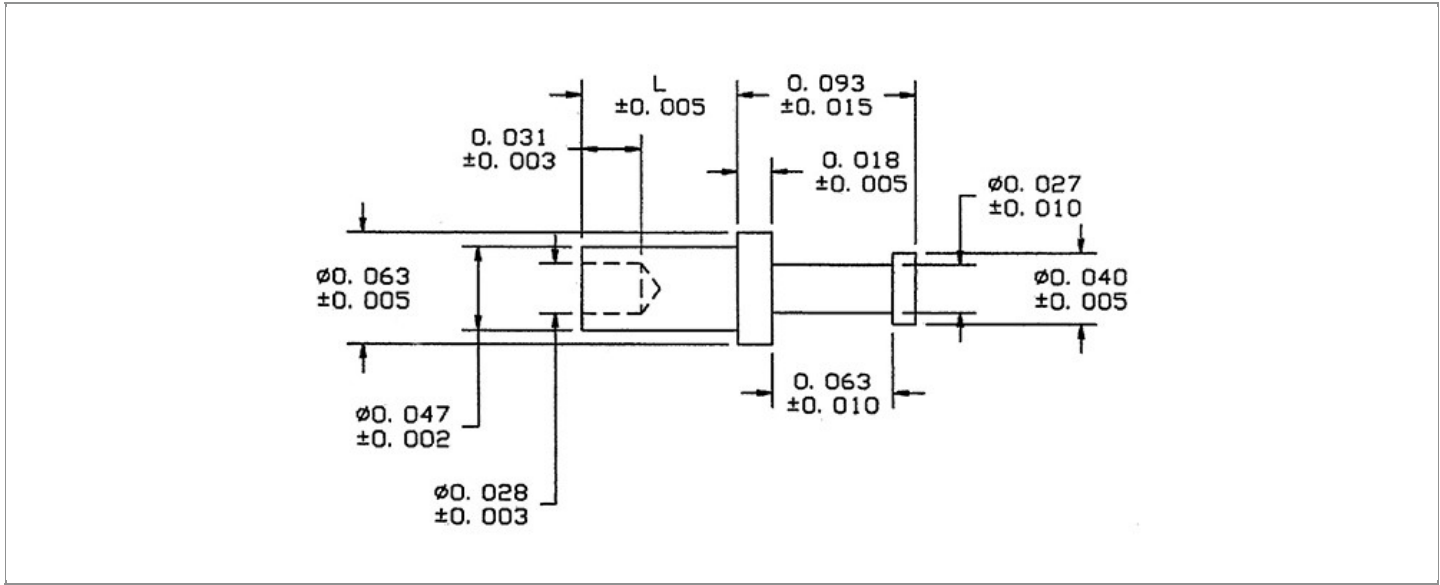

BOARD / PANEL MOUNTING METHOD	MOUNTING HOLE SIZE	DRILL SIZE	FEED THRU COMBINATION
SWAGE MOUNT	0.052" ± 0.001	#55	N/A

**PART NO. STRUCTURE:**

15R-104 - X - XX  
 PART SERIES    DIMENSION    FINISH

**MATERIAL OPTIONS:**

15R-104-X-XX

COMPONENT	MATERIAL	MATERIAL AND SPECIFICATION
TERMINAL	PHOSPHOR BRONZE	PHOSPHOR BRONZE PER ASTM B139, ALLOY C54400

**DIMENSION OPTIONS:**

15R-104-X-XX

DIMENSION	K	OVERALL LENGTH	SHANK LENGTH (L)	BOARD/PANEL THICKNESS
1	N/A	0.144"	0.051"	1/32"
2	N/A	0.175"	0.082"	1/16"
3	N/A	0.206"	0.113"	3/32"
4	N/A	0.238"	0.145"	1/8"

FINISH - PLATING OPTIONS:

15R-104-X-XX

FINISH CODE	COMPONENT	FINISH	FINISH AND SPECIFICATION
05	TERMINAL	ELECTRO-SOLDER	0.000300"MIN. ELECTRO-SOLDER PER SAE-AMS-P-81728 OVER 0.000100"MIN. COPPER PER SAE-AMS-2418
088	TERMINAL	BRIGHT TIN-LEAD	0.000300"MIN. BRIGHT TIN-LEAD (Sn93%-Pb7%) PER ASTM B545 OVER 0.000100"MIN. COPPER PER SAE-AMS-2418
095	TERMINAL	HOT SOLDER DIP	0.000100"MIN. HOT SOLDER DIP USING Sn60 PER IPC-J-STD-006 OVER 0.000100"MIN. COPPER PER SAE-AMS-2418

TOLERANCES:\*

DECIMAL	FRACTIONAL	ANGULAR	DRAWING ORIGATION DATE	LAST MODIFICATION DATE
± 0.010	± 1/64	± 5°	4/9/1997	3/1/2017

\*All dimensions are in inches.

RoHS COMPLIANCE:

15R-104-1-XX

PART NUMBER	RoHS COMPLIANT
15R-104-1-05	NO
15R-104-1-088	NO
15R-104-1-095	NO

15R-104-2-XX

PART NUMBER	RoHS COMPLIANT
15R-104-2-05	NO
15R-104-2-088	NO
15R-104-2-095	NO

15R-104-3-XX

PART NUMBER	RoHS COMPLIANT
15R-104-3-05	NO
15R-104-3-088	NO
15R-104-3-095	NO

15R-104-4-XX

PART NUMBER	RoHS COMPLIANT
15R-104-4-05	NO
15R-104-4-088	NO
15R-104-4-095	NO

MILITARY REFERENCE SPECIFICATIONS:

15R-104-1-XX

PART NUMBER	MIL SPECIFICATION	MIL PART NUMBER	COMMERCIAL ITEM DESCRIPTION (CID) SPECIFICATION	CID PART NUMBER
15R-104-1-05	MIL-T-55155/29	M55155/29XB02	A-A-59126/29	AA59126/29XB02
15R-104-1-088	MIL-T-55155/29	M55155/29XD02	A-A-59126/29	AA59126/29XD02
15R-104-1-095	MIL-T-55155/29	M55155/29XC02	A-A-59126/29	AA59126/29XC02

15R-104-2-XX

PART NUMBER	MIL SPECIFICATION	MIL PART NUMBER	COMMERCIAL ITEM DESCRIPTION (CID) SPECIFICATION	CID PART NUMBER
15R-104-2-05	MIL-T-55155/29	M55155/29XB05	A-A-59126/29	AA59126/29XB05

Continued on next page...

MILITARY REFERENCE SPECIFICATIONS CONTINUED:

15R-104-2-XX

PART NUMBER	MIL SPECIFICATION	MIL PART NUMBER	COMMERCIAL ITEM DESCRIPTION (CID) SPECIFICATION	CID PART NUMBER
15R-104-2-088	MIL-T-55155/29	M55155/29XD05	A-A-59126/29	AA59126/29XD05
15R-104-2-095	MIL-T-55155/29	M55155/29XC05	A-A-59126/29	AA59126/29XC05

15R-104-3-XX

PART NUMBER	MIL SPECIFICATION	MIL PART NUMBER	COMMERCIAL ITEM DESCRIPTION (CID) SPECIFICATION	CID PART NUMBER
15R-104-3-05	MIL-T-55155/29	M55155/29XB08	A-A-59126/29	AA59126/29XB08
15R-104-3-088	MIL-T-55155/29	M55155/29XD08	A-A-59126/29	AA59126/29XD08
15R-104-3-095	MIL-T-55155/29	M55155/29XC08	A-A-59126/29	AA59126/29XC08

15R-104-4-XX

PART NUMBER	MIL SPECIFICATION	MIL PART NUMBER	COMMERCIAL ITEM DESCRIPTION (CID) SPECIFICATION	CID PART NUMBER
15R-104-4-05	MIL-T-55155/29	M55155/29XB11	A-A-59126/29	AA59126/29XB11
15R-104-4-088	MIL-T-55155/29	M55155/29XD11	A-A-59126/29	AA59126/29XD11
15R-104-4-095	MIL-T-55155/29	M55155/29XC11	A-A-59126/29	AA59126/29XC11

TOOLING:

INSTALLATION TOOL: ARBOR PRESS	INSTALLATION TOOL: ANVIL (ARBOR PRESS OPERATED)	INSTALLATION TOOL: PRESS-FIT / ROLL SWAGE / RIVET PUNCH (ARBOR PRESS OPERATED)	INSTALLATION TOOL: FLARE SWAGE PUNCH (ARBOR PRESS OPERATED)
TM1	TA62-40-18	TP47-26	TFLP90-150

NOTES:

DATASHEET NOTES
N/A

INSTRUCTION NOTES
SEE GENERAL SWAGING INSTALLATION INSTRUCTION ON CONCORD ELECTRONICS' WEBSITE <a href="http://WWW.CONCORD-ELECTRONICS.COM">WWW.CONCORD-ELECTRONICS.COM</a>