

DRAWING NUMBER:	15R-216-X-XX
PRODUCT GROUP:	TERMINALS
SUB-GROUP:	MILITARY NON-INSULATED TERMINALS
DESCRIPTION:	NON-INSULATED DOUBLE TURRET TERMINAL

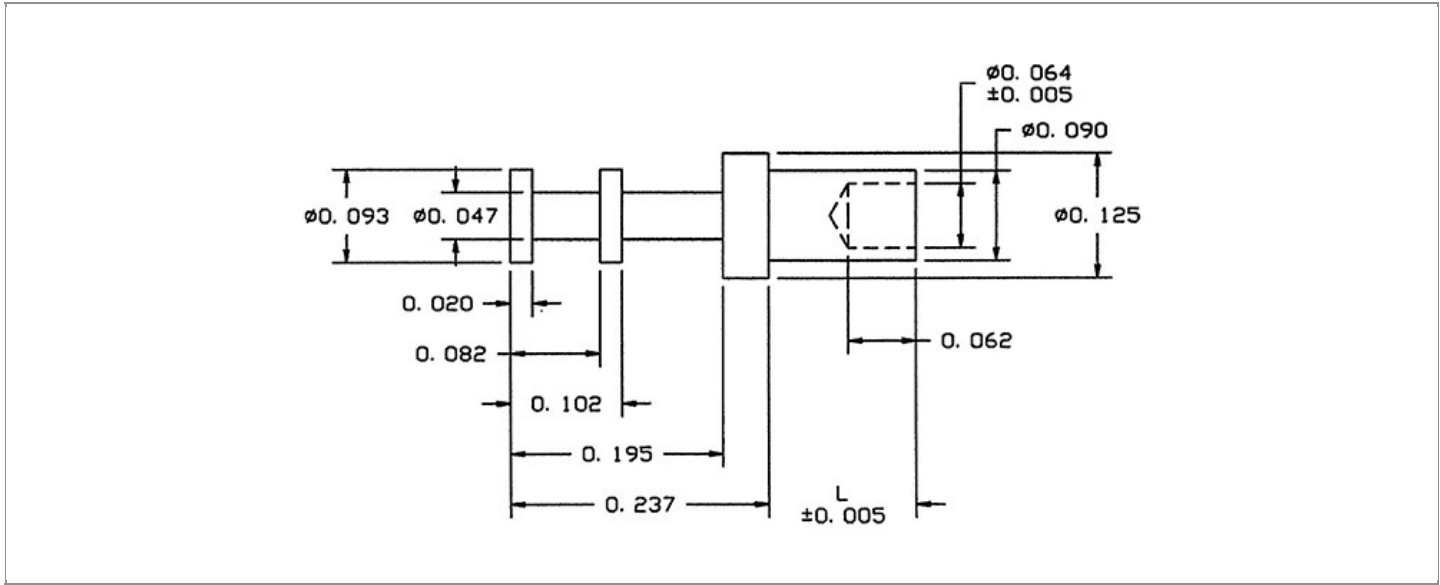

BOARD / PANEL MOUNTING METHOD	MOUNTING HOLE SIZE	DRILL SIZE	FEED THRU COMBINATION
SWAGE MOUNT	0.094" ± 0.001	3/32"	N/A

PART NO. STRUCTURE:

15R-216 - X - XX
 PART SERIES DIMENSION FINISH

MATERIAL OPTIONS:

15R-216-X-XX

COMPONENT	MATERIAL	MATERIAL AND SPECIFICATION
TERMINAL	PHOSPHOR BRONZE	PHOSPHOR BRONZE PER ASTM B139, ALLOY C54400

DIMENSION OPTIONS:

15R-216-X-XX

DIMENSION	K	OVERALL LENGTH	SHANK LENGTH (L)	BOARD/PANEL THICKNESS
2	N/A	0.342"	0.105"	1/16"
3	N/A	0.372"	0.135"	3/32"
4	N/A	0.402"	0.165"	1/8"

FINISH - PLATING OPTIONS:

15R-216-X-**XX**

FINISH CODE	COMPONENT	FINISH	FINISH AND SPECIFICATION
05	TERMINAL	ELECTRO-SOLDER	0.000300"MIN. ELECTRO-SOLDER PER SAE-AMS-P-81728 OVER 0.000100"MIN. COPPER PER SAE-AMS-2418
088	TERMINAL	BRIGHT TIN-LEAD	0.000300"MIN. BRIGHT TIN-LEAD (Sn93%-Pb7%) PER ASTM B545 OVER 0.000100"MIN. COPPER PER SAE-AMS-2418
095	TERMINAL	HOT SOLDER DIP	0.000100"MIN. HOT SOLDER DIP USING Sn60 PER IPC-J-STD-006 OVER 0.000100"MIN. COPPER PER SAE-AMS-2418

TOLERANCES:*

DECIMAL	FRACTIONAL	ANGULAR	DRAWING ORIGATION DATE	LAST MODIFICATION DATE
± 0.005	N/A	± 3°	10/22/2002	3/1/2017

*All dimensions are in inches.

RoHS COMPLIANCE:

15R-216-2-XX

PART NUMBER	RoHS COMPLIANT
15R-216-2-05	NO
15R-216-2-088	NO
15R-216-2-095	NO

15R-216-3-XX

PART NUMBER	RoHS COMPLIANT
15R-216-3-05	NO
15R-216-3-088	NO
15R-216-3-095	NO

15R-216-4-XX

PART NUMBER	RoHS COMPLIANT
15R-216-4-05	NO
15R-216-4-088	NO
15R-216-4-095	NO

MILITARY REFERENCE SPECIFICATIONS:

15R-216-2-XX

PART NUMBER	MIL SPECIFICATION	MIL PART NUMBER	COMMERCIAL ITEM DESCRIPTION (CID) SPECIFICATION	CID PART NUMBER
15R-216-2-05	MIL-T-55155/12	M55155/12XB04	A-A-59126/12	AA59126/12XB04
15R-216-2-088	MIL-T-55155/12	M55155/12XD04	A-A-59126/12	AA59126/12XD04
15R-216-2-095	MIL-T-55155/12	M55155/12XC04	A-A-59126/12	AA59126/12XC04

15R-216-3-XX

PART NUMBER	MIL SPECIFICATION	MIL PART NUMBER	COMMERCIAL ITEM DESCRIPTION (CID) SPECIFICATION	CID PART NUMBER
15R-216-3-05	MIL-T-55155/12	M55155/12XB05	A-A-59126/12	AA59126/12XB05
15R-216-3-088	MIL-T-55155/12	M55155/12XD05	A-A-59126/12	AA59126/12XD05
15R-216-3-095	MIL-T-55155/12	M55155/12XC05	A-A-59126/12	AA59126/12XC05

Continued on next page...

MILITARY REFERENCE SPECIFICATIONS CONTINUED:

15R-216-4-XX

PART NUMBER	MIL SPECIFICATION	MIL PART NUMBER	COMMERCIAL ITEM DESCRIPTION (CID) SPECIFICATION	CID PART NUMBER
15R-216-4-05	MIL-T-55155/12	M55155/12XB06	A-A-59126/12	AA59126/12XB06
15R-216-4-088	MIL-T-55155/12	M55155/12XD06	A-A-59126/12	AA59126/12XD06
15R-216-4-095	MIL-T-55155/12	M55155/12XC06	A-A-59126/12	AA59126/12XC06

TOOLING:

INSTALLATION TOOL: ARBOR PRESS	INSTALLATION TOOL: ANVIL (ARBOR PRESS OPERATED)	INSTALLATION TOOL: PRESS-FIT / ROLL SWAGE / RIVET PUNCH (ARBOR PRESS OPERATED)	INSTALLATION TOOL: FLARE SWAGE PUNCH (ARBOR PRESS OPERATED)
TM1	TA125-94-23	TP90-64	TFLP90-175

NOTES:

DATASHEET NOTES

N/A

INSTRUCTION NOTES

SEE GENERAL SWAGING INSTALLATION INSTRUCTION ON CONCORD ELECTRONICS' WEBSITE WWW.CONCORD-ELECTRONICS.COM