

# SMA ADAPTERS-TERMINATIONS-COAXIAL ACCESSORIES

## TERMINATIONS MALE TERMINATION

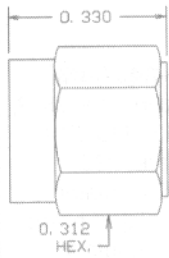

**800-2500-03**  
 VSWR: 1.25 Max.to  
 18 GHz  
 50 OHMS 1/2 Watt  
 Temperature: -54°C  
 to +125°C



## CRIMP CABLE PLUG-FEMALE

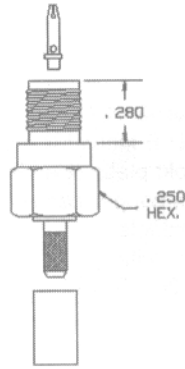

**800-2486-03**  
 For use on RG55,  
 58, 142, 223  
 Passivated steel  
 shell. Gold plated  
 center conductor.  
 50 OHM  
 DWV 1000 VRMS  
 60 Hz@Sea level

**800-2487-03**  
 For use on RG174,  
 179,187, 188, 316

## CRIMP CABLE PLUG-MALE

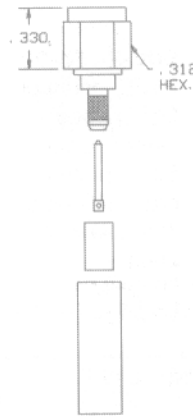

**800-2426-03**  
 For use on RG55,  
 58, 142, 223  
 Passivated steel  
 shell. Gold plated  
 center conductor.  
 PTFE insulator.  
 50 OHM

**800-2427-03**  
 For use on RG174,  
 179,187, 188, 316

## FEMALE TERMINATION

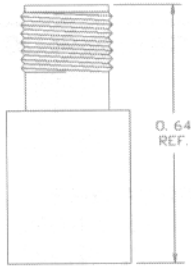

**800-2501-03**  
 VSWR: 1.25 Max.to  
 18 GHz  
 50 OHMS 1/2 Watt  
 Temperature: -54°C  
 to +125°C



## SMA SHORT PLUG

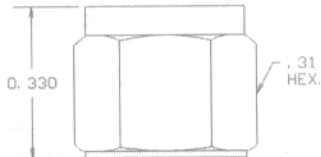

**800-2425-03**  
 PTFE insulator Passivated gold plated  
 steel shell.  
 Gold plated center contact

# CONCORD<sup>®</sup>

MAINTAINS LARGE  
 INVENTORYIES TO SHIP SAME  
 DAY ON MOST PRODUCTS!

# CONCORD<sup>®</sup>