

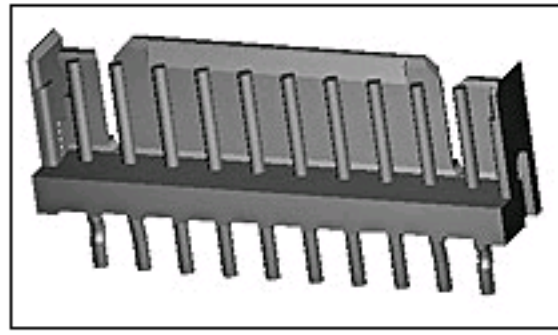

292161-6 Product Details



292161-6

TE Internal Number: 292161-6
Active

[View 3D PDF](#)

2mm AMP CT Connectors

Always EU RoHS/ELV Compliant (Statement of Compliance)

Product Highlights:

- Wire-to-Board
- Applies To Printed Circuit Board
- Connector
- Header
- Header Type = Partially Shrouded

[View all Features](#)

Quick Links

- ▶ [Check Pricing & Availability](#)
- ▶ [Search for Tooling](#)
- ▶ [View Mating Products \(3\)](#)
- ▶ [Product Feature Selector](#)
- ▶ [Contact Us About This Product](#)

[Add to My Part List](#) | [Request Sample](#) | [Find Similar Products](#) | [Buy Product](#)

Documentation & Additional Information

Product Drawings:

- [POST HEADER ASS'Y VERTICAL TYPE \(AMP CT CONNECTOR 2m... \(PDF, English\)](#)

Catalog Pages/Data Sheets:

- [2.0MM_AMP_CT_CONNECTOR_SERIES_QUICK_REF_GUIDE \(PDF, English\)](#)

Product Specifications:

- None Available

Application Specifications:

- None Available

Instruction Sheets:

- None Available

CAD Files: (CAD Format & Compression Information)

- [2D Drawing \(DXF, Version A\)](#)
- [3D Model \(IGES, Version A\)](#)
- [3D Model \(STEP, Version A\)](#)

[List all Documents](#)

Additional Product Images:

- [Typical Application](#)

Related Products:

- [Tooling](#)
- [Mating Products \(3\)](#)

Product Features (Please use the Product Drawing for all design activity)

Product Type Features:

- [Product Type](#) = Connector
- [Connector Type](#) = Header
- [Termination Method to PC Board](#) = Through Hole - Solder
- [PCB Mounting Orientation](#) = Vertical
- [PCB Mount Alignment](#) = Without
- [PCB Mount Retention](#) = With
- [PCB Mount Retention Type](#) = Kinked Leg(s)
- [Shrouded](#) = Yes - Partial
- [Sealed](#) = No
- [UL File Number](#) = E28476
- [CSA File Number](#) = LR 7189

Electrical Characteristics:

- [Contact - Rated Current \(A\)](#) = 4
- [Operating Voltage Reference](#) = AC/DC, AC, DC
- [Operating Voltage \(VAC\)](#) = 125
- [Operating Voltage \(VDC\)](#) = 125

Termination Features:

- [Wire/Cable Size \(AWG\)](#) = 22 - 28
- [Tail Orientation](#) = In-line
- [Tail Length \(mm \[in\]\)](#) = 3.2 [0.126]

Dimensions:

- [Mating Post Length \(mm \[in\]\)](#) = 4.50 [0.177]
- [PCB Thickness, Recommended \(mm \[in\]\)](#) = 0.80 - 1.60 [0.031 - 0.063]
- [Length \(X-Axis\) \(mm \[in\]\)](#) = 13.80 [0.543]
- [Width \(Z-Axis\) \(mm \[in\]\)](#) = 3.60 [0.141]
- [Profile Height \(Y-Axis\) \(mm \[in\]\)](#) = 6.80 [0.267]

Body Features:

- [Header Type](#) = Partially Shrouded
- [Mating Retention](#) = Without

Contact Features:

- [Contact Type](#) = Pin
- [Contact Plating, Mating Area, Material](#) = Tin
- [Contact Plating, Mating Area, Thickness \(µm \[µin\]\)](#) = 1 [39.37]
- [Contact Plating, Termination Area, Material](#) = Tin
- [Contact Plating, Termination Area, Thickness \(µm \[µin\]\)](#) = 1 [40]

Housing Features:

- [Connector Style](#) = Plug
- [Centerline \(mm \[in\]\)](#) = 2.00 [0.079]
- [Housing Color](#) = Natural
- [UL Flammability Rating](#) = UL 94V-0

Configuration Features:

- [Number of Positions](#) = 6
- [Number of Rows](#) = 1

Industry Standards:

- [RoHS/ELV Compliance](#) = RoHS compliant, ELV compliant
- [Lead Free Solder Processes](#) = Wave solder capable to 240°C
- [RoHS/ELV Compliance History](#) = Always was RoHS compliant
- [Agency/Standard](#) = CSA, UL

Environmental:

- [Operating Temperature \(°C \[°F\]\)](#) = -40 - +105 [-40 - +221]

Conditions for Usage:

- [Applies To](#) = Printed Circuit Board

Operation/Application:

- [Application Use](#) = Wire-to-Board
- [Contact Transmits \(Typical Application\)](#) = Signal (Data)
- [Pick and Place Cover](#) = Without

Packaging Features:

- [Packaging Method](#) = Bag, Box

Other:

- [Brand](#) = AMP

Corporate Information

- [About TE](#)
- [Investors](#)
- [News Room](#)
- [Supplier Portal](#)
- [Careers](#)
- [Terms & Conditions](#)
- [Privacy Policy](#)

Quick Links

- [Check Distributor Inventory](#)
- [Cross Reference Products](#)
- [Find Documents & Drawings](#)
- [Product Compliance Support Center](#)
- [Site Map](#)

Customer Support

- [Email or Chat With Us](#)
- [Find a Phone Number](#)
- [Search Knowledge Base](#)
- [Manage Your Account](#)

Keep Me Informed

Receive TE News, Events & Technology Updates

Enter your email address

