

**HB.16, HB-K.16, HD.40, HD-K.40 Gehäuse/Housings**

**Baugröße/Size 6**

Pulverbeschichtet, silbergrau  
K = korrosionsgeschützt, schwarz

*Powder-coated, silver-grey*  
*K = corrosion-resistant, black*

**Längsbügel am Unterteil/Side clip at housing bottom**

**IP 65**

Bezeichnung  
Description

Metr. PG

Bestelltext  
Designation

Bestell-Nr.  
Order No.

Sockelgehäuse: Kabeleingang seitlich, Standard Bauform  
Surface mounted housing: Side entry, Standard construction

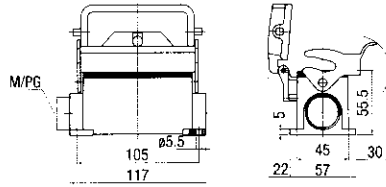
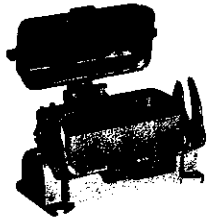

2xM25	21	HB.16.SGD-LB.1.21.Z	1-1102308-2
	2x21	HB.16.SGD-LB.2.21.Z	1-1102310-2
		HB.16.SGD-LB.2.M25.Z	0-1106448-2
<b>Mit Korrosionsschutz</b> <b>With corrosion protection</b>			
2xM25	21	HB-K.16.SGD-LB.1.21.Z	2-1102308-2
	2x21	HB-K.16.SGD-LB.2.21.Z	2-1102310-2
		HB-K.16.SGD-LB.2.M25.Z	0-1106448-6

Sockelgehäuse: Kabeleingang seitlich, Hohe Bauform  
Surface mounted housing: Side entry, High construction

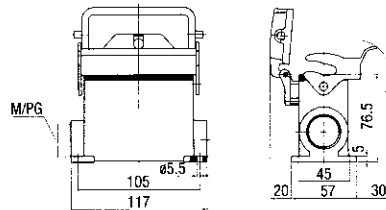
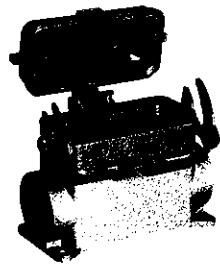

2xM32	21	HD.40.SGD-LB.1.21.Z	1-1102589-2
	2x21	HD.40.SGD-LB.2.21.Z	1-1102591-2
	29	HD.40.SGD-LB.1.29.Z	1-1102593-2
	2x29	HD.40.SGD-LB.2.29.Z	1-1102595-2
		HD.40.SGD-LB.2.M32.Z	0-1106451-2
<b>Mit Korrosionsschutz</b> <b>With corrosion protection</b>			
2xM32	21	HD-K.40.SGD-LB.1.21.Z	2-1102589-2
	2x21	HD-K.40.SGD-LB.2.21.Z	2-1102591-2
	29	HD-K.40.SGD-LB.1.29.Z	2-1102593-2
	2x29	HD-K.40.SGD-LB.2.29.Z	2-1102595-2
		HD-K.40.SGD-LB.2.M32.Z	0-1106451-6

Kupplungsgehäuse: Kabeleingang unten, Standard Bauform  
Cable-to-cable hood: Bottom entry, Standard construction

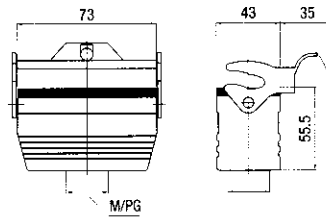

M32	21	HB.16.KD0-LB.1.21.G	1-1102304-2
		HB.16.KD0-LB.1.M32.G	0-1106447-1

Kupplungsgehäuse: Kabeleingang unten, Hohe Bauform  
Cable-to-cable hood: Bottom entry, High construction

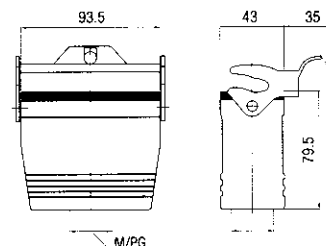

M32	21	HD.40.KD0-LB.1.21.G	1-1102584-2
	29	HD.40.KD0-LB.1.29.G	1-1102587-2
		HD.40.KD0-LB.1.M32.G	0-1106450-1
<b>Mit Korrosionsschutz</b> <b>With corrosion protection</b>			
M32		HD-K.40.KD0-LB.1.M32.G	0-1106450-3

**Passende Kabelverschraubungen Seite 173/Suitable Cable fittings page 173**