

Product Compliance

[For compliance documentation, visit the product page on TE.com>](#)

EU RoHS Directive 2011/65/EU	Compliant
EU ELV Directive 2000/53/EC	Compliant
China RoHS 2 Directive MIIT Order No 32, 2016	No Restricted Materials Above Threshold
EU REACH Regulation (EC) No. 1907/2006	Current ECHA Candidate List: JAN 2025 (247) Candidate List Declared Against: JUL 2017 (174) Does not contain REACH SVHC
Halogen Content	Low Halogen - Br, Cl, F, I < 900 ppm per homogenous material. Also BFR/CFR/PVC Free
Solder Process Capability	Not applicable for solder process capability

Product Compliance Disclaimer

This information is provided based on reasonable inquiry of our suppliers and represents our current actual knowledge based on the information they provided. This information is subject to change. The part numbers that TE has identified as EU RoHS compliant have a maximum concentration of 0.1% by weight in homogenous materials for lead, hexavalent chromium, mercury, PBB, PBDE, DBP, BBP, DEHP, DIBP, and 0.01% for cadmium, or qualify for an exemption to these limits as defined in the Annexes of Directive 2011/65/EU (RoHS2). Finished electrical and electronic equipment products will be CE marked as required by Directive 2011/65/EU. Components may not be CE marked. Additionally, the part numbers that TE has identified as EU ELV compliant have a maximum concentration of 0.1% by weight in homogenous materials for lead, hexavalent chromium, and mercury, and 0.01% for cadmium, or qualify for an exemption to these limits as defined in the Annexes of Directive 2000/53/EC (ELV). Regarding the REACH Regulation, the information TE provides on SVHC in articles for this part number is based on the latest European Chemicals Agency (ECHA) 'Guidance on requirements for substances in articles' posted at this URL: <https://echa.europa.eu/guidance-documents/guidance-on-reach>

Customers Also Bought

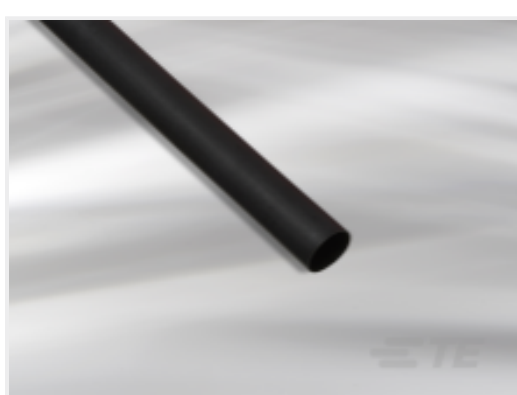

TE Part #CAT-HST-BATTU
BATTU Heat Shrink Tubing



TE Part #YHC59320000000000
BATTERY LEAD CONNECTOR.35MM.
+VE.M6 THRD.



TE Part #HC5843
LEAD CONN. FOR HC5840 & HC58



TE Part #YHC59020000000000
BATTERY POST CLAMP.+VE.

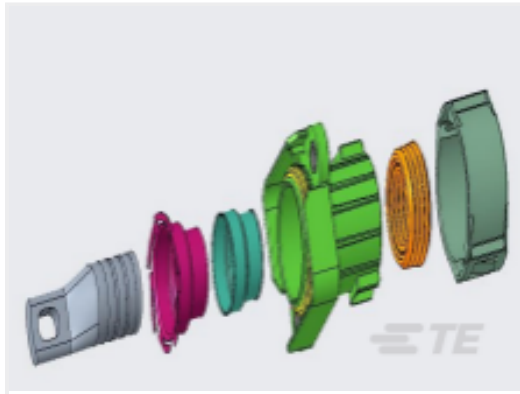

TE Part #YIPT-1PXI-70MM-000
IPT-1pxi 70sqmm



TE Part #4-643818-4
14P MTA156 CONN ASSY 20AWG YEL



TE Part #2-1418510-1
1,6TAB HSG ASSY2X2P RADIAL SEAL



TE Part #2-1703648-1
7POS, MIXED,TAB HSG,ASSY,CODB

Documents

CAD Files

Customer View Model

[ENG_CVM_826779-1_C.3d_igs.zip](#)

English

Customer View Model

[ENG_CVM_826779-1_C.3d_stp.zip](#)

English

Customer View Model

[ENG_CVM_826779-1_C.2d_dxf.zip](#)

English

3D PDF

English

By downloading the CAD file I accept and agree to the [Terms and Conditions](#) of use.