

638652-2 ✓ ACTIVE

AMP | 1.5/2.8 Connector System

TE Internal #: 638652-2

Receptacle Terminal, 18 – 20 AWG, .823 – .518 mm² Wire, 1.5 mm [.06 in] Tab Width, Tin (Sn), Unsealed, Terminates To Wire, 1.5/2.8 Connector System

[View on TE.com >](#)



Automotive Parts > Automotive Terminals > 1.5/2.8 CONNECTOR SYSTEM, RECPT AND TAB

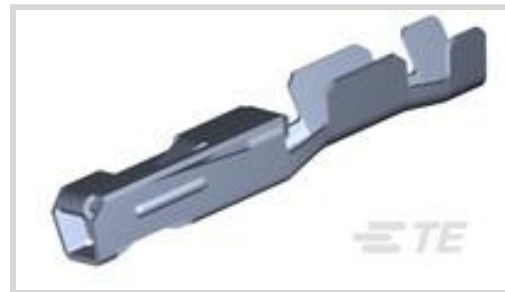

Terminal Type: **Receptacle**

Wire Size: **18 – 20 AWG**

Mating Tab Width: **1.5 mm [.06 in]**

Interface Plating: **Tin (Sn)**

[All 1.5/2.8 CONNECTOR SYSTEM, RECPT AND TAB \(36\)](#)

Features

Product Type Features

Receptacle Style	180°
Primary Locking Feature	Clean Body
Sealable	No

Body Features

Terminal Seal Type	Unsealed
--------------------	----------

Contact Features

Typical Current Rating	16 A
Crimp Type	F-Crimp
Contact Size	1.5mm
Contact Fabrication	Stamped & Formed
Wire Contact Termination Area Plating Material	Tin
Terminal Type	Receptacle
Mating Tab Width	1.5 mm [.06 in]
Interface Plating	Tin (Sn)

Termination Features

Termination Method to Wire & Cable	Crimp
Product Terminates To	Wire



Dimensions

Compatible Insulation Diameter Range	1.4 – 2.13 mm [.05 – .084 in]
Wire Size	18 – 20 AWG
Wire Size Search	.5 mm ² , .6 mm ² , .75 mm ² , .82 mm ²
Tab Length	17.25 mm [6.8 in]

Usage Conditions

Insulation Option	Uninsulated
Operating Temperature (Max)	125 °C [257 °F]
Operating Temperature Range	-40 – 125 °C [-40 – 257 °F]

Operation/Application

Compatible With Wire Base Material	Copper
------------------------------------	--------

Industry Standards

Compatible With Agency/Standards Products	LV214
---	-------

Packaging Features

Packaging Method	Reel
Packaging Quantity	7000

Other

Customer Preferred Contact	No
Terminal Transmits	0 – 24 A (Low Power)

Product Compliance

[For compliance documentation, visit the product page on TE.com>](#)

EU RoHS Directive 2011/65/EU	Compliant
EU ELV Directive 2000/53/EC	Compliant
China RoHS 2 Directive MIIT Order No 32, 2016	No Restricted Materials Above Threshold
EU REACH Regulation (EC) No. 1907/2006	Current ECHA Candidate List: JAN 2025 (247) Candidate List Declared Against: JAN 2025 (247) Does not contain REACH SVHC
Halogen Content	Low Halogen - Br, Cl, F, I < 900 ppm per homogenous material. Also BFR/CFR/PVC Free
Solder Process Capability	Not reviewed for solder process capability

Product Compliance Disclaimer

This information is provided based on reasonable inquiry of our suppliers and represents our current actual knowledge based on the information they provided. This information is subject to change. The part numbers that TE has identified as EU RoHS compliant have a maximum concentration of 0.1% by weight in homogenous materials for lead, hexavalent chromium, mercury, PBB, PBDE, DBP, BBP, DEHP, DIBP, and 0.01% for cadmium, or qualify for an exemption to these limits as defined in the Annexes of Directive 2011/65/EU (RoHS2). Finished electrical and electronic equipment products will be CE marked as required by Directive 2011/65/EU. Components may not be CE marked. Additionally, the part numbers that TE has identified as EU ELV compliant have a maximum concentration of 0.1% by weight in homogenous materials for lead, hexavalent chromium, and mercury, and 0.01% for cadmium, or qualify for an exemption to these limits as defined in the Annexes of Directive 2000/53/EC (ELV). Regarding the REACH Regulation, the information TE provides on SVHC in articles for this part number is based on the latest European Chemicals Agency (ECHA) 'Guidance on requirements for substances in articles' posted at this URL: <https://echa.europa.eu/guidance-documents/guidance-on-reach>

Compatible Parts



TE Part # 3-2141581-9
32POS, MIXED, REC HSG, ASSY,
SEALED



TE Part # CAT-M8793-CH8172
MOS, CONNECTOR HOUSING



TE Part # 2050836-1
PACKAGE COMPONENT FOR 65P
MIXED PLUG HSG



TE Part # 2421112-6
64P ECU PLUG CONNECTOR



TE Part # 2305570-1
Strip Terminal Cutter-Side Feed-No
Crimp



TE Part # 7-2266247-7
OCEAN_2.0_SPARE_PART_KIT-
070F080F



TE Part # 2137299-7
PACKAGE COMPONENT FOR 32P
MIXE



TE Part # 2137492-1
48 POS MIXED REC HSG BRN W/ CO



TE Part # 2137491-1
48 POS MIXED REC HSG GREY W/ C



TE Part # 2050036-4
64P ECU PLUG CONNECTOR



TE Part # 213729-6
CPC RCPT ASSY, SZ 17-14, W/INSRT



TE Part # 9-2300050-9
32POS MIXED RECEPTACLE
HOUSING



TE Part # 3-2177515-7
32POS, MIXED, REC HSG, ASSY, SEALED



TE Part # 3-2141581-8
32POS, MIXED, REC HSG, ASSY, SEALED



TE Part # 2266247-2
OCEAN_2.0_Applicator-S-070F080F-RSA



TE Part # 2050036-5
64P ECU PLUG CONNECTOR



TE Part # 2050036-1
64P ECU PLUG CONNECTOR



TE Part # 2455296-1
PACKAGE COMPONENT FOR 32P MIXE

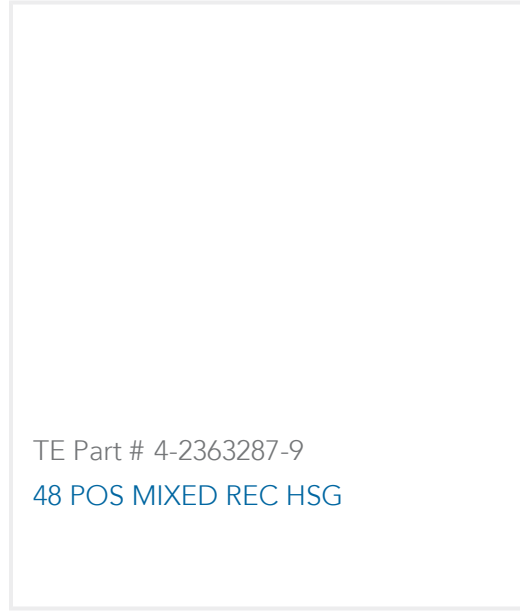

TE Part # 4-2363287-9
48 POS MIXED REC HSG



TE Part # 2421112-5
64P ECU PLUG CONNECTOR

Also in the Series | **1.5/2.8 Connector System**



Automotive Headers(1)



Automotive Housings(32)



Automotive Signal & Power Connector Housings(23)

Customers Also Bought



TE Part #1670108-1
BLIND PLUG FEMALE 1.5



TE Part #1719661-1
2 LOCK REC HSG



TE Part #2050036-1
64P ECU PLUG CONNECTOR



TE Part #2112228-1
PROTECTION CAP,TE



TE Part #2338360-1
2P ECONOSEAL RECEPTACLE ASSY



TE Part #9-2363287-9
48 POS MIXED REC HSG BN



TE Part #2294463-2
MCON 1.2 CB TAB MONO



TE Part #2299987-3
65W PLUG ASSEMBLY

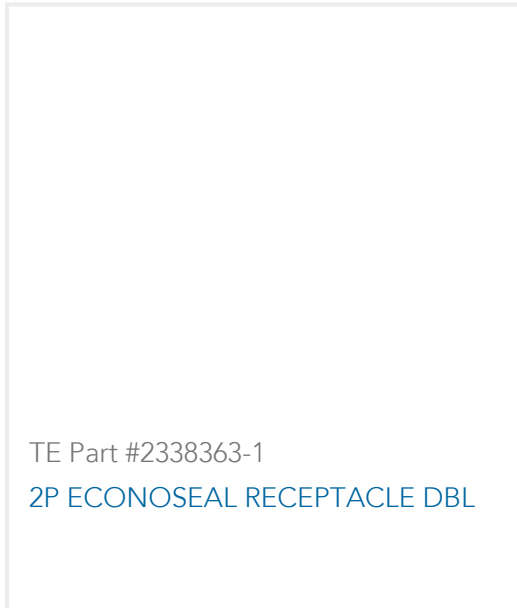

Documents

Product Drawings

[RECEPT,1.5MM,TIN 18-20AWG RD=1](#)

English

CAD Files

Customer View Model

[ENG_CVM_CVM_638652-2_D.2d_dxf.zip](#)

English

[3D PDF](#)

3D

Customer View Model

[ENG_CVM_CVM_638652-2_D.3d_igs.zip](#)

English

Customer View Model

[ENG_CVM_CVM_638652-2_D.3d_stp.zip](#)

English

By downloading the CAD file I accept and agree to the [Terms and Conditions](#) of use.

Product Specifications

[Application Specification](#)

English