

LOC	DIST	REVISIONS			
P	LTN	DESCRIPTION	DATE	OWN	APVD
F		REVISED PER ECO-16-001363	29JAN2016	ERL	ERL
G		REVISED PER ECO-16-004862	29MAR2016	ERL	ERL
G1		REVISED PER ECO-16-006284	25APR2016	ERL	ERL
H		REVISED PER ECO-16-009531	24JUN2016	JAB	ERL

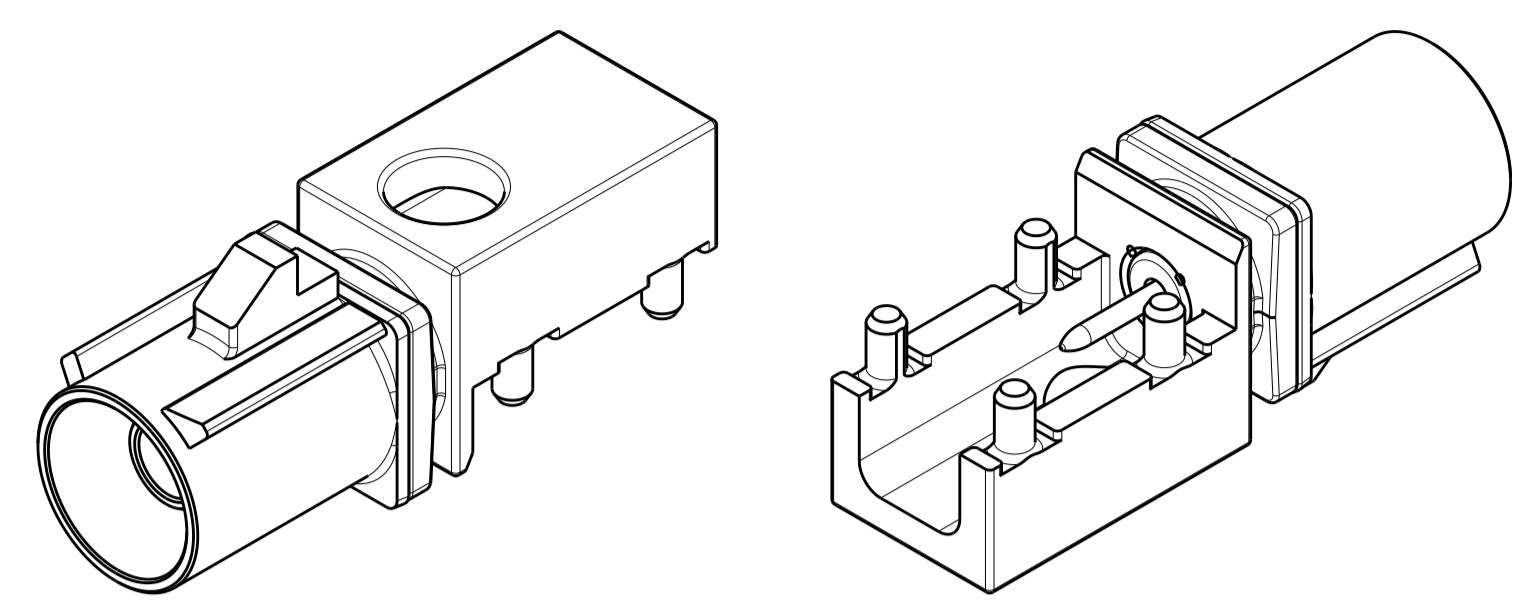

ISOMETRIC VIEWS
SCALE 4:1

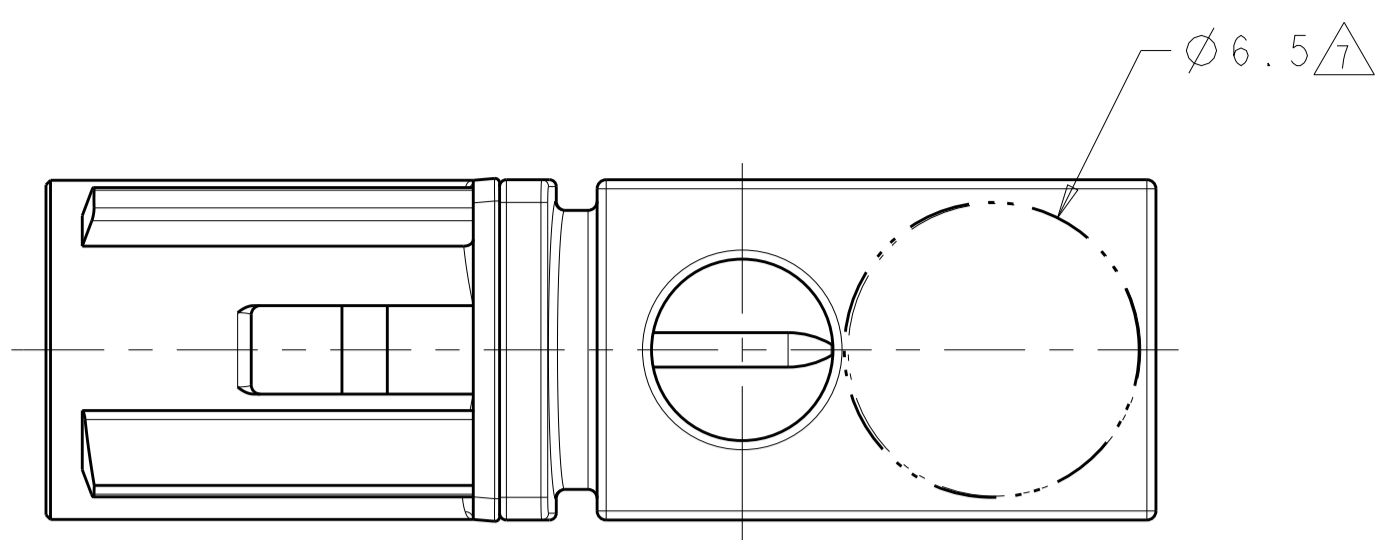
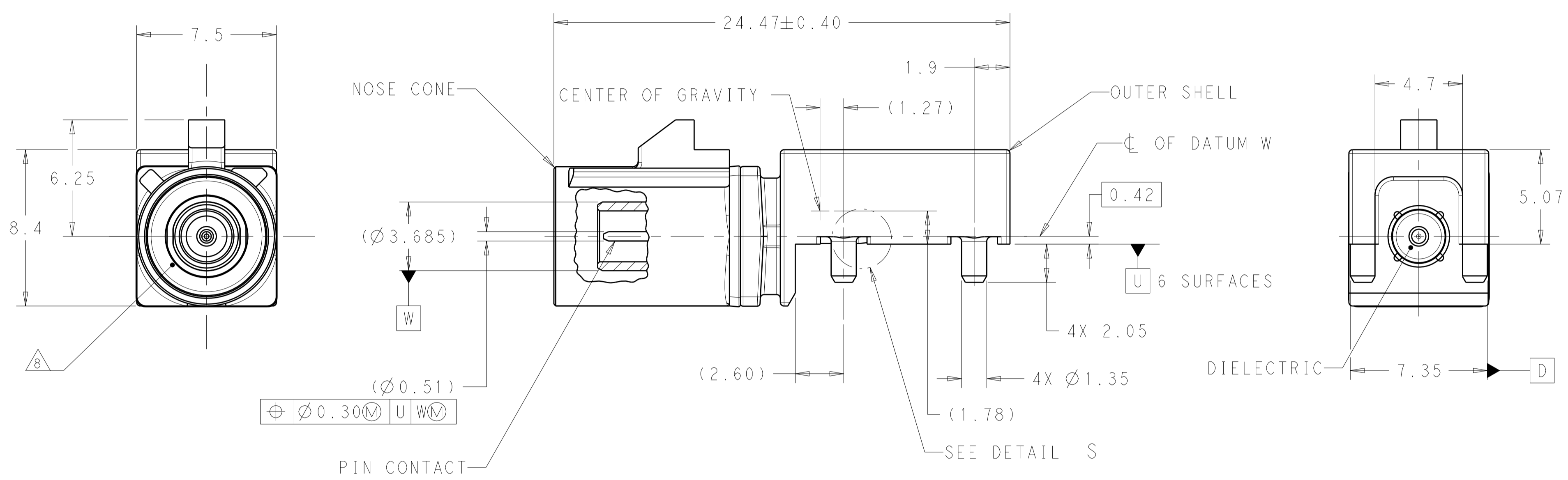

FINISH	PACKAGING	CODING DETAIL	NOSE CONE COLOR	CODING REF	PART NUMBER
3	TAPE AND REEL	PER DETAIL Z	WATER BLUE	Z	9-2287906-0
		PER DETAIL N	PASTEL GREEN	N	8-2287906-3
		PER DETAIL M	PASTEL ORANGE	M	8-2287906-2
		PER DETAIL L	CARMINE RED	L	8-2287906-1
		PER DETAIL K	CURRY	K	8-2287906-0
		PER DETAIL I	BEIGE	I	7-2287906-9
		PER DETAIL H	HEATHER VIOLET	H	7-2287906-8
		PER DETAIL G	BLUE GREY	G	7-2287906-7
		PER DETAIL F	NUT BROWN	F	7-2287906-6
		PER DETAIL E	LEAF GREEN	E	7-2287906-5
		PER DETAIL D	CLARET VIOLET	D	7-2287906-4
		PER DETAIL C	SIGNAL BLUE	C	7-2287906-3
PER DETAIL B	CREAM	B	7-2287906-2		
PER DETAIL A	JET BLACK	A	7-2287906-1		
2	TAPE AND REEL	PER DETAIL Z	WATER BLUE	Z	7-2287906-0
		PER DETAIL N	PASTEL GREEN	N	6-2287906-3
		PER DETAIL M	PASTEL ORANGE	M	6-2287906-2
		PER DETAIL L	CARMINE RED	L	6-2287906-1
		PER DETAIL K	CURRY	K	6-2287906-0
		PER DETAIL I	BEIGE	I	5-2287906-9
		PER DETAIL H	HEATHER VIOLET	H	5-2287906-8
		PER DETAIL G	BLUE GREY	G	5-2287906-7
		PER DETAIL F	NUT BROWN	F	5-2287906-6
		PER DETAIL E	LEAF GREEN	E	5-2287906-5
		PER DETAIL D	CLARET VIOLET	D	5-2287906-4
		PER DETAIL C	SIGNAL BLUE	C	5-2287906-3
PER DETAIL B	CREAM	B	5-2287906-2		
PER DETAIL A	JET BLACK	A	5-2287906-1		
3	TRAY	PER DETAIL Z	WATER BLUE	Z	4-2287906-0
		PER DETAIL N	PASTEL GREEN	N	3-2287906-3
		PER DETAIL M	PASTEL ORANGE	M	3-2287906-2
		PER DETAIL L	CARMINE RED	L	3-2287906-1
		PER DETAIL K	CURRY	K	3-2287906-0
		PER DETAIL I	BEIGE	I	2-2287906-9
		PER DETAIL H	HEATHER VIOLET	H	2-2287906-8
		PER DETAIL G	BLUE GREY	G	2-2287906-7
		PER DETAIL F	NUT BROWN	F	2-2287906-6
		PER DETAIL E	LEAF GREEN	E	2-2287906-5
		PER DETAIL D	CLARET VIOLET	D	2-2287906-4
		PER DETAIL C	SIGNAL BLUE	C	2-2287906-3
PER DETAIL B	CREAM	B	2-2287906-2		
PER DETAIL A	JET BLACK	A	2-2287906-1		
3	TRAY	PER DETAIL Z	WATER BLUE	Z	2-2287906-0
		PER DETAIL N	PASTEL GREEN	N	1-2287906-3
		PER DETAIL M	PASTEL ORANGE	M	1-2287906-2
		PER DETAIL L	CARMINE RED	L	1-2287906-1
		PER DETAIL K	CURRY	K	1-2287906-0
		PER DETAIL I	BEIGE	I	2287906-9
		PER DETAIL H	HEATHER VIOLET	H	2287906-8
		PER DETAIL G	BLUE GREY	G	2287906-7
		PER DETAIL F	NUT BROWN	F	2287906-6
		PER DETAIL E	LEAF GREEN	E	2287906-5
		PER DETAIL D	CLARET VIOLET	D	2287906-4
		PER DETAIL C	SIGNAL BLUE	C	2287906-3
PER DETAIL B	CREAM	B	2287906-2		
PER DETAIL A	JET BLACK	A	2287906-1		

- 1 NOSE CONE - NYLON, COLOR: SEE TABLE, 25% GLASS FILLED.
DIELECTRIC - POLYESTER PCT, NATURAL, 30% GLASS FILLED.
PIN CONTACT - BRASS.
OUTER SHELL - ZINC.
- 2 PIN CONTACT - 0.38µm MIN GOLD ON INTERFACE END,
2.5µm MIN TIN ON SOLDER END,
BOTH OVER 1.3µm MIN NICKEL.
OUTER SHELL - 2.0µm MIN TIN OVER 1.52µm MIN NICKEL,
BOTH OVER 2.54µm MIN COPPER.
- 3 PIN CONTACT - 0.80µm MIN GOLD ON INTERFACE END,
2.5µm MIN TIN ON SOLDER END,
BOTH OVER 1.3µm MIN NICKEL.
OUTER SHELL - 3.0µm MIN TIN OVER 2.0µm MIN NICKEL,
BOTH OVER 10.0µm MIN COPPER.
- 4 MINIMUM SIGNAL PAD FOR SOLDER.
- 5 MINIMUM RECOMMENDED GROUND PLANE.
- 6 SIGNAL DIMENSION TRACE RECOMMENDED FOR OPTIMUM SIGNAL PERFORMANCE.
- 7 VACUUM PICKUP AREA.
- 8 MALE INTERFACE PER SAE/USCAR-18 REVISION 3, ROAD VEHICLES 50 Ohm RADIO FREQUENCY INTERFACE.
- 9 REELING VIEW FOR REFERENCE ONLY TO SHOW UNREELING DIRECTION

DETAIL S
SCALE 15:1

THIS DRAWING IS A CONTROLLED DOCUMENT.

DIMENSIONS:	TOLERANCES UNLESS OTHERWISE SPECIFIED:	OWN J.A.BAKER 30SEP2014	TE Connectivity MALE ASSEMBLY, 1 POSITION, 12 O'CLOCK, EDGE MOUNT, PCB, FAKRA
mm	0 PLC ±0.2	CHK D.J.LANE 30SEP2014	
	1 PLC ±0.08	APVD D.J.LANE 30SEP2014	
	2 PLC ±0.05	PRODUCT SPEC 108-32058	
MATERIAL	FINISH SEE TABLE	APPLICATION SPEC 114-32108	SIZE CAGE CODE DRAWING NO RESTRICTED TO
		WEIGHT 3.07g	A100779C=2287906
		CUSTOMER DRAWING	SCALE 6:1 SHEET 1 OF 2 REV H

LOC	DIST	REVISIONS			
P	LTN	DESCRIPTION	DATE	DWN	APVD
IN	00	SEE SHEET 1			

CODINGS

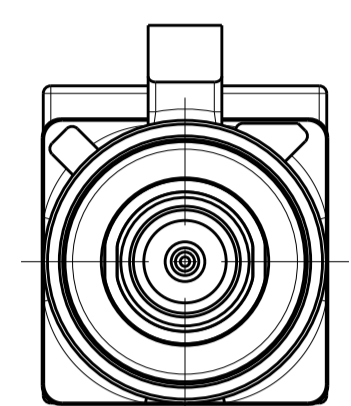

DETAIL A
SCALE 5:1

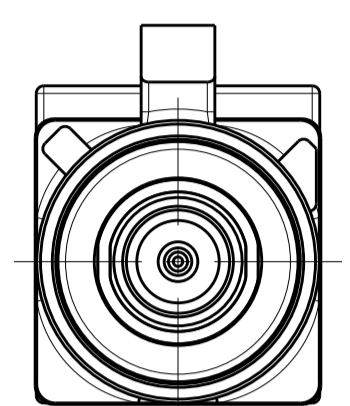

DETAIL B
SCALE 5:1

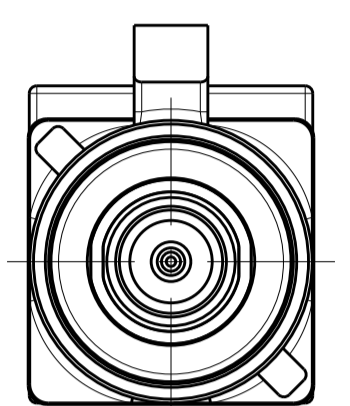

DETAIL C
SCALE 5:1

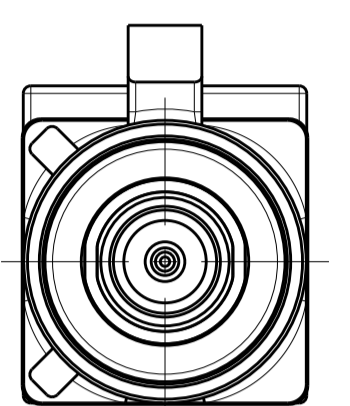

DETAIL D
SCALE 5:1

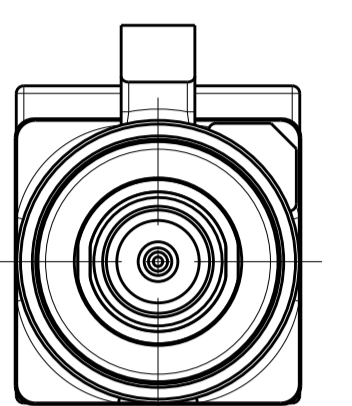

DETAIL E
SCALE 5:1

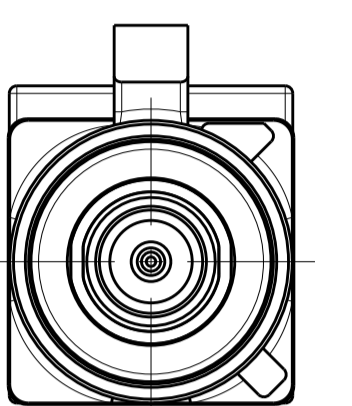

DETAIL F
SCALE 5:1

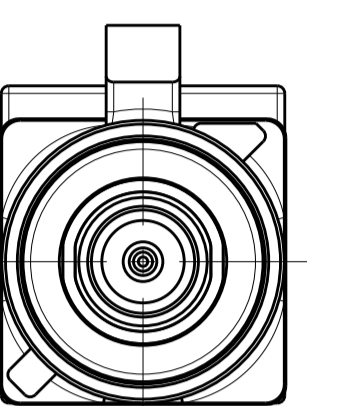

DETAIL G
SCALE 5:1

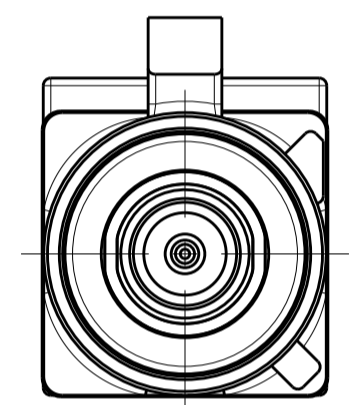

DETAIL H
SCALE 5:1

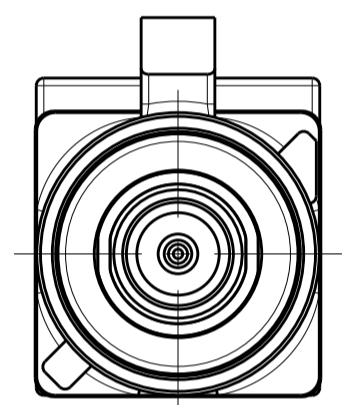

DETAIL I
SCALE 5:1

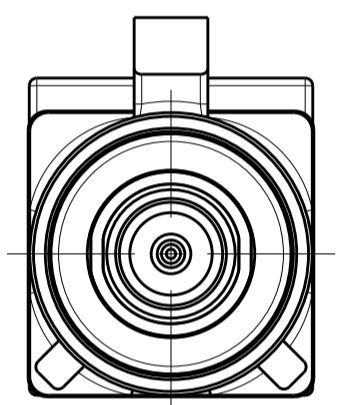

DETAIL K
SCALE 5:1

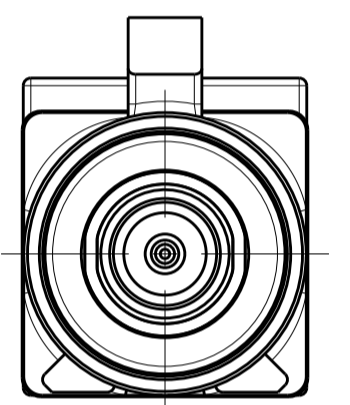

DETAIL L
SCALE 5:1

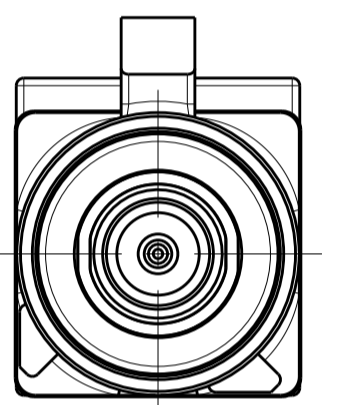

DETAIL M
SCALE 5:1

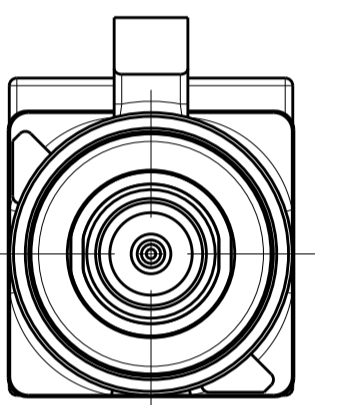

DETAIL N
SCALE 5:1

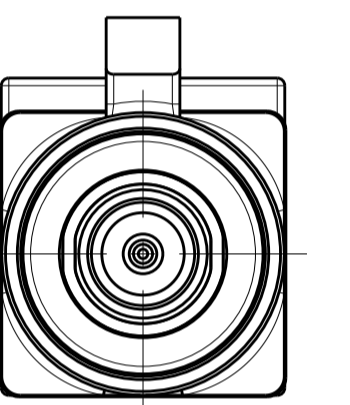

DETAIL Z
SCALE 5:1

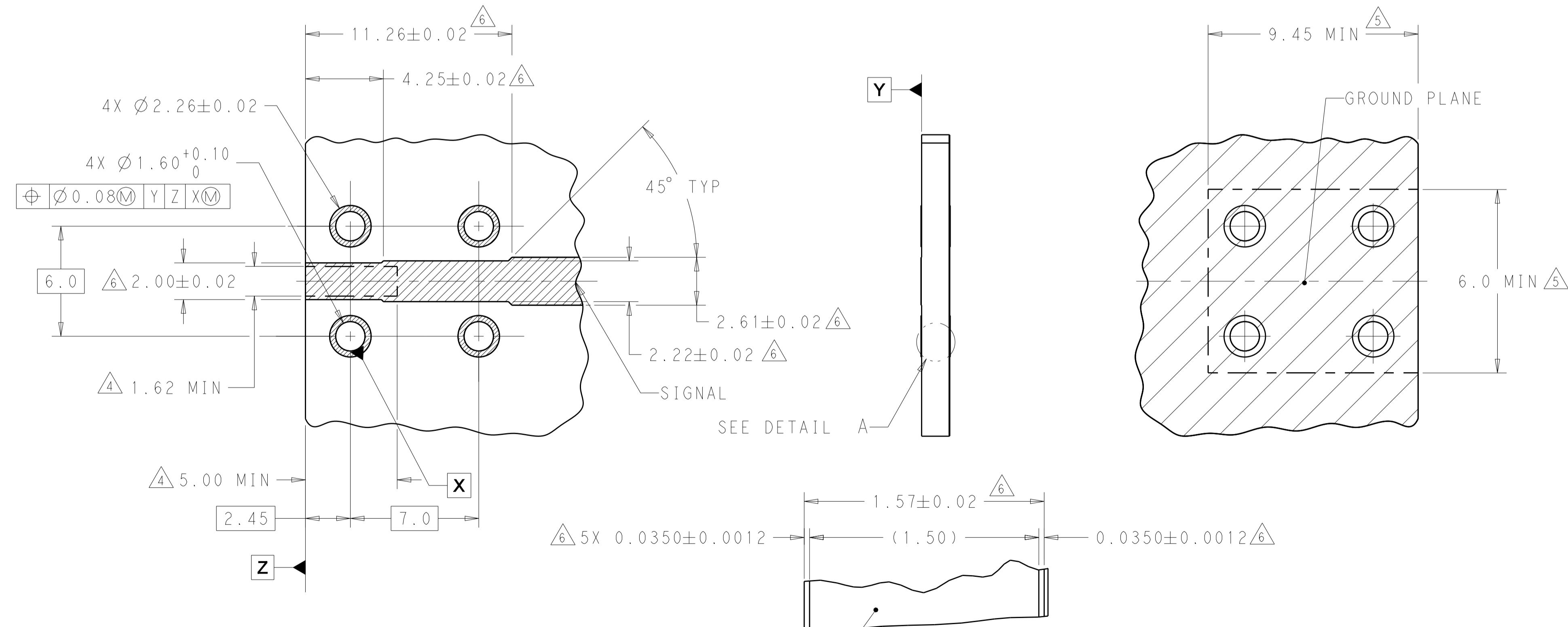

△ MATERIAL DIELECTRIC CONSTANT; FR4 = 4.51
DETAIL A
SCALE 50:1

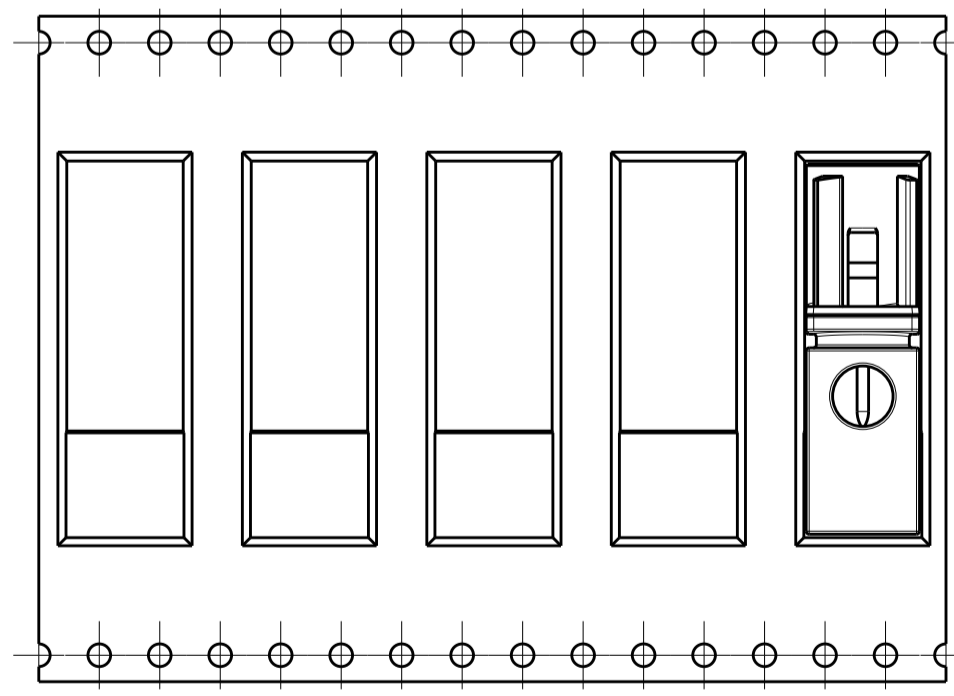

DIRECTION OF UNREELING
SCALE 2:1

THIS DRAWING IS A CONTROLLED DOCUMENT.		DWN: J.A. BAKER 30SEP2014	TE Connectivity
DIMENSIONS: mm		CHK: D.J. LANE 30SEP2014	
TOLERANCES UNLESS OTHERWISE SPECIFIED:		APVD: D.J. LANE 30SEP2014	NAME: MALE ASSEMBLY, 1 POSITION, 12 O'CLOCK, EDGE MOUNT, PCB, FAKRA
0 PLC ±	1 PLC ±0.2	PRODUCT SPEC	SIZE: CAGE CODE DRAWING NO
2 PLC ±0.08	3 PLC ±	108-32058	RESTRICTED TO
4 PLC ±	ANGLES ±	APPLICATION SPEC	
MATERIAL FINISH SEE TABLE		114-32108	
		WEIGHT: 3.07g	A100779C=2287906
		CUSTOMER DRAWING	SCALE: 6:1 SHEET 2 OF 2 REV H