

REVISIONS					
P	LTN	DESCRIPTION	DATE	DWN	APVD
A10		REVISED PER ECN-23-219231	27JUN2023	CN	GK
A11		REVISED PER ECN-23-226437	15AUG2023	CN	GK
A12		REVISED PER ECN-24-287123	02OCT2024	AM	CN
A13		REVISED PER ECN-25-341192	02SEP2025	SR	CN

2 CIRCUITS ACCEPT
0.5 - 6.0mm² WIRE SIZE

80 CIRCUITS ACCEPT
0.35 - 0.75mm² WIRE SIZE

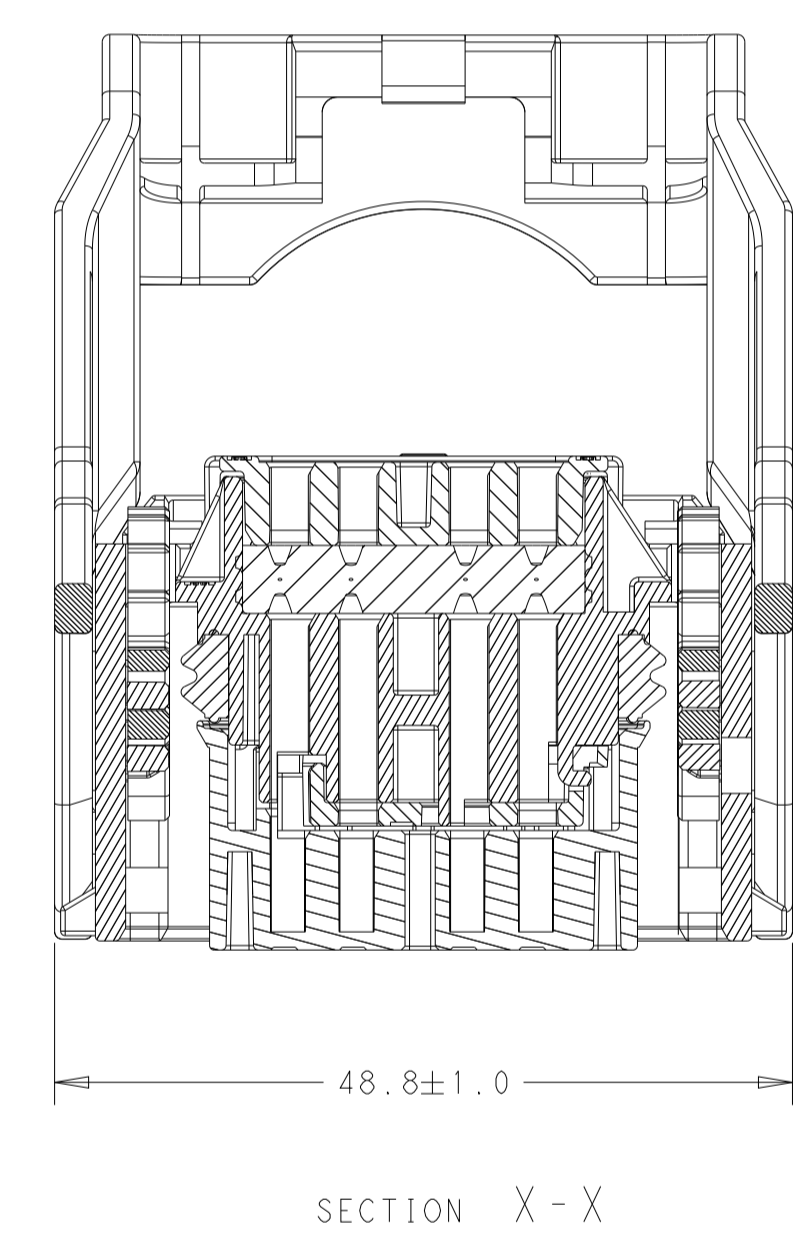
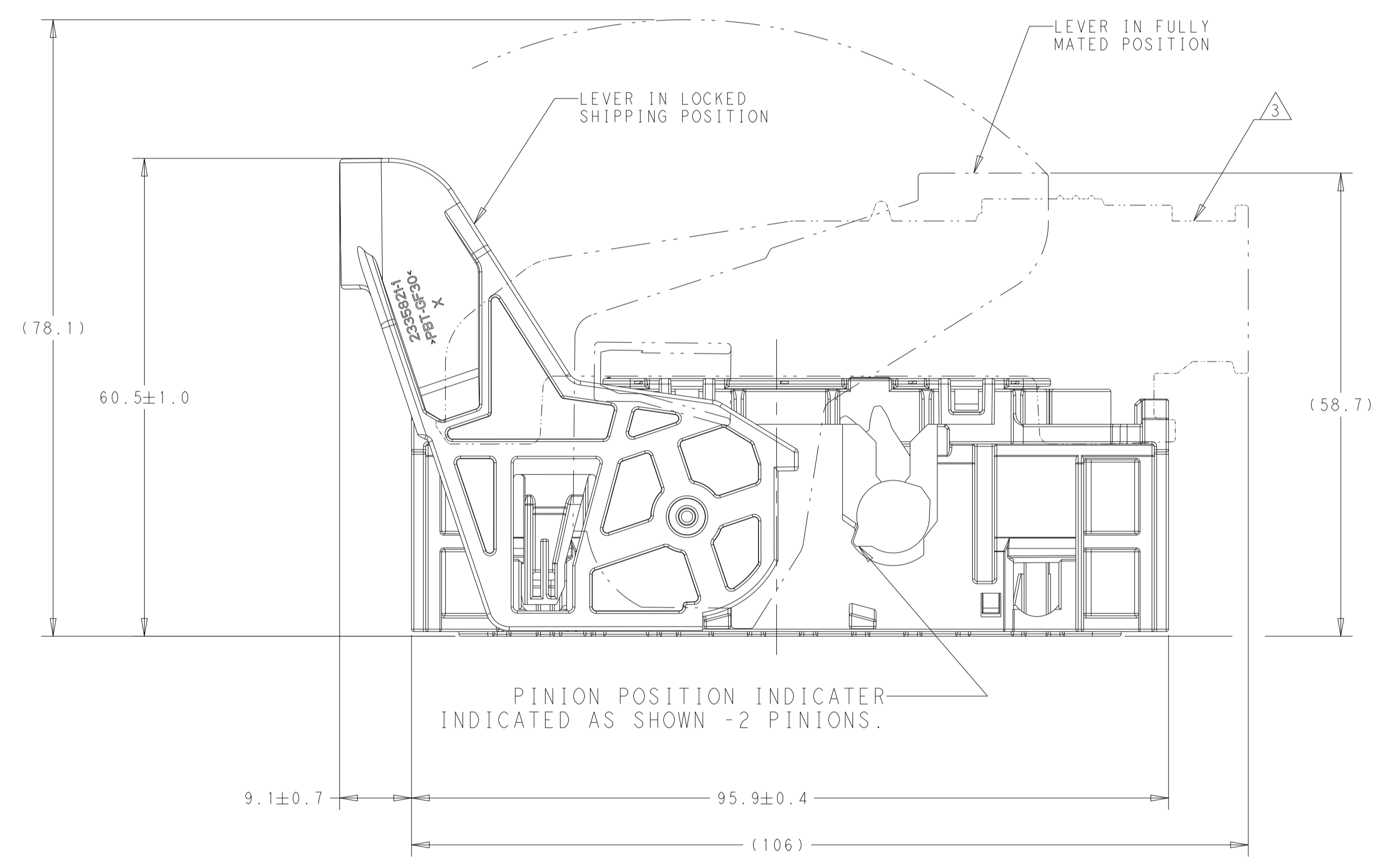
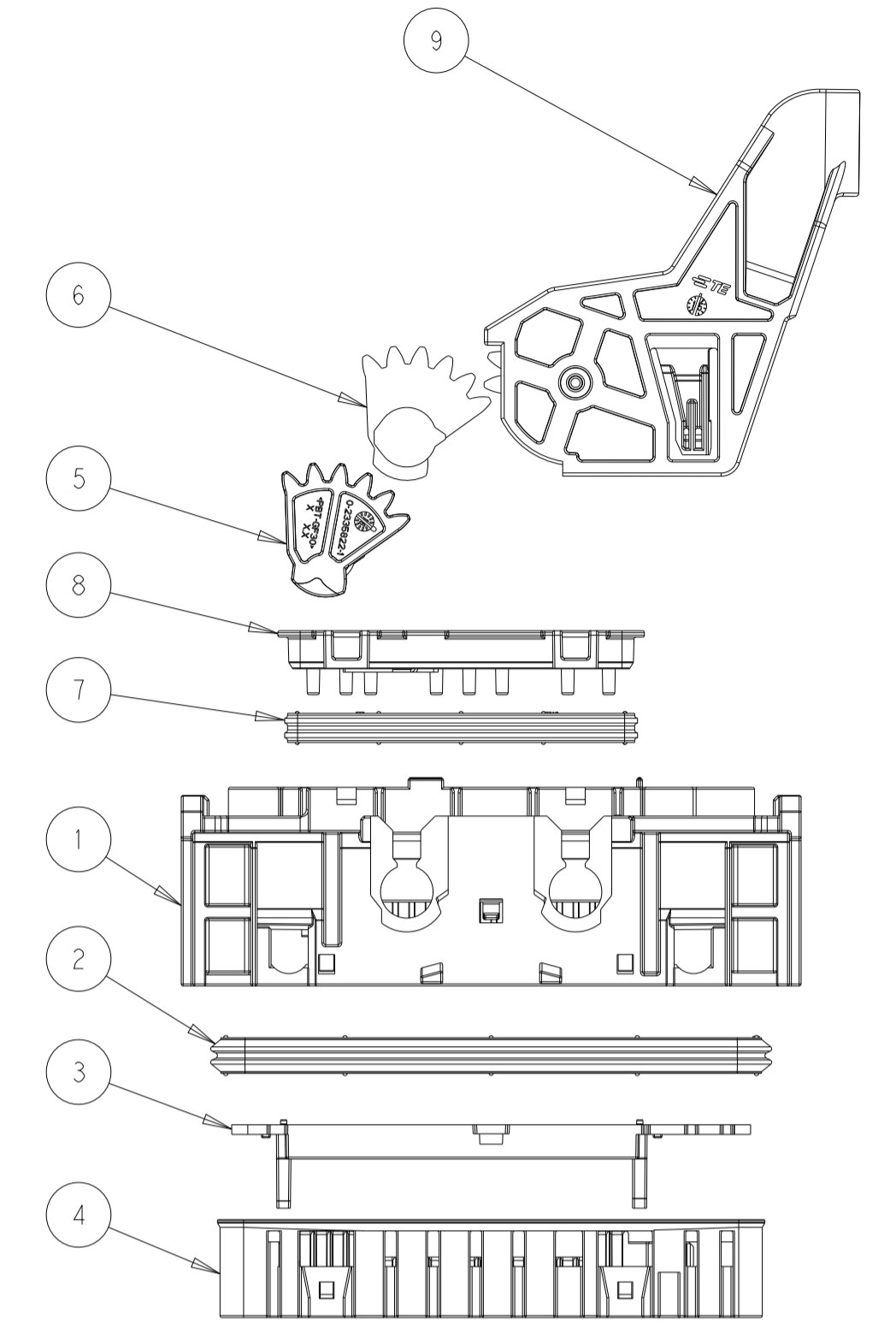
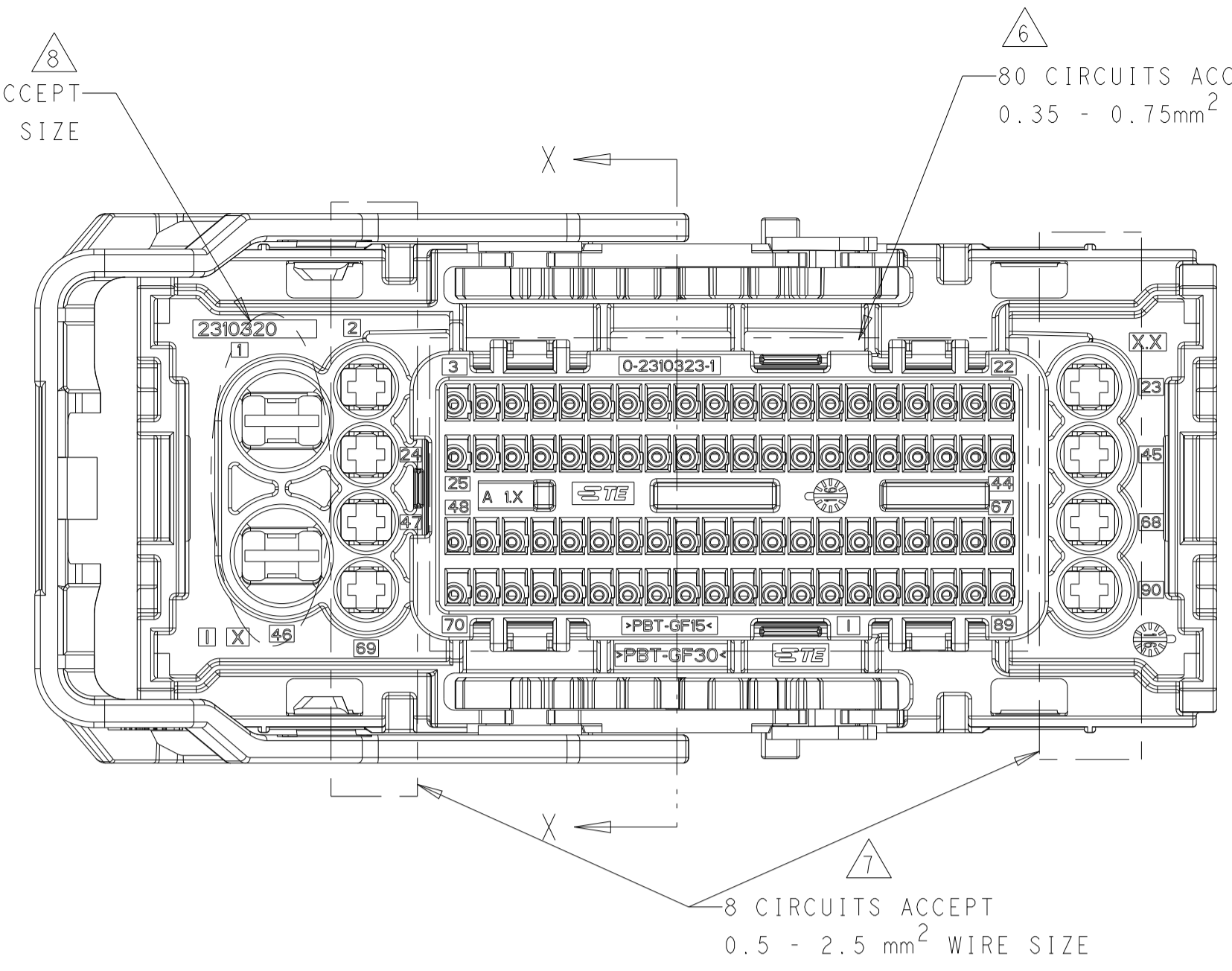

SPECIFIC PINOUT CONFIGURATIONS SEE, TABLE SHEET 3

1	1	A	GREY	LEVER	9
1	1	A	BLACK	MAT SEAL RETAINER	8
1	1	A	BLUE	MAT SEAL	7
1	1	A	GREY	PINION GEAR B	6
1	1	A	GREY	PINION GEAR A	5
-	-	B	NATURAL	FRONT HOUSING CODING D	4
-	-	B	GREY	FRONT HOUSING CODING C	4
-	-	B	BLACK	FRONT HOUSING CODING B	4
1	1	B	BLUE	FRONT HOUSING CODING A	4
1	1	A	RED	ISL	3
1	1	A	GREEN	PERIPHERAL SEAL	2
1	1	B	BLACK	MAIN HOUSING	1
-	-	REV	COLOR	DESCRIPTION	ITEM NO
2344716	2344715	PART NUMBER OF EACH ASSY			
CODING A LEFT	CODING A RIGHT	CODING LEVER POSITION			
A	A	REVISION OF EACH ASSY			

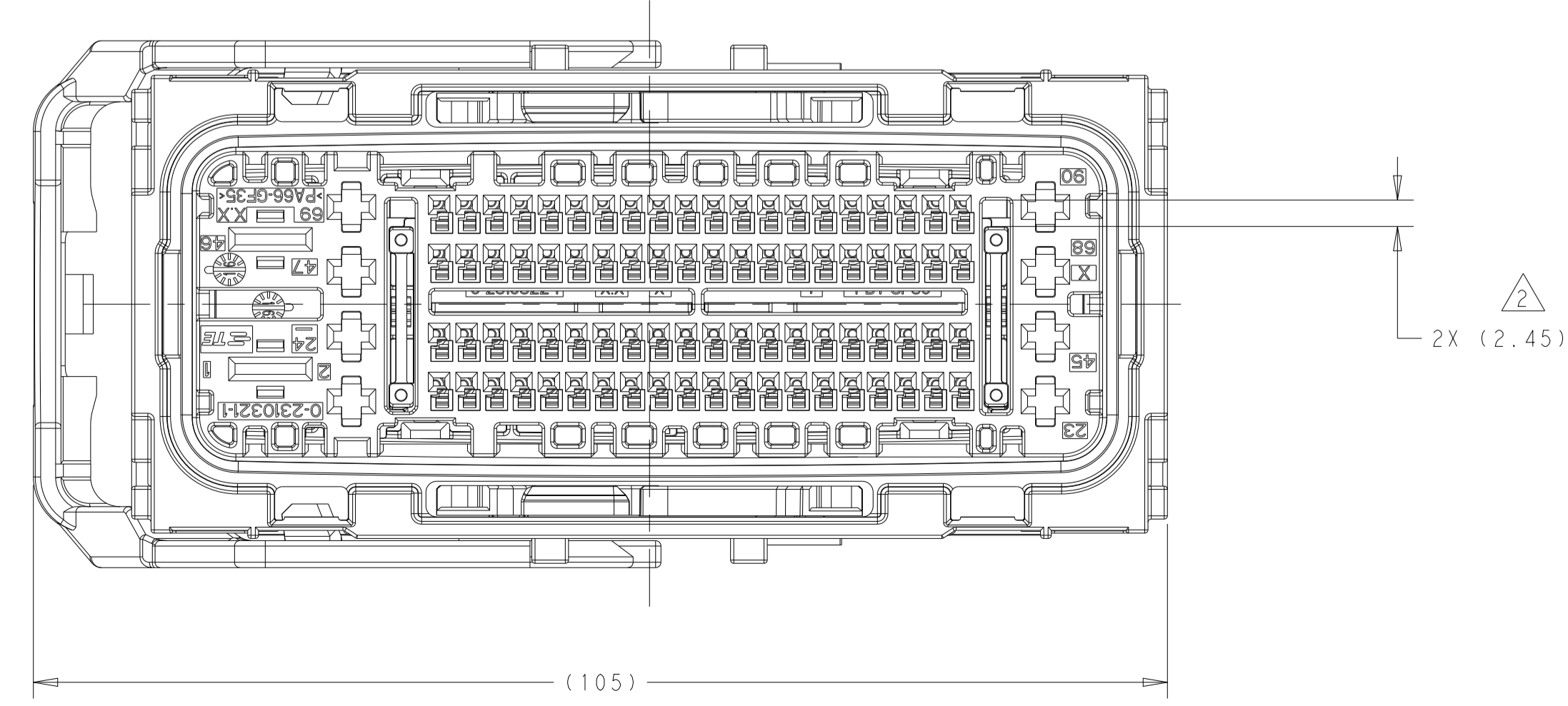

THIS DRAWING IS A CONTROLLED DOCUMENT.

OWN: V. UMARJI 04OCT2018
CHK: M. ALLOWAY 12OCT2018
APVD: G. PUCKEL 15OCT2018

NAME: 90 POS SEALED PLUG ASSEMBLY

SIZE: CAGE CODE DRAWING NO: A100779
SCALE: 2:1 SHEET 1 OF 3

TE Connectivity

RESTRICTED TO

REVISIONS				
P	LTN	DESCRIPTION	DATE	OWN
-		SEE SHEET 1	-	-

△ MATERIALS:

MAIN HOUSING : PBT, 30% GF, BLACK
 PERIPHERAL SEAL : SILICONE, 30 DUROMETER SHORE A, GREEN
 ISL : PBT, 30% GF, RED
 FRONT HOUSING : PA66, 35% GF, BLACK LS
 PINION GEAR RIGHT : PBT, 30% GF, GREY
 PINION GEAR LEFT : PBT, 30% GF, GREY
 MAT SEAL : SILICONE, 18 DUROMETER SHORE A, BLUE
 MAT SEAL RETAINER : PBT, 15% GF, BLACK LS
 LEVER : PBT, 30% GF, GREY

△ ISL SHOWN IN OPEN, SHIPPING POSITION.

△ WIRE DRESS COVER ASSEMBLY, TE P/N 2384266-1, IS REQUIRED AND SOLD AS A SEPARATE PART. WIRE LOADING IS LIMITED BY AVAILABLE VOLUME AND WIRE ORGANIZATION UNDER THE COVER ASSEMBLY. COVER IS DESIGNED TO ACCOMMODATE 66 WIRES OF NOMINAL CONSTRUCTION, WELL ORGANIZED. OTHER LOADING CONFIGURATIONS MAY BE POSSIBLE DEPENDING ON WIRE SIZE. CONTACT RESPONSIBLE TE ENGINEER AT DEVELOPMENT STAGE FOR CONSULTATION. TO AID COVER ATTACHMENT, MAXIMUM HEIGHT OF DRESSED WIRE BUNDLE ABOVE MAT SEAL RETAINER SHOULD BE 33 MILLIMETERS.

4. REFER TO TE DRWG 208-32022 FOR MATING INTERFACE DETAILS.

5. REFERENCE INSTRUCTION SHEET 408-32280 FOR CONNECTOR HANDLING AND USE.

△ APPLICABLE 0.64 GENERATION Y TERMINALS:

- 1-2138699-4 (0.35 mm² WIRE)
- 1-2138699-1 (0.5 mm² WIRE)
- 1-2138699-2 (0.75 mm² WIRE)

△ APPLICABLE 2.8 MCP TERMINAL:

- 1-968855-3 (0.5-1.0 mm² WIRE)
- 828904-1 (SWS)
- 1-968857-3 (1.5-2.5 mm² WIRE)
- 828905-1 (SWS)

△ APPLICABLE 6.3 MCP TERMINALS:

- 1241412-3 (0.5-1.0 mm²)
- 2177018-1 (SWS)
- 1-1241418-3 (4.0-6.0 mm² WIRE)
- 1719043-1 (SWS)

9. LAYER PACKAGING

PACKAGE TYPE	PART NUMBER	QTY
SHIPPING BOX	0-973056-1	1
CORRUGATED INSERT	0-973163-1	4
PAPER CUSHION	0-740045-1	2

10. NOTE REMOVED

11. CONNECTOR CLASSIFICATION:GM3191 JUNE 2012,
 TEMP CLASS T2 (-40° TO 105°C AMBIENT TO CONN SYS)
 125°C OPERATING ENVIRONMENT AT TERMINALS
 VIBRATION CLASS: GMPT CTS PROFILE
 SEALING CLASS: S3 (HIGH PRESSURE SPRAY & IMMERSION TO 1m)
 GMW3172 NOVEMBER 2012 POWERTRAIN UNDERHOOD TEST FLOW LEGS 1-4,
 VIBRATION PROFILE PER TABLE, 8 HRS EACH AXIS WITH TEMPERATURE CYCLES

BREAKPOINT	POWER SPECTRAL DENSITY (G ² /Hz)	FREQUENCY (Hz)
1	0.02	10
2	0.05	20
3	0.05	100
4	0.001	800
5	0.001	2000

12. TERMINALS VALIDATED FOR THIS CONNECTOR: SEE NOTES.
 PRODUCT QUALIFICATION TESTING CONDUCTED MATED TO SPECIFIED INTERFACE WITH 6.3mm CIRCUITS ENERGIZED AT 30.6 AMPS, 2.8mm CIRCUITS ENERGIZED AT 12.7 AMPS, ALL CIRCUITS ENERGIZED CONCURRENTLY AND ON LARGEST WIRE SIZE. ADDITIONAL 16X-0.64mm CIRCUITS POWERED AT 4 AMPS CONCURRENTLY WITH ABOVE ON MAXIMUM WIRE SIZE. (CONTACT CONNECTOR DRE IF DEVIATION IS NEEDED).

13. CONNECTOR SHIPPED WITH THE CPA AND ISL IN THE PRE-LOCK POSITION.

14. REFERENCE TE INSTRUCTION SHEET 408-32280 FOR HARNESS MANUFACTURE AND VEHICLE ASSEMBLY PLANT ASSEMBLY/ DISASSEMBLY AND REPAIR INSTRUCTIONS.

15. THE FOLLOWING DEVIATIONS APPLY TO ACCEPTANCE CRITERA OF ABOVE SPECIFICATIONS:

ISL PRE-LOCK TO LOCK AND LOCK TO PRE-LOCK TESTED BY ACTUATING ISL COLUMNS INDIVIDUALLY AS SHOWN IN INSTRUCTION SHEET 408-32280.

NO LEVER "POP-UP" AT PRE-SEATING TO DEVICE.

FOR MATING WITH SPECIFIED INTERFACE, WORST CASE CONTACT WIPE CAN BE BELOW 1.0mm FOR ALL CONTACTS. STATISTICAL BEST FIT IS GREATER THAN 1.0mm FOR ALL CONTACTS.

LEVER RETENTION IN SHIPPING POSITION IS 127N MINIMUM.

△ A SIX DIGIT MARKING ACC. TABLE (SEE SHEET 3)
 LOCATED ON FRONT OF FEMALE HOUSING.

17. CAVITY PLUGS FOR GENY 0.64 CIRCUITS: 1612108-4
 CAVITY PLUGS FOR MCP 2.8 CIRCUITS: 828922-1
 CAVITY PLUGS FOR MCP 6.3 CIRCUITS: 967652-1

THIS DRAWING IS A CONTROLLED DOCUMENT.		OWN V. UMARJI 04OCT2018	
DIMENSIONS: mm		CHK M. ALLOWAY 12OCT2018	
TOLERANCES UNLESS OTHERWISE SPECIFIED		APVD G. PUCKEL 15OCT2018	NAME 90 POS SEALED PLUG ASSEMBLY
0 PLC ±.3	1 PLC ±.3	PRODUCT SPEC	SIZE
2 PLC ±.075	3 PLC ±.050	APPLICATION SPEC	CAGE CODE
4 PLC ±.050	ANGLES ±1°	FINISH	DRAWING NO
MATERIAL	WEIGHT	RESTRICTED TO	A 00779 C=2344715
CUSTOMER DRAWING	SCALE 2:1	SHEET 2 OF 3	REV A13

