

## 62262 -1 Product Details

**Live Product Chat** US Only  
8:30am - 5pm ET, Mon - Fri

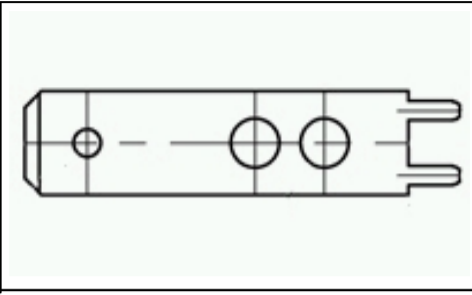

**62262 -1**

[Active](#)

### Quick Disconnect Tabs, Tab Adapters & Tab Caps

[Always EU RoHS/ELV Compliant](#) ( [Statement of Compliance](#) )

#### Product Highlights:

- ? Tab
- ? Tab Type = Printed Circuit Board
- ? Tab Fit = 6.35 x 0.81 mm
- ? Brass Material
- ? Tin Finish

[View all Features](#) | [Find Similar Products](#)

#### Quick Links

- [Check Pricing & Availability](#)
- [Search for Tooling Product Feature Selector](#)
- [Contact Us About This Product](#)

### Documentation & Additional Information

#### Product Drawings:

- ? [TAB, FASTON, .250 SERIES](#) (PDF, English)

#### Catalog Pages/Data Sheets:

- ? None Available

#### Product Specifications:

- ? None Available

#### Application Specifications:

- ? None Available

#### Instruction Sheets:

- ? None Available

#### CAD Files: ( [CAD Format & Compression Information](#) )

- ? [2D Drawing](#) (DXF, Version E)
- ? [3D Model](#) (IGES, Version E)
- ? [3D Model](#) (STEP, Version E)

[List all Documents](#)

#### Additional Information:

- ? [Product Line Information](#)

#### Related Products:

- ? [Tooling](#)

### Product Features (Please use the Product Drawing for all design activity)

#### Product Type Features:

- ? [Product Type](#) = Tab
- ? [Tab Fit \(mm \[in\]\)](#) = 6.35 x 0.81 [.250 x .032]
- ? [Material](#) = Brass
- ? [Finish](#) = Tin
- ? [Mount Angle](#) = Straight
- ? Insulation Support = Without
- ? [PCB Hole Diameter \(mm \[in\]\)](#) = 1.25 [0.049]
- ? [PCB Thickness \(mm \[in\]\)](#) = 3.18 [0.125]

#### Electrical Characteristics:

- ? [Dimple](#) = Without

#### Body Related Features:

- ? [Tab Type](#) = Printed Circuit Board
- ? Stud Hole = Without
- ? Stock Thickness (mm [in]) = 0.81 [0.032]

#### Industry Standards:

- ? [RoHS/ELV Compliance](#) = RoHS compliant, ELV compliant
- ? [Lead Free Solder Processes](#) = Not relevant for lead free process
- ? RoHS/ELV Compliance History = Always was RoHS compliant

#### Packaging Related Features:

- ? [Packaging Method](#) = Loose Piece

#### Other:

- ? Brand = AMP