

REVISIONS					
P	LTN	DESCRIPTION	DATE	DWN	APVD
A		RELEASED PER ECO-19-013357	29AUG2019	CJV	JW
B		REVISED PER ECO-19-014774	26SEP2019	CJV	JW

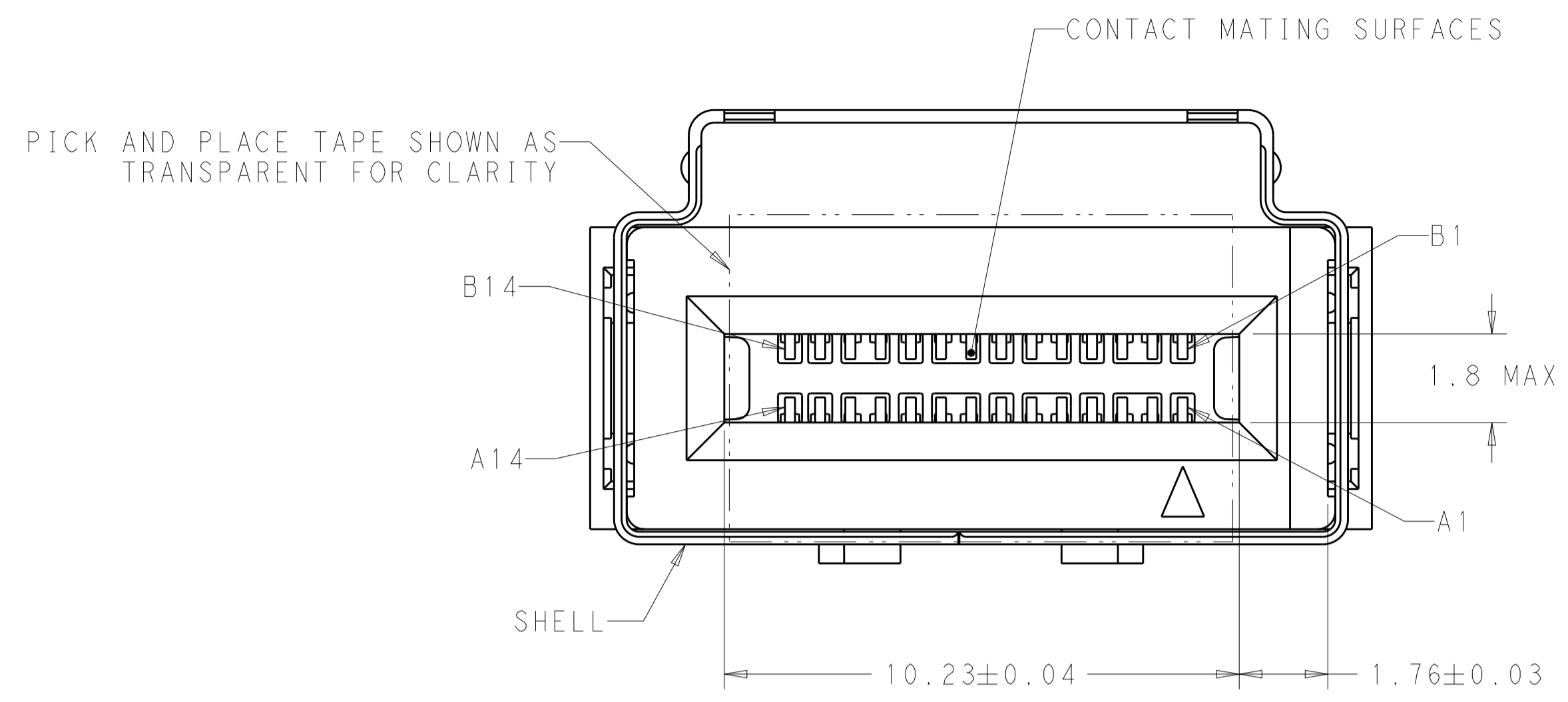

- 1. HOUSING - LCP, UL94V-0, BLACK. CONTACT OVERMOLDS - LCP, UL94V-0, BLACK. SHELL, CONTACTS, HOLD DOWNS - COPPER ALLOY. PICK AND PLACE TAPE - POLYIMIDE FILM.
- 2. CONTACTS - GOLD PLATE ON MATING SURFACES, TIN PLATE ON SOLDER FEET. HOLD DOWNS - TIN PLATE. SHELL - NICKEL PLATE, TIN PLATE ON HOLD DOWNS.
- 3. DATUMS AND BASIC DIMENSIONS ESTABLISHED BY CUSTOMER.
- 4. MINIMUM HOST PCB THICKNESS: 1.5.
- 5. SEE MSA SPECIFICATION FOR ADDITIONAL PADDLE CARD LAYOUTS COMPATIBLE WITH THIS RECEPTACLE AND FOR OPTIONAL SPLIT CONTACT PAD LAYOUTS FOR THE PADDLE CARD. SPECIFICATION PINOUT MAY ALSO DESIGNATE PAD SEQUENCE DIFFERENT FROM ILLUSTRATION.

- 6. POSITIONS DESIGNATED AS "SIGNAL" ARE REQUIRED LOCATIONS FOR HIGH SPEED DIFFERENTIAL PAIR SIGNALING. THESE LOCATIONS MAY ALSO BE USED FOR SUPPORTING SIDEBAND SIGNALS OR OTHER UTILITY PURPOSES. POSITIONS DESIGNATED AS "GROUND" ARE REQUIRED WHEN SUPPORTING HIGH SPEED DIFFERENTIAL SIGNALS. THESE LOCATIONS MAY ALSO BE USED FOR SIDEBAND SIGNALS OR OTHER UTILITY PURPOSES.
- 7. RECOMMENDED COMPONENT AND TRACE KEEP OUT AREA. EACH EDGE 0.15 MIN FROM EDGE OF HOLE.
- 8. PART NUMBER AND DATE CODE MARKED IN APPROXIMATE AREA SHOWN.
- 9. TAPE AND REEL PACKAGED FOR PICK AND PLACE SURFACE MOUNT PROCESSING. POCKET TAPE PITCH = 20.

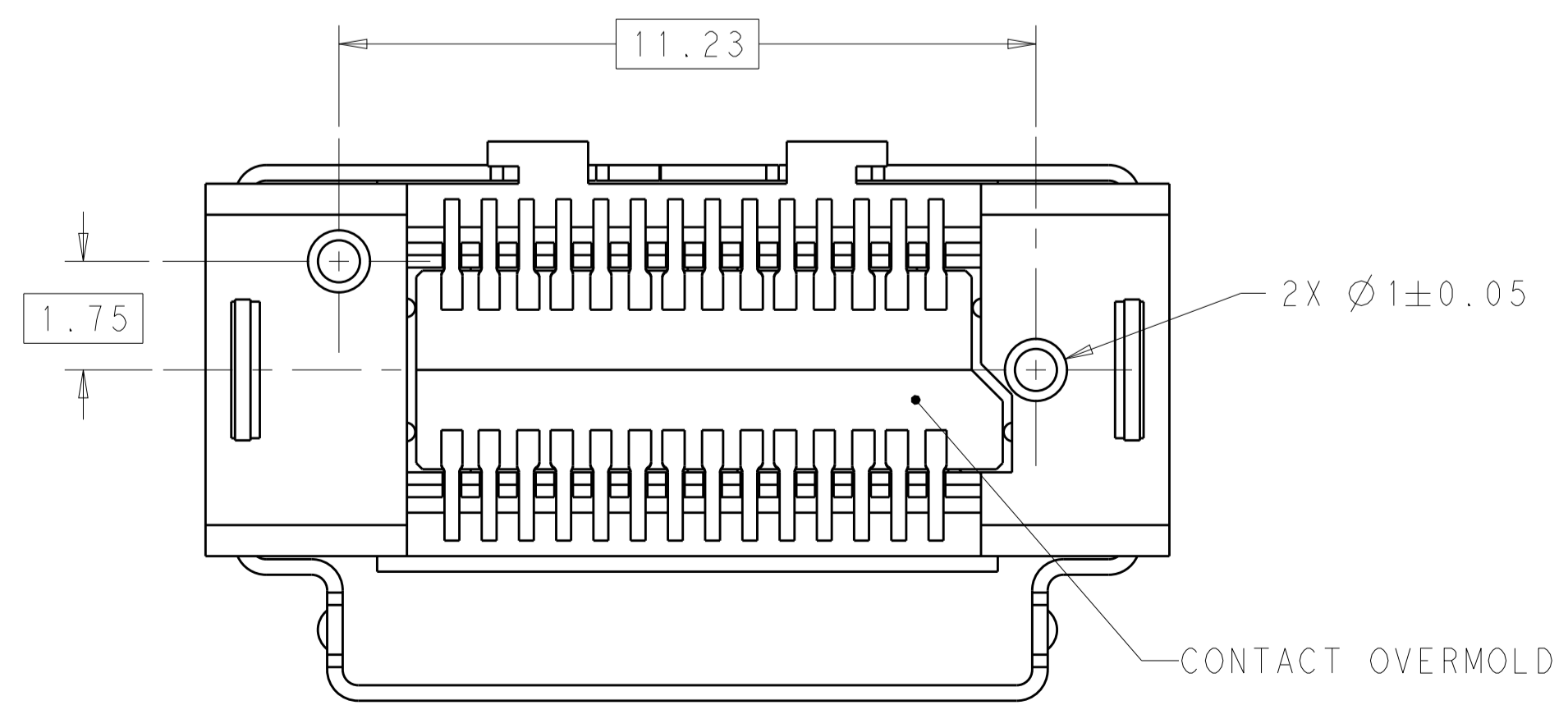
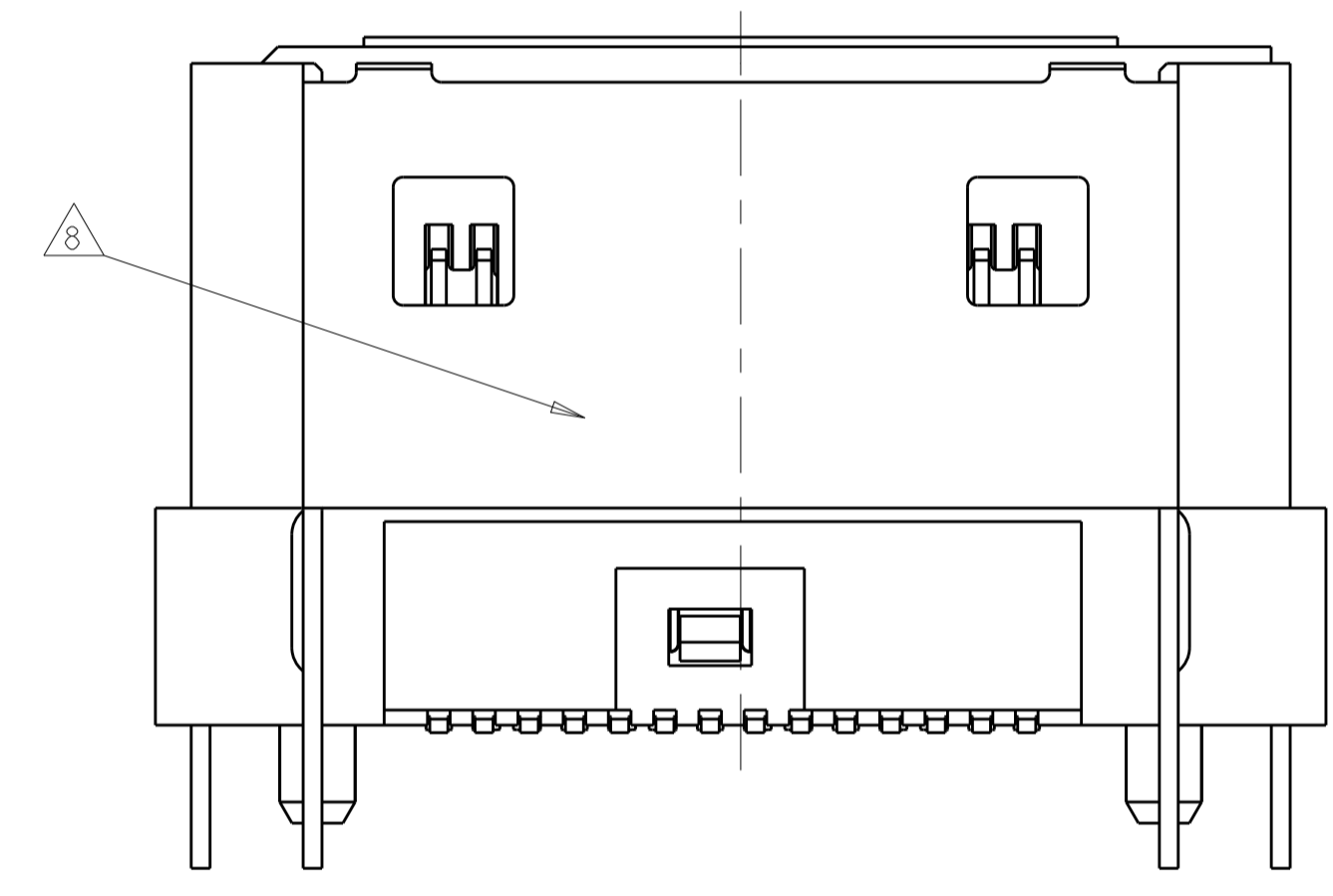
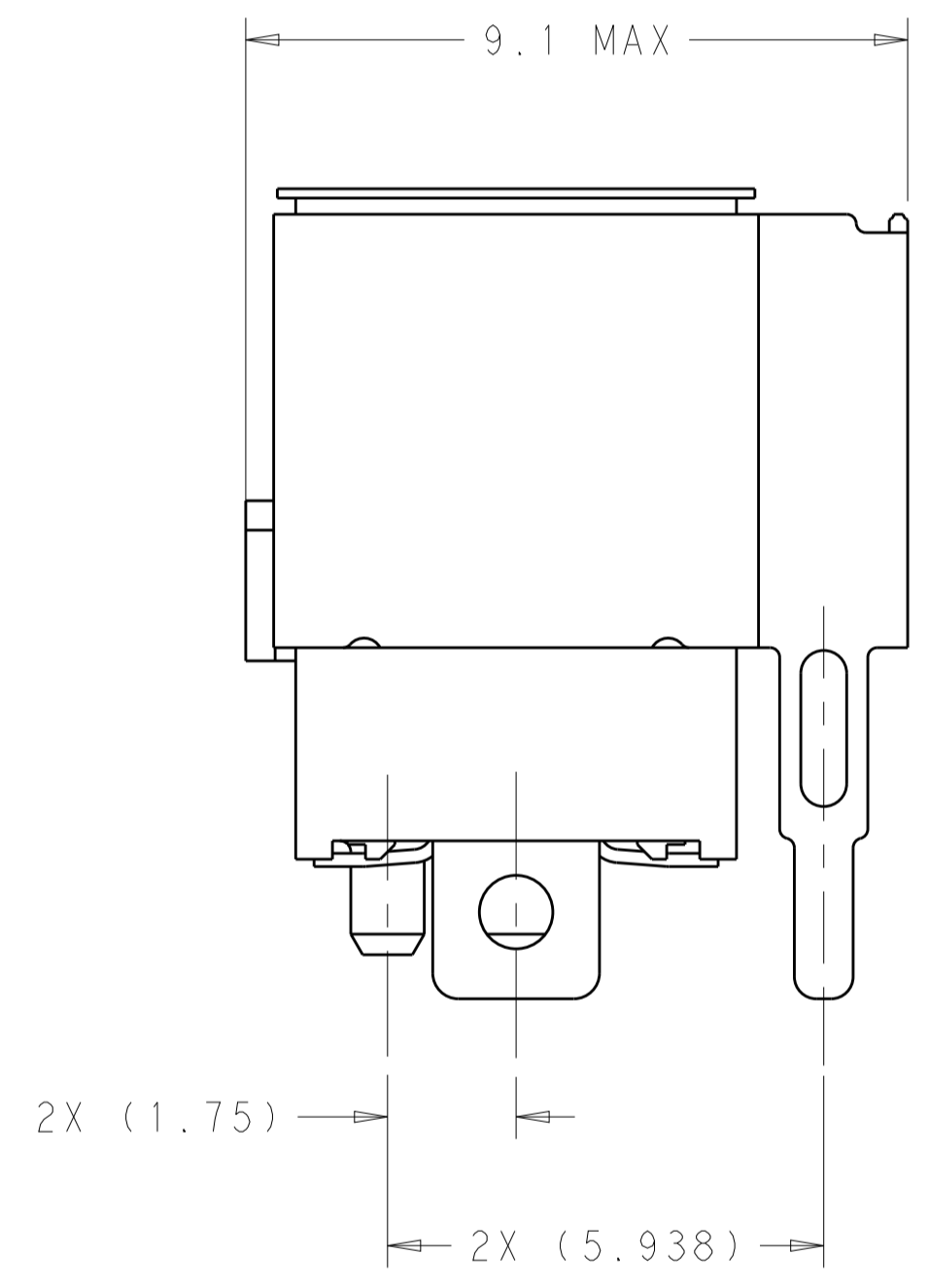
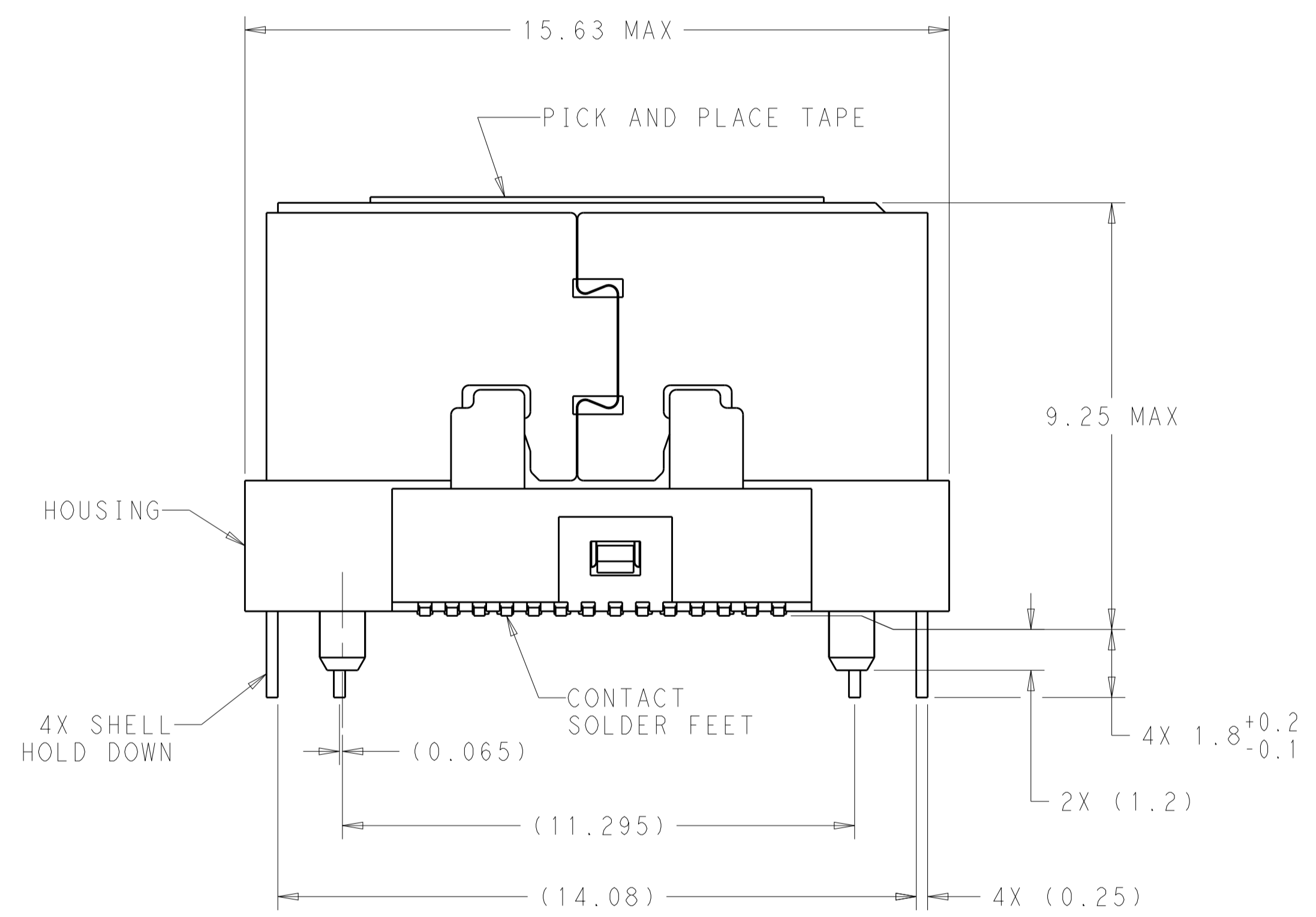

0.76µm Au	200	2354531-3
0.38µm Au	100	2354531-2
FLASH Au/PdNi	50	2354531-1
PLATING	MATING CYCLES	PART NUMBER

THIS DRAWING IS A CONTROLLED DOCUMENT.

DWN: M. SHIRK 08APR2019
 CHK: J. WESTMAN 08APR2019
 APVD: J. WESTMAN 08APR2019

DIMENSIONS: mm

TOLERANCES UNLESS OTHERWISE SPECIFIED:

0 PLC	±
1 PLC	±
2 PLC	±
3 PLC	±
4 PLC	±
ANGLES	±

MATERIAL:

FINISH:

NAME: RECEPTACLE ASSEMBLY, VERTICAL, 28 POSITION, SLIVER 2.0

PRODUCT SPEC: 108-130021

APPLICATION SPEC: 114-130015

SIZE: A1

CAGE CODE: 00779

DRAWING NO: C=2354531

RESTRICTED TO: -

WEIGHT: -

CUSTOMER DRAWING

SCALE: 10:1

SHEET: 1 OF 3

REV: B

TE Connectivity

REVISIONS				
P.	LTN.	DESCRIPTION	DATE	APPD.
-	-	SEE SHEET 1	-	-

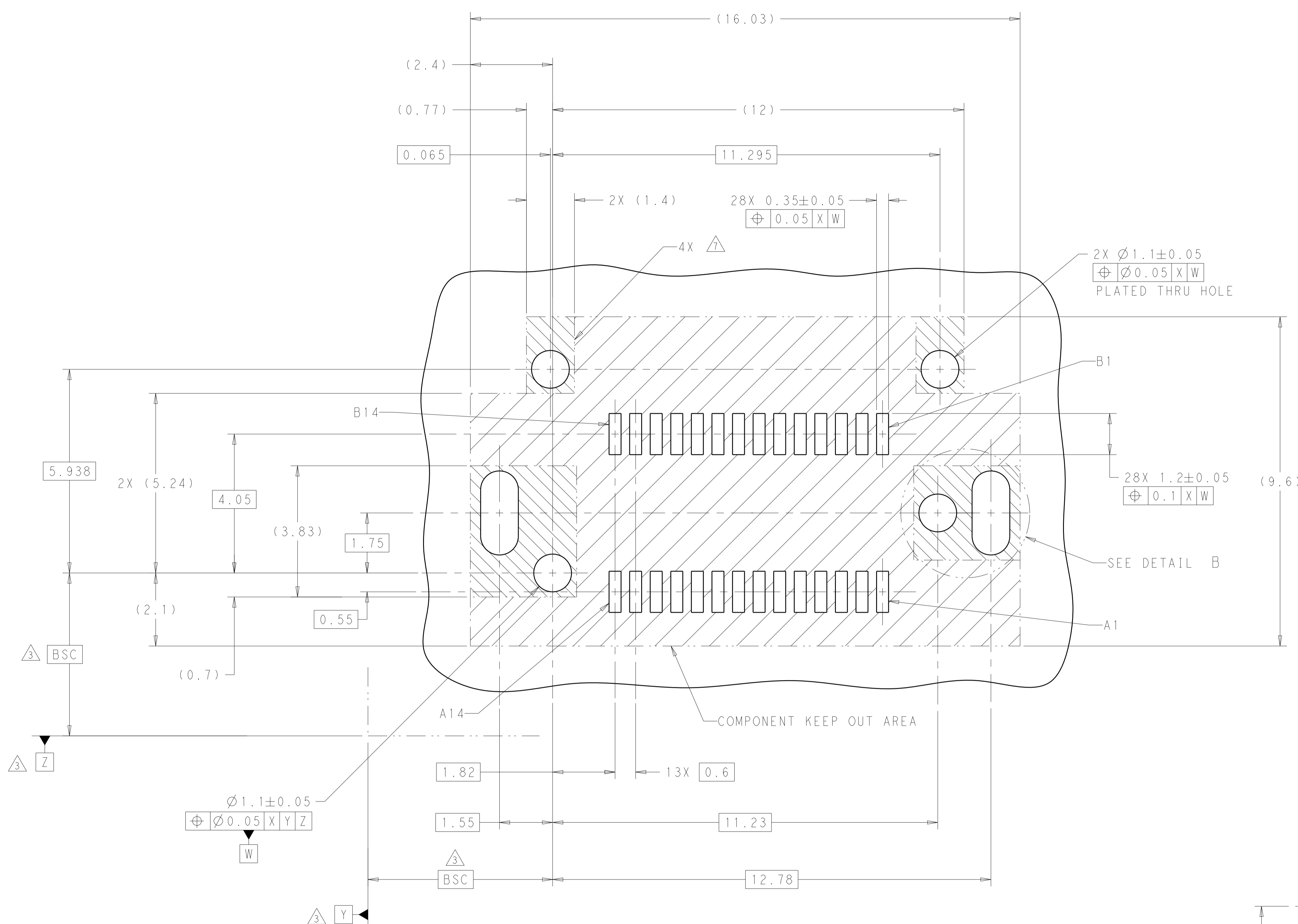

RECOMMENDED PCB LAYOUT AND KEEP OUT AREA
SCALE 15:1

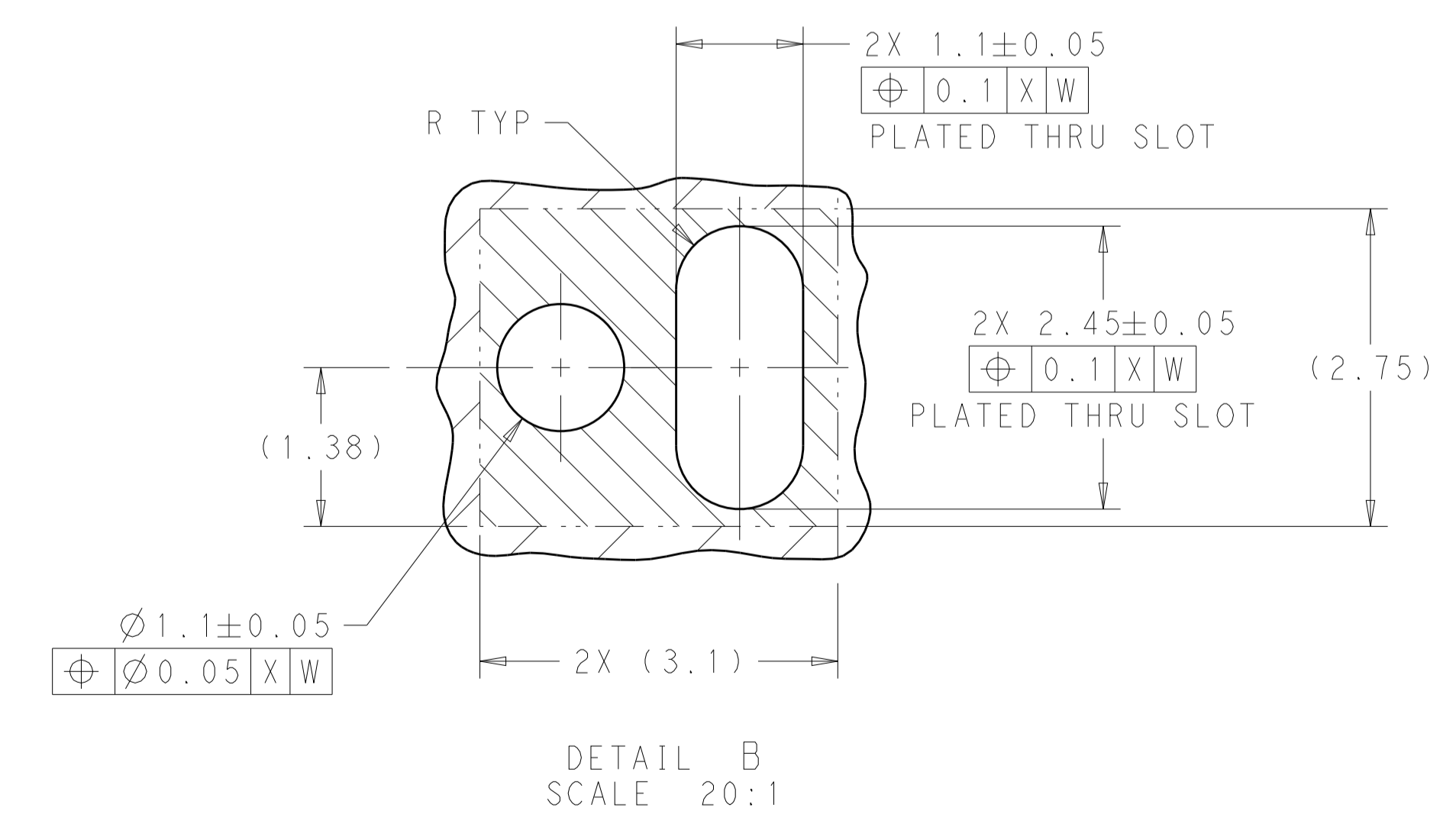

DETAIL B
SCALE 20:1

THIS DRAWING IS A CONTROLLED DOCUMENT.		OWN: M. SHIRK 08APR2019	 TE Connectivity
DIMENSIONS: mm		CHK: J. WESTMAN 08APR2019	
TOLERANCES UNLESS OTHERWISE SPECIFIED:		APPD: J. WESTMAN 08APR2019	NAME: RECEPTACLE ASSEMBLY, VERTICAL, 28 POSITION, SLIVER 2.0
0 PLC ±	1 PLC ±	PRODUCT SPEC	SIZE: 108-130021
2 PLC ±	3 PLC ±	APPLICATION SPEC	RESTRICTED TO: A1
4 PLC ±	ANGLES ±	114-130015	SCALE: 10:1
MATERIAL:	FINISH:	WEIGHT:	SHEET 2 OF 3
CUSTOMER DRAWING		100779	REV B

REVISIONS				
P.	LTN.	DESCRIPTION	DATE	OWN. APVD.
-	-	SEE SHEET 1	-	-

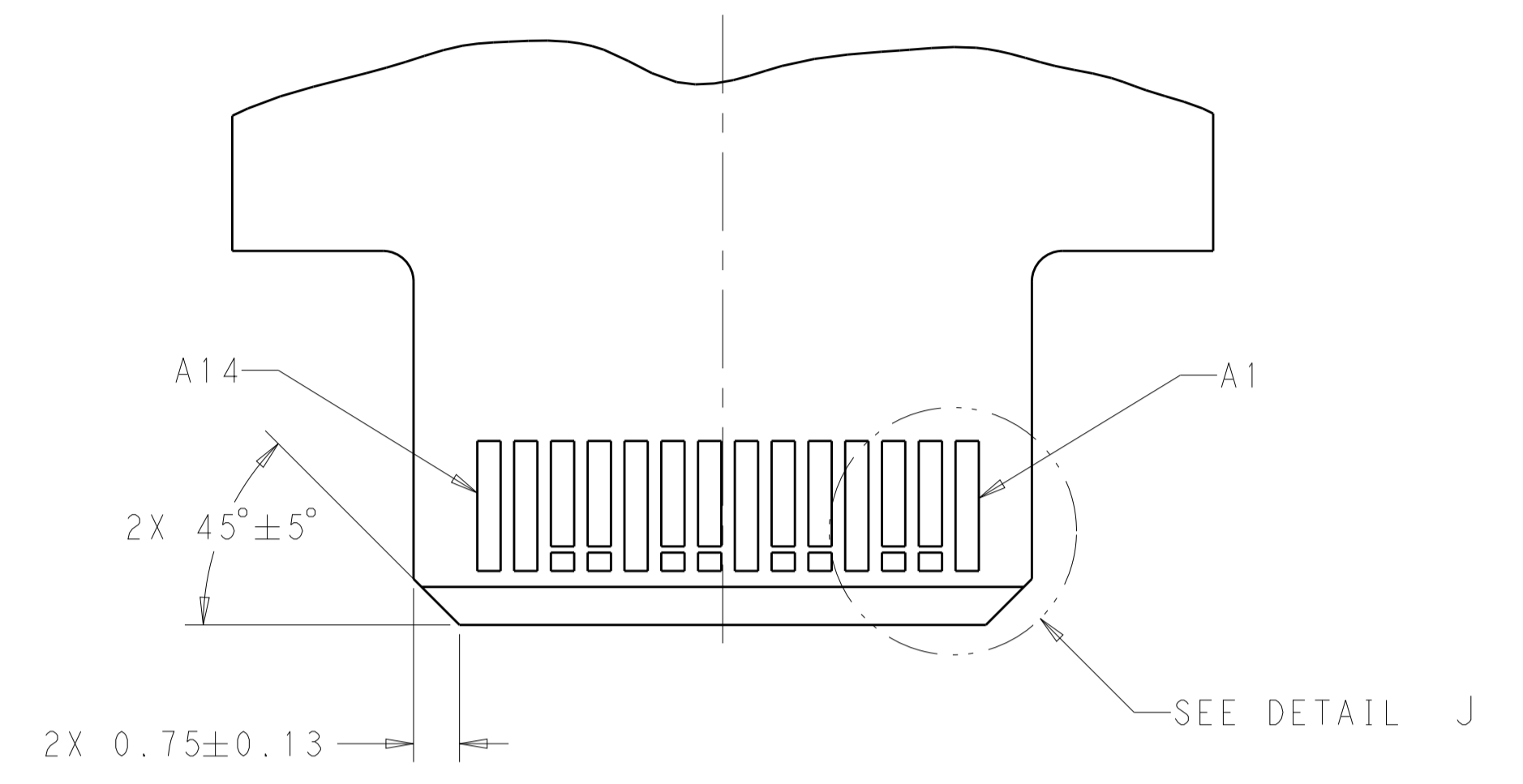
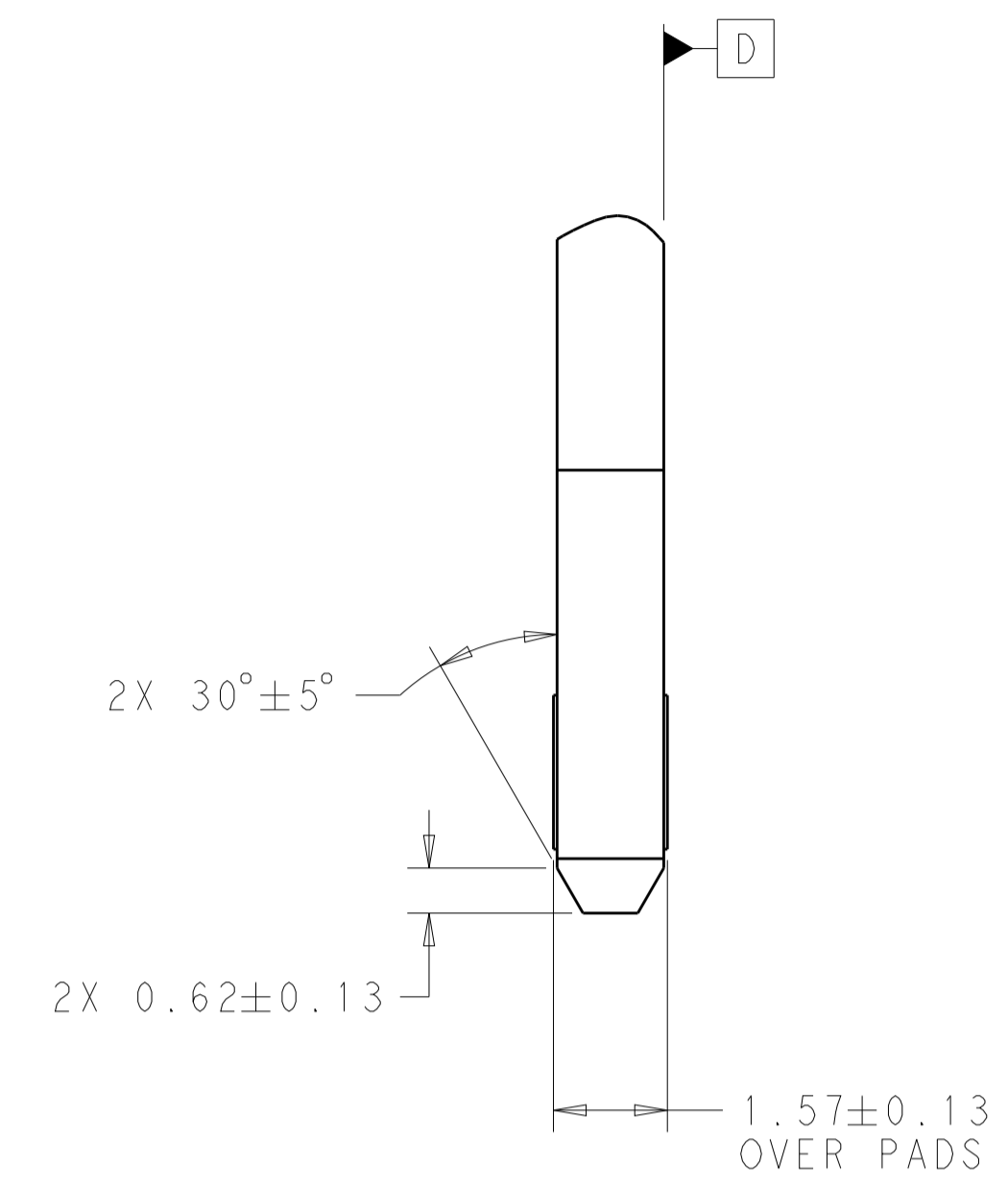
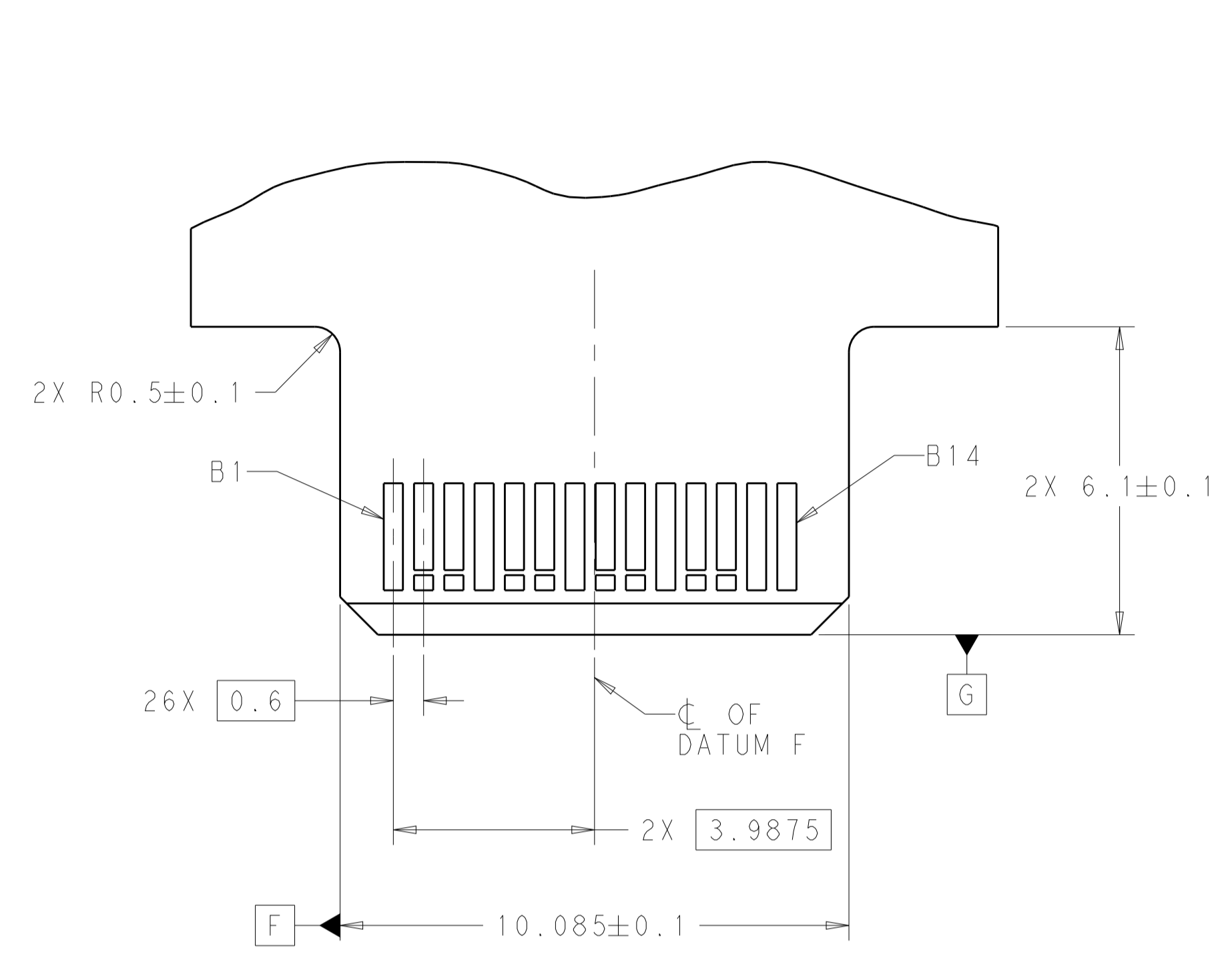

RECOMMENDED PCB OUTLINE DIMENSIONS.
 TOLERANCE VALUES ARE CRITICAL. PLEASE BE SURE TO DESIGNATE
 TOLERANCES TO PCB SUPPLIER TO ENSURE OPTIMIZED FUNCTIONALITY.

CONTACT NUMBER	SIDE A	SIDE B
1	GROUND	GROUND
2	SIGNAL	SIGNAL
3	SIGNAL	SIGNAL
4	GROUND	GROUND
5	SIGNAL	SIGNAL
6	SIGNAL	SIGNAL
7	GROUND	GROUND
8	SIGNAL	SIGNAL
9	SIGNAL	SIGNAL
10	GROUND	GROUND
11	SIGNAL	SIGNAL
12	SIGNAL	SIGNAL
13	GROUND	GROUND
14	GROUND	GROUND

CONNECTOR CONTACT IDENTIFICATION

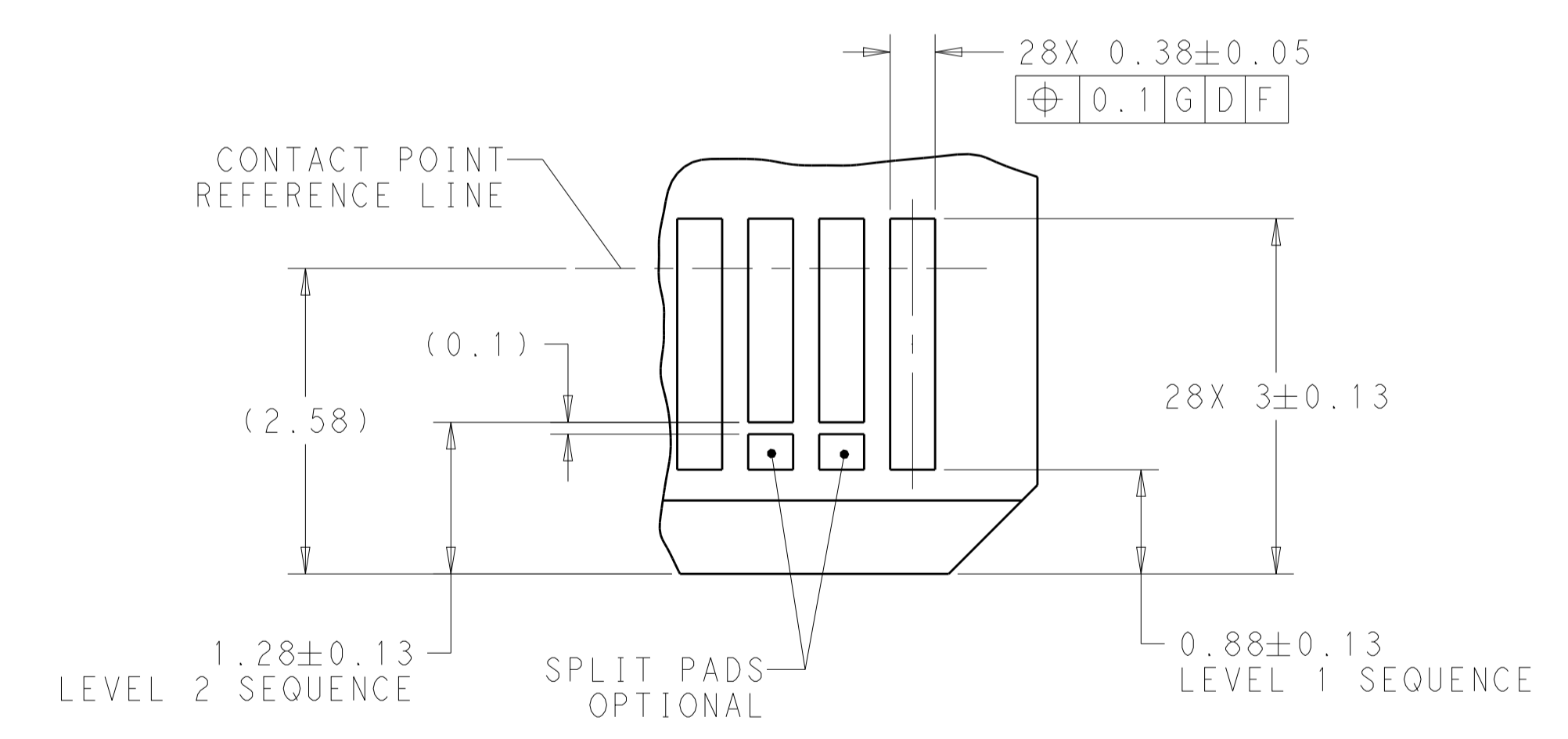

DETAIL J
 SCALE 20:1

THIS DRAWING IS A CONTROLLED DOCUMENT.		OWN: M. SHIRK 08APR2019	TE Connectivity
DIMENSIONS: mm		CHK: J. WESTMAN 08APR2019	
TOLERANCES UNLESS OTHERWISE SPECIFIED:		APVD: J. WESTMAN 08APR2019	NAME: RECEPTACLE ASSEMBLY, VERTICAL, 28 POSITION, SLIVER 2.0
0 PLC ±	1 PLC ±	PRODUCT SPEC: 108-130021	SIZE: A1
2 PLC ±	3 PLC ±	APPLICATION SPEC: 114-130015	CAGE CODE: 2354531
4 PLC ±	ANGLES ±	WEIGHT: -	RESTRICTED TO: -
MATERIAL: -	FINISH: -	CUSTOMER DRAWING	SCALE: 10:1 SHEET 3 OF 3 REV B