

## Product Details for 1058014 - 1

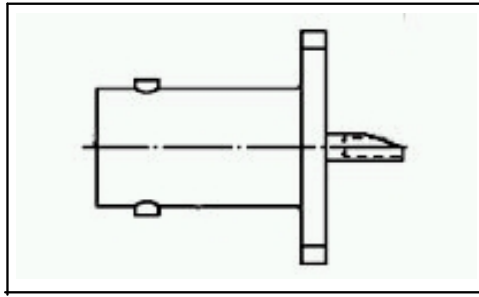

**1058014 - 1**

[Active](#)

### BNC RF Connectors

[RoHS Compliant \(Statement of Compliance\)](#)

#### Product Highlights:

- ? Connector
- ? Connector Type = BNC
- ? Jack
- ? Terminate To Wire
- ? Not Stacked

[View all Features](#)

### Quick Links

- [Check Pricing & Availability](#)
- [Search for Tooling](#)
- [Product Feature Selector](#)
- [Contact Us About This Product](#)

### Documentation & Additional Information

#### Product Drawings:

- ? [BNC FLANGE MOUNT JACK RECEPTACLE SOLDER POT TERMINAL](#) (PDF, English)

#### Catalog Pages/Data Sheets:

- ? None Available

#### Product Specifications:

- ? None Available

#### Application Specifications:

- ? None Available

#### Instruction Sheets:

- ? None Available

#### CAD Files:

- ? None Available

#### Additional Information:

- ? [Product Line Information](#)

#### Related Products:

- ? [Tooling](#)

[List all Documents](#)

### Product Features (Please use the Product Drawing for all design activity)

#### Product Type Features:

- ? [Product Type](#) = Connector
- ? [Connector Type](#) = BNC
- ? [Gender](#) = Jack
- ? [Stacked](#) = No
- ? [Number of Ports](#) = 1
- ? [Body Style](#) = Straight
- ? [Grade](#) = Commercial
- ? [Body Material](#) = Brass
- ? [Body Insulation](#) = Without
- ? [Sealed](#) = No
- ? [Isolated](#) = No
- ? [Dielectric Material](#) = TFE Fluorocarbon
- ? Solder Terminal = With

#### Mechanical Attachment:

- ? Surface Mountable = No
- ? [Panel Attachment](#) = With
- ? [Panel Attachment Method](#) = Flange
- ? Panel Attachment Style = Rear Mount

#### Electrical Characteristics:

- ? [Connector Impedance \(?\)](#) = 50
- ? Insulation Resistance (M?) = 10,000
- ? Frequency = DC to 4 GHz

#### Termination Related Features:

- ? [Coaxial Cable Termination Type](#) = Solder

#### Body Related Features:

- ? [Hardware Included](#) = No
- ? [Body Plating](#) = Nickel Over Copper
- ? [Polarized](#) = No

#### Contact Related Features:

- ? [Center Contact Material](#) = Beryllium Copper
- ? [Center Contact Plating](#) = Gold over Copper

#### Industry Standards:

- ? Government/Industry Qualification = No
- ? [RoHS/ELV Compliance](#) = RoHS compliant, ELV compliant
- ? [Lead Free Solder Processes](#) = Not relevant for lead free process
- ? RoHS/ELV Compliance History = Always was RoHS compliant

#### Conditions for Usage:

- ? [Terminate To](#) = Wire

#### Other:

- ? Brand = AMP