

1 2 3 4 5 6 7 8

TECHNICAL DATA

D-SUBMINIATURE CONNECTORS

SHELL : Steel
Finish : Tinned
BODY : Glass filled thermoplastic.
 Flame retardant to UL94 V-0
Color : Black
CONTACTS : Material for Copper Alloy
 Finish of contact mating area:
 Gold plating over Nickel
ELECTRICAL : Voltage rating 300 V Rms to 50 Hz
 150 V Rms to 50 Hz(Shielded contacts)
 Nominal current 7.5 A (Size 20)
 Withstanding Voltage >1000 V Rms to 50 Hz
 Contact resistance 50 mOhms max.
 Insulator resistance >5000 M Ohms
CLIMATIC : Temperature range -55 degree up to 155 degree
 Damp heat 56 days(40 degree-95% HR)
 Other climatic specification in accordance with
 NF C93-425 Sheet HE507
MACHANICAL : Insertion force per contact 1.2N <F<2.5N(Size 20)
 Extraction force per contact 0.4N MINI.(Size 20)
 Mating and unmating force size B 83N Max.8.0 N mini.
MARKING : Amphenol...(Series No.)
 Commercial reference
 Manufacturing date

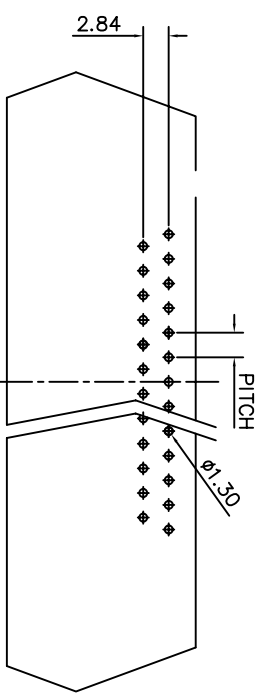
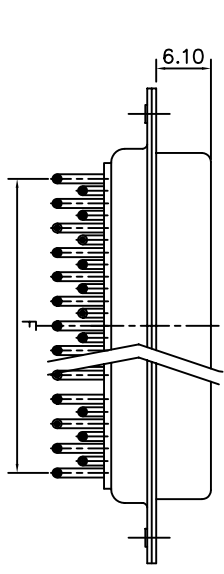
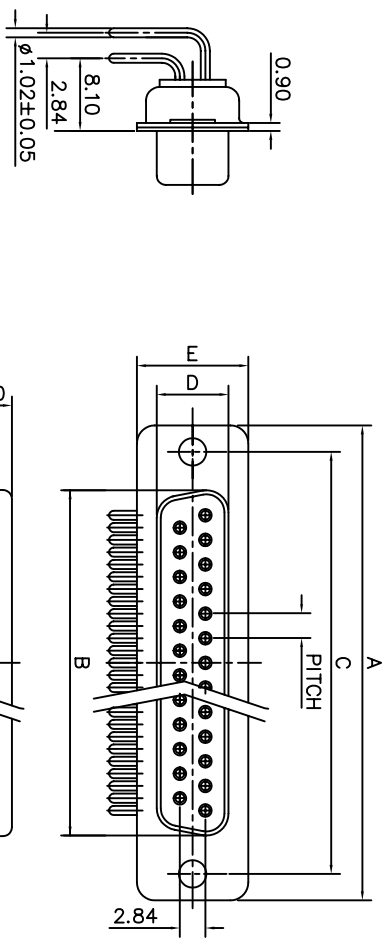

RECOMMENDED P.C.B LAYOUT



ONS/SHELL	A	B	C	D	E	PITCH	F	POS.
A	+0.25 -0.25	+0.00 -0.20	+0.10 -0.10	+0.00 -0.25	+0.20 -0.20			9
E	30.70	16.40	25.00	8.00	12.40	2.74	10.96	9
A	39.00	24.80	33.30	8.00	12.40	2.74	19.18	15
B	52.90	38.50	47.00	8.00	12.40	2.76	33.12	25
C	69.20	54.90	63.50	8.00	12.40	2.76	49.68	37

PRODUCT CODE

L77D A 15 S C

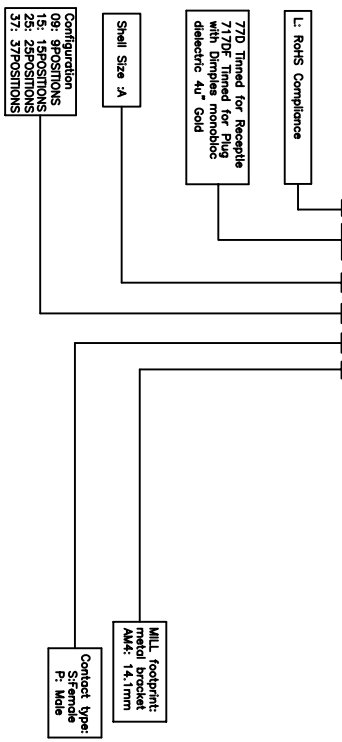

Amphenol Socapex

SERIES		TOL. GEN. : +/0.30	
NUMBER SERIES		VOLUME:	
D/DF		AREA:	
FILE:		PLATING:	
DESIGNATION		TREATMENT:	
D-SUB CONNECTOR		MATERIAL:	
DATE	2006.04.25	CUSTOMER	origin drawing
		MODIFICATIONS	Li.k 04/25/06
		DRAW	Li.k
		DATE	04/25/06
		APPROVE	Li.k
		IND	A
COMMERCIAL PART NUMBER		L77DAXXSC	