

This document is the property of Amphenol Corporation and is delivered on the express condition that it is not to be disclosed, reproduced or used, in whole or in part, for manufacture or sale by anyone other than Amphenol Corporation without its prior consent, & that no right is granted to disclose or to use any information in this document.

# Customer drawing

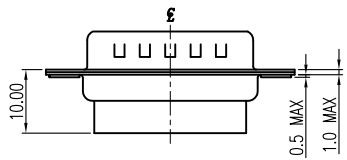

15~62 Position

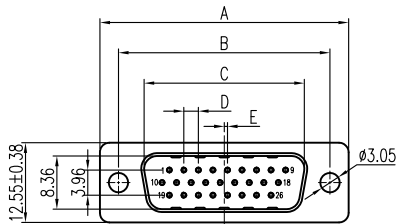
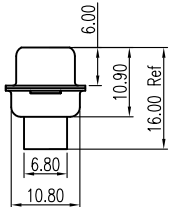

### Dimensions

Shell Size	Positions	A±0.38	B	C	D	E
E	15	30.81	24.99	16.92	2.29	0.25
A	26	39.19	33.32	25.25	2.29	0.51
B	44	53.04	47.04	38.96	2.29	0.51
C	62	69.32	63.50	55.42	2.41	0.58

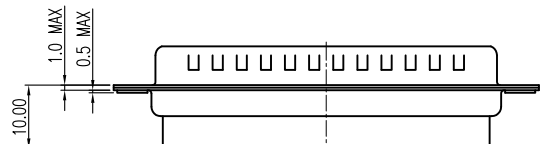
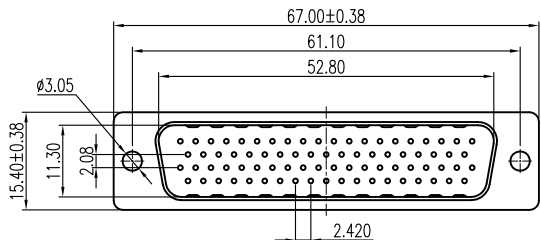

78 Position

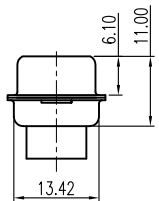

REVISIONS				
SYM	ECN	DESCRIPTION	DATE	APPROVED
1	HK--	First Release Drawing	03/25/14	IP
2	HK--	Update the Drawing	10/30/14	IP
3	HK--	Update Withstanding Voltage	08/09'22	Tony.Tang

## D-SUB TECHNICAL DATA

SHELL : SPCC, 100u" Tin over 50u" min nickel over 50u" min Copper

BODY: PBT, UL 94V-0, Color:Black.

SPRING WASHER: Stainless Steel

ELECTRICAL : Withstanding Voltage >500 V RMS  
Insulation resistance >1000 M Ohms

MARKING : Amphenol...(Series No.)  
Commercial reference  
Manufacturing date

### PRODUCT CODE

L 777 HR X XX P

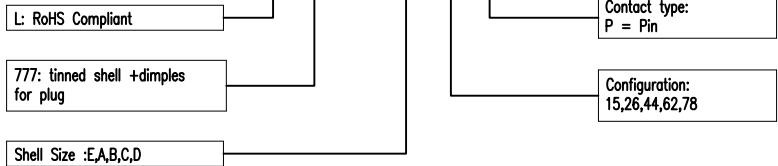

<b>UNLESS OTHERWISE SPECIFIED TOLERANCES</b> U.S. METRIC .X +/- 0.50 .XX +/- 0.30 .XXX +/- 0.20 FRACTIONS +/- ANGLES +/- 5° <b>FOR MATERIALS AND FINISHES SEE NOTES</b> REMOVE SHARP EDGES DIMENSIONS U.S. INCHES METRIC MM	<b>APPROVAL</b> DRAWN Bella.Wu CHECKED Tony.Tang CHECKED	<b>DATE</b> 08/09'22 08/09'22	<h1>Amphenol</h1>	
	<b>DRAWING FILE :</b>			<b>TITLE</b> D-sub crimping type,HR series
	<b>ANGLE OF PROJECTION</b> 			<b>SIZE</b> DRAWING NO. A4 L777HRXXXP
	<b>SCALE</b> NONE			<b>REV.</b> 3 <b>SHEET</b> 1 OF 1