

This document is the property of Amphenol Corporation and is delivered on the express condition that it is not to be disclosed, reproduced or used, in whole or in part, for manufacture or sale by anyone other than Amphenol Corporation without its prior consent, and that no right is granted to disclose or to use any information in this document.

The marking on this product doesn't contain environmental hazardous materials per Material Specification 55-00259 for Sony GP compliant or per directive 2011/65/EU for RoHS compliant.



ORIGINAL



REVISIONS				
SYM	ECN No.	DESCRIPTION	DATE	APPROVED
A	NE-17276	RELEASE TO PRODUCTION	10/20/2017	Roger Tsai

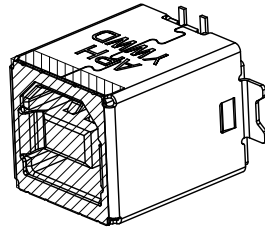
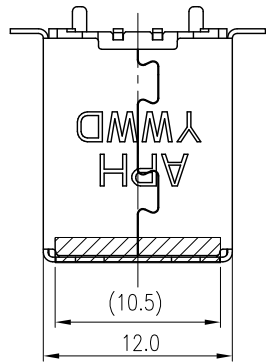

NOTES:

- MATERIAL:
 - HOUSING: HIGH TEMPERATURE THERMAL PLASTIC LCP , UL94V-0, COLOR: OPTIONS.
 - TERMINAL: COPPER ALLOY.
 - SHELL: COPPER ALLOY.
 - MYLAR: POLYIMIDE.
- FINISH:
 - TERMINAL:
 - CONTACT AREA: SELECTIVE GOLD PLATING ;
 - SOLDERING AREA: MATTE TIN PLATING 100 μ" THICKNESS MIN.;
 - UNDER PLATING: NICKEL PLATING 50 μ" THICKNESS MIN. OVERALL.
 - SHELL:
 - ELECTROLESS NICKEL PLATING 50 μ" THICKNESS MIN. OVERALL.
- THIS PRODUCT DOESN'T CONTAIN ENVIRONMENTAL HAZARDOUS PER DIRECTIVE 2011/65/EU FOR RoHS COMPLIANT.
- PRODUCT SPECIFICATION REFER TO : PS-7329.

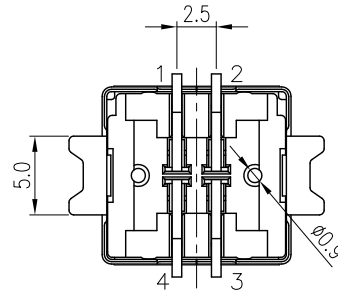
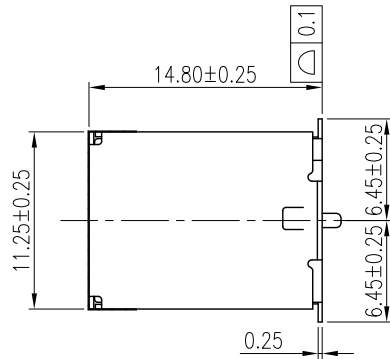
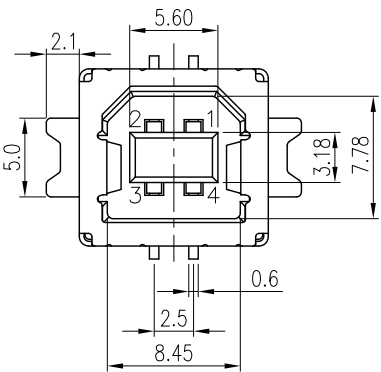

P/N: GSB2A1 X X H1EU

CONTACT FINISH
 1: FLASH GOLD
 2: 30u" GOLD

COLOR OF HOUSING ; PACKING :MYLAR

- 0: WHITE ;TRAY; W/MYLAR
- 1: BLACK ;TRAY; W/MYLAR
- 2: WHITE ;T&R; W/O MYLAR
- 3: BLACK ;T&R; W/O MYLAR

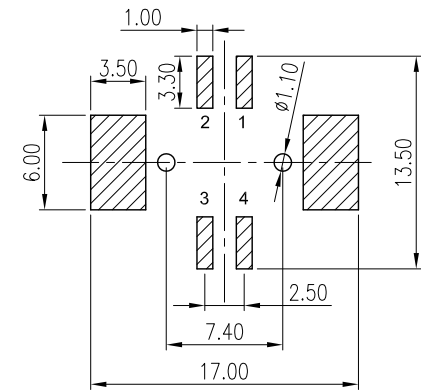

RECOMMENDED PCB LAYOUT
 TOP VIEW
 TOLERANCE: ±0.05mm
 PCB THICKNESS: 1.60±0.05mm

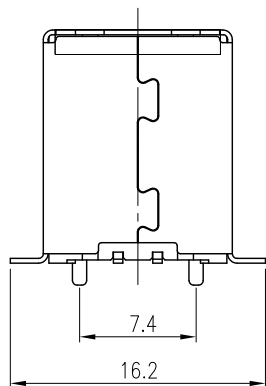

TOLERANCE	APPROVALS	DATE	TITLE		Amphenol®			
X.	DRAWN	10/20/2017	USB 2.0 B TYPE RECEPTACLE STRAIGHT W/ POST SMT TYPE (14.8H)		Amphenol Corporation Amphenol Taiwan Corporation			
X.X ±0.30	Debby Hung	10/20/2017						
X.XX ±0.20	CHECKED	10/20/2017						Sandy Wu
X.XXX ±0.10	APPROVED	10/20/2017						Roger Tsai
ANGULAR ±1°	DWG TYPE	PROJECT CODE	UNIT	SIZE	PART No.	GSB2A1XXH1EU		
UNLESS OTHERWISE SPECIFIED	CUST DWG	OTHER	mm	A3	GSB2A1XXH1EU	GSB2A1XXH1EU		
			SCALE	SHEET	DWG No.	REV.		
			NA	1 OF 3	GSB2A1XXH1EU	A		

This document is the property of Amphenol Corporation and is delivered on the express condition that is not to be disclosed, reproduced or used, in whole or in part, for manufacture or sale by anyone other than Amphenol Corporation without its prior consent, and that no right is granted to disclose or to use any information in this document.

The marking on this product doesn't contain environmental hazardous materials per Material Specification 55-00259 for Sony GP compliant or per directive 2011/65/EU for RoHS compliant.



ORIGINAL

REVISIONS				
SYM	ECN No.	DESCRIPTION	DATE	APPROVED
A	NE-17276	RELEASE TO PRODUCTION	10/20/2017	Roger Tsai



NOTES:

1. TRAY COLOR: TRANSPARENT
2. STAPLES SHOULD ONLY BE USED TO SET UP CARTON. ALL CARTON CLOSURES MUST BE DONE WITH TAPE.
3. FILL PACKAGING TRAYS WITH THE QUANTITIES AS INDICATED IN THE CHART.
4. SHIPPING CARTON DIMENSION: 520 X 273 X 310 MM.

60 PCS TRAY/CARTON

COVER

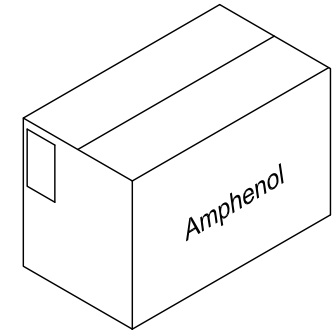
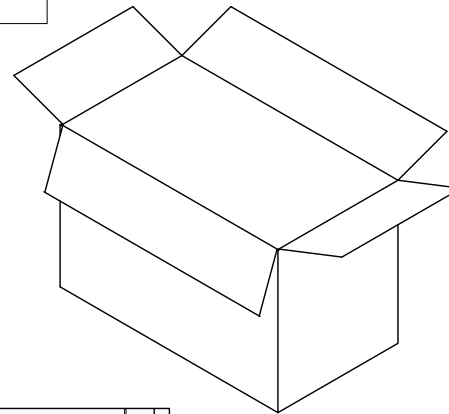
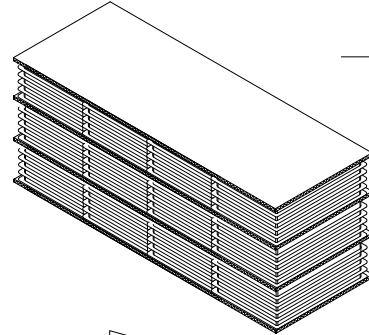
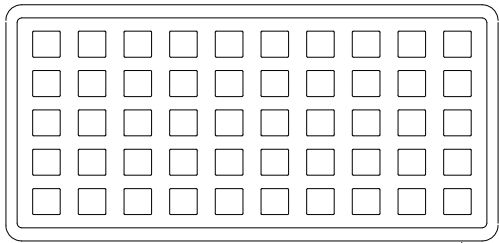

50 PCS/TARY

TRAY

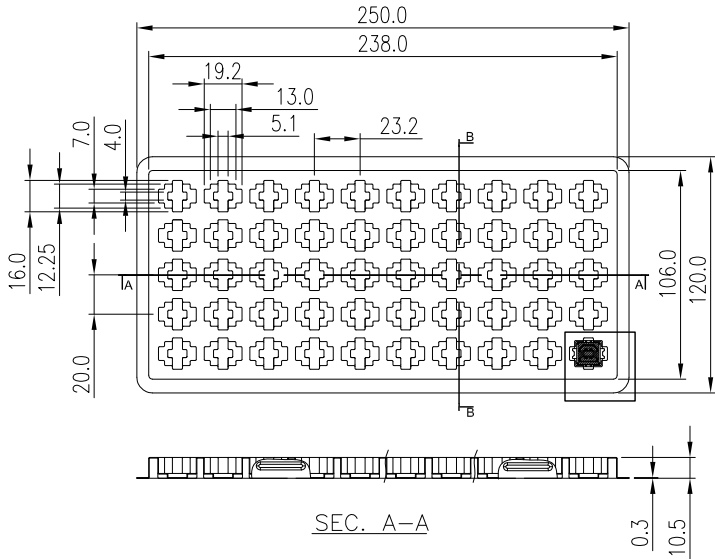

SEC. A-A

TRAY SIZE
250 X 120 X 18.5

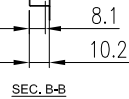

SEC. B-B

PACKAGING BY TRAY	14.1	10.2	50	60	3000	GSB2A1XXH1EU
G/W KG	N/W KG	PCS/ TRAY	TRAYS/ BOX	QUANTITY (PCS)	PART NUMBER	

TOLERANCE	APPROVALS	DATE	TITLE		Amphenol®	
X. ±0.30	DRAWN Debby Hung	10/20/2017	USB 2.0 B TYPE RECEPTACLE STRAIGHT W/ POST SMT TYPE (14.8H)		Amphenol Corporation Amphenol Taiwan Corporation	
X.X ±0.20	CHECKED Sandy Wu	10/20/2017				
X.XXX ±0.10	APPROVED Roger Tsai	10/20/2017				
ANGULAR ±1°	DWG TYPE CUST DWG	PROJECT CODE OTHER				
UNLESS OTHERWISE SPECIFIED			UNIT mm	SIZE A3	PART No. GSB2A1XXH1EU	
			SCALE NA	SHEET 2 OF 3	DWG No. GSB2A1XXH1EU	REV. A

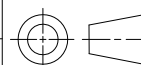

UNIT mm

SIZE A3

SCALE NA

SHEET 2 OF 3

PART No. GSB2A1XXH1EU

DWG No. GSB2A1XXH1EU

REV. A

This document is the property of Amphenol Corporation and is delivered on the express condition that is not to be disclosed, reproduced or used, in whole or in part, for manufacture or sale by anyone other than Amphenol Corporation without its prior consent, and that no right is granted to disclose or to use any information in this document.

The marking on this product doesn't contain environmental hazardous materials per Material Specification 55-00259 for Sony GP compliant or per directive 2011/65/EU for RoHS compliant.



ORIGINAL



REVISIONS				
SYM	ECN No.	DESCRIPTION	DATE	APPROVED
A	NE-17276	RELEASE TO PRODUCTION	10/20/2017	Roger Tsai

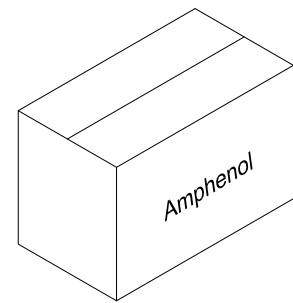
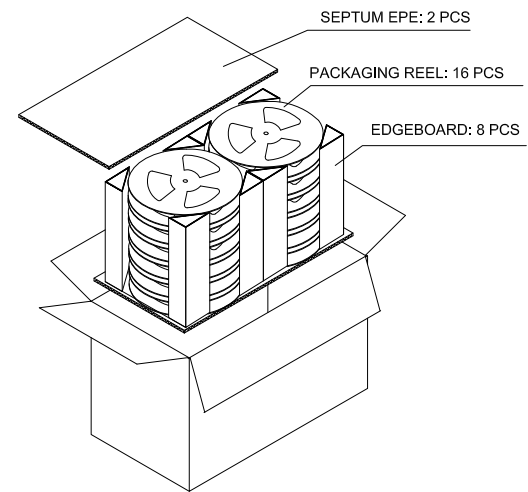
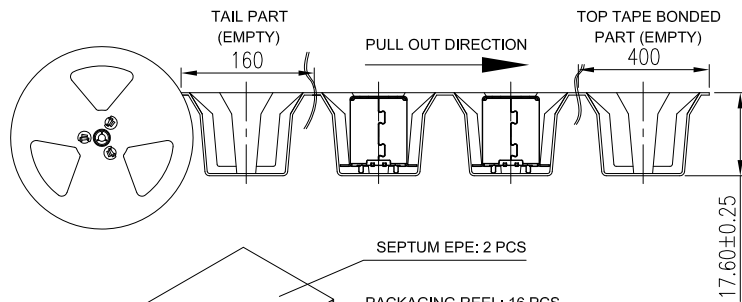
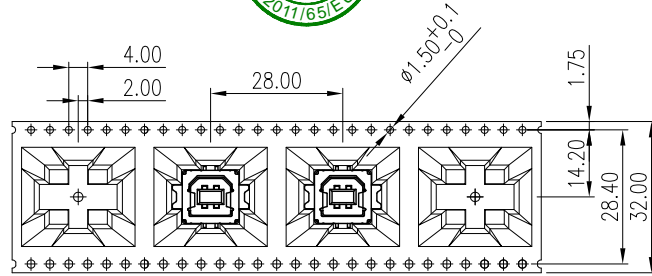

NOTES:

1. STAPLES SHOULD ONLY BE USED TO SET UP CARTON. ALL CARTON CLOSURES MUST BE DONE WITH TAPE.
2. FILL PACKAGING CARRIER TAPES W/ESD WITH THE QUANTITIES AS INDICATED IN THE CHART.
3. SHIPPING CARTON DIMENSION: 690 X 360 X 325mm.

PACKAGING BY T&R	13.9	5.7	100	16	1600	GSB2A1XXH1EU
	G/W KG	N/W KG	PCS/ REEL	REELS/ BOX	QUANTITY (PCS)	PART NUMBER

TOLERANCE	APPROVALS	DATE	TITLE		Amphenol [®] Amphenol Corporation Amphenol Taiwan Corporation	
X. ±0.30 X.X ±0.20 X.XX ±0.10 X.XXX ±0.10	DRAWN Debby Hung CHECKED Sandy Wu APPROVED Roger Tsai	10/20/2017 10/20/2017 10/20/2017	USB 2.0 B TYPE RECEPTACLE STRAIGHT W/ POST SMT TYPE (14.8H)			
ANGULAR ±1°	DWG TYPE CUST DWG	PROJECT CODE OTHER		UNIT mm SCALE NA	SIZE A3 SHEET 3 OF 3	PART No. GSB2A1XXH1EU DWG No. GSB2A1XXH1EU REV. A