

This document is the property of Amphenol Corporation and is delivered on the express condition that it is not to be disclosed, reproduced or used in whole or in part, for manufacture or sale by anyone other than Amphenol Corporation without its prior consent, and that no right is granted to disclose or to use any information in this document.

The marking on this product doesn't contain environmental hazardous materials per directive 2011/65/EU & 2015/863/EU for RoHS compliant and per IEC 61249-2-21 for Halogen-Free compliant.



ORIGINAL



REVISIONS				
SYM	ECN No.	DESCRIPTION	DATE	BY
A	NE-14096	RELEASE TO PRODUCTION	05/21/2014	Debby Hung
B	NE-15016	COMBINE DRAWING FOR PACKAGE AND TAIL OPTIONS.	02/02/2015	Debby Hung
C	NE-16117	ADDED METAL BOARDLOCK OPTION	05/13/2016	Aqua Chou
D	NE-21027	1.UPDATE PCB LAYOUT RECOMMENDED. 2.CHANGE THE DIRECTION OF THE PRODUCT AND ADDED DIMENSION FROM THE PACKAGING.	05/13/2021	Karen Su
E	NE-24066	ADD TRUE POSITION ON DRAWING	2024-03-01	Bruce Huang

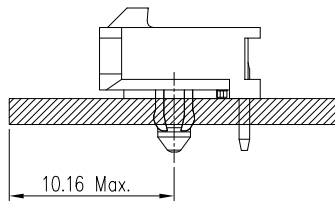
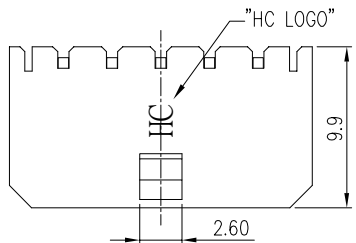

RECOMMENDED PCB LAYOUT EDGE

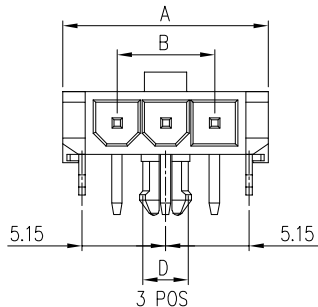
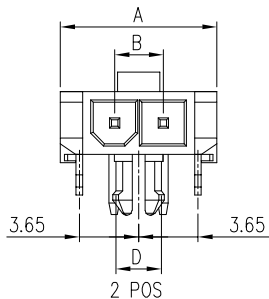
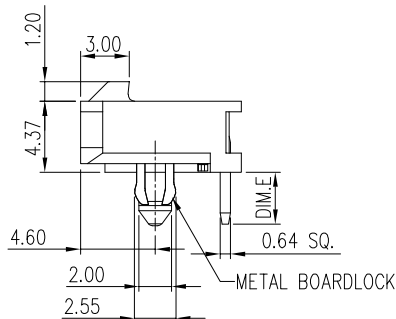
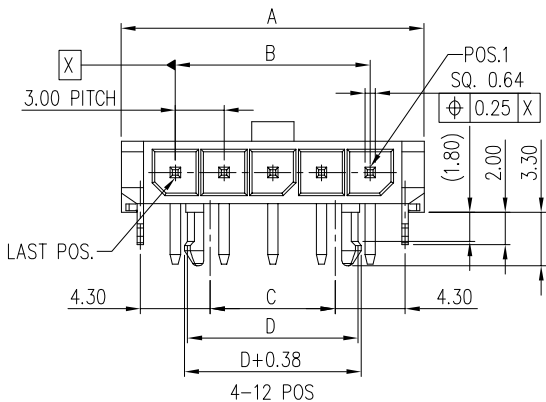

NOTES:

- MATERIAL:
HOUSING: HIGH TEMPERATURE THERMAL PLASTIC, LCP, UL94V-0, COLOR: BLACK.
TERMINAL: HIGH PERFORMANCE COPPER ALLOY.
METAL BOARDLOCK: COPPER ALLOY.
- FINISH:
TERMINAL:
CONTACT AREA: SELECTIVE PLATING OPTIONS, THICKNESS MIN.;
SOLDERING AREA: SELECTIVE PLATING OPTIONS, THICKNESS MIN.;
UNDER PLATING: NICKEL PLATING 50 μ" THICKNESS MIN. OVERALL.
METAL BOARDLOCK:
MATTE TIN PLATING 100 μ" THICKNESS MIN.;
UNDER PLATING: NICKEL PLATING 50 μ" THICKNESS MIN. OVERALL.
- THIS PRODUCT DOESN'T CONTAIN ENVIRONMENTAL HAZARDOUS PER DIRECTIVE 2011/65/EU & 2015/863/EU FOR RoHS COMPLIANT. AND PER IEC 61249-2-21 FOR HALOGEN-FREE COMPLIANT.
- PRODUCT SPECIFICATION REFER TO : PS-7528
- THE PRODUCT SUITABLE PIP PROCESS: PLEASE REFER LAYOUT (DRAWING 2 OF 5).
- TO ENSURE CURRENT RATING CAPABILITY, PLEASE ADOPT TOTAL SOLUTION. (G88MPH CABLE HOUSING SERIES WITH G88MPC CABLE TERMINAL SERIES)

PART NO. G88MPBXX0X2XXEU

- No. OF CIRCUIT ——— DIM.E /PACKING OPTIONS/METAL BOARDLOCK
- CONTACT&SOLDERING FINISH ———
- 0: 100u" MATTE TIN PLATING (OVERALL)
 - 1: GOLD FLASH (OVERALL)
 - 2: 15u" GOLD /100u" MATTE TIN
 - 3: 30u" GOLD /100u" MATTE TIN
- C1: 2.10mm/TRAY/ W/O METAL BOARDLOCK
 - C : 3.20mm/TRAY/ W/O METAL BOARDLOCK
 - C3: 2.10mm/TRAY/ W/ METAL BOARDLOCK
 - C4: 3.20mm/TRAY/ W/ METAL BOARDLOCK
 - 1R: 2.10mm/T&R/ W/O METAL BOARDLOCK
 - 2R: 3.20mm/T&R/ W/O METAL BOARDLOCK
 - 3R: 2.10mm/T&R/ W/ METAL BOARDLOCK
 - 4R: 3.20mm/T&R/ W/ METAL BOARDLOCK

7	24.65	18.00	13.70	16.50					
6	21.65	15.00	10.70	13.50	12	39.65	33.00	28.70	31.50
5	18.65	12.00	7.70	10.50	11	36.65	30.00	25.70	28.50
4	15.65	9.00	4.70	7.50	10	33.65	27.00	22.70	25.50
3	12.65	6.00	—	2.80	9	30.65	24.00	19.70	22.50
2	9.65	3.00	—	2.80	8	27.65	21.00	16.70	19.50
POS.	A	B	C	D	POS.	A	B	C	D

TOLERANCE	APPROVALS	DATE	TITLE		PART No.	
X.X ±0.30	DRAWN Bruce Huang	2024-03-01	G88MP SERIES MICRO POWER PLUS 3.0 PITCH S/R R/A DIP TYPE		Amphenol® Amphenol Corporation Amphenol Taiwan Corporation	
X.XX ±0.20						
X.XXX ±0.10	APPROVED Roger Tsai	2024-03-01	UNIT mm	SIZE A3	PART No. G88MPBXX0X2XXEU	
ANGULAR ±1°	DWG TYPE CUST DWG	PROJECT CODE PHD	SCALE NA	SHEET 1 OF 6	DWG No. G88MPBXX0X2XXEU	REV. E
UNLESS OTHERWISE SPECIFIED						

This document is the property of Amphenol Corporation and is delivered on the express condition that it is not to be disclosed, reproduced or used, in whole or in part, for manufacture or sale by anyone other than Amphenol Corporation without its prior consent, and that no right is granted to disclose or to use any information in this document.

The marking on this product doesn't contain environmental hazardous materials per directive 2011/65/EU & 2015/863/EU for RoHS compliant and per IEC 61249-2-21 for Halogen-Free compliant.



ORIGINAL



REVISIONS				
SYM	ECN No.	DESCRIPTION	DATE	BY
A	NE-14096	RELEASE TO PRODUCTION	05/21/2014	Debby Hung
B	NE-15016	COMBINE DRAWING FOR PACKAGE AND TAIL OPTIONS.	02/02/2015	Debby Hung
C	NE-16117	ADDED METAL BOARDLOCK OPTION	05/13/2016	Aqua Chou
D	NE-21027	1.UPDATE PCB LAYOUT RECOMMENDED. 2.CHANGE THE DIRECTION OF THE PRODUCT AND ADDED DIMENSION FROM THE PACKAGING.	05/13/2021	Karen Su
E	NE-24066	ADD TRUE POSITION ON DRAWING	2024-03-01	Bruce Huang

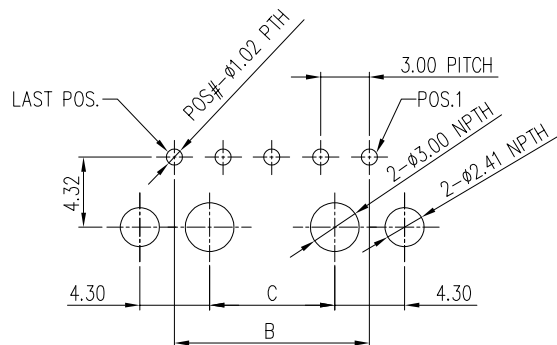

4-12POS
RECOMMENDED PCB LAYOUT (TOP VIEW)
(ALL TOLERANCES ARE ±0.05)
PCB BOARD THK 1.60mm

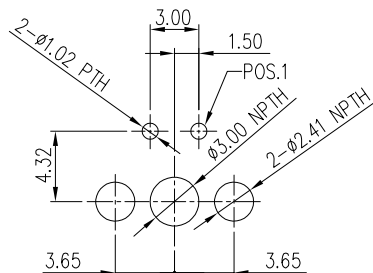

2POS
RECOMMENDED PCB LAYOUT (TOP VIEW)
(ALL TOLERANCES ARE ±0.05)
PCB BOARD THK 1.60mm

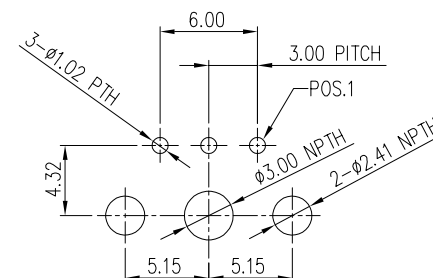

3POS
RECOMMENDED PCB LAYOUT (TOP VIEW)
(ALL TOLERANCES ARE ±0.05)
PCB BOARD THK 1.60mm

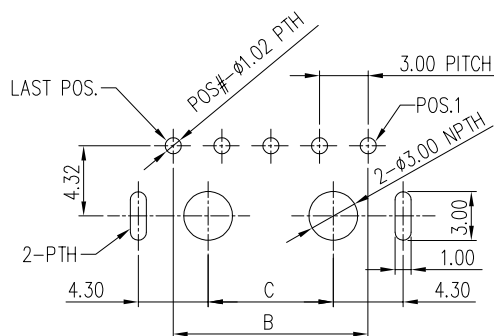

4-12POS
RECOMMENDED PCB LAYOUT (TOP VIEW)
(ALL TOLERANCES ARE ±0.05)
PCB BOARD THK 1.60mm
THE LAYOUT SUITABLE FOR PIP PROCESS

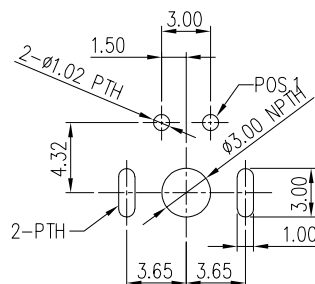

2POS
RECOMMENDED PCB LAYOUT (TOP VIEW)
(ALL TOLERANCES ARE ±0.05)
PCB BOARD THK 1.60mm
THE LAYOUT SUITABLE FOR PIP PROCESS

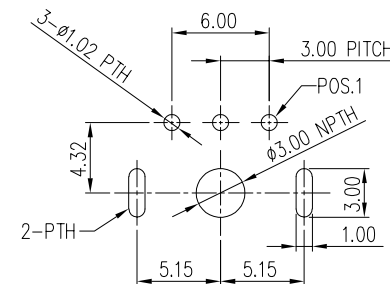

3POS
RECOMMENDED PCB LAYOUT (TOP VIEW)
(ALL TOLERANCES ARE ±0.05)
PCB BOARD THK 1.60mm
THE LAYOUT SUITABLE FOR PIP PROCESS

TOLERANCE	APPROVALS	DATE	TITLE		Amphenol®		
X. ±0.30	DRAWN Bruce Huang	2024-03-01	G88MP SERIES MICRO POWER PLUS 3.0 PITCH S/R R/A DIP TYPE		Amphenol Corporation Amphenol Taiwan Corporation		
X.X ±0.20	CHECKED Joseph Jiang	2024-03-01					
X.XXX ±0.10	APPROVED Roger Tsai	2024-03-01					
ANGULAR ±1°	DWG TYPE CUST DWG	PROJECT CODE PHD		UNIT mm	SIZE A3	PART No. G88MPBXX0X2XXEU	
UNLESS OTHERWISE SPECIFIED				SCALE NA	SHEET 2 OF 6	DWG No. G88MPBXX0X2XXEU	REV. E

This document is the property of Amphenol Corporation and is delivered on the express condition that it is not to be disclosed, reproduced or used, in whole or in part, for manufacture or sale by anyone other than Amphenol Corporation without its prior consent, and that no right is granted to disclose or to use any information in this document.

The marking on this product doesn't contain environmental hazardous materials per directive 2011/65/EU & 2015/863/EU for RoHS compliant and per IEC 61249-2-21 for Halogen-Free compliant.



ORIGINAL



REVISIONS				
SYM	ECN No.	DESCRIPTION	DATE	BY
A	NE-14096	RELEASE TO PRODUCTION	05/21/2014	Debby Hung
B	NE-15016	COMBINE DRAWING FOR PACKAGE AND TAIL OPTIONS.	02/02/2015	Debby Hung
C	NE-16117	ADDED METAL BOARDLOCK OPTION	05/13/2016	Aqua Chou
D	NE-21027	1.UPDATE PCB LAYOUT RECOMMENDED. 2.CHANGE THE DIRECTION OF THE PRODUCT AND ADDED DIMENSION FROM THE PACKAGING.	05/13/2021	Karen Su
E	NE-24066	ADD TRUE POSITION ON DRAWING	2024-03-01	Bruce Huang

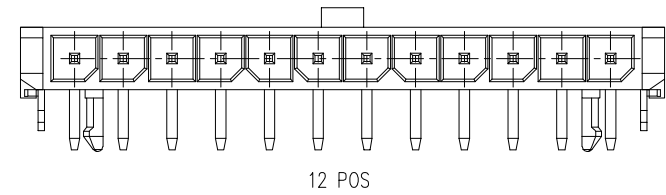
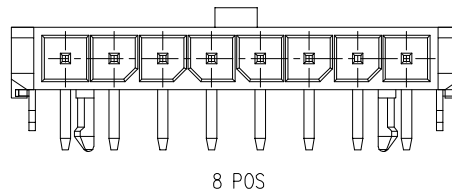
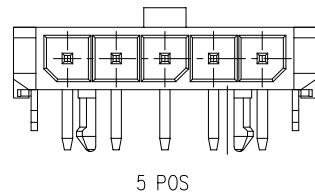
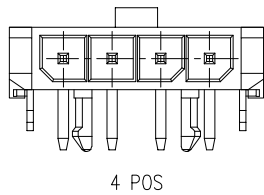
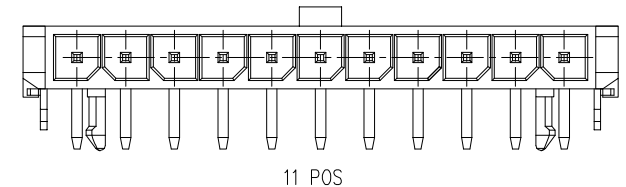
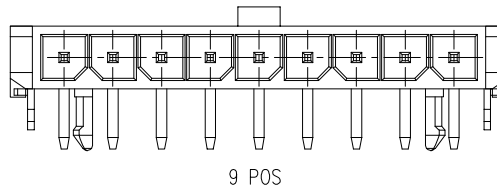
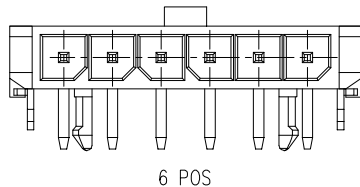
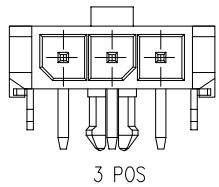
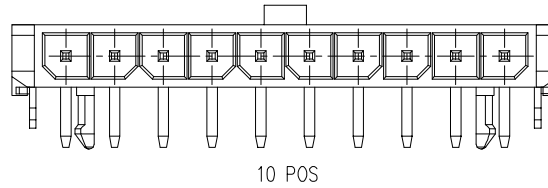
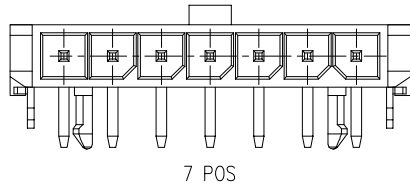
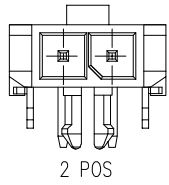

KEY DISPLAY DESCRIPTION

TOLERANCE X. ±0.30 X.X ±0.20 X.XX ±0.10 X.XXX ±0.10 ANGULAR ±1° UNLESS OTHERWISE SPECIFIED	APPROVALS DRAWN Bruce Huang CHECKED Joseph Jiang APPROVED Roger Tsai	DATE 2024-03-01 2024-03-01 2024-03-01	TITLE G88MP SERIES MICRO POWER PLUS 3.0 PITCH S/R R/A DIP TYPE		Amphenol® Amphenol Corporation Amphenol Taiwan Corporation	
	DWG TYPE CUST DWG	PROJECT CODE PHD		UNIT mm SCALE NA	SIZE A3 SHEET 3 OF 6	PART No. G88MPBXX0X2XXEU DWG No. G88MPBXX0X2XXEU REV. E

This document is the property of Amphenol Corporation and is delivered on the express condition that it is not to be disclosed, reproduced or used, in whole or in part, for manufacture or sale by anyone other than Amphenol Corporation without its prior consent, and that no right is granted to disclose or to use any information in this document.

The marking on this product doesn't contain environmental hazardous materials per directive 2011/65/EU & 2015/863/EU for RoHS compliant and per IEC 61249-2-21 for Halogen-Free compliant.



ORIGINAL



REVISIONS				
SYM	ECN No.	DESCRIPTION	DATE	BY
A	NE-14096	RELEASE TO PRODUCTION	05/21/2014	Debby Hung
B	NE-15016	COMBINE DRAWING FOR PACKAGE AND TAIL OPTIONS.	02/02/2015	Debby Hung
C	NE-16117	ADDED METAL BOARDLOCK OPTION	05/13/2016	Aqua Chou
D	NE-21027	1.UPDATE PCB LAYOUT RECOMMENDED. 2.CHANGE THE DIRECTION OF THE PRODUCT AND ADDED DIMENSION FROM THE PACKAGING.	05/13/2021	Karen Su
E	NE-24066	ADD TRUE POSITION ON DRAWING	2024-03-01	Bruce Huang

POS.	BOARD-MOUNT P/N	CABLE HOUSING P/N	CABLE TERMINAL P/N	AWG NO.	PLATING OPTIONS
02	G88MPB020X2XXEU	G88MPH0221CEU	G88MPCX232CEU	AWG#16~18	0: TIN 100u" ; 1: FLASH GOLD
			G88MPCX332CEU	AWG#20~30	2: 15u" GOLD ; 3: 30u" GOLD
03	G88MPB030X2XXEU	G88MPH0321CEU	G88MPCX232CEU	AWG#16~18	0: TIN 100u" ; 1: FLASH GOLD
			G88MPCX332CEU	AWG#20~30	2: 15u" GOLD ; 3: 30u" GOLD
04	G88MPB040X2XXEU	G88MPH0421CEU	G88MPCX232CEU	AWG#16~18	0: TIN 100u" ; 1: FLASH GOLD
			G88MPCX332CEU	AWG#20~30	2: 15u" GOLD ; 3: 30u" GOLD
05	G88MPB050X2XXEU	G88MPH0521CEU	G88MPCX232CEU	AWG#16~18	0: TIN 100u" ; 1: FLASH GOLD
			G88MPCX332CEU	AWG#20~30	2: 15u" GOLD ; 3: 30u" GOLD
06	G88MPB060X2XXEU	G88MPH0621CEU	G88MPCX232CEU	AWG#16~18	0: TIN 100u" ; 1: FLASH GOLD
			G88MPCX332CEU	AWG#20~30	2: 15u" GOLD ; 3: 30u" GOLD
07	G88MPB070X2XXEU	G88MPH0721EU	G88MPCX232CEU	AWG#16~18	0: TIN 100u" ; 1: FLASH GOLD
			G88MPCX332CEU	AWG#20~30	2: 15u" GOLD ; 3: 30u" GOLD
08	G88MPB080X2XXEU	G88MPH0821CEU	G88MPCX232CEU	AWG#16~18	0: TIN 100u" ; 1: FLASH GOLD
			G88MPCX332CEU	AWG#20~30	2: 15u" GOLD ; 3: 30u" GOLD
09	G88MPB090X2XXEU	G88MPH0921CEU	G88MPCX232CEU	AWG#16~18	0: TIN 100u" ; 1: FLASH GOLD
			G88MPCX332CEU	AWG#20~30	2: 15u" GOLD ; 3: 30u" GOLD
10	G88MPB100X2XXEU	G88MPH1021CEU	G88MPCX232CEU	AWG#16~18	0: TIN 100u" ; 1: FLASH GOLD
			G88MPCX332CEU	AWG#20~30	2: 15u" GOLD ; 3: 30u" GOLD
11	G88MPB110X2XXEU	G88MPH1121CEU	G88MPCX232CEU	AWG#16~18	0: TIN 100u" ; 1: FLASH GOLD
			G88MPCX332CEU	AWG#20~30	2: 15u" GOLD ; 3: 30u" GOLD
12	G88MPB120X2XXEU	G88MPH1221CEU	G88MPCX232CEU	AWG#16~18	0: TIN 100u" ; 1: FLASH GOLD
			G88MPCX332CEU	AWG#20~30	2: 15u" GOLD ; 3: 30u" GOLD

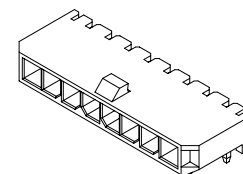

AMPHENOL BOARD-MOUNT

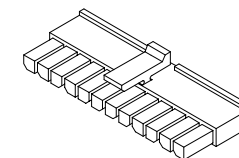

AMPHENOL CABLE HOUSING

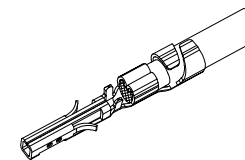

AMPHENOL CABLE TERMINAL

NOTE:
TO ENSURE CURRENT RATING CAPABILITY,
PLEASE ADOPT TOTAL SOLUTION.
(G88MPH CABLE HOUSING SERIES WITH
G88MPC CABLE TERMINAL SERIES)

TOLERANCE		APPROVALS		DATE	TITLE		Amphenol®						
X		DRAWN	Bruce Huang	2024-03-01	G88MP SERIES MICRO POWER PLUS 3.0 PITCH S/R R/A DIP TYPE		Amphenol Corporation Amphenol Taiwan Corporation						
X.X	±0.30	CHECKED	Joseph Jiang	2024-03-01									
X.XX	±0.20	APPROVED	Roger Tsai	2024-03-01									
X.XXX	±0.10	UNLESS OTHERWISE SPECIFIED	CUST DWG	PROJECT CODE PHD			UNIT	mm	SIZE	A3	PART No.	G88MPBXX0X2XXEU	
							SCALE	NA	SHEET	4 OF 6	DWG No.	G88MPBXX0X2XXEU	
											REV.	E	

This document is the property of Amphenol Corporation and is delivered on the express condition that it not to be disclosed, reproduced or used, in whole or in part, for manufacture or sale by anyone other than Amphenol Corporation without its prior consent, and that no right is granted to disclose or to use any information in this document.

The marking on this product doesn't contain environmental hazardous materials per directive 2011/65/EU & 2015/863/EU for RoHS compliant and per IEC 61249-2-21 for Halogen-Free compliant.



ORIGINAL



REVISIONS				
SYM	ECN No.	DESCRIPTION	DATE	BY
A	NE-14096	RELEASE TO PRODUCTION	05/21/2014	Debby Hung
B	NE-15016	COMBINE DRAWING FOR PACKAGE AND TAIL OPTIONS.	02/02/2015	Debby Hung
C	NE-16117	ADDED METAL BOARDLOCK OPTION	05/13/2016	Aqua Chou
D	NE-21027	1.UPDATE PCB LAYOUT RECOMMENDED. 2.CHANGE THE DIRECTION OF THE PRODUCT AND ADDED DIMENSION FROM THE PACKAGING.	05/13/2021	Karen Su
E	NE-24066	ADD TRUE POSITION ON DRAWING	2024-03-01	Bruce Huang

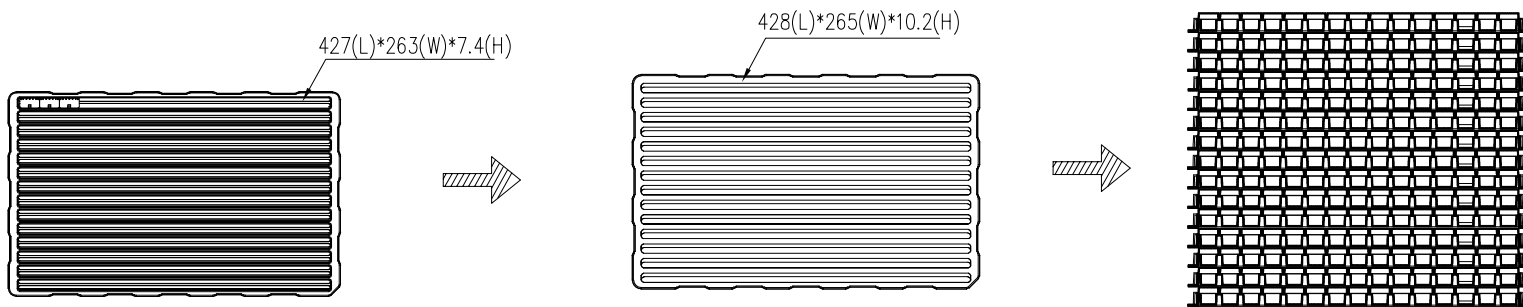

TRAY BOTTOM COVER

TRAY TOP COVER

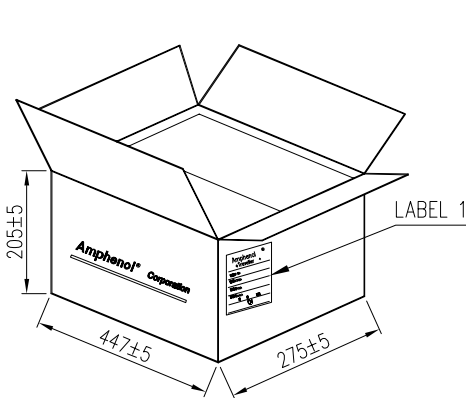

(15 INSIDE CARTON)

POS	PCS/TRAY	PCS/CARTON
02	574	8610
03	434	6510
04	350	5250
05	294	4410
06	252	3780
07	224	3360
08	196	2940
09	182	2730
10	154	2310
11	140	2100
12	140	2100

TOLERANCE	APPROVALS	DATE	TITLE		Amphenol®			
X. ±0.30	DRAWN Bruce Huang	2024-03-01	G88MP SERIES MICRO POWER PLUS 3.0 PITCH S/R R/A DIP TYPE		Amphenol Corporation Amphenol Taiwan Corporation			
X.XX ±0.20	CHECKED Joseph Jiang	2024-03-01						
X.XXX ±0.10	APPROVED Roger Tsai	2024-03-01						
ANGULAR ±1°	DWG TYPE CUST DWG	PROJECT CODE PHD	UNIT mm	SIZE A3	PART No. G88MPBXX0X2XXEU			
UNLESS OTHERWISE SPECIFIED			SCALE NA	SHEET 5 OF 6	DWG No. G88MPBXX0X2XXEU REV. E			

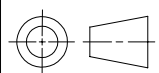

This document is the property of Amphenol Corporation and is delivered on the express condition that it is not to be disclosed, reproduced or used, in whole or in part, for manufacture or sale by anyone other than Amphenol Corporation without its prior consent, and that no right is granted to disclose or to use any information in this document.

The marking on this product doesn't contain environmental hazardous materials per directive 2011/65/EU & 2015/863/EU for RoHS compliant and per IEC 61249-2-21 for Halogen-Free compliant.



ORIGINAL



REVISIONS				
SYM	ECN No.	DESCRIPTION	DATE	BY
A	NE-14096	RELEASE TO PRODUCTION	05/21/2014	Debby Hung
B	NE-15016	COMBINE DRAWING FOR PACKAGE AND TAIL OPTIONS.	02/02/2015	Debby Hung
C	NE-16117	ADDED METAL BOARDLOCK OPTION	05/13/2016	Aqua Chou
D	NE-21027	1.UPDATE PCB LAYOUT RECOMMENDED. 2.CHANGE THE DIRECTION OF THE PRODUCT AND ADDED DIMENSION FROM THE PACKAGING.	05/13/2021	Karen Su
E	NE-24066	ADD TRUE POSITION ON DRAWING	2024-03-01	Bruce Huang

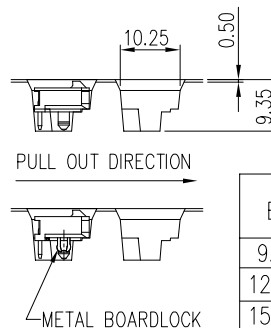
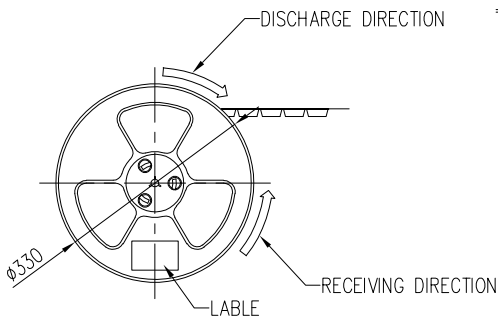
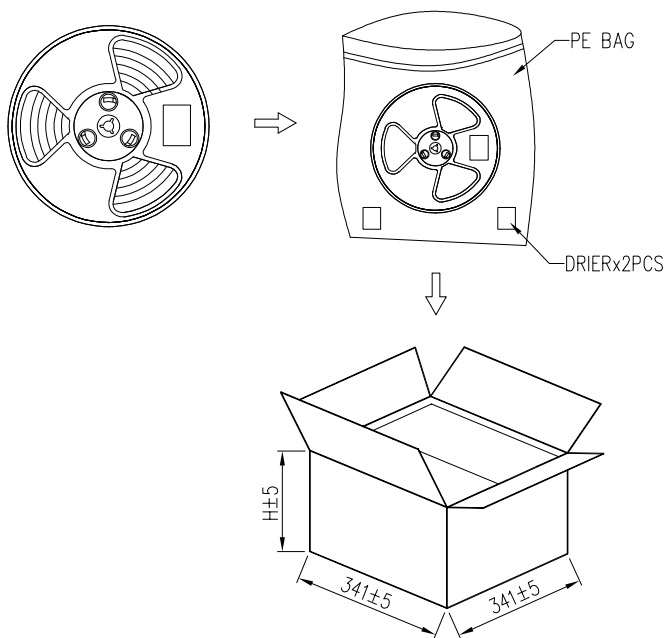
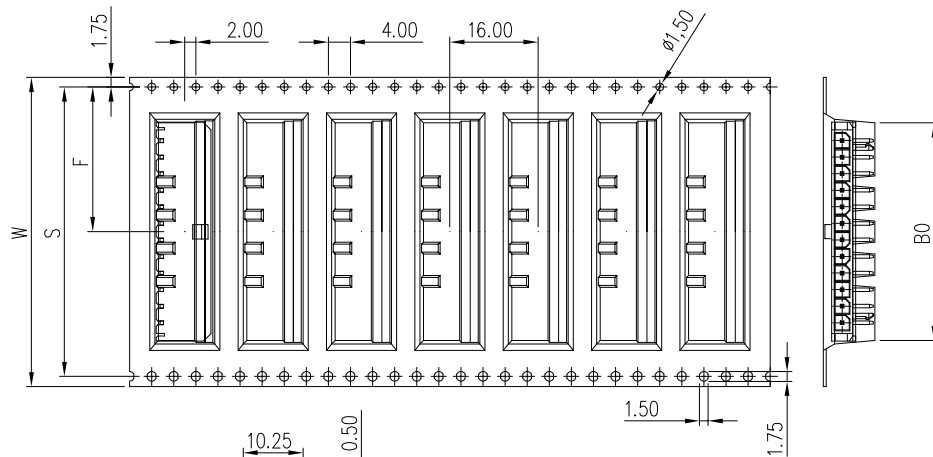
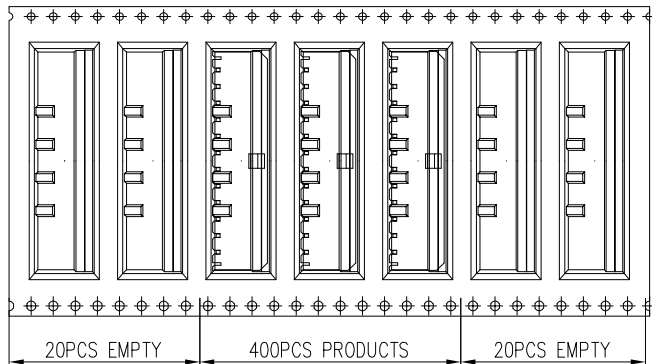

B0	S	F	PCS REEL	REELS CARTON	QUANTITY (PCS)	W	H	POS.
9.44		11.5	400	6	2400	24.0	233	2
12.44			400	5	2000	32.0		3
15.44	28.4	14.2	400	5	2000			4
18.44			400	5	2000			5
21.44			400	4	1600		44.0	233
24.44	40.4	20.2	400	4	1600	7		
27.44			400	4	1600	8		
30.44			400	3	1200	9		
33.44			400	3	1200	56.0		10
36.44	52.4	26.2	400	3	1200			11
39.44			400	3	1200			12

TOLERANCE	APPROVALS	DATE	TITLE		Amphenol®			
X. ±0.30	DRAWN Bruce Huang	2024-03-01	G88MP SERIES MICRO POWER PLUS 3.0 PITCH S/R R/A DIP TYPE		Amphenol Corporation Amphenol Taiwan Corporation			
X.X ±0.20	CHECKED Joseph Jiang	2024-03-01						
X.XXX ±0.10	APPROVED Roger Tsai	2024-03-01	UNLESS OTHERWISE SPECIFIED		UNIT mm	SIZE A3	PART No. G88MPBXX0X2XXEU	
ANGULAR ±1°	DWG TYPE CUST DWG	PROJECT CODE PHD			SCALE NA	SHEET 6 OF 6	DWG No. G88MPBXX0X2XXEU	REV. E

