

This document is the property of Amphenol Corporation and is delivered on the express condition that it is not to be disclosed, reproduced or used, in whole or in part, for manufacture or sale by anyone other than Amphenol Corporation without its prior consent, and that no right is granted to disclose or to use any information in this document.

The marking on this product doesn't contain environmental hazardous materials per Material Specification SS-00259 for Sony GP compliant or per directive 2011/65/EU for RoHS compliant.



ORIGINAL



REVISIONS				
SYM	ECN No.	DESCRIPTION	DATE	APPROVED
A	NE-17266	RELEASE REVISION	01/15/2018	Roger Tsai

NOTES:

1. MATERIAL:
HOUSING: HIGH TEMPERATURE THERMAL PLASTIC, NYLON 66, UL94V-0, COLOR: OPTION.
2. THIS PRODUCT DOESN'T CONTAIN ENVIRONMENTAL HAZARDOUS PER DIRECTIVE 2011/65/EU FOR RoHS COMPLIANT.
3. PRODUCT SPECIFICATION REFER TO : PS-76XX.
4. MATES WITH: G823XX1XYBEU.
5. TERMINAL USE: G862ACX14XT4EU.

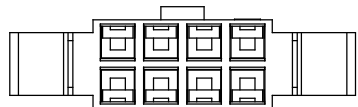
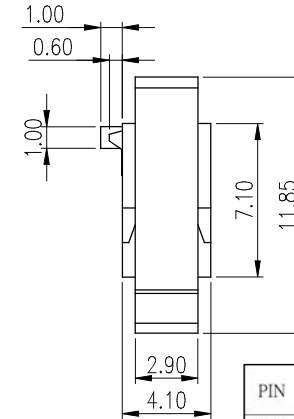
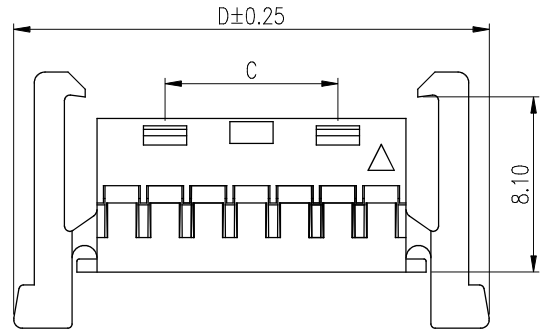
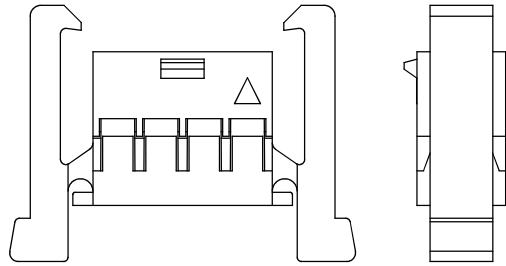
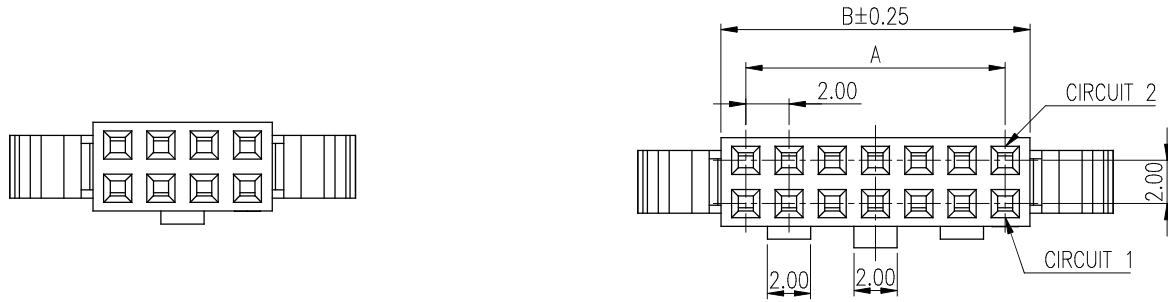

2X2~2X6P

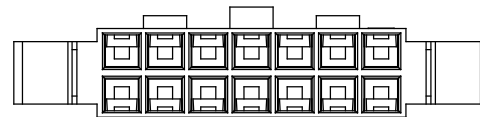

2X7~2X25P

PIN	DIM. (mm)				PIN	DIM. (mm)			
	A	B	C	D		A	B	C	D
2x02	2.00	4.30	/	12.00	2x14	26.00	28.30	22.00	36.00
2x03	4.00	6.30		14.00	2x15	28.00	30.30	24.00	38.00
2x04	6.00	8.30		16.00	2x16	30.00	32.30	26.00	40.00
2x05	8.00	10.30		18.00	2x17	32.00	34.30	28.00	42.00
2x06	10.00	12.30		20.00	2x18	34.00	36.30	30.00	44.00
2x07	12.00	14.30		8.00	2x19	36.00	38.30	32.00	46.00
2x08	14.00	16.30		10.00	2x20	38.00	40.30	34.00	48.00
2x09	16.00	18.30		12.00	2x21	40.00	42.30	36.00	50.00
2x10	18.00	20.30		14.00	2x22	42.00	44.30	38.00	52.00
2x11	20.00	22.30		16.00	2x23	44.00	46.30	40.00	54.00
2x12	22.00	24.30		18.00	2x24	46.00	48.30	42.00	56.00
2x13	24.00	26.30		20.00	2x25	48.00	50.30	44.00	58.00

PART NO. G862AH XX X T4EU
 NO. OF POSITION ——— COLOR
 1: WHITE
 2: BLACK
 4: BLUE

TOLERANCE	APPROVALS	DATE	TITLE		UNIT		SIZE	PART No.	
X. X.X ±0.30 X.XX ±0.20 X.XXX ±0.10	DRAWN Karen Su	01/15/2018	G862 SERIES 2.00 PITCH, HOUSING FOR CRIMPING SOCKET		mm	A3	G862AHXXXT4EU		
	CHECKED Aqua Chou	01/15/2018					G862AHXXXT4EU		
	APPROVED Roger Tsai	01/15/2018					G862AHXXXT4EU		
ANGULAR ±1°	DWG TYPE CUST DWG	PROJECT CODE SKT			SCALE NA	SHEET 1 OF 2	DWG No.	REV.	
UNLESS OTHERWISE SPECIFIED					G862AHXXXT4EU	A			

Amphenol®

Amphenol Corporation
Amphenol Taiwan Corporation

This document is the property of Amphenol Corporation and is delivered on the express condition that it is not to be disclosed, reproduced or used, in whole or in part, for manufacture or sale by anyone other than Amphenol Corporation without its prior consent, and that no right is granted to disclose or to use any information in this document.

The marking on this product doesn't contain environmental hazardous materials per Material Specification SS-00259 for Sony GP compliant or per directive 2011/65/EU for RoHS compliant.



ORIGINAL



REVISIONS				
SYM	ECN No.	DESCRIPTION	DATE	APPROVED
A	NE-17266	RELEASE REVISION	01/15/2018	Roger Tsai

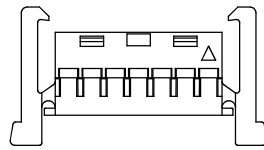

CONNECTOR



BAG

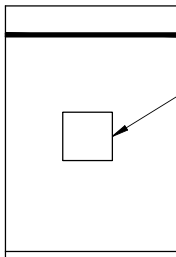

LABEL

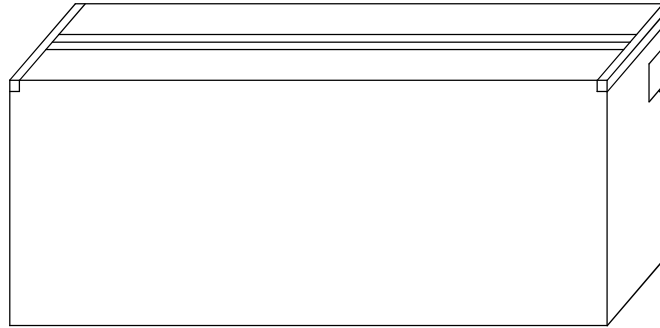

LABEL

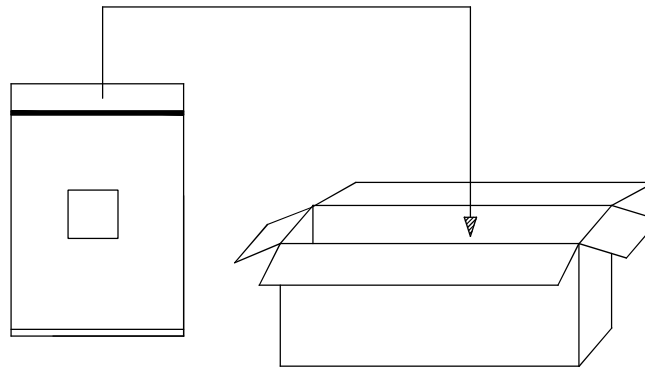

CARTON

PACKING CAPACITY				
PIN	PCS/BAG	BAG/BC	PCS/BC	PE BAG
2x02~2x03	1,000	80	80,000	0.08*130*150
2x04~2x07	1,000	60	60,000	0.08*150*190
2x08~2x10	1,000	40	40,000	0.08*160*240
2x11~2x15	1,000	20	20,000	0.08*210*270
2x16~2x20	1,000	16	16,000	0.08*240*310
2x21~2x25	500	20	10,000	0.08*210*270

NOTES:

- MATERIAL:
CARTON: FIBREBOARD, CORRUGATED, DOUBLE WALL.
PE BAG: POLYETHYLENES, TRANSPARENT COLOR.
- DIMENSION:
PE BAG: SEE TABLE
CARTON: 450 X 370 X 250 mm.
- QUANTITY: SEE TABLE

TOLERANCE	APPROVALS	DATE	TITLE		PART No.	
X. ±0.30	DRAWN Karen Su	01/15/2018	G862 SERIES 2.00 PITCH, HOUSING FOR CRIMPING SOCKET		Amphenol® Amphenol Corporation Amphenol Taiwan Corporation	
X.X ±0.20	CHECKED Aqua Chou	01/15/2018				
X.XXX ±0.10	APPROVED Roger Tsai	01/15/2018				
ANGULAR ±1°	DWG TYPE CUST DWG	PROJECT CODE SKT	UNIT mm	SIZE A3	G862AHXXXT4EU	
UNLESS OTHERWISE SPECIFIED			SCALE NA	SHEET 2 OF 2	DWG No. G862AHXXXT4EU	REV. A

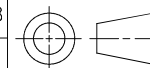

UNIT mm
SCALE NA
SIZE A3
SHEET 2 OF 2

PART No. G862AHXXXT4EU
DWG No. G862AHXXXT4EU
REV. A