

| REVISIONS |                             |         |        |
|-----------|-----------------------------|---------|--------|
| REV       | ECN, ERN NO.                | DATE    | APPRD. |
| B         | PRODUCT DRAWING (EAR 14658) | MAY4/18 | K.L.   |

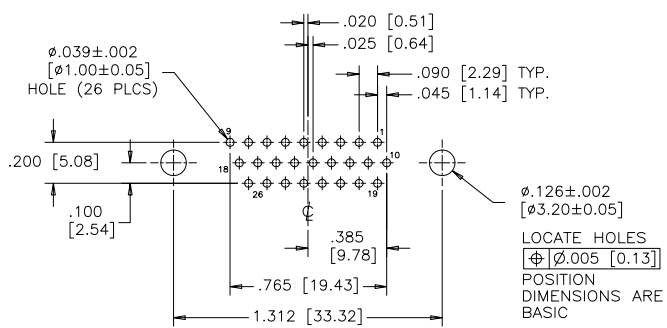
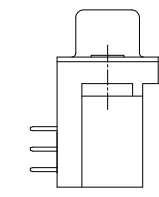
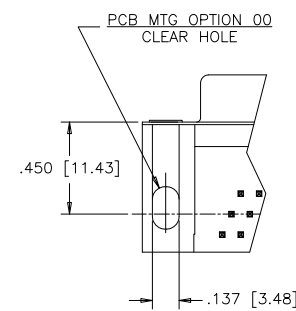
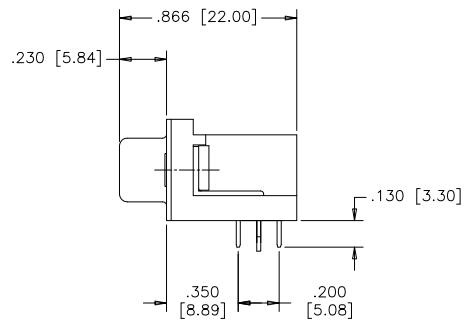
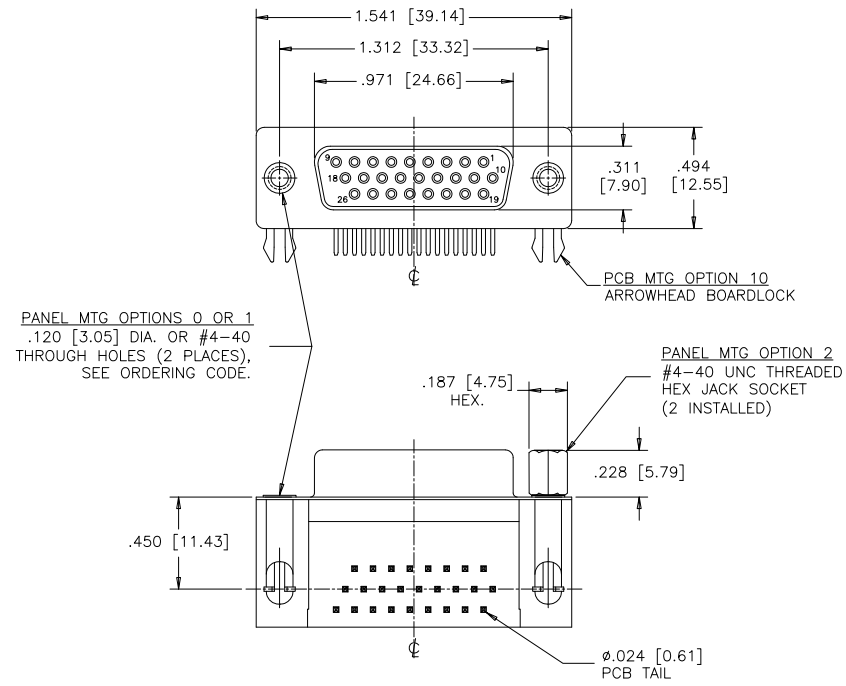

RECOMMENDED P.C.B LAYOUT  
(COMPONENT SIDE OF BOARD)

ORDERING CODE:

PART NUMBER: 1 7 E B H - 0 2 6 S A M - 2 1 0

- SERIES
- NUMBER OF CONTACTS 026
- STYLE S= SOCKET
- CONTACT PLATING OPTIONS FOR ENGAGEMENT AREA
  - AA= 3µ" [0.08 MICRONS] GOLD FLASH
  - CH= 15µ" [0.38 MICRONS] GOLD
  - AM= 30µ" [0.76 MICRONS] GOLD
- PCB MOUNTING OPTIONS
  - 00= CLEAR HOLE
  - 10= ARROWHEAD BOARDLOCK
- PANEL MOUNTING OPTIONS
  - 0= .120 [3.05] CLEAR HOLE
  - 1= #4-40 THREADED HOLE
  - 2= #4-40 UNC THREADED HEX JACK SOCKETS

SPECIFICATIONS:

- MATERIALS: ALL MATERIALS ARE RoHS COMPLIANT.
- SHELLS: STEEL, NICKEL PLATED.
- INSERTS: HIGH TEMPERATURE RESISTANT NYLON, GLASS REINFORCED, UL FLAMMABILITY RATING 94V-0, COLOUR: BLACK.
- CONTACTS: COPPER ALLOY, GOLD PLATING (SEE ORDERING CODE) OVER 50µ" [1.27 MICRONS] NICKEL ON ENGAGEMENT AREA WITH 100µ" [2.54 MICRONS] MIN. MATTE TIN ON CONTACT TERMINALS.
- BOARDLOCK: COPPER ALLOY, TIN PLATED.

ELECTRICAL DATA:

- CURRENT RATING: 3 AMP
- CONTACT RESISTANCE: 15 MILLIOHMS MAX.
- INSULATION RESISTANCE: 5000 MEGOHMS MIN.
- DIELECTRIC WITHSTANDING VOLTAGE: 1000 VAC rms
- OPERATING TEMPERATURE: -55°C TO +105°C

|                   |              |      |          |
|-------------------|--------------|------|----------|
| DRAWN             | J.LEE        | DATE | DEC12/06 |
| DESIGNED          |              |      |          |
| CHECKED           | K.LAMBIE     | DATE | DEC12/06 |
| I. E. APPRD.      |              |      |          |
| Q. A. APPRD.      |              |      |          |
| DWG. APPRD.       |              |      |          |
| ENG. REL. NO.     |              |      |          |
| REF.              | EAR 12992    |      |          |
| DIMENSIONS ARE IN | CODE ID. NO. |      |          |
| INCHES [mm]       | 03554        |      |          |

Amphenol Canada Corp.

TITLE 17EBH SERIES HIGH DENSITY D-SUB CONNECTOR, 26 SIZE SOCKET, RIGHT ANGLE PCB CONTACTS, PLATING & MOUNTING OPTIONS, RoHS COMPLIANT

|       |                    |                                    |
|-------|--------------------|------------------------------------|
| DWG   | DRAWING NO.        | REV.                               |
| C     | P-17EBH-026SXX-XX0 | B                                  |
| SCALE | 2/1                | WT. _____ SURF. _____ SHEET 1 OF 1 |

THIS DOCUMENT CONTAINS PROPRIETARY INFORMATION AND SUCH INFORMATION MAY NOT BE DISCLOSED TO OTHERS FOR ANY PURPOSE OR USED FOR MANUFACTURING PURPOSES WITHOUT WRITTEN PERMISSION FROM AMPHENOL CANADA CORP.